

IF THIS SHEET IS NOT 24 X 36 IT IS A REDUCED SCALE PRINT - SCALE ACCORDINGLY

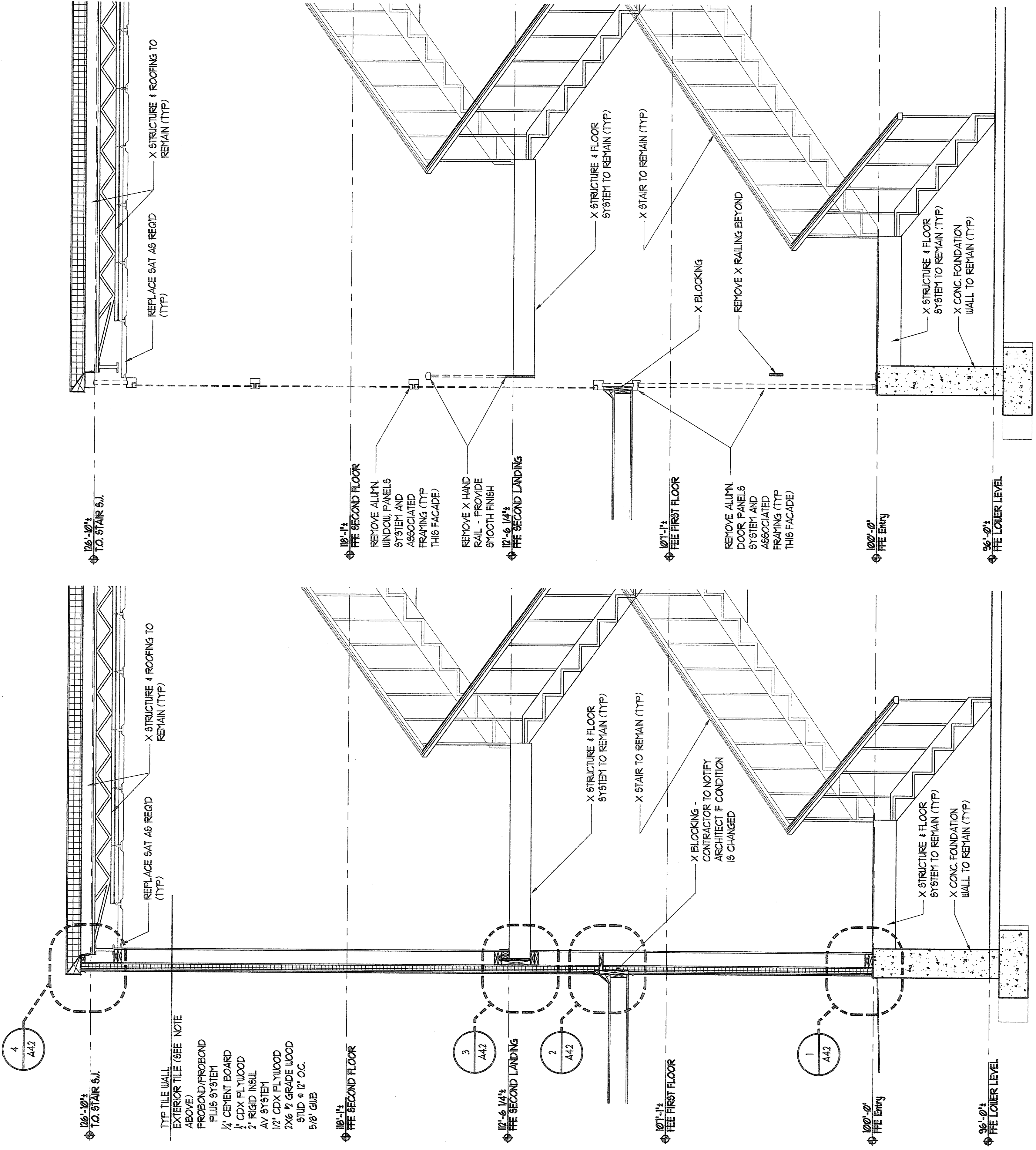
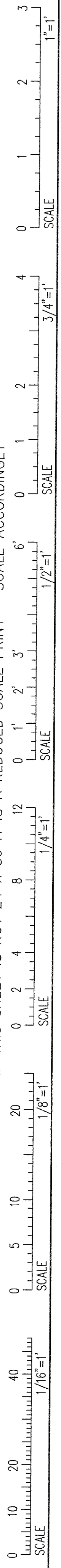

TYP TILE WALL ABOVE
 EXTERIOR TILE (SEE NOTE ABOVE)
 PREBOND/PROBOND PLUS SYSTEM
 1/2" CEMENT BOARD
 1/2" CDX PLYWOOD
 2" RIGID INSUL
 AV SYSTEM
 1/2" CDX PLYWOOD
 2X6 #2 GRADE WOOD STUD @ 12" O.C.
 5/8" GIBS

1 Demo Wall Section
 SCALE: 1/2" = 1'-0"

2 Wall Section
 SCALE: 1/2" = 1'-0"

DATE	DESCRIPTION
	BID SET
Date Issued	04/16/10
Project Number	10503

SHEET NAME	
Wall Sections	
Drawn By	JP
Checked By	LAS
A3.2	

CONSTRUCTION SET

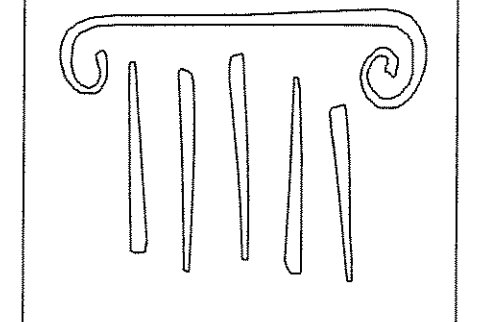

PORT CITY ARCHITECTURE

65 NEWBURY STREET
 PORTLAND, ME 04101
 207.761.9000
 fax: 207.761.2010
 lita@portcityarch.com

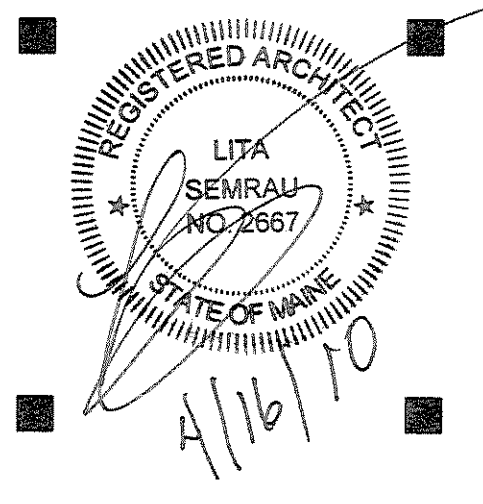

ALLIED COOK CONSTRUCTION
 Managers - Builders
 Building Excellence Since 1958

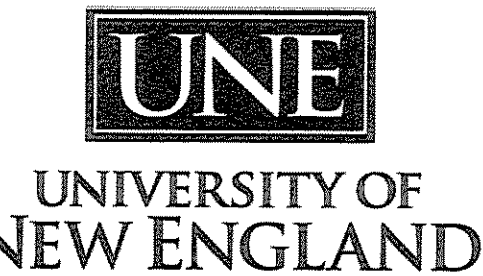

UNIVERSITY OF NEW ENGLAND
 Portland Campus
Blewett Hall Window Replacement
 716 STEVENS AVENUE, PORTLAND, ME