

Location of Construction: 746 Stevens Ave.		Owner: Westbrook College		Phone: 797-7261	
Owner Address: same		Leasee/Buyer's Name:		Business Name:	
Contractor Name: Neocraft Signs		Address: 686 Main St. Lewiston		Phone: 772-1544	
Past Use: college		Proposed Use: law office with sign as per plans -renting space from colleg		COST OF WORK: \$ 26.60 PERMIT FEE: \$ 26.60 FIRE DEPT. <input type="checkbox"/> Approved <input type="checkbox"/> Denied INSPECTION: Use Group: <u>1</u> Type: Signature: <i>BOCA 9/2/94</i>	
Proposed Project Description: Please mail permit to: McCabe & Duval, Inc. 44 Exchange St Portland, ME 04101 Direct Sign as per plans		PEDESTRIAN ACTIVITIES DISTRICT (P.U.D.) Action: <input type="checkbox"/> Approved <input type="checkbox"/> Approved with Conditions <input type="checkbox"/> Denied Signature: _____ Date: _____			

Permit No:
940936

Permit Issued:
PERMIT ISSUED
SEP 6 1994
145-A-003
CITY OF PORTLAND

Zoning Approval:
Special Zone or Reviews:
 Shoreland
 Wetland
 Flood Zone
 Subdivision
 Site Plan maj minor mm

Zoning Appeal
 Variance
 Miscellaneous
 Conditional Use
 Interpretation
 Approved
 Denied

Historic Preservation
 Not in District or Landmark
 Does Not Require Review
 Requires Review

Action:
 Approved
 Approved with Conditions
 Denied
 Date: 7/26/94

1. This permit application doesn't preclude the Applicant(s) from meeting applicable State and Federal rules.
2. Building permits do not include plumbing, septic or electrical work.
3. Building permits are void if work is not started within six (6) months of the date of issuance. False information may invalidate a building permit and stop all work..

Latin

CERTIFICATION

I hereby certify that I am the owner of record of the named property, or that the proposed work is authorized by the owner of record and that I have been authorized by the owner to make this application as his authorized agent and I agree to conform to all applicable laws of this jurisdiction. In addition, if a permit for work described in the application issued, I certify that the code official's authorized representative shall have the authority to enter all areas covered by such permit at any reasonable hour to enforce the provisions of the code(s) applicable to such permit

[Signature]
 SIGNATURE OF APPLICANT ADDRESS: 441 Exchange St. Portland DATE: 7/25/94 PHONE: 734-4530

RESPONSIBLE PERSON IN CHARGE OF WORK, TITLE PHONE:

CEO DISTRICT **4**
Mr. Carroll

COMMENTS

Done w/out inspec.

	Type	Inspection Record	Date
Foundation:	_____	_____	_____
Framing:	_____	_____	_____
Plumbing:	_____	_____	_____
Final:	_____	_____	_____
Other:	_____	_____	_____

WESTBROOK COLLEGE

Founded in 1831

Stevens Avenue
Portland, Maine 04103
(207) 797-7261/FAX (207) 797-7225

Tom Downing
Hardy, Wolf & Downing, P.A.
186 Lisbon Street
Lewiston, Maine 04240

Dear Tom,

I have been in touch with Chris Duval, of McCabe & Duval, in regards to the sign they are designing for you to be installed at 746 Stevens Avenue. It is acceptable to Westbrook College to install the sign at the front of the building, as long as it meets all city codes. The sign should be no larger than nine square feet, as agreed upon in the lease. Should you have any questions please feel free to give me a call.

Sincerely,

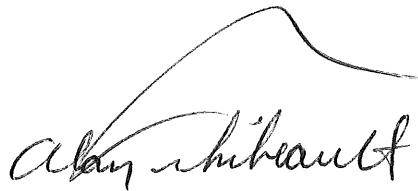

Alan Thibeault
Director of Facilities Management

cc Wendy Libby, Treasurer, Westbrook College
✓ Chris Duval, McCabe & Duval

ACORD. CERTIFICATE OF INSURANCE

ISSUE DATE (MM/DD/YY)

07/21/94

PRODUCER

NORTON,
 P O BOX 655
 181 PARK ROW
 BRUNSWICK ME 04011

THIS CERTIFICATE IS ISSUED AS A MATTER OF INFORMATION ONLY AND CONFERS NO RIGHTS UPON THE CERTIFICATE HOLDER. THIS CERTIFICATE DOES NOT AMEND, EXTEND OR ALTER THE COVERAGE AFFORDED BY THE POLICIES BELOW.

COMPANIES AFFORDING COVERAGE

INSURED

HARDY WOLF & DOWNING
 186 LISBON ST
 LEWISTON ME 04240

- COMPANY LETTER A THE TRAVELERS INSURANCE
- COMPANY LETTER B
- COMPANY LETTER C
- COMPANY LETTER D
- COMPANY LETTER E

COVERAGES

THIS IS TO CERTIFY THAT THE POLICIES OF INSURANCE LISTED BELOW HAVE BEEN ISSUED TO THE INSURED NAMED ABOVE FOR THE POLICY PERIOD INDICATED, NOTWITHSTANDING ANY REQUIREMENT, TERM OR CONDITION OF ANY CONTRACT OR OTHER DOCUMENT WITH RESPECT TO WHICH THIS CERTIFICATE MAY BE ISSUED OR MAY PERTAIN. THE INSURANCE AFFORDED BY THE POLICIES DESCRIBED HEREIN IS SUBJECT TO ALL THE TERMS, EXCLUSIONS AND CONDITIONS OF SUCH POLICIES. LIMITS SHOWN MAY HAVE BEEN REDUCED BY PAID CLAIMS.

CO LTR	TYPE OF INSURANCE	POLICY NUMBER	POLICY EFFECTIVE DATE (MM/DD/YY)	POLICY EXPIRATION DATE (MM/DD/YY)	LIMITS
A	GENERAL LIABILITY	680688F47791	11/07/93	11/07/94	GENERAL AGGREGATE \$2,000,000
X	COMMERCIAL GENERAL LIABILITY				PRODUCTS-COMP/OP AGG. \$2,000,000
	CLAIMS MADE X OCCUR.				PERSONAL & ADV. INJURY \$ N/A
	OWNER'S & CONTRACTOR'S PROT.				EACH OCCURRENCE \$1,000,000
					FIRE DAMAGE (Any one fire) \$ 50,000
					MED. EXPENSE (Any one person) \$ 5,000
	AUTOMOBILE LIABILITY				COMBINED SINGLE LIMIT \$
	ANY AUTO				BODILY INJURY (Per person) \$
	ALL OWNED AUTOS				BODILY INJURY (Per accident) \$
	SCHEDULED AUTOS				PROPERTY DAMAGE \$
	HIRED AUTOS				
	NON-OWNED AUTOS				
	GARAGE LIABILITY				
	EXCESS LIABILITY				EACH OCCURRENCE \$
	UMBRELLA FORM				AGGREGATE \$
	OTHER THAN UMBRELLA FORM				
	WORKER'S COMPENSATION				STATUTORY LIMITS
	AND				EACH ACCIDENT \$
	EMPLOYERS' LIABILITY				DISEASE-POLICY LIMIT \$
					DISEASE-EACH EMPLOYEE \$
	OTHER				

DESCRIPTION OF OPERATIONS/LOCATIONS/VEHICLES/SPECIAL ITEMS

This coverage also extends to their Portland office located at 746 Stevens Avenue. If you have any questions, please feel free to call me.

CERTIFICATE HOLDER

Dr. Wendy Libby
 Westbrook College
 716 Stevens Avenue
 Portland, ME 04103

CANCELLATION

SHOULD ANY OF THE ABOVE DESCRIBED POLICIES BE CANCELLED BEFORE THE EXPIRATION DATE THEREOF, THE ISSUING COMPANY WILL ENDEAVOR TO MAIL 10 DAYS WRITTEN NOTICE TO THE CERTIFICATE HOLDER NAMED TO THE LEFT, BUT FAILURE TO MAIL SUCH NOTICE SHALL IMPOSE NO OBLIGATION OR LIABILITY OF ANY KIND UPON THE COMPANY, ITS AGENTS OR REPRESENTATIVES.

AUTHORIZED REPRESENTATIVE

Kay Ann Dow

Post-It™ brand fax transmittal memo 7671 # of pages 1

To	Chris Duvall	From	Alan Thibault
Co.	McDermott Duvall	Co.	Westbrook College
Dept.		Phone #	773-7245
Fax #	773-7245	Fax #	773-7245

X site location
 716 - Avenue Ave
 Westbrook, Me. 04092

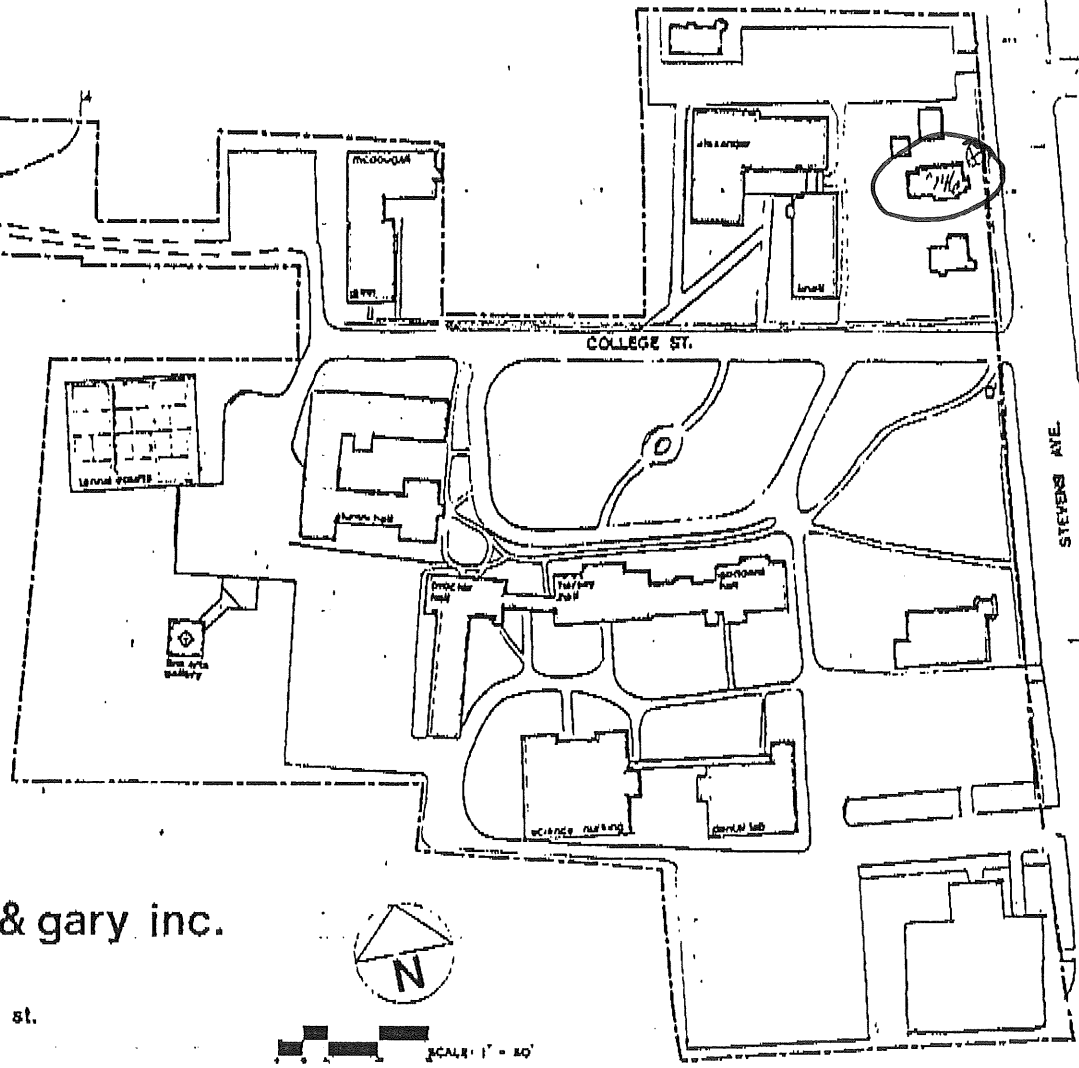

moriece & gary inc.

land planners
 165 commercial st.
 portland, maine

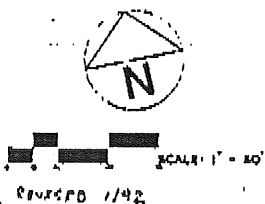

REVISED 1/92

(1) 2'-4" x 3'-7 1/2" double faced architectural Series 3 post and panel sign consisting of extruded aluminum cabinet system with 1/8" aluminum sign faces and surface applied graphics. Sign to be installed between (2) 1 3/4" x 3 1/4" aluminum posts set direct burial method to a depth of 4' below grade with concrete footing allowing 3' beneath sign to grade.

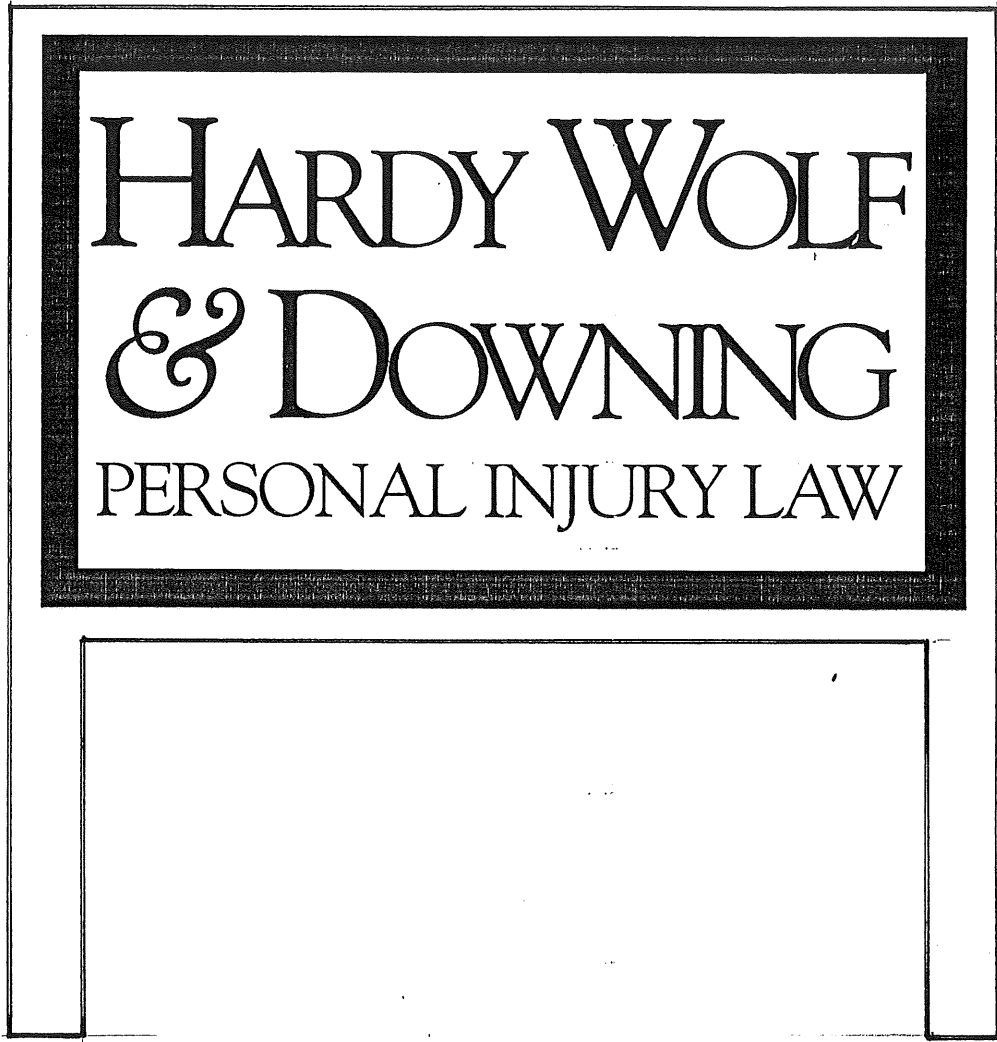

HARDY, WOLF & DOWNING, 746 STEVENS AVE, PORTLAND, ME.
PROPOSED SIGN 7-1894 DWG 1 of 2

Neokraft

Signs that work.

Neokraft Signs Incorporated, 688 Main Street, Lewiston, Maine 04240
Manufacturers, Installers and Designers of Custom Electric, Neon, Plastic and Metal Signs
(207) 782-9654, FAX 782-0009

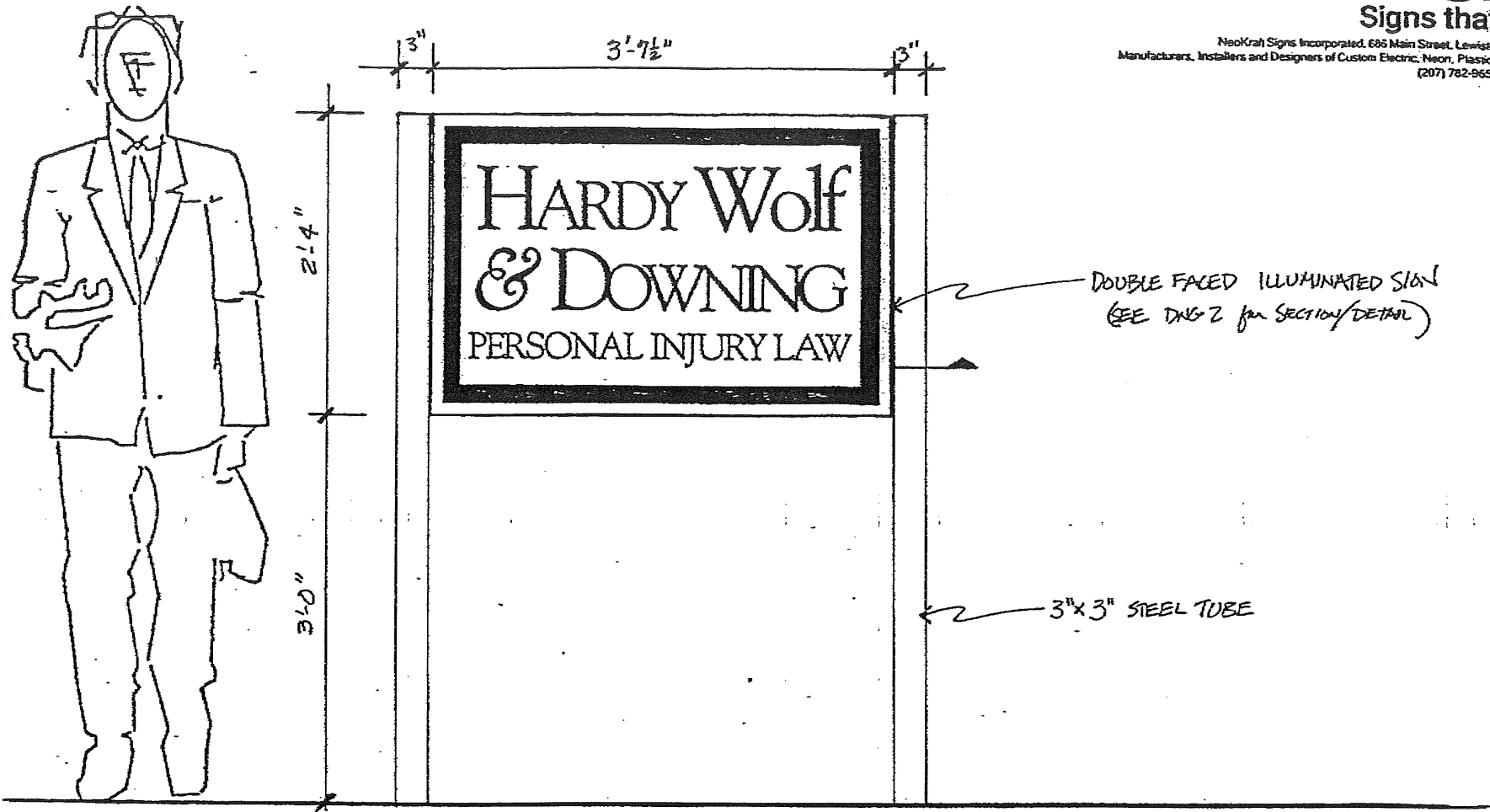

ELEVATION
SCALE 1" = 1'-0"

Series 3

3 1/4" Post and Panel

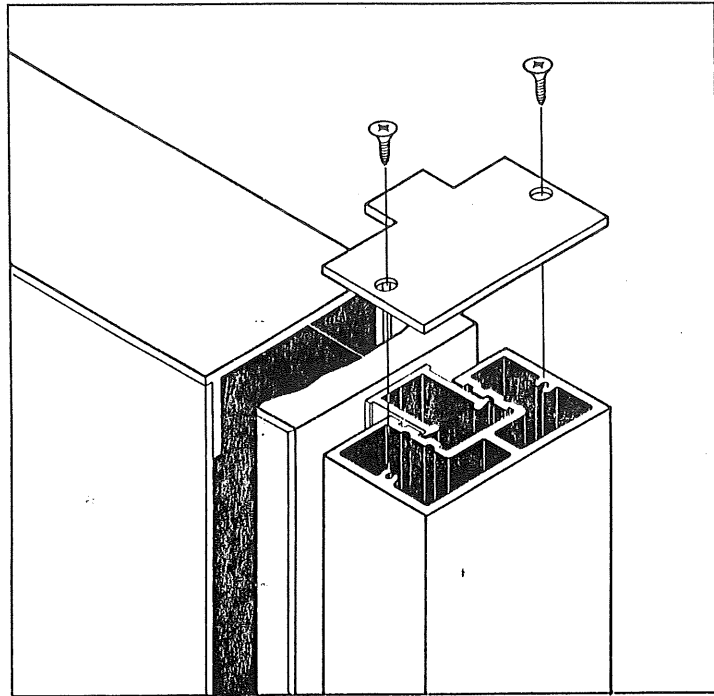

- Non-illuminated
- Fixed faces
- Square corners
- Rectangular columns
- Adjustable reveal
- Aluminum faces

- Rectangular column
- Direct burial
- Embedded in concrete

