

- DEMO NOTES:**
1. DEMO SET ON JANUARY 9, 2015 FOR ADDITIONAL INFORMATION ON ITEMS PREVIOUSLY REMOVED AVAILABLE FOR REFERENCE.
  2. SEE DEMO ELEVATIONS AND SECTIONS FOR MORE INFORMATION.
  3. OFTEN DURING DEMO OF HISTORIC BUILDINGS, ARTIFACTS ARE FOUND IN WALLS AND OTHER CAVITIES - IF ANY ARTIFACTS ARE FOUND DURING DEMO, THEY ARE PROPERTY OF UNE AND SHALL BE TURNED OVER TO THE OWNER.
  4. SALVAGE NOTES FOR ANNEX: (SEE PHOTO ON D2.4)
    - A) DR AND WINDOW TRIM INCLUDING COING
    - B) TRIM AT BOTTOM OF CURVED CEILING
    - C) BEAD BOARD ON THE EXTERIOR WALLS
    - D) SLATE COUNTERS AND OTHER ITEMS BEING STORED IN THE ANNEX

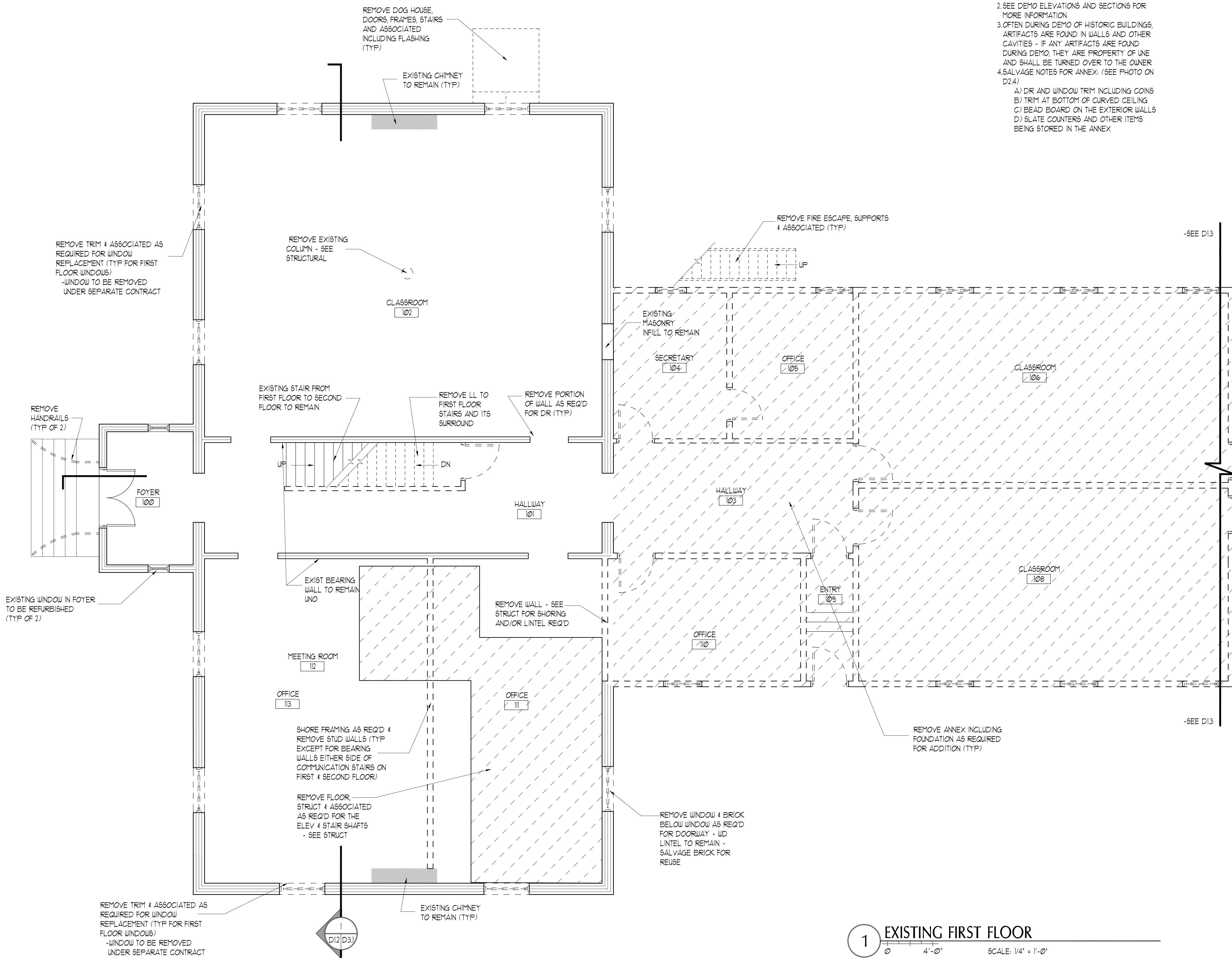

1 EXISTING FIRST FLOOR  
 SCALE: 1/4" = 1'-0"

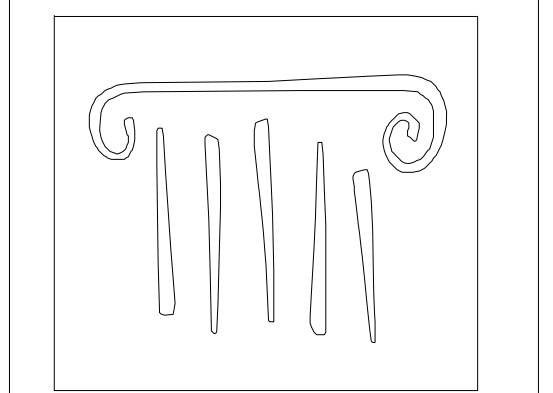

65 NEWBURY STREET  
 PORTLAND, ME 04101  
 207.761.9000  
 info@portcityarch.com  
 WWW.PORTCITYARCH.COM

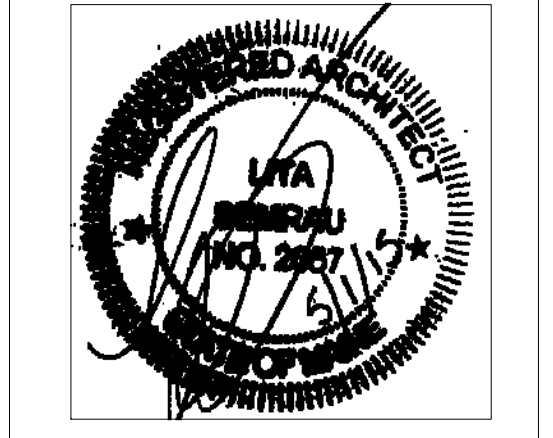

**UNE**  
 UNIVERSITY OF  
 NEW ENGLAND

**Allied Engineering**  
 Structural Mechanical Electrical Commissioning

**CONSIGLI**  
 Est. 1905

**BECKER**  
 STRUCTURAL ENGINEERS

**PERMIT SET**

REVISIONS		
No.	Description	Date

UNIVERSITY OF  
 NEW ENGLAND  
 PORTLAND, MAINE

**ALUMNI HALL  
 RENOVATION  
 FIRST FLOOR  
 PLAN**

Project Number **14525**  
 Date **May 1, 2015**  
 Drawn by **JP TS SM**  
 Checked by **LAS**

**D1.2**

Scale AS NOTED