

2 LOWER LEVEL STAIR PLAN
SCALE: 1/2" = 1'-0"

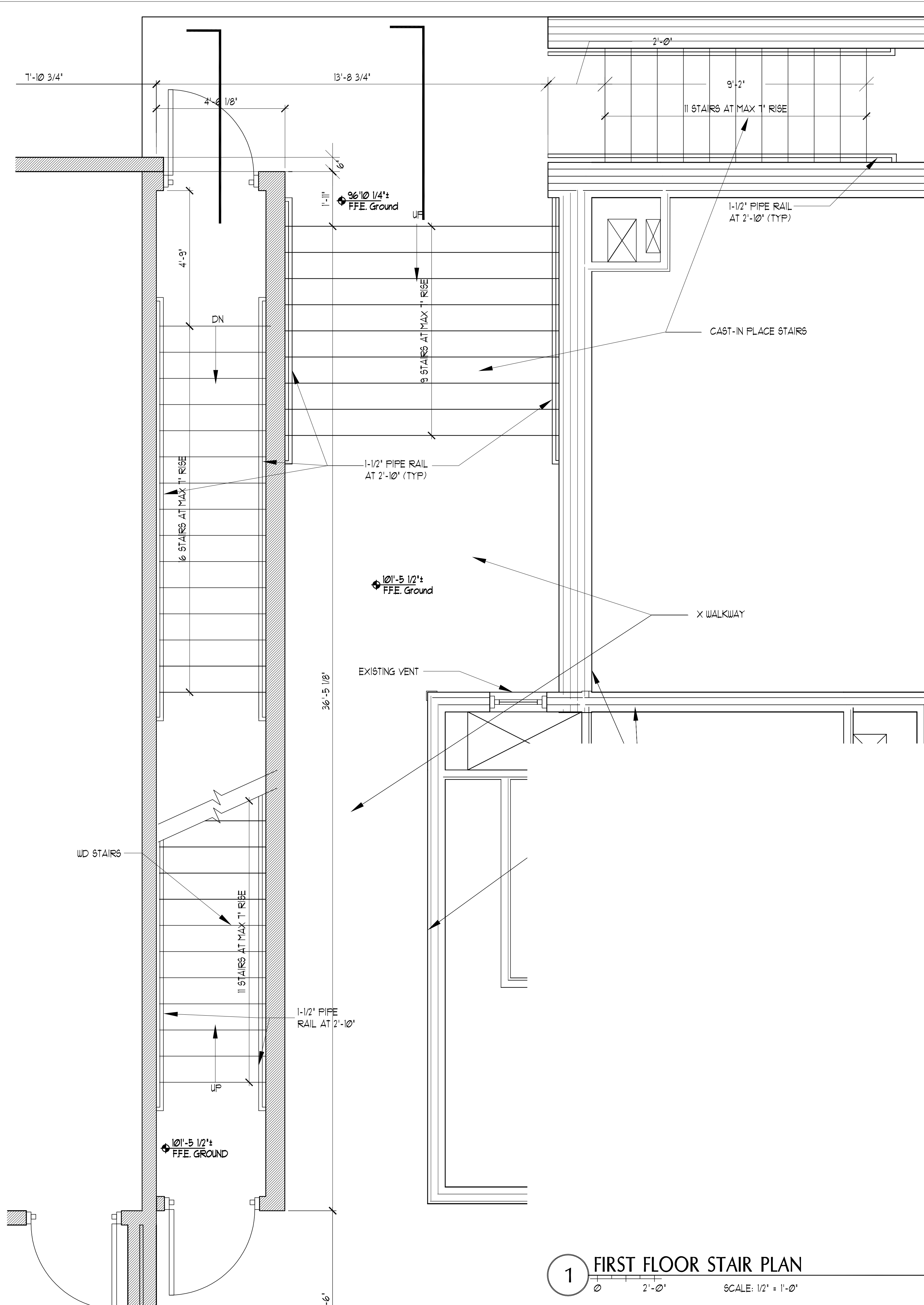

1 FIRST FLOOR STAIR PLAN
SCALE: 1/2" = 1'-0"

NOTE:
CONTRACTOR TO VERIFY DIMENSIONS & EXISTING
CONDITION & REPORT TO ARCHITECT FOR COORDINATION
PURPOSES

NOTE:
CONTRACTOR TO FIELD VERIFY ALL FLOOR TO FLOOR
DIMENSIONS

NOTE:
HANDRAILS TO EXTEND 12" HORIZ. AT THE TOP OF ALL
STAIR RUNS (MIN.) AND CONTINUE TO SLOPE AT THE
BOTTOM OF ALL STAIR RUNS FOR A HORIZ. DISTANCE OF
11" (MIN.), TYP.

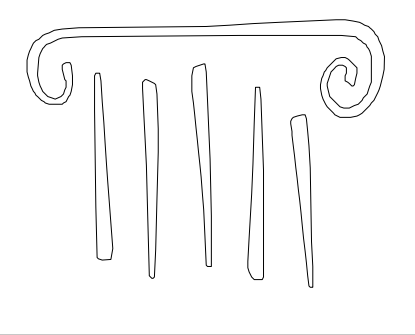

65 NEWBURY STREET
PORTLAND, ME 04101
207.761.9000
info@portcityarch.com
WWW.PORTCITYARCH.COM

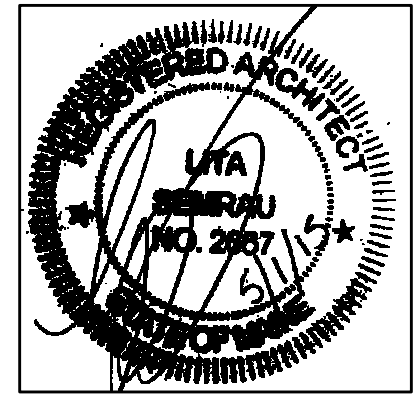

Allied Engineering
Structural Mechanical Electrical Commissioning



PERMIT SET

REVISIONS		
No.	Description	Date

**UNIVERSITY OF
NEW ENGLAND**
PORTLAND, MAINE

**ALUMNI HALL
RENOVATION
ABPLANALP
STAIR PLAN**

Project Number **14525**
Date **May 01, 2015**
Drawn by **JP TS SM AR**
Checked by **LAS**

A31

Scale AS NOTED