

**LIFE SAFETY DEVICE LEGEND**

- SYSTEM INTEGRATED EMERGENCY LIGHT (REMOTE HEAD)
- SYSTEM INTEGRATED EMERGENCY LIGHT (2 LAMP)
- NEW ILLUMINATED EXIT SIGN WITH DIRECTIONAL CHEVRON
- SYSTEM INTEGRATED FIRE PULL STATION
- SYSTEM INTEGRATED MAGNETIC DOOR HOLDBACK
- SYSTEM INTEGRATED FIRE HORN (H); HORNSTROBE (HS)
- SYSTEM INTEGRATED PHOTOELECTRIC SMOKE DETECTOR
- 10 LB ABC TYPE EXTINGUISHER
- FIRE SEPARATION WALL RATING AS INDICATED
- TRAVEL DISTANCE
- EXISTING COMPONENT OR DEVICE
- REMOVE EXISTING COMPONENT OR DEVICE
- NEW COMPONENT OR DEVICE

**PLAN LEGEND**

- EXISTING WALL TO REMAIN
- NEW WOOD STUD WALL
- NEW STEEL STUD WALL
- NEW COOLER PANEL WALL
- NEW MASONRY (CMU) WALL
- NEW BRICK VENEER / STEEL STUD WALL
- EXISTING BRICK WALL TO REMAIN
- EXISTING MASONRY (CMU) WALL
- EXISTING WALL TO BE DEMOLISHED
- NEW BUILDING ADDITIONS
- (E) EXISTING DEVICE OR COMPONENT
- (N) NEW DEVICE OR COMPONENT
- (R) DEVICE OR COMPONENT TO BE REMOVED

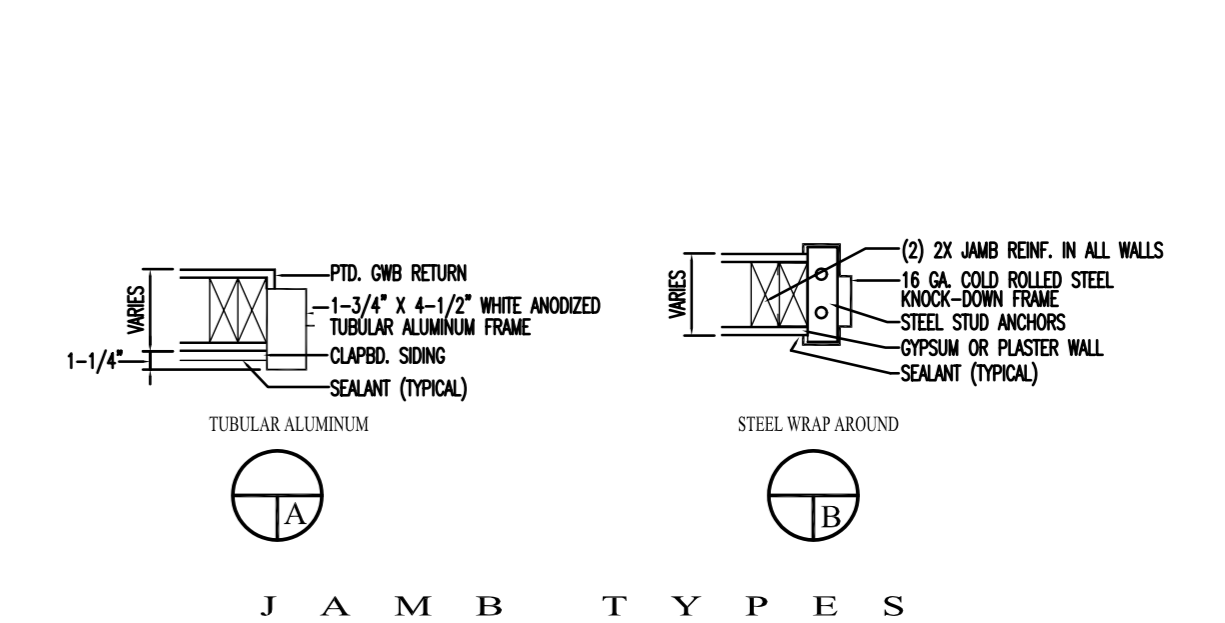
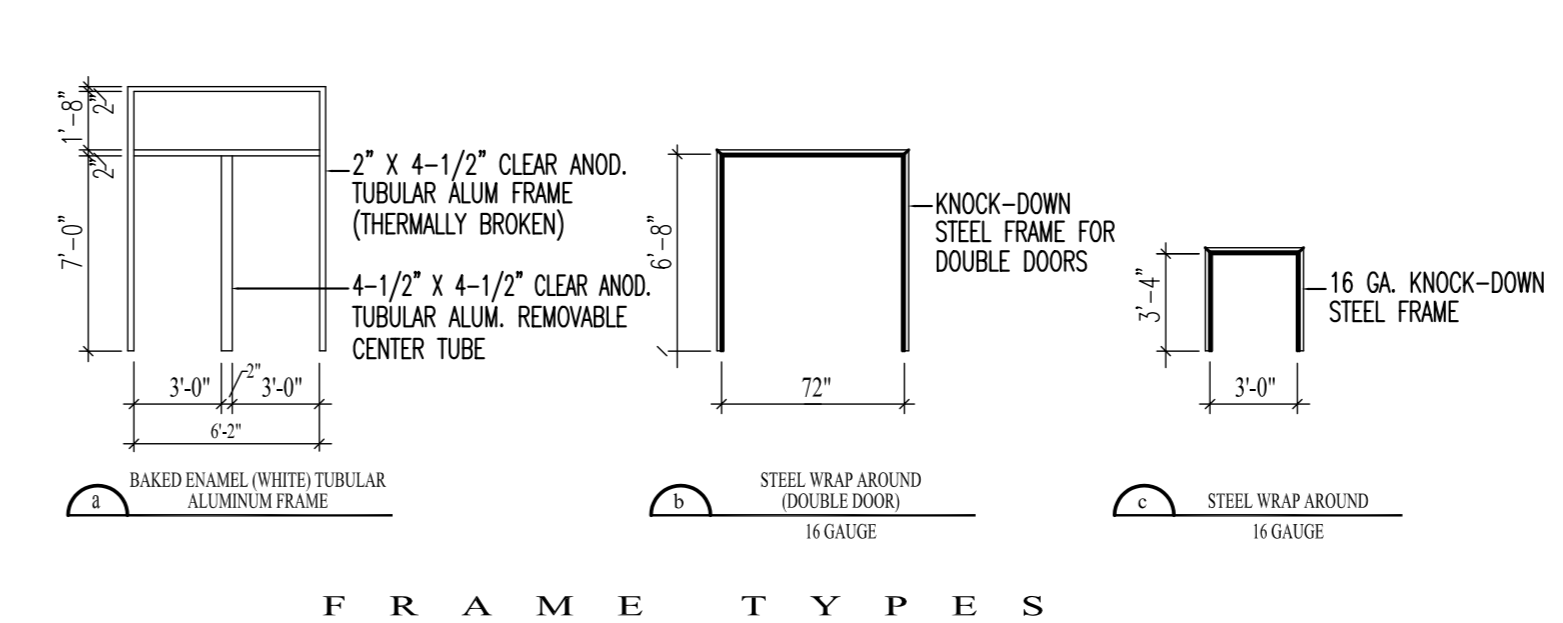
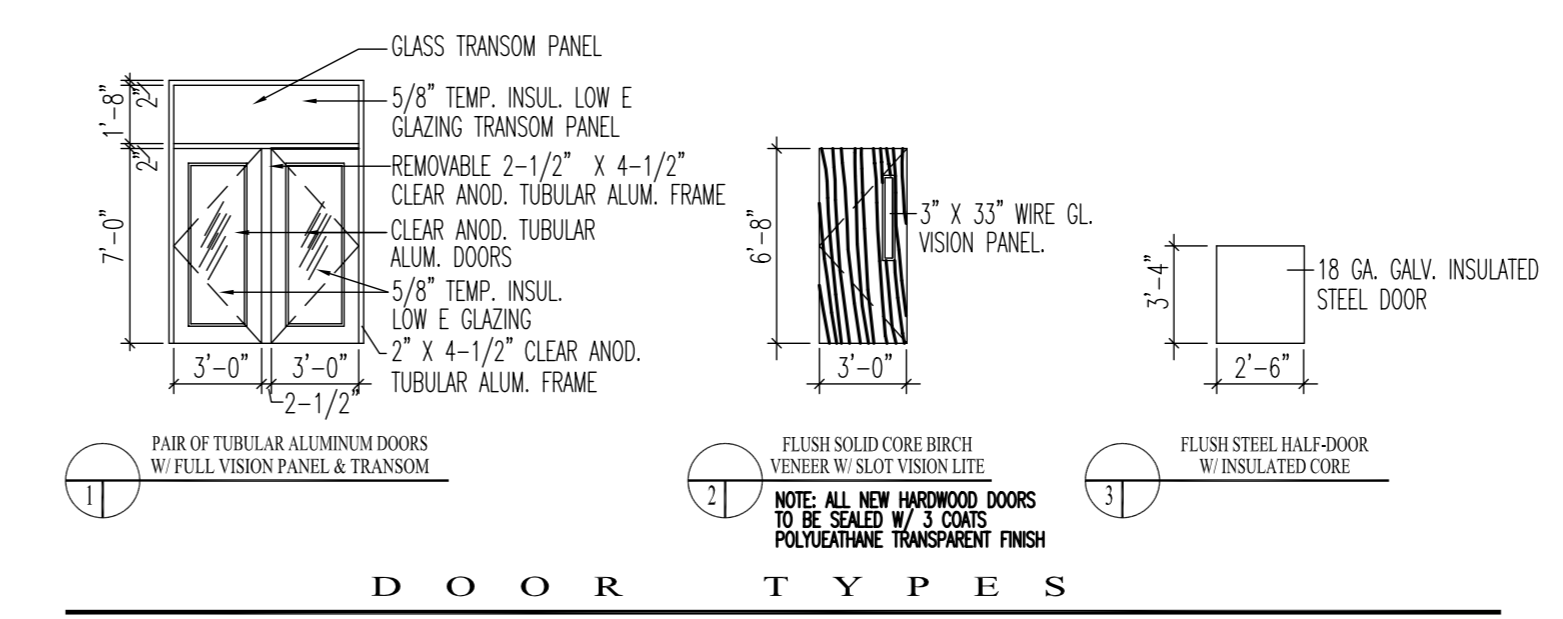

**DOOR SCHEDULE**

NO.	DOOR SIZE	DOOR TYPE	JAMB TYPE	FRAME TYPE	RATING	CYLINDER CORE	HARDWARE	REMARKS
FH11	PR. 3070 TUBULAR ALUM.	1	A	TUBULAR ALUM. AA	NO RATING	MERCRO MWMN CORE	NO RATING	NO SETS OF DOCS. FOR STAIRS TO BE ON THE SAME OR BY METRO MWMN SETS. (SEE SCHEDULE FOR DOOR TYPE AND METRO MWMN SETS. SEE SCHEDULE FOR DOOR TYPE AND METRO MWMN SETS. SEE SCHEDULE FOR DOOR TYPE AND METRO MWMN SETS.)
FH12	PR. 3068 BRICK VENEER	2	B	STEEL, BB	1 HR. ULL LISTED	MERCRO CORE	1 HR. ULL LISTED	1. ALL NEW EXTERIOR HARDWARE TO BE STAINLESS STEEL. 2. ALL NEW INTERIOR HARDWARE TO BE STAINLESS STEEL. 3. ALL NEW INTERIOR AND EXTERIOR LOCKS SHALL BE EQUIPPED WITH REINFORCED CYLINDER LOCKS. THE EXTERIOR CYLINDER LOCKS SHALL BE OF THE TYPE THAT IS NOT AFFECTED BY THE CYLINDER LOCKS WITH THE CYLINDER LOCKS. 4. ALL HARDWARE AND LOCKS SHALL BE OF THE TYPE THAT IS NOT AFFECTED BY THE CYLINDER LOCKS WITH THE CYLINDER LOCKS.
FH13	3014 STEEL DOOR	3	B	STEEL, BB	1 HR. ULL LISTED	MERCRO CORE	1 HR. ULL LISTED	1. ALL NEW EXTERIOR HARDWARE TO BE STAINLESS STEEL. 2. ALL NEW INTERIOR HARDWARE TO BE STAINLESS STEEL. 3. ALL NEW INTERIOR AND EXTERIOR LOCKS SHALL BE EQUIPPED WITH REINFORCED CYLINDER LOCKS. THE EXTERIOR CYLINDER LOCKS SHALL BE OF THE TYPE THAT IS NOT AFFECTED BY THE CYLINDER LOCKS WITH THE CYLINDER LOCKS. 4. ALL HARDWARE AND LOCKS SHALL BE OF THE TYPE THAT IS NOT AFFECTED BY THE CYLINDER LOCKS WITH THE CYLINDER LOCKS.

**DOOR, FRAME & HARDWARE SCHEDULE**  
NOT TO SCALE

REL. FOR PRICING & PERMITTING - JUNE 25, 2012  
NOT FOR CONSTRUCTION

FR. HAYES STAIR RETROFIT PROJECT  
695 STEVENS AVENUE  
PORTLAND, MAINE 04103



REVISIONS

NO.	DESCRIPTION	DATE
01	CONCEPTUAL PLAN	MAY 06, 2012
02	REVISED DRAWING SHEETS	MAY 16, 2012
03	ADD ALL EGRESS LOWER	MAY 21, 2012
04	REVISED DRAWING SHEETS	MAY 21, 2012
05	REV. PER STRUCT. REVIEW	JUNE 26, 2012

**DAVID D. LEASURE - ARCHITECTURAL ASSOCIATES INC.**  
1344 WASHINGTON AVENUE  
PORTLAND, MAINE  
PH. (207) 797-8661 FAX (207) 797-8333

PROJECT NO. 080111 PROJECT TITLE: ST. BRIGID SCHOOL RENOVATION  
SHEET TITLE: FR. HAYES STAIR - LOWER LEVEL PLAN  
SCALE: 1/4" = 1'-0"

FH-A-200 R1

THIS DRAWING HAS BEEN DEVELOPED BY DAVID D. LEASURE, ARCHITECTURAL ASSOCIATES INC. ALL RIGHTS RESERVED. NO PART OF THIS DRAWING IS TO BE REPRODUCED OR TRANSMITTED IN ANY FORM OR BY ANY MEANS, ELECTRONIC OR MECHANICAL, WITHOUT THE WRITTEN PERMISSION OF DAVID D. LEASURE, ARCHITECTURAL ASSOCIATES INC. ALL RIGHTS RESERVED.