

GENERAL NOTES:

1. REPORT AN DISCREPANCIES TO THE DESIGNER OF RECORD. CONTRACTOR SHALL PROCEED WITH WORK ONLY AFTER DISCREPANCIES HAVE BEEN RESOLVED BY THE DESIGNER OF RECORD.
2. EXISTING BUILDING COMPONENTS AND WORK CURRENTLY COMPLETED AND IN PLACE DURING CONSTRUCTION WHICH IS AFFECTED BY NEW WORK AND DEMOLITION, OR WHICH MAY BE DAMAGED BY THE CONTRACTOR OR ANY SUBCONTRACTOR, SHALL BE REPLACED OR RESTORED TO THE ORIGINAL CONDITION AND COLOR AS APPROVED BY THE DESIGNER OF RECORD.
3. THE BUILDING SHALL BE CONSTRUCTED TO CONFORM WITH ALL GOVERNING CODES INCLUDING 2009 IBC, NFPA 101 2009 AND NFPA 150 PERFORMANCE BASED CRITERIA SHOWN HEREIN, ICC PLUMBING CODE, NEC 2009, AND ANSI.
4. ALL EXISTING CONDITIONS ARE TO BE FIELD VERIFIED BY THE CONTRACTOR PRIOR TO FABRICATION. THIS INCLUDES DELIVERY PROCEDURES, DIMENSIONS AND MATERIALS.
5. DRAWINGS ARE NOT TO BE SCALED. CONTRACTOR SHALL VERIFY DIMENSIONS AND CONDITIONS. APPARENT DISCREPANCIES REQUIRING CLARIFICATION SHALL BE DIRECTED TO THE DESIGNER OF RECORD PRIOR TO COMMENCEMENT OF THE WORK IN QUESTION.
6. DEMOLITION MAY REQUIRE SELECTIVE REMOVAL OF EXISTING MATERIALS, TEMPORARY BRACING AND STRUCTURAL SHORING. REMOVAL OF ALL MATERIALS DISMANTLED NOT INTENDED FOR REUSE SHALL BE DISPOSED OF IN COMPLIANCE WITH LOCAL REGULATIONS.
7. THIS PROJECT SHALL NOT CONTAIN HAZARDOUS MATERIALS OF ANY TYPE, INCLUDING BUT NOT LIMITED TO ASBESTOS.
8. THE CONTRACTOR SHALL OBTAIN ALL REQUIRED PERMITS FROM THE APPROPRIATE OFFICIALS PRIOR TO COMMENCING THE WORK AND INSPECTIONS AND APPROVALS UPON COMPLETION OF THE WORK.
9. WHERE ONLY A SINGLE PRODUCT OR MANUFACTURER IS NAMED, PROVIDE THE PRODUCT INDICATED. SUBSTITUTIONS SHALL BE PERMITTED ONLY WHEN APPROVED BY THE OWNER OR THE OWNERS AUTHORIZED REPRESENTATIVE THROUGH WRITTEN DIRECTIVE.
10. THE LOCATION OF ALL DOOR FRAMES NOT DIMENSIONED SHALL BE 4" FROM ADJACENT WALLS UNLESS OTHERWISE INDICATED.
11. ALL PARTITIONS SHALL EXTEND FROM FLOOR TO UNDERSIDE OF SUPPORTING STRUCTURE ABOVE UNLESS OTHERWISE NOTED.
12. INSTALL BLOCKING BEHIND ALL SURFACE APPLIED FIXTURES, TRIM, GRAB BARS, SHELVES, CHAIR RAILS, PICTURE RAILS AND BASE MOLDINGS.
13. AT PROJECT CLOSEOUT, SUBMIT SPECIFIC WARRANTIES, WORKMANSHIP BONDS, MAINTENANCE AGREEMENTS, FINAL CERTIFICATIONS AND SIMILAR DOCUMENTS.
14. COMPLETE FINAL CLEANUP AT PROJECT CLOSEOUT. TOUCH-UP, REPAIR AND RESTORE ALL MARRED EXPOSED FINISHES.
15. IF TWO CONFLICTING CONDITIONS OR DETAILS EXIST IN THIS DRAWING SET OR ASSOCIATED SPECIFICATIONS THE SUBCONTRACTOR SHALL MAKE THEM KNOWN TO THE GENERAL CONTRACTOR AND DESIGNER OF RECORD. IT SHALL BE THE DESIGNER OF RECORD'S CHOICE TO DECIDE WHICH CONDITION OR DETAIL APPLIES, AT NO ADDITIONAL COST.

REVISIONS:



FORESIDE ARCHITECTS
 LLC

5 FUNDY ROAD Phone: 207-781-3344
 FALMOUTH, ME 04105 Fax: 207-699-5564
 Online @ foresidearchitects.com

Project Status:

PERMIT AND REVIEW DRAWINGS

Project Number:

SW120714

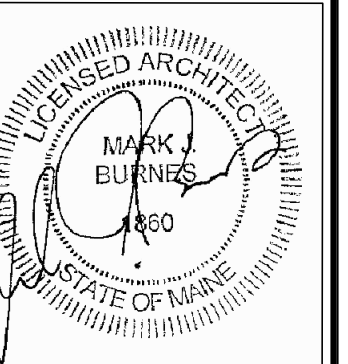

SAGE WELLNESS, LLC
 978 - 980 FOREST AVENUE
 PORTLAND, ME 04103

Drawing Name:

FLOOR PLAN

Scale:

AS NOTED

SHEET

A102

Date:
 AUGUST 18, 2014

PLAN NOTES:

- 1). ALL DOORS ARE TO BE PROVIDED WITH ADAAG COMPLIANT HARDWARE, INCLUDING LEVER DEVICES
- 2). ALL DOORS AND FRAMES SHALL HAVE A FIRE-RATING CONSISTENT WITH THE WALL IN WHICH IT IS PLACED. WALLS WITH FIRE OR SMOKE PROTECTION CHARACTERISTICS SHALL EMPLOY DOORS WITH LIKE CHARACTERISTICS.
- 3). ALL DOOR HARDWARE SHALL INCLUDE LEVER-TYPE LATCH SET, AUTOMATIC CLOSER AND SMOKE SEALS WHEN DOOR . THIS SHALL BE INCORPORATED INTO ALL RATED DOOR OPENINGS.
- 4). LOCATIONS OF LIFE SAFETY AND SIGNAL DEVICES AS MINIMUM QUANTITIES AND LOCATED AS SUCH. FINAL DETERMINATION SHALL BE AS APPROVED BY LOCAL FIRE OFFICIAL REVIEW AND SIGN OFF.
- 5). PROVIDE ADAAG COMPLIANT BRAILLE SIGNAGE PER 2010 ADAAG REGULATIONS, PROVIDE FOR THE FOLLOWING SPACES: EXITS and TOILET ROOMS, MOUNT AT 4'-6" A.F.F.
- 6). INTERIOR AND ADAAG SIGNAGE MAY BE PROVIDED BY WELCH STENCIL COMPANY OF SCARBOROUGH, MAINE. THIS SHALL BE ACCOMPLISHED BY THE USE OF AN ALLOWANCE AND REQUIRE SUBMITTALS FOR ARCHITECT AND OWNER REVIEW AND APPROVAL.
- 7). ALL PENETRATIONS OF FIRE RATED WALLS AND CEILINGS SHALL BE SEALED WITH UL APPROVED FIRE SEALANT AND FIRE STOPPING MATERIALS.
- 8). ALL DIMENSIONS ARE MEASURED FROM CENTERLINE OF STUD WITH THE EXCEPTION OF EXTERIOR WALLS, MILLWORK AND CASEWORK. FINAL DIMENSIONS SHOULD BE DETERMINED BY FIELD MEASUREMENT PRIOR TO FABRICATION AND INSTALLATION OF ALL STOREFRONT, WINDOWS, MILLWORK AND CASEWORK.
- 9). WINDOW TREATMENTS AND OFFICE FURNISHINGS SHALL BE FURNISHED BY OWNER AND REQUIRE COORDINATION OF FURNISHINGS PLAN BY THE CONTRACTOR AND SUB CONTRACTORS.
- 10). ALL NEW PARTITIONS SHALL EXTEND TO THE UNDERSIDE OF THE DECK ABOVE AND CONSIST OF 3-1/2" OR 5-1/2" WOOD FRAMING @ 16" OC AND 5/8" TYPE "X" GWB ON EACH SIDE AND 3-1/2" SOUND ATTENUATION BATT WITHIN. FIRE STOP AND FIRE CAULK ALL JOINTS AND PENETRATIONS IN ALL PARTITIONS PROVIDED WITH FIRE RATINGS.

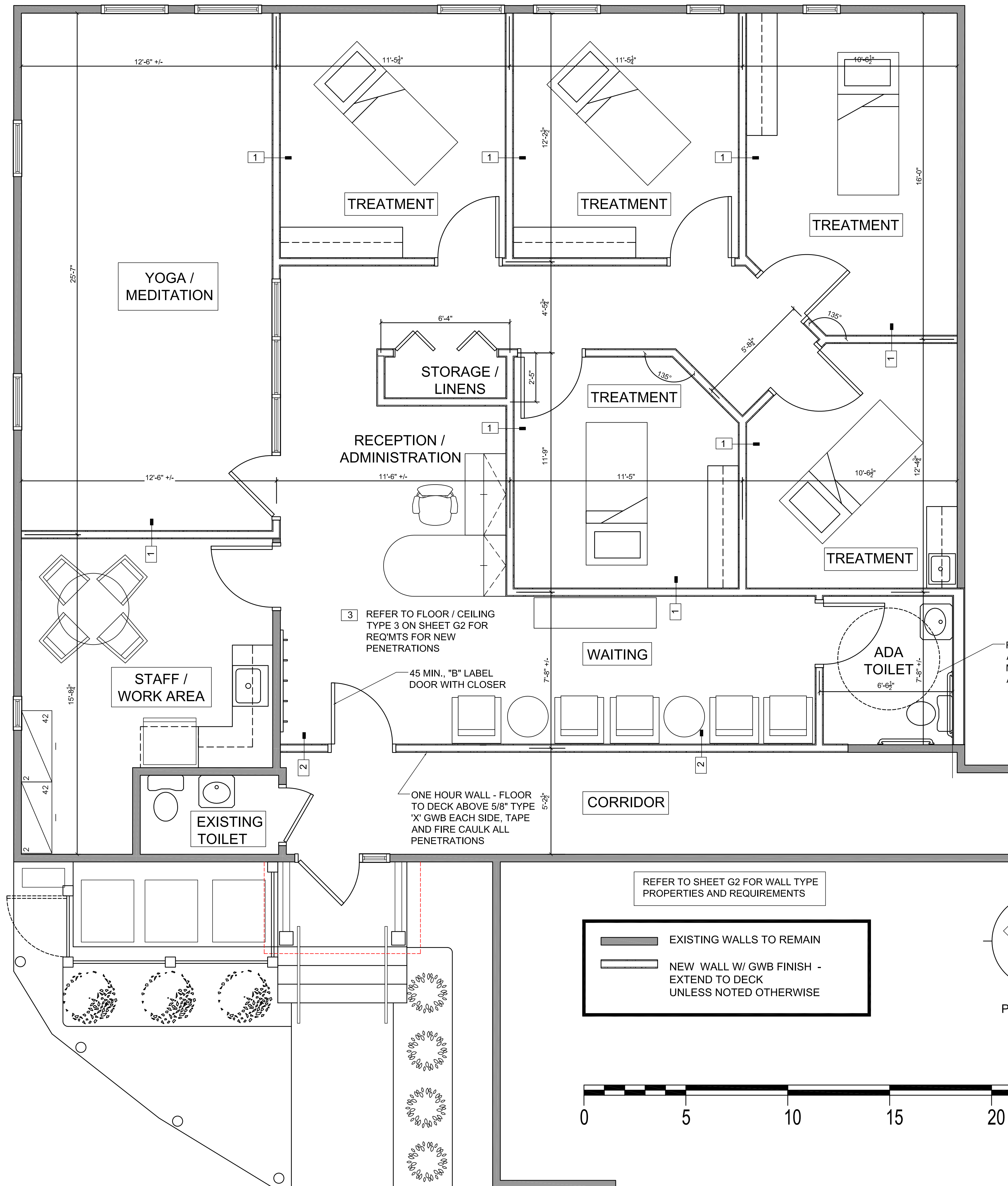

1 FLOOR PLAN
 SCALE: NTS