

GARAGE VIEW

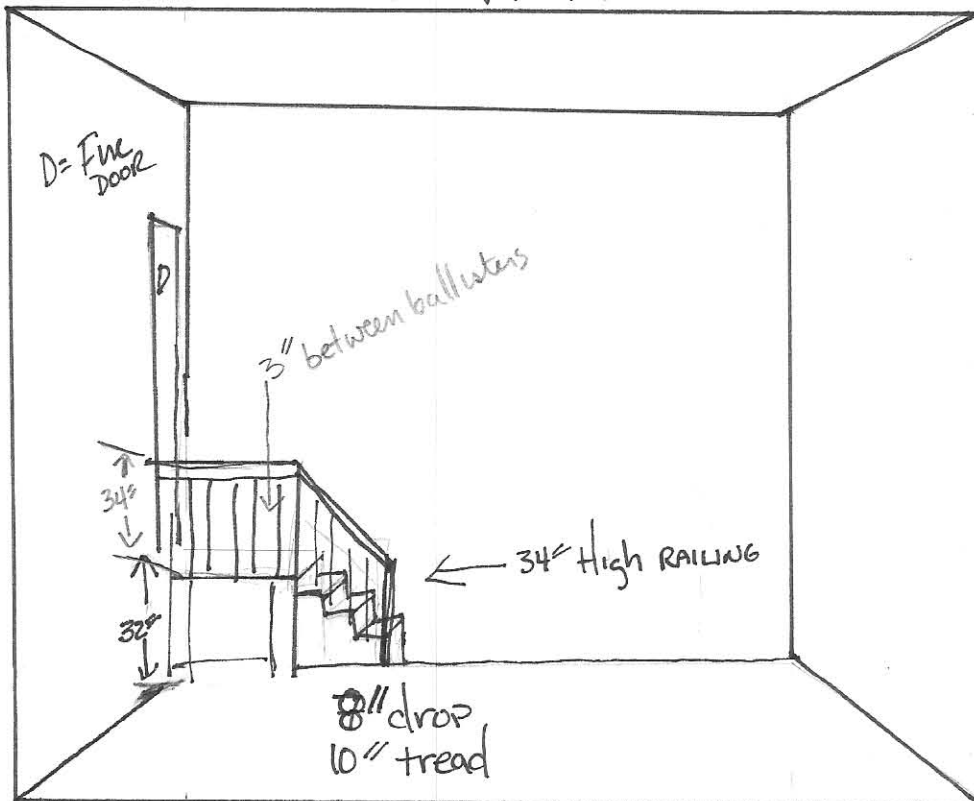

TOP VIEW OF HOUSE

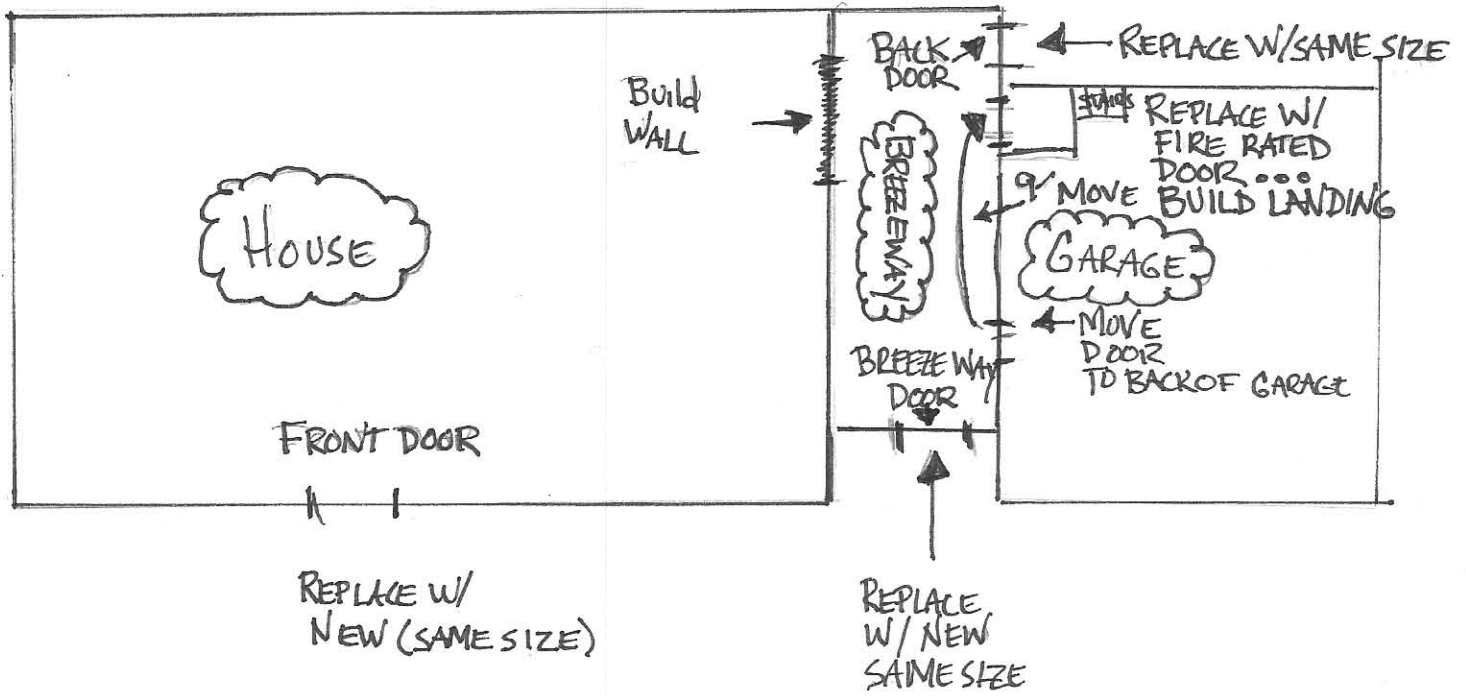

- A = DOORWAY TO KITCHEN (NO CHANGE)
- B = WALL CLOSING OFF DINING ROOM (7' x 7' = 16" o.c. 2x4 studs)
- C = BACK DOOR: REPLACE W/ NEW SAME SIZE
- D = NEW FIRE DOOR TO GARAGE (3.0' DOOR... MOVED 9')
- E = OLD DOOR TO GARAGE (REPLACE W/ WALL)
- F = ALL PANELING REPLACED W/ SHEETROCK

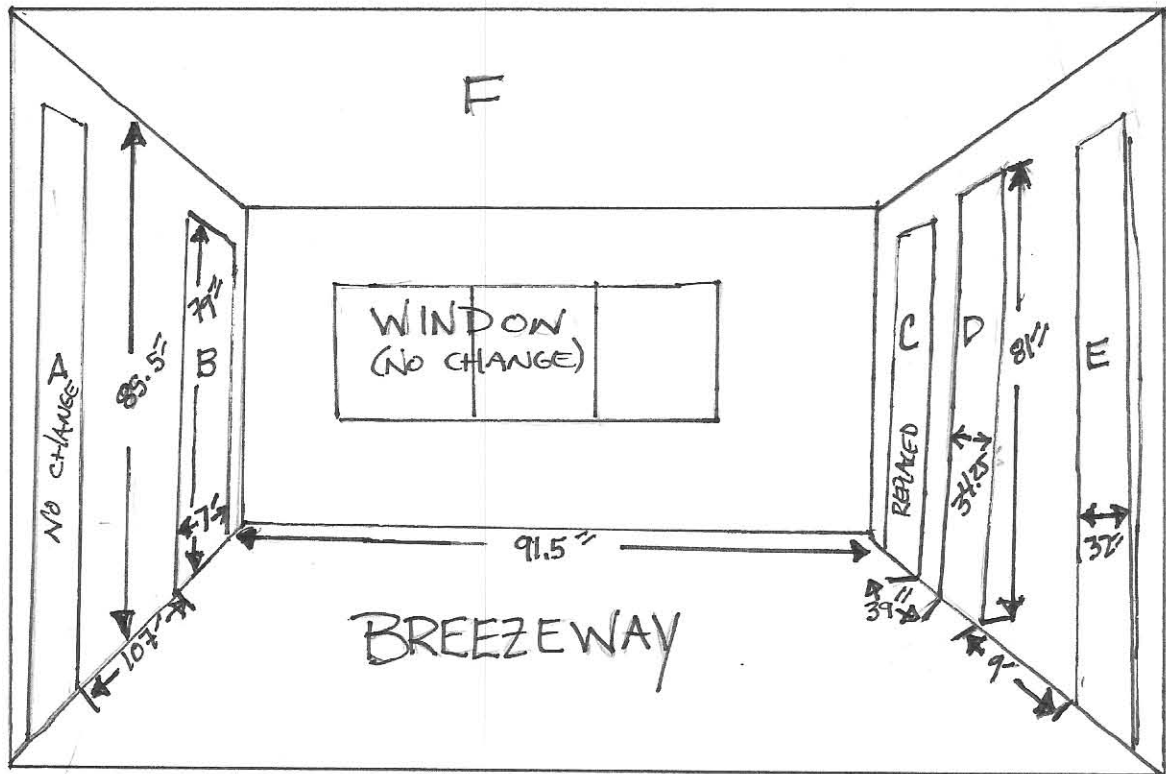

BREEZEWAY VIEW