

Form # P 04

DISPLAY THIS CARD ON PRINCIPAL FRONTAGE OF WORK  
**CITY OF PORTLAND**

Please Read  
Application And  
Notes, If Any,  
Attached

BUILDING PERMIT

PERMIT ISSUED

Permit Number: 100933

AUG 18 2010

This is to certify that LE THUY H & THANH V LE / David Le is/are working

has permission to install a 6' x 8' Premade Shed

City of Portland

AT 269 WALTON ST

CPD 143 A046001

provided that the person or persons, firm or corporation accepting this permit shall comply with all of the provisions of the Statutes of Maine and of the Ordinances of the City of Portland regulating the construction, maintenance and use of buildings and structures, and of the application on file in this department.

Apply to Public Works for street line and grade if nature of work requires such information.

Notification of inspection must be given and written permission procured before this building or part thereof is lathed or otherwise finished-in. 24 HOUR NOTICE IS REQUIRED.

A certificate of occupancy must be procured by owner before this building or part thereof is occupied.

OTHER REQUIRED APPROVALS

Fire Dept. \_\_\_\_\_

Health Dept. \_\_\_\_\_

Appeal Board \_\_\_\_\_

Other \_\_\_\_\_

Department Name

Director - Building & Inspection Services

PENALTY FOR REMOVING THIS CARD

**City of Portland, Maine - Building or Use Permit Application**

389 Congress Street, 04101 Tel: (207) 874-8703, Fax: (207) 874-8716

Permit No: 10-0933	Issue Date:	CBL: 143 A046001
-----------------------	-------------	---------------------

Location of Construction: 269 WALTON ST	Owner Name: LE THUY H & THANH V LE JTS	Owner Address: 21 DEMEREST ST	Phone:
Business Name:	Contractor Name: David Woodworking	Contractor Address: 971 Brighton Ave Portland	Phone 2077742045
Lessee/Buyer's Name	Phone:	Permit Type: Sheds	Zone: R-5

Past Use: Duplex	Proposed Use: Duplex - install a 6' x 8' Premade Shed	Permit Fee: \$30.00	Cost of Work: \$900.00	CEO District: 4
Proposed Project Description: install a 6' x 8' Premade Shed  <i>legal 2 family</i>		FIRE DEPT: <input type="checkbox"/> Approved <input type="checkbox"/> Denied <i>P/A</i> Signature:	INSPECTION: Use Group: <i>R-3/U</i> Type: <i>5B</i> <i>TRC 2003</i> Signature:	

PEDESTRIAN ACTIVITIES DISTRICT (P.A.D.)	
Action: <input type="checkbox"/> Approved <input type="checkbox"/> Approved w/Conditions <input type="checkbox"/> Denied	Signature: _____ Date: _____

Permit Taken By: Idobson	Date Applied For: 07/30/2010	<b>Zoning Approval</b>		
-----------------------------	---------------------------------	------------------------	--	--

- This permit application does not preclude the Applicant(s) from meeting applicable State and Federal Rules.
- Building permits do not include plumbing, septic or electrical work.
- Building permits are void if work is not started within six (6) months of the date of issuance. False information may invalidate a building permit and stop all work..

<b>Special Zone or Reviews</b> <input type="checkbox"/> Shoreland <input type="checkbox"/> Wetland <input type="checkbox"/> Flood Zone <input type="checkbox"/> Subdivision <input type="checkbox"/> Site Plan Maj <input type="checkbox"/> Minor <input type="checkbox"/> MM <input type="checkbox"/> Date: <i>8/12/10</i>	<b>Zoning Appeal</b> <input type="checkbox"/> Variance <input type="checkbox"/> Miscellaneous <input type="checkbox"/> Conditional Use <input type="checkbox"/> Interpretation <input type="checkbox"/> Approved <input type="checkbox"/> Denied Date: _____	<b>Historic Preservation</b> <input checked="" type="checkbox"/> Not in District or Landmark <input type="checkbox"/> Does Not Require Review <input type="checkbox"/> Requires Review <input type="checkbox"/> Approved <input type="checkbox"/> Approved w/Conditions <input type="checkbox"/> Denied Date: _____
--	---	--

**PERMIT ISSUED**

AUG 18 2010

City of Portland

**CERTIFICATION**

I hereby certify that I am the owner of record of the named property, or that the proposed work is authorized by the owner of record and that I have been authorized by the owner to make this application as his authorized agent and I agree to conform to all applicable laws of this jurisdiction. In addition, if a permit for work described in the application is issued, I certify that the code official's authorized representative shall have the authority to enter all areas covered by such permit at any reasonable hour to enforce the provision of the code(s) applicable to such permit.

SIGNATURE OF APPLICANT \_\_\_\_\_ ADDRESS \_\_\_\_\_ DATE \_\_\_\_\_ PHONE \_\_\_\_\_

RESPONSIBLE PERSON IN CHARGE OF WORK, TITLE \_\_\_\_\_ DATE \_\_\_\_\_ PHONE \_\_\_\_\_



# CITY OF PORTLAND, MAINE

Department of Building Inspections

## Original Receipt

July 31, 2010

Received from Thank you

Location of Work 569 Westbrook

Cost of Construction \$ \_\_\_\_\_ Building Fee: \_\_\_\_\_

Permit Fee \$ \_\_\_\_\_ Site Fee: \_\_\_\_\_

Certificate of Occupancy Fee: \_\_\_\_\_

Total: 30.00

Building (B)  Plumbing (P)  Electrical (E)  Site Plan (S)

Other \_\_\_\_\_

CBL: 143 A040

Check #: 322 Total Collected \$ 30.00

**No work is to be started until permit issued.  
Please keep original receipt for your records.**

Taken by: [Signature]

WHITE - Applicant's Copy  
YELLOW - Office Copy  
PINK - Permit Copy

**City of Portland, Maine - Building or Use Permit**

389 Congress Street, 04101 Tel: (207) 874-8703, Fax: (207) 874-8716

Permit No: 10-0933	Date Applied For: 07/30/2010	CBL: 143 A046001
-----------------------	---------------------------------	---------------------

Location of Construction: 269 WALTON ST	Owner Name: LE THUY H & THANH V LE JTS	Owner Address: 21 DEMEREST ST	Phone:
Business Name:	Contractor Name: David Woodworking	Contractor Address: 971 Brighton Ave Portland	Phone (207) 774-2045
Lessee/Buyer's Name	Phone:	Permit Type: Sheds	

Proposed Use: Duplex - install a 6' x 8' Premade Shed	Proposed Project Description: install a 6' x 8' Premade Shed
--	---

**Dept:** Zoning      **Status:** Approved with Conditions      **Reviewer:** Marge Schmuckal      **Approval Date:** 08/12/2010

**Note:** **Ok to Issue:** ✓

- 1) This is NOT an approval for an additional dwelling unit. You SHALL NOT add any additional kitchen equipment including, but not limited to items such as stoves, microwaves, refrigerators, or kitchen sinks, etc. Without special approvals.
- 2) This property shall remain a two family dwelling. Any change of use shall require a separate permit application for review and approval.
- 3) This permit is being approved on the basis of plans submitted and follow up information regarding the setbacks. Any deviations shall require a separate approval before starting that work.

**Dept:** Building      **Status:** Approved      **Reviewer:** Tammy Munson      **Approval Date:** 08/18/2010

**Note:** **Ok to Issue:** ✓

**Comments:**

8/10/2010-mes: the plot plan has no setbacks on it - called the owner and left a message saying that I need the plot plan revised showing what the setbacks will be.

8/12/2010-mes: owner called me back with the shed setbacks - ok to issue

**PERMIT ISSUED**

AUG 18 2010

City of Portland

## **BUILDING PERMIT INSPECTION PROCEDURES**

**Please call 874-8703 or 874-8693 (ONLY )  
or email: [buildinginspections@portlandmaine.gov](mailto:buildinginspections@portlandmaine.gov)**

With the issuance of this permit, the owner, builder or their designee is required to provide adequate notice to the City of Portland Inspection Services for the following inspections. Appointments must be requested 48 to 72 hours in advance of the required inspection. The inspection date will need to be confirmed by this office.

- **Please read the conditions of approval that is attached to this permit!! Contact this office if you have any questions.**
- **Permits expire in 6 months, if the project is not started or ceases for 6 months.**
- **If the inspection requirements are not followed as stated below additional fees may be incurred due to the issuance of a "Stop Work Order" and subsequent release to continue with construction.**

  X   **Building Location Inspection: Prior to pouring concrete or setting precast piers**

  X   **Final inspection required at completion of work.**

**The project cannot move to the next phase prior to the required inspection and approval to continue, REGARDLESS OF THE NOTICE OR CIRCUMSTANCES.**

**IF THE PERMIT REQUIRES A CERTIFICATE OF OCCUPANCY, IT MUST BE PAID FOR AND ISSUED TO THE OWNER OR DESIGNEE BEFORE THE SPACE MAY BE OCCUPIED.**

**PERMIT ISSUED**

**AUG 18 2010**

City of Portland



# General Building Permit Application

If you or the property owner owes real estate or personal property taxes or user charges on any property within the City, payment arrangements must be made before permits of any kind are accepted.

Location/Address of Construction: <u>269-271 Walton St. Portland, Me 04103</u>		
Total Square Footage of Proposed Structure/Area	Square Footage of Lot	Number of Stories
Tax Assessor's Chart, Block & Lot Chart#      Block#      Lot#	Applicant * Name	Telephone:
<u>143      A      046</u>	<u>THANH LE</u>	<u>878-2661</u>
	Address	
	<u>21 Demerest St.</u>	
	City, State & Zip	
	<u>Portland, Me 04103</u>	
Lessee/DBA (If Applicable)	Owner (if different from Applicant)	Cost Of Work: \$
<b>RECEIVED</b>  JUL 30 2010  Dept. of Building Inspections City of Portland Maine	Name	<u>900.00</u>
	Address	C of O Fee: \$
	City, State & Zip	Total Fee: \$ <u>900.00</u>
Current legal use (i.e. single family)	<u>Duplex</u>	Number of Residential Units <u>2</u>
If vacant, what was the previous use?		
Proposed Specific use:	<u>To store lawn mower etc.</u>	<u>30.00</u>
Is property part of a subdivision?	<u>N/A</u>	If yes, please name
Project description:	<u>6 x 8 Shed pre-made. David Woodworking Inc.</u>	
Contractor's name:	<u>971 Brighton Ave.</u>	
Address:	<u>Portland, Me 04102</u>	
City, State & Zip	Telephone:	<u>774-2045</u>
Who should we contact when the permit is ready:	Telephone:	
Mailing address:		

Please submit all of the information outlined on the applicable Checklist. Failure to do so will result in the automatic denial of your permit.

In order to be sure the City fully understands the full scope of the project, the Planning and Development Department may request additional information prior to the issuance of a permit. For further information or to download copies of this form and other applications visit the Inspections Division on-line at [www.portlandmaine.gov](http://www.portlandmaine.gov), or stop by the Inspections Division office, room 315 City Hall or call 874-8703.

I hereby certify that I am the Owner of record of the named property, or that the owner of record authorizes the proposed work and that I have been authorized by the owner to make this application as his/her authorized agent. I agree to conform to all applicable laws of this jurisdiction. In addition, if a permit for work described in this application is issued, I certify that the Code Official's authorized representative shall have the authority to enter all areas covered by this permit at any reasonable hour to enforce the provisions of the codes applicable to this permit.

Signature: \_\_\_\_\_ Date: 7/30/10

This is not a permit; you may not commence ANY work until the permit is issued

They be  
called 8/12/10  
and gave me  
the set back and?

car setback  
is 6'

side setback  
is 10'

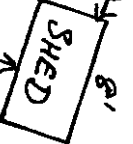

123' ±

PAVED DRIVE

LOT 7

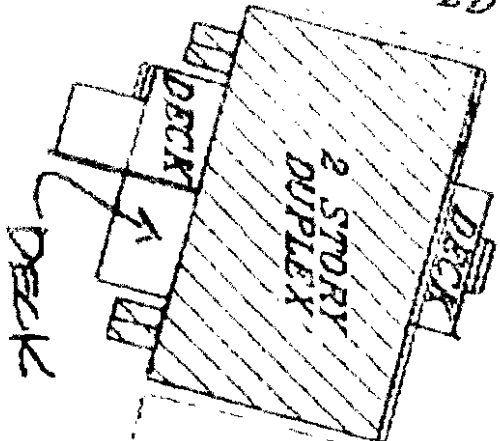

PAVED DRIVE

118' ±

77' ±

WALTON STREET  
TO STEVENS AVENUE  
APPARENT R/W

LOT 6



4144

shall be no closer than 5'  
to side or rear prop. com  
Showing 6' ± 10' of

DECK.

FRONT  
DAVIS WOODWORKING

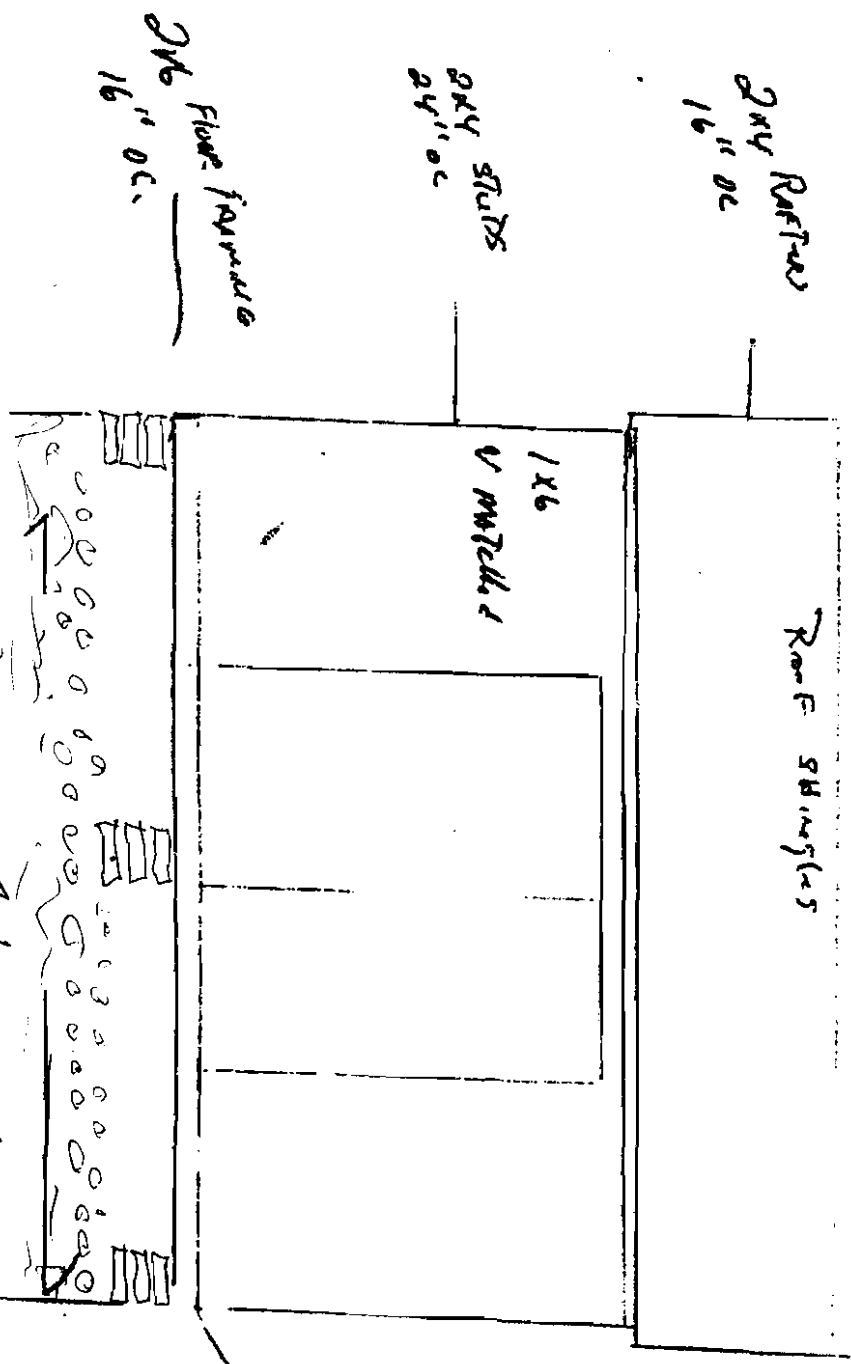

*[Handwritten signature]*