

Cross Sections with Framing Details

Wall construction for all 3 rooms will be 2x4 spaced at 16" on center and inside of walls will be covered in 1/2" sheet rock, with nothing on the outside of the frame. Per previous permit, construction type is 3B.

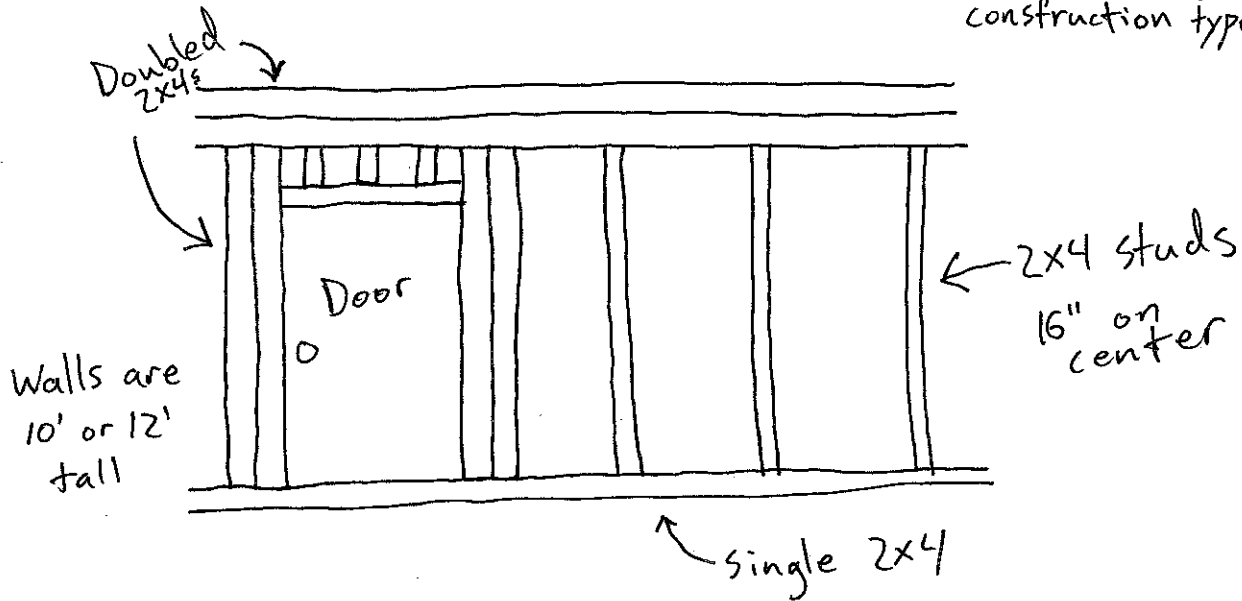

The 2 smaller room's ceilings will be made up of 2x6 joists every 16" on center.

The center beam for the large room will be 4, 2x6s wide that spans the length of 28' and the joist will be 11' on both sides of the beam to the walls. The joists will be spaced 16" on center, with the use of joists hangers and the center beam will be supported with one 4x4 post in the center of the room.

