

approx. 70'

OK under 10%
W/L

MOVE PLUMBING ETC.

- ① Door # 7 - needs to swing out of partition A.
- ② Sprinkled? YES Existing
- ③ Door # 15 change swing

3	8/17/09
2	8/01/09
1	7/21/09

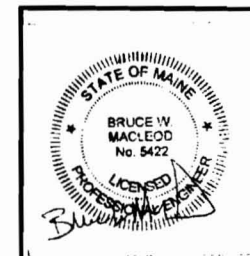

MacLeod
Structural Engineers, PA
404 Main Street Corham, Maine 04038 207.839.0980

DEPARTMENT OF HEALTH AND HUMAN SERVICES
FOREST AVE. PORTLAND, ME.

NEW OFFICE LAYOUT

TITLE: Floor/Furniture Plan

DATE: 7/13/09 DRAWN BY: BMM DRAWING NUMBER:
SCALE: as noted PROJ. NO.: 2009-216 A-1

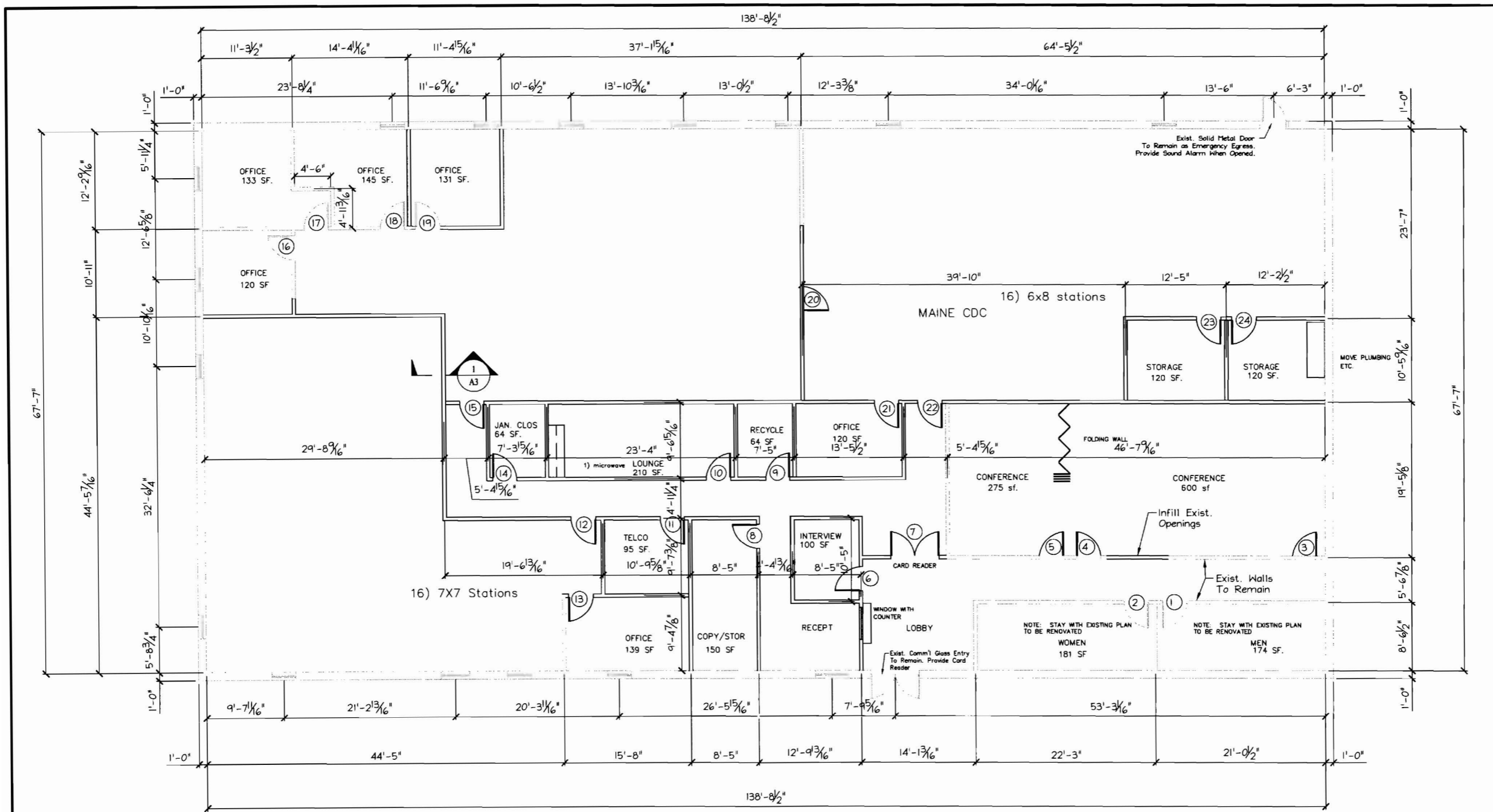

NOTE:
ALL WINDOWS ARE EXISTING, 4'X4'
DOUBLE PANE SLIDERS (CERTAINTED)

138' x 68' = 9384 sq ft = 400 = 23 ft x 35 ft = 800
 DEPARTMENT OF HEALTH AND HUMAN SERVICES
 FOREST AVE
 PORTLAND, ME

- 3 _____
- 2 8/17/09
- 1 8/01/09

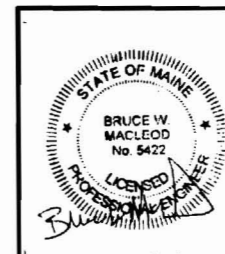

MacLeod Structural Engineers, PA		
404 Main Street Corham, Maine 04038 207.839.0980		
DEPARTMENT OF HEALTH AND HUMAN SERVICES FOREST AVE. PORTLAND, ME.		
NEW OFFICE LAYOUT		
TITLE: DIMENSIONS PLAN		
DATE: 7/13/09	DRAWN BY: BWM	DRAWING NUMBER:
SCALE: as noted	PROJ NO: 2009-216	A-2

DOOR SCHEDULE

DOOR #	SIZE	STYLE	FUNCTION	ROOM NAME	MTRL	
					DOOR	FRAME
1	3070	SOLID	PASSAGE W/ CLOSER	MEN'S RESTROOM	WOOD	HMF
2	3070	SOLID	PASSAGE W/ CLOSER	WOMEN'S RESTROOM	WOOD	HMF
3	3070	1/4 LITE	CLASSROOM	CONFERENCE ROOM	WOOD	HMF
4	3070	1/4 LITE	CLASSROOM	CONFERENCE ROOM	WOOD	HMF
5	3070	1/4 LITE	CLASSROOM	CONFERENCE ROOM	WOOD	HMF
6	3070	1/4 LITE	CLASSROOM	INTERVIEW ROOM	WOOD	HMF
7	6070	(2) FULL LITE	CARD READER	ENTRY/CORRIDOR	WOOD	HMF
8	3070	1/4 LITE	PASSAGE	COPY/STORAGE	WOOD	HMF
9	3070	SOLID	CLASSROOM	RECYCLE	WOOD	HMF
10	3070	FULL LITE	PASSAGE	LOUNGE	WOOD	HMF
11	3070	LOUVER	CARD READER	TELECOM	WOOD	HMF
12	3070	FULL LITE	PASSAGE	CORRIDOR/WORKSTATIONS/ TO REG. OP	WOOD	HMF
13	3070	1/4 LITE	PASSAGE	OFFICE/ IN LIC # REG	WOOD	HMF
14	3070	SOLID	STORE ROOM	JANITOR	WOOD	HMF
15	3070	FULL LITE	PASSAGE	CORRIDOR/WORK STATIONS/ TO REG. OP	WOOD	HMF
16	3070	1/4 LITE	PASSAGE	OFFICE IN REG. OP	WOOD	HMF
17	3070	1/4 LITE	CLASSROOM	OFFICE IN REG. OP	WOOD	HMF
18	3070	1/4 LITE	PASSAGE	OFFICE IN REG. OP	WOOD	HMF
19	3070	1/4 LITE	PASSAGE	OFFICE IN REG. OP	WOOD	HMF
20	3070	FULL LITE	PASSAGE	DOOR INTO CDC FROM REG. OP	WOOD	HMF
21	3070	1/4 LITE	PASSAGE	OFFICE IN CDC	WOOD	HMF
22	3070	FULL LITE	PASSAGE	MAINE CDC/CORRIDOR	WOOD	HMF
23	3070	SOLID	STORE ROOM	CDC STORAGE	WOOD	HMF
24	3070	SOLID	STORE ROOM	CDC STORAGE	WOOD	HMF

NOTES -
 PASSAGE - NO LOCKING
 STORE ROOM - OPEN W/KEY ONLY
 CLASS ROOM - LOCK/UNLOCK W/KEY

NOTE - ALL DOORS TO HAVE LEVER HANDLES OR PANIC HARDWARE, AS APPLICABLE.

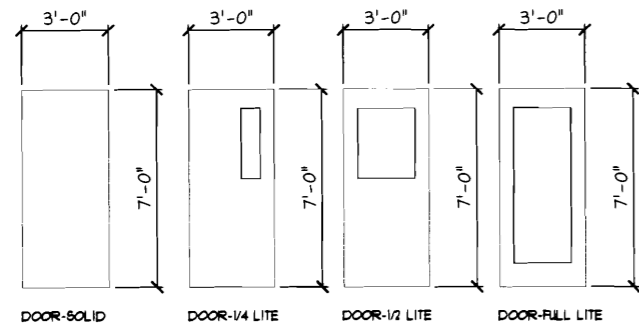

DOOR ELEVATIONS

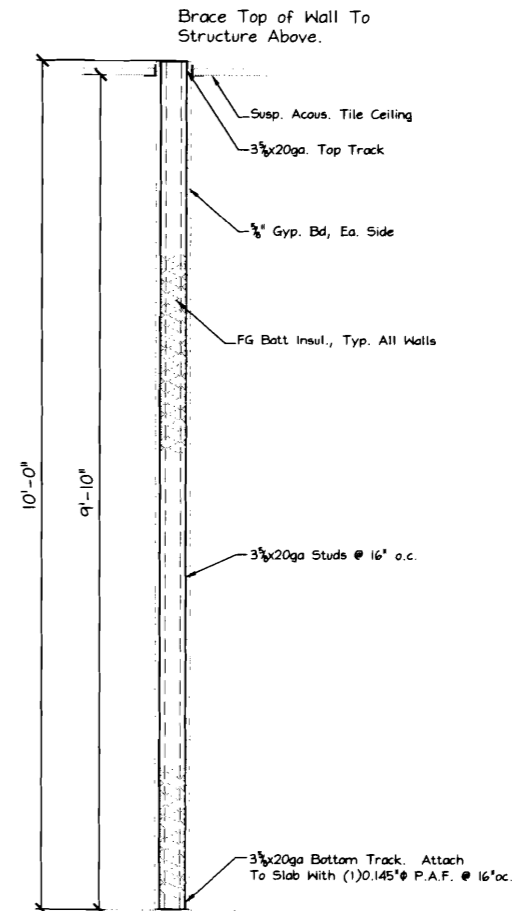

SECTION 1 TYP. INTERIOR WALL SECTION
 SCALE: 3/4" = 1'-0"

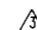
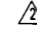
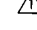
 _____
 _____
 8/17/09 _____

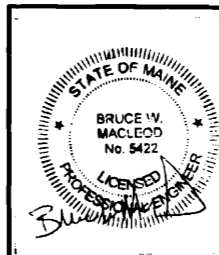

MacLeod Structural Engineers, PA		
404 Main Street Corham, Maine 04038 207.839.0980		
DEPARTMENT OF HEALTH AND HUMAN SERVICES FOREST AVE. PORTLAND, ME.		
NEW OFFICE LAYOUT		
TITLE: DOOR SCHEDULE		
DATE: 7/13/09	DRAWN BY: BWM	DRAWING NUMBER:
SCALE: as noted	PROJ NO: 2009-216	A-3

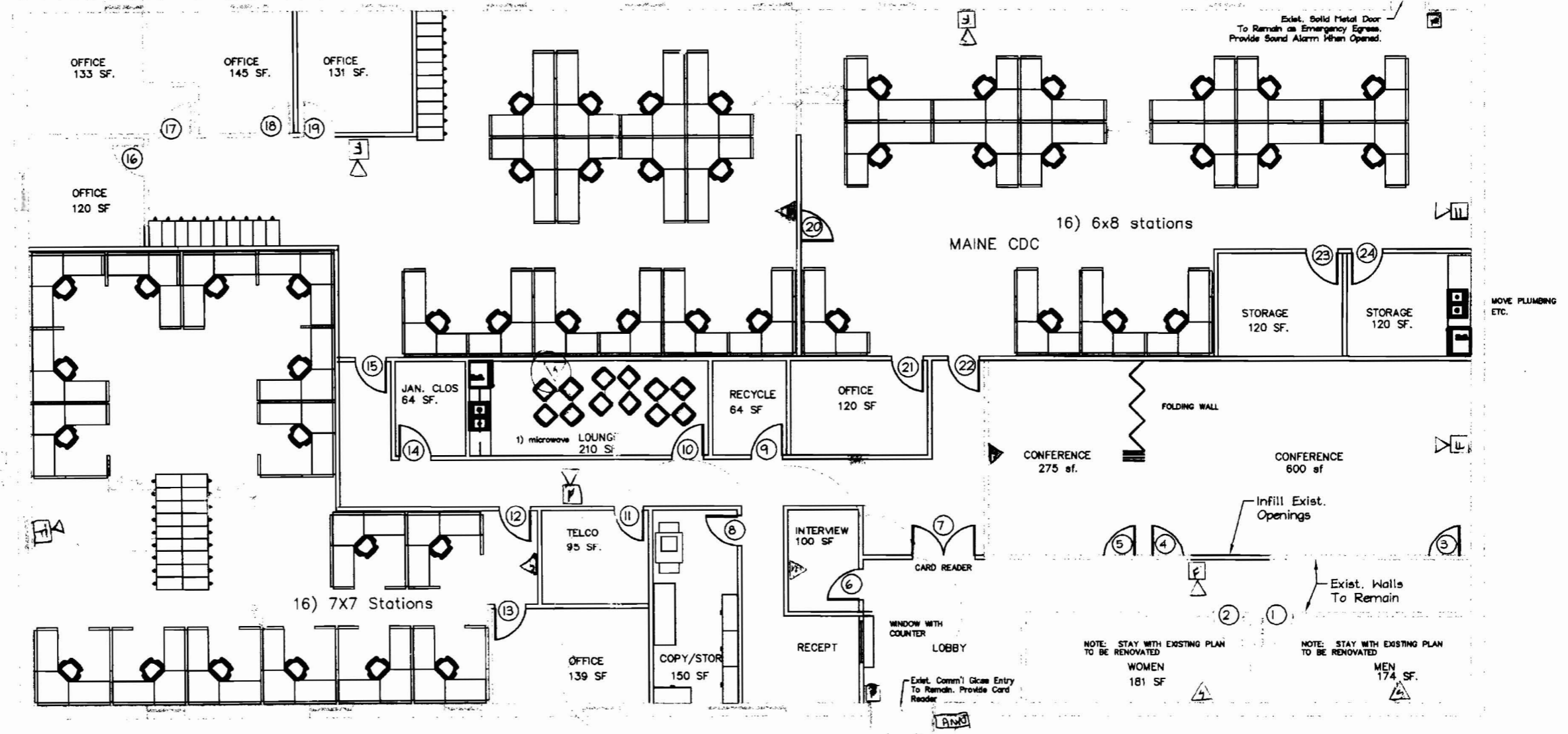

- 1- - Annunciator
- 2- - pull station
- 7- - horn Strobe
- 7- - Strobe

*Spinked
for 28.5.09*

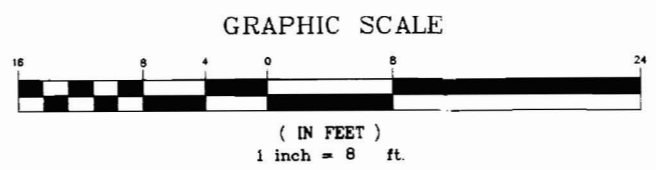

	8/27/09
	8/17/09
	8/01/09
	7/21/09



MacLeod Structural Engineers, PA		
404 Main Street Gorham, Maine 04038 207.838.0980		
DEPARTMENT OF HEALTH AND HUMAN SERVICES FOREST AVE. PORTLAND, ME.		
NEW OFFICE LAYOUT		
TITLE: Floor/Furniture Plan		
DATE: 7/13/09	DRAWN BY: EMM	DRAWING NUMBER:
SCALE: as noted	PROJ NO: 2008-216	A-1