

DISPLAY THIS CARD ON PRINCIPAL FRONTAGE OF WORK CITY OF PORTLAND

Please Read Application And Notes, If Any, Attached

PERMIT

PERMIT ISSUED
 Permit Number: 051518
 NOV 4 2005
 CITY OF PORTLAND

This is to certify that WOJCIK JOSEPH B JR / Applicant/Mark Goodwin
 has permission to Dog Wash/ Side walk sign
 AT 985 FOREST AVE

provided that the person or persons, firm or corporation accepting this permit shall comply with all of the provisions of the Statutes of Maine and of the Ordinances of the City of Portland regulating the construction, maintenance and use of buildings and structures, and of the application on file in this department.

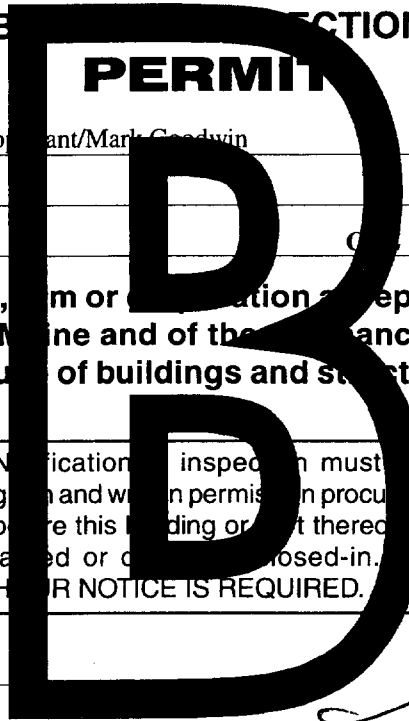

Apply to Public Works for street line and grade if nature of work requires such information.

Notification of inspection must be given and work on permit must be completed before this building or part thereof is occupied or closed-in. 48 HOUR NOTICE IS REQUIRED.

A certificate of occupancy must be procured by owner before this building or part thereof is occupied.

OTHER REQUIRED APPROVALS
 Fire Dept. _____
 Health Dept. _____
 Appeal Board _____
 Other _____
 DepartmentName

[Signature]
 11/3/05
 Director - Building & Inspection Services

PENALTY FOR REMOVING THIS CARD

City of Portland, Maine - Building or Use Permit Application

389 Congress Street, 04101 Tel: (207) 874-8703, Fax: (207) 874-8716

Permit No: 05-1518	Issue Date: NOV 4 2005	CBL: 142 B015001
-----------------------	---------------------------	---------------------

Location of Construction: 985 FOREST AVE	Owner Name: WOJCIK JOSEPH B JR	Owner Address: 2 JUNIPER LN	Phone:
Business Name:	Contractor Name: Applicant/Mark Goodwin	Contractor Address: Portland	Phone:

Lessee/Buyer's Name	Phone:	Permit Type: Signs - Side Walk	Zone: B2
----------------------------	---------------	--	--------------------

Past Use: Commercial/ Dog Wash	Proposed Use: Dog Wash/ Side walk sign	Permit Fee: \$42.00	Cost of Work: \$42.00	CEO District: 4
--	--	-------------------------------	---------------------------------	---------------------------

FIREDEPT: <input type="checkbox"/> Approved <input type="checkbox"/> Denied Signature: <i>N/A</i>	INSPECTION: Use Group: U Type: Sign IBC 2003 Signature: <i>[Signature]</i>
---	--

Proposed Project Description:
Dog Wash/ Side walk sign

PEDESTRIAN ACTIVITIES DISTRICT (P.A.D.)

Action: Approved Approved w/Conditions Denied

Signature: _____ Date: _____

Permit Taken By: Idobson	Date Applied For: 10/18/2005	Zoning Approval	
------------------------------------	--	------------------------	--

<p>1. This permit application does not preclude the Applicant(s) from meeting applicable State and Federal Rules.</p> <p>2. Building permits do not include plumbing, septic or electrical work.</p> <p>3. Building permits are void if work is not started within six (6) months of the date of issuance. False information may invalidate a building permit and stop all work..</p>	<p>Special Zone or Reviews</p> <p><input type="checkbox"/> Shoreland</p> <p><input type="checkbox"/> Wetland</p> <p><input type="checkbox"/> Flood Zone</p> <p><input type="checkbox"/> Subdivision</p> <p><input type="checkbox"/> Site Plan</p> <p>Maj <input type="checkbox"/> Minor <input type="checkbox"/> MM <input type="checkbox"/></p> <p>OK Date: 10/28/05 <i>[Signature]</i></p>	<p>Zoning Appeal</p> <p><input type="checkbox"/> Variance</p> <p><input type="checkbox"/> Miscellaneous</p> <p><input type="checkbox"/> Conditional Use</p> <p><input type="checkbox"/> Interpretation</p> <p><input type="checkbox"/> Approved</p> <p><input type="checkbox"/> Denied</p> <p>Date: _____</p>	<p>Historic Preservation</p> <p><input checked="" type="checkbox"/> Not in District or Landmark</p> <p><input type="checkbox"/> Does Not Require Review</p> <p><input type="checkbox"/> Requires Review</p> <p><input type="checkbox"/> Approved</p> <p><input type="checkbox"/> Approved w/Conditions</p> <p><input type="checkbox"/> Denied</p> <p><i>AGM</i> Date: _____</p>
---	---	--	--

CERTIFICATION

I hereby certify that I am the owner of record of the named property, or that the proposed work is authorized by the owner of record and that I have been authorized by the owner to make this application as his authorized agent and I agree to conform to all applicable laws of this jurisdiction. In addition, if a permit for work described in the application is issued, I certify that the code official's authorized representative shall have the authority to enter all areas covered by such permit at any reasonable hour to enforce the provision of the code(s) applicable to such permit.

SIGNATURE OF APPLICANT	ADDRESS	DATE	PHONE
RESPONSIBLE PERSON IN CHARGE OF WORK, TITLE		DATE	PHONE

City of Portland, Maine - Building or Use Permit

389 Congress Street, 04101 Tel: (207) 874-8703, Fax: (207) 874-8716

Permit No: 05-1518	Date Applied For: 10/18/2005	CBL: 142 B015001
------------------------------	--	----------------------------

Location of Construction: 985 FOREST AVE	Owner Name: WOJCIK JOSEPH B JR	Owner Address: 2 JUNIPER LN	Phone:
Business Name:	Contractor Name: Applicant/Mark Goodwin	Contractor Address: Portland	Phone:
Lessee/Buyer's Name	Phone:	Permit Type: Signs - Side Walk	

Proposed Use: Dog Wash/ Side walk sign	Proposed Project Description: Dog Wash/ Side walk sign
--	--

Dept: Zoning **Status:** Approved **Reviewer:** Ann Machado **Approval Date:** 10/28/2005
Note: **Ok to Issue:**

Dept: Building **Status:** Approved **Reviewer:** Tammy Munson **Approval Date:** 11/03/2005
Note: **Ok to Issue:**



Signage/Awning Permit Application

If you or the property owner owes real estate or personal property taxes or user charges on any property within the City, payment arrangements must be made before permits of any kind are accepted.

Total Square Footage of Proposed Structure 6		Square Footage of Lot
142 B015 001		773-4206
Lessee/Buyer's Name (If Applicable) PORTLAND DOG WASH	Applicant name, address & telephone: PORTLAND DOG WASH (MARK GOODWIN) 981 FOREST AVE 04103 (207) 797-7082	Total s.f. of signage x \$2.00 Per s.f. plus \$30.00/\$65.00 For H.D. signage= Total Fee: \$ 42.00 Awning Fee= cost of work Total Fee: \$ 42.00
Current Specific use: <u>SELF-SERVE DOG WASH / PET SUPPLY - RETAIL</u>		
If vacant, what was prior use: <u>NA</u>		
How long has it been vacant? <u>NA</u>		
Proposed Use: <u>SAME AS CURRENT/NA</u>		
Project Description: <u>SIDEWALK SPRINGER MESSAGE BOARD SIGN BY JOSEPH STRAHL COMPANY, INC. PLEASE SEE ATTACHED AND SPECIFICATIONS</u>		
Contractor's name, address & telephone:		
Who should we contact when the permit is ready: <u>MARK GOODWIN</u>		
Mailing address: <u>981 FOREST AVE PORTLAND 04103</u>		
Phone: <u>(207) 797-7082 or (207) 415-5707</u>		

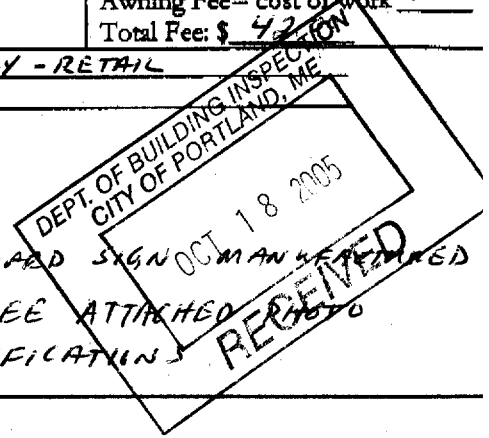

Please submit all of the information outlined in the Sign/Awning Application Checklist. Failure to do so will result in the automatic denial of your permit.

In order to be sure the City fully understands the full scope of the project, the Planning and Development Department may request additional information prior to the issuance of a permit. For further information visit us on-line at www.portlandmaine.gov, stop by the Building Inspections office, room 315 City Hall or call 874-8703.

I hereby certify that I am the Owner of record of the named property, or that the owner of record authorizes the proposed work and that I have been authorized by the owner to make this application as his/her authorized agent. I agree to conform to all applicable laws of this jurisdiction. In addition, if a permit for work described in this application is issued, I certify that the Code Official's authorized representative shall have the authority to enter all areas covered by this permit at any reasonable hour to enforce the provisions of the codes applicable to this permit.

Signature of applicant <i>Mark Goodwin</i>	Date: 10/18/05
--	-----------------------

This is not a permit; you may not commence ANY work until the permit is issued.



Signage/Awning Pre-Application Questionnaire

Please complete all of the following information.

Address: 981 FOREST AVE. Zone: B2
CBL: 172 3015 001

Single Tenant Lot? Yes No Multi Tenant Lot? Yes No

Tenant/allocated building space frontage (feet): Length: 35 Height 1.5 = 52.5

Information on proposed sign(s): SIDEWALK SIGN

Freestanding (e.g., pole) sign? Yes No Dimensions proposed: 24" x 36" x 1/2"
Bldg. wall sign? (attached to bldg) Yes No Dimensions proposed: _____

Information on already existing and permitted sign(s):

Freestanding (e.g., pole) sign? Yes No Dimensions proposed: _____
Bldg. wall sign? (attached to bldg) Yes No Dimensions proposed: 4' x 4' x 1"
Awning? Yes No Dimensions: _____
Lot frontage (feet): 171'

~~Awning? Yes No Is awning backlit? Yes No
Height of awning: _____ Length of awning: _____ Depth: _____
Is there any communication, message, trademark or symbol on it? Yes No
If yes, total s.f. of panels w/communications, message, trademark or symbol: _____ s.f.~~

A site sketch and building sketch showing exactly where existing and new signage is located must be provided. Sketcher and/or: pictures of proposed signage are also required.

Signature of applicant: [Signature] Date: 10/18/05

~For office use only~

max ht. 40"
min ht 35"

ACORD™ CERTIFICATE OF LIABILITY INSURANCE		DATE (MM/DD/YYYY) 10/18/2005
PRODUCER Roux Insurance Services, Inc. P.O. Box 1805 954 Lisbon Street Lewiston, ME 04241-1805	THIS CERTIFICATE IS ISSUED AS A MATTER OF INFORMATION ONLY AND CONFERS NO RIGHTS UPON THE CERTIFICATE HOLDER. THIS CERTIFICATE DOES NOT AMEND, EXTEND OR ALTER THE COVERAGE AFFORDED BY THE POLICIES BELOW.	
INSURED Portland Dog Wash Mark Goodwin & Greg Goodwin 981 Forest Ave Portland, ME 04103	INSURERS AFFORDING COVERAGE INSURER A: NORTH EAST INS CO / PRESERVER INSURER B: INSURER C: INSURER D:	NAIC # 24007

COVERAGES

THE POLICIES OF INSURANCE LISTED BELOW HAVE BEEN ISSUED TO THE INSURED NAMED ABOVE FOR THE POLICY PERIOD INDICATED. NOTWITHSTANDING ANY REQUIREMENT, TERM OR CONDITION OF ANY CONTRACT OR OTHER DOCUMENT WITH RESPECT TO WHICH THIS CERTIFICATE MAY BE ISSUED OR MAY PERTAIN, THE INSURANCE AFFORDED BY THE POLICIES DESCRIBED HEREIN IS SUBJECT TO ALL THE TERMS, EXCLUSIONS AND CONDITIONS OF SUCH POLICIES. AGGREGATE LIMITS SHOWN MAY HAVE BEEN REDUCED BY PAID CLAIMS.

SR	ADD'L TR	TYPE OF INSURANCE	POLICY NUMBER	POLICY EFFECTIVE DATE (MM/DD/YY)	POLICY EXPIRATION DATE (MM/DD/YY)	LIMITS
A	X	GENERAL LIABILITY <input checked="" type="checkbox"/> COMMERCIAL SERVICE/PRODUCTS <input type="checkbox"/> CLAIMS MADE <input checked="" type="checkbox"/> OCCUR GEN'L AGGREGATE LIMIT APPLIES PER: <input checked="" type="checkbox"/> POLICY <input type="checkbox"/> PROJECT <input type="checkbox"/> LOC	77180003985	03/30/05	03/30/06	EACH OCCURRENCE \$ 1,000,000 DAMAGE TO RENTED PREMISES (Ea occurrence) \$ 100,000 MED EXP (Any one person) \$ 5,000 PERSONAL & ADV INJURY \$ 1,000,000 GENERAL AGGREGATE \$ 2,000,000 PRODUCTS - COMP/OP AGG \$ 1,000,000
		AUTOMOBILE LIABILITY <input type="checkbox"/> ANY AUTO <input type="checkbox"/> ALL OWNED AUTOS <input type="checkbox"/> SCHEDULED AUTOS <input type="checkbox"/> HIRED AUTOS <input type="checkbox"/> NON-OWNED AUTOS				COMBINED SINGLE LIMIT (Ea accident) \$ BODILY INJURY (Per person) \$ BODILY INJURY (Per accident) \$ (Per accident) \$
		GARAGE LIABILITY <input type="checkbox"/> ANY AUTO				AUTO ONLY - EA ACCIDENT \$ OTHER THAN EA ACC AGG \$ AUTO ONLY \$
		EXCESS/UMBRELLA LIABILITY <input type="checkbox"/> OCCUR <input type="checkbox"/> CLAIMS MADE DEDUCTIBLE \$ RETENTION \$				EACH OCCURRENCE \$ AGGREGATE \$ \$ \$
		WORKERS COMPENSATION AND EMPLOYERS' LIABILITY ANY PROPRIETOR/PARTNER/EXECUTIVE OFFICER/MEMBER EXCLUDED? If yes, describe under SPECIAL PROVISIONS below				WC STATUTORY LIMITS OW-ER \$ EL EACH ACCIDENT \$ EL DISEASE-EAEMPLOYEE \$ EL DISEASE - POLICY LIMIT \$
		OTHER				

DESCRIPTION OF OPERATIONS / LOCATIONS / VEHICLES / EXCLUSIONS ADDED BY ENDORSEMENT / SPECIAL PROVISIONS

Certificate Holder is named as an additional insured.

CERTIFICATE HOLDER

City of Portland
 Dept of Planning & Dev Inspection Ser Div
 389 Congress St. Rm 315
 Portland, ME 04101

CANCELLATION

SHOULD ANY OF THE ABOVE DESCRIBED POLICIES BE CANCELLED BEFORE THE EXPIRATION DATE THEREOF, THE ISSUING INSURER WILL ENDEAVOR TO MAIL 10 DAYS WRITTEN NOTICE TO THE CERTIFICATE HOLDER NAMED TO THE LEFT. BUT FAILURE TO DO SO SHALL IMPOSE NO OBLIGATION OR LIABILITY OF ANY KIND UPON THE INSURER, ITS AGENTS OR REPRESENTATIVES.

AUTHORIZED REPRESENTATIVE

Pamela Edwards

Attn: Mark

WRITTEN CONSENT AND AGREEMENT RELATING TO A CERTAIN SIGN-OR AWNING PROPOSED TO BE ERECTED ON A BUILDING AT 977 FOREST AVE IN PORTLAND, MAINE JOL WOJCIK being the owner of the premises at 977 FOREST AVE in Portland, Maine hereby gives consent to the erection of a certain sign owned by ISLAND DOG U— over the sidewalk or on the building from said premises as described in application to the Division of Inspection Services of Portland, Maine for a permit to cover the erection of said sign:

And in consideration of the issuance of said permit, PORTLAND DOG WASH IT owner of said premises, in event said sign shall cease to serve the purpose for which it was erected or shall become dangerous and in event the owner of said sign shall fail to remove said sign or make it permanently safe in case the sign still serves the purpose for which it was erected, hereby agrees for himself or itself, for his heirs, its successors, and his or its assigns, to completely remove said sign in such condition and of order from him to remove it.

In Witness where JOL WOJCIK owner of said premises has signed this consent and agreement this 5th day of May 19 2004

J.S. Dyala
Owner's signature

[Signature]
Lessee's signature

**Sidewalk Springer Message Board Sign
Model SPG-MB**

- **1 - 24" x 36" x 1/2" (600 x 900 x 10mm) blank White sign face with letter tracks on both sides**
 - **1- Black Sign Base (18" x 24" x 4")**
 - **2 - Heavy duty galvanized spring assemblies**
 - **4 - No slide feet**
 - **1 - Set assembly hardware**

Proposed Sign Location



Existing Signage and Viewshed





PORTLAND DOG WASH

"Self-Service Washing and Grooming"

**SIGN
INCREASE
YOUR
SALES**

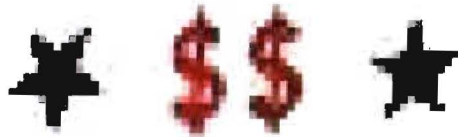

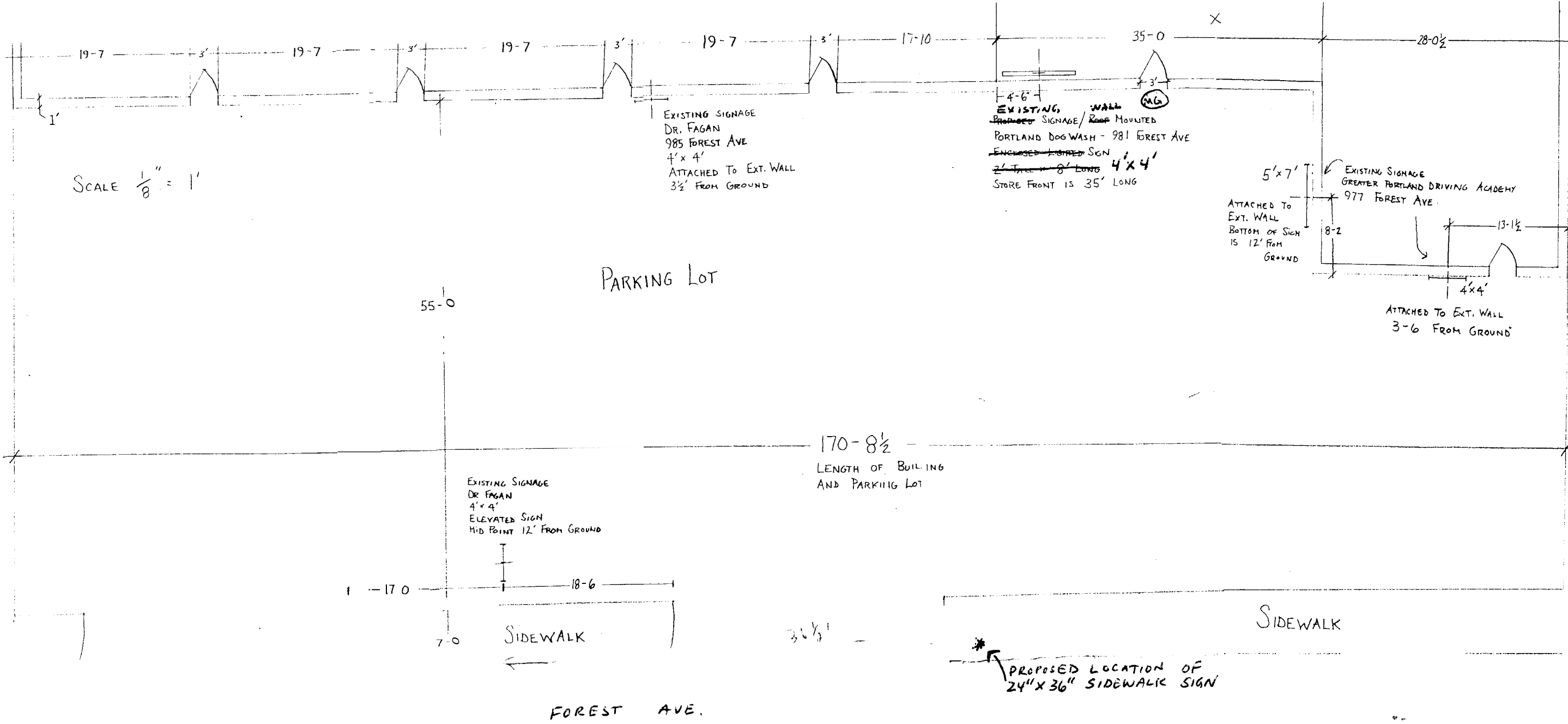



CITY OF PORTLAND, MAINE

Department of Building Inspections

12.18 20 05

Received from Portland Dog Wash

Location of Work 981 Forest Ave.

Cost of Construction \$ _____

Permit Fee \$ 400.00

Building (IL) _____ Plumbing (IS) _____ Electrical (I2) _____ Site Plan (U2) _____

Other Sign

CBL: 142 B 75

Check #: 285

Total Collected \$ 400.00

THIS IS NOT A PERMIT

No work is to be started until PERMIT CARD is actually posted upon the premises. Acceptance of fee is no guarantee that permit will be granted. PRESERVE THIS RECEIPT. In case permit cannot be granted the amount of the fee will be refunded upon return of the receipt less \$10.00 or 10% whichever is greater.

WHITE - Applicant's Copy
YELLOW - Office Copy
PINK - Permit Copy