

DISPLAY THIS CARD ON PRINCIPAL FRONTAGE OF WORK

CITY OF PORTLAND

DEPARTMENT OF BUILDING INSPECTION

PERMIT

PERMIT ISSUED

Permit Number: 050954

AUG 26 2005

CITY OF PORTLAND

Please Read Application And Notes, If Any, Attached

This is to certify that Flanagan James E Jr &/Owner has permission to add windows to create family room in existing storage area AT 171 Walton St

provided that the person or persons, firm or corporation accepting this permit shall comply with all of the provisions of the Statutes of Maine and of the ordinances of the City of Portland regulating the construction, maintenance and use of buildings and structures, and of the application on file in this department.

Apply to Public Works for street line and grade if nature of work requires such information.

Notification of inspection must be given and written permission procured before this building or part thereof is altered or occupied. 24 HOUR NOTICE IS REQUIRED.

A certificate of occupancy must be procured by owner before this building or part thereof is occupied.

OTHER REQUIRED APPROVALS

Fire Dept. Health Dept. Appeal Board Other Department Name

Signature: JMB 8/22/05 Director - Building & Inspection Services

PENALTY FOR REMOVING THIS CARD

**City of Portland, Maine - Building or Use Permit Application**

389 Congress Street, 04101 Tel: (207) 874-8703, Fax: (207) 874-8716

Permit No: 05-0951	Issue Date: AUG 25 2005	PERMIT ISSUED	QBL: 142 B012001
Location of Construction: 171 Walton St	Owner Name: Flanagan James E Jr &	Owner Address: 171 Walton St	Phone: 615-1625
Business Name:	Contractor Name: Owner	Contractor Address: Portland	Phone: CITY OF PORTLAND
Lessee/Buyer's Name	Phone:	Permit Type: Additions - Dwellings	Zone: B-2

Past Use: single family home	Proposed Use: Single Family Home/ add windows to create family room in existing storage area	Permit Fee: \$39.00	Cost of Work: \$2,000.00	CEO District: 4
		FIRE DEPT: <input type="checkbox"/> Approved <input type="checkbox"/> Denied	INSPECTION: Use Group: R-3 Type: SB IRC-2003	
		Signature:	Signature: <i>[Signature]</i>	
Action: <input type="checkbox"/> Approved <input type="checkbox"/> Approved w/Conditions <input type="checkbox"/> Denied				
Signature: _____ Date: _____				

Permit Taken By: Idobson	Date Applied For: 07/12/2005	<b>Zoning Approval</b>		
-----------------------------	---------------------------------	------------------------	--	--

<p>1. This permit application does not preclude the Applicant(s) from meeting applicable State and Federal Rules.</p> <p>2. Building permits do not include plumbing, septic or electrical work.</p> <p>3. Building permits are void if work is not started within six (6) months of the date of issuance. False information may invalidate a building permit and stop all work..</p>	<p><b>Special Zone or Reviews</b></p> <input type="checkbox"/> Shoreland <input type="checkbox"/> Wetland <input type="checkbox"/> Flood Zone <input type="checkbox"/> Subdivision <input type="checkbox"/> Site Plan  Maj <input type="checkbox"/> Minor <input type="checkbox"/> MM <input type="checkbox"/> Date: <i>JMB 8/22/05</i>	<p><b>Zoning Appeal</b></p> <input type="checkbox"/> Variance <input type="checkbox"/> Miscellaneous <input type="checkbox"/> Conditional Use <input checked="" type="checkbox"/> Interpretation <input type="checkbox"/> Approved <input type="checkbox"/> Denied  Date: _____	<p><b>Historic Preservation</b></p> <input checked="" type="checkbox"/> Not in District or Landmark <input type="checkbox"/> Does Not Require Review <input type="checkbox"/> Requires Review <input type="checkbox"/> Approved <input type="checkbox"/> Approved w/Conditions <input type="checkbox"/> Denied  Date: <i>JMB</i>
---	--	--	---

**CERTIFICATION**

I hereby certify that I am the owner of record of the named property, or that the proposed work is authorized by the owner of record and that I have been authorized by the owner to make this application as his authorized agent and I agree to conform to all applicable laws of this jurisdiction. In addition, if a permit for work described in the application is issued, I certify that the code official's authorized representative shall have the authority to enter all areas covered by such permit at any reasonable hour to enforce the provision of the code(s) applicable to such permit.

SIGNATURE OF APPLICANT	ADDRESS	DATE	PHONE
RESPONSIBLE PERSON IN CHARGE OF WORK, TITLE		DATE	PHONE

**City of Portland, Maine - Building or Use Permit**

389 Congress Street, 04101 Tel: (207) 874-8703, Fax: (207) 874-8716

<b>Permit No:</b> 05-0951	<b>Date Applied For:</b> 07/12/2005	<b>CBL:</b> 142 B012001
------------------------------	--	----------------------------

<b>Location of Construction:</b> 171 Walton St	<b>Owner Name:</b> Flanagan James E Jr &	<b>Owner Address:</b> 171 Walton St	<b>Phone:</b>
<b>Business Name:</b>	<b>Contractor Name:</b> Owner	<b>Contractor Address:</b> Portland	<b>Phone:</b>
<b>Lessee/Buyer's Name</b>	<b>Phone:</b>	<b>Permit Type:</b> Alterations - Dwellings	

<b>Proposed Use:</b> Single Family Home/ add windows to create family room in existing storage area	<b>Proposed Project Description:</b> add windows to create family room in existing storage area
--	--

**Dept:** Zoning      **Status:** Approved      **Reviewer:** Jeanine Bourke      **Approval Date:** 08/22/2005  
**Note:**      **Ok to Issue:**

**Dept:** Building      **Status:** Approved      **Reviewer:** Peter Merrow      **Approval Date:** 08/22/2005  
**Note:** Existing structure. 2x12 floor joists, 4x6 carring beam, doubled 2x12 girders on sona tubes.      **Ok to Issue:**

1) Permit approved based on **the** plans submitted and reviewed w/owner/contractor, with additional information as agreed on and as noted on plans.



# Residential Building Permit Application

If you or the property owner owes real estate or personal property taxes or user charges on any property within the City, payment arrangements must be made before permits of any kind are accepted.

Total Square Footage of Proposed Structure		Square Footage of Lot <u>2,2867</u>	
Tax Assessor's Chart, Block & Lot Chart# <u>42</u> Block# <u>B</u> Lot# <u>12</u>	Owner: <u>James Flanagan</u> <u>Carolyn Stephens</u>		Telephone: <u>878-2116</u>
Lessee/Buyer's Name (If Applicable)	Applicant name, address & telephone: <u>James Flanagan</u> <u>171 Walton St 04103</u> <u>878-8775</u>		Cost Of Work: \$ <u>2000.00</u> Fee: \$ <u>39<sup>00</sup>/<sub>100</sub></u>
Current Specific use: <u>Storage</u>			
Proposed Specific use: <u>Family Room</u>			
Project description: <u>Install one Double Hung window (2'11 1/2" x 4'8 1/2") and two awning windows (2'11 5/16" x 1'5") and (2'0 1/8" x 1'5")</u>			
Contractor's name, address & telephone:			
Who should we contact when the permit is ready: <u>James Flanagan</u>			
Mailing address: <u>171 Walton St</u> <u>Portland</u> <u>04103</u>			
Phone: <u>878-8775</u>			

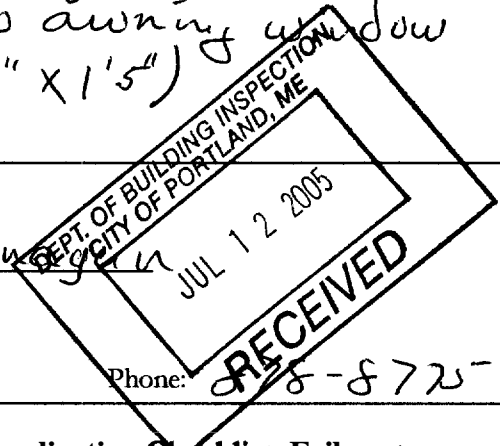

Please submit all of the information outlined in the Residential Application Checklist. Failure to do so will result in the automatic denial of your permit.

At the discretion of the Planning and Development Department, additional information may be required prior to permit approval. For further information stop by the Building Inspections office, room 315 City Hall or call 8748703.

I hereby certify that I am the Owner of record of the named property, or that the owner of record authorizes the proposed work and that I have been authorized by the owner to make this application as his/her authorized agent. I agree to conform to all applicable laws of this jurisdiction. In addition, if a permit for work described in this application is issued, I certify that the Code Official's authorized representative shall have the authority to enter all areas covered by this permit at any reasonable hour to enforce the provisions of the codes applicable to this permit.

Signature of applicant: <u>[Signature]</u>	Date: <u>7-12-05</u>
--	----------------------

Permit Fee: ~~\$30.00~~ for the first \$1000.00 Construction Cost, \$9.00 per additional \$1000.00 cost

**This is not a Permit; you may not commence any work until the Permit is issued.**

This page contains a detailed description of the Parcel ID you selected. Press the **New Search** button at the bottom of the screen to submit a new query.

### Current Owner Information

**Card Number 1 of 1**  
**Parcel ID** 142 B012001  
**Location** 171 WALTON ST  
**Land Use** SINGLE FAMILY

**Owner Address** FLANAGAN JAMES E JR & CAROLYN M STEPHENS JTS  
 171 WALTON ST  
 PORTLAND ME 04103

**Book/Page** 11472/267  
**Legal** 142-B-12  
 WALTON ST 157-169  
 22867 SF

### Current Valuation Information

<b>Land</b>	<b>Building</b>	<b>Total</b>
\$32,030	\$66,360	\$98,390

### New Estimated Valuation Information

<b>Land</b>	<b>Building</b>	<b>Total</b>	<b>Phase-In Value</b>
\$75,800	\$104,300	\$180,100	\$139,245

### Property Information

<b>Pear Built</b> 1930	<b>Style</b> Bungalow	<b>Story Height</b> 1	<b>Sq. Ft.</b> 1302	<b>Total Acres</b> 0.525		
<b>Bedrooms</b> 3	<b>Full Baths</b> 1	<b>Half Baths</b>	<b>Total Rooms</b> 6	<b>Attic</b> Full Finsh	<b>Basement</b> Full	

### Outbuildings

<b>Type</b>	<b>Quantity</b>	<b>Year Built</b>	<b>Size</b>	<b>Grade</b>	<b>Condition</b>
GARAGE-WD/CB	1	1930	28X32	B	A
SHED-FRAME	1	1930	12x20	D	A

### Sales Information

<b>Date</b> 06/01/1994	<b>Type</b> LAND + BLDING	<b>Price</b> \$82,000	<b>Book/Page</b> 11472-267
---------------------------	------------------------------	--------------------------	-------------------------------

### Picture and Sketch

**Picture**      **Sketch**      **Tax Map**

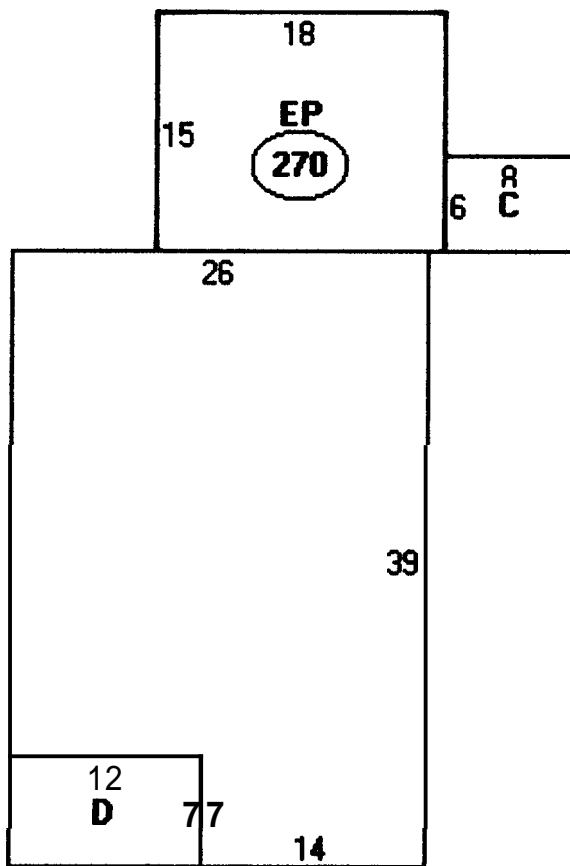

Descriptor/Area

A: FA/1Fr/B  
930 sqft

B: EP  
270 sqft

C: WD  
48 sqft

D: EP  
84 sqft

4x6 ATTACHED  
CONSTRUCT  
2x6 CONSTRUCT

2x12  
JOISTS

AR21

AR31

EXISTING STRUCTURE ON SONG TUBES

2x12 JOISTS

16' CON  
2x4  
CONSTRUCT

Anderson DH3049  
Unit 2'11 1/2" X 4'8 1/2"  
R.O. 3'0" X 4'9"

Anderson AR31  
Unit 2'11 5/16" X 1'5"  
R.O. 3'0 1/2" X 1'5 1/2"

Anderson AR21  
Unit 2'0 3/8" X 1'5"  
R.O. 2'0 5/8" X 1'5 1/2"

DH3049

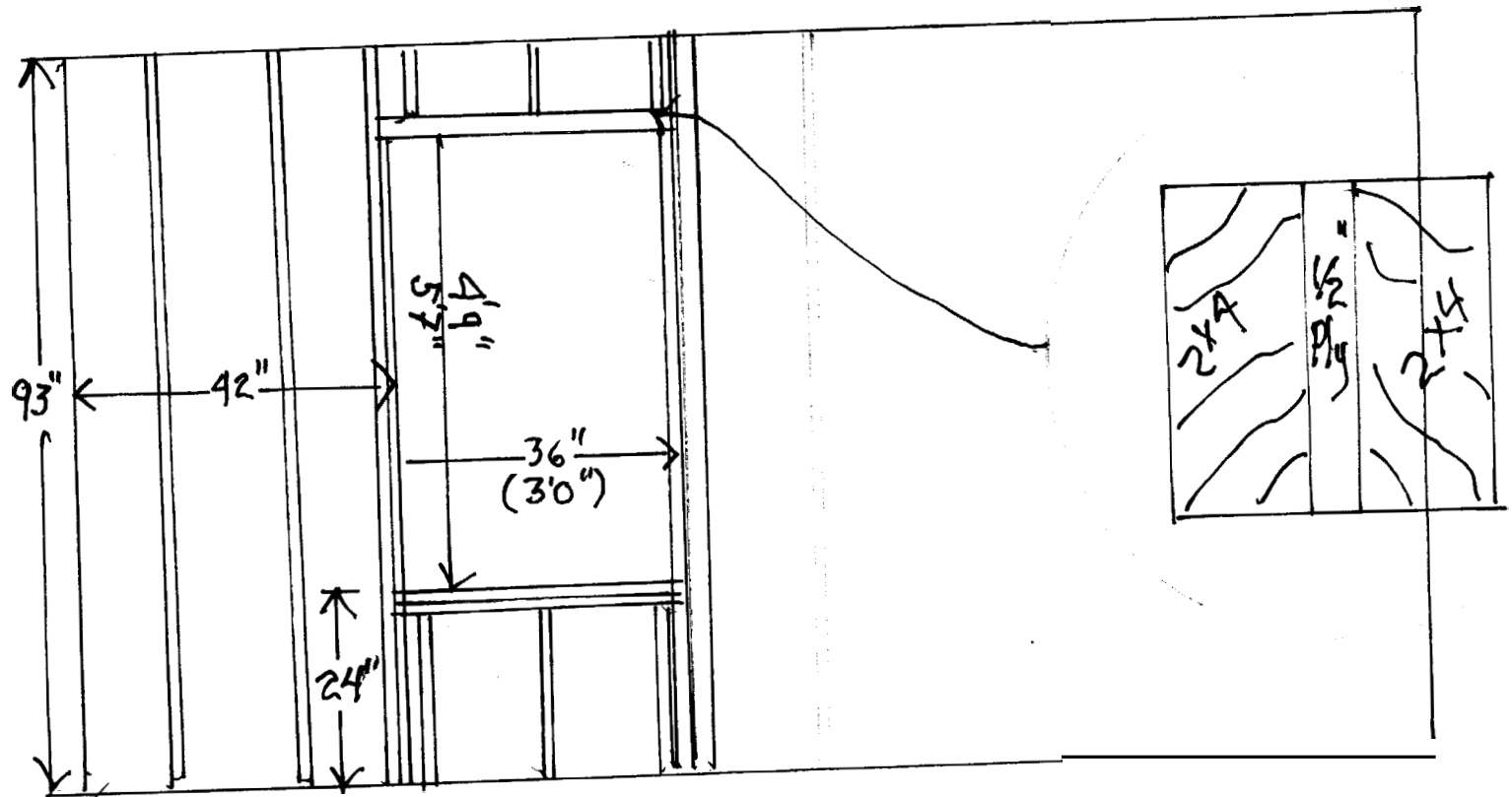

$4' = 1'$

171 Walton St  
 Slanagan Stephens



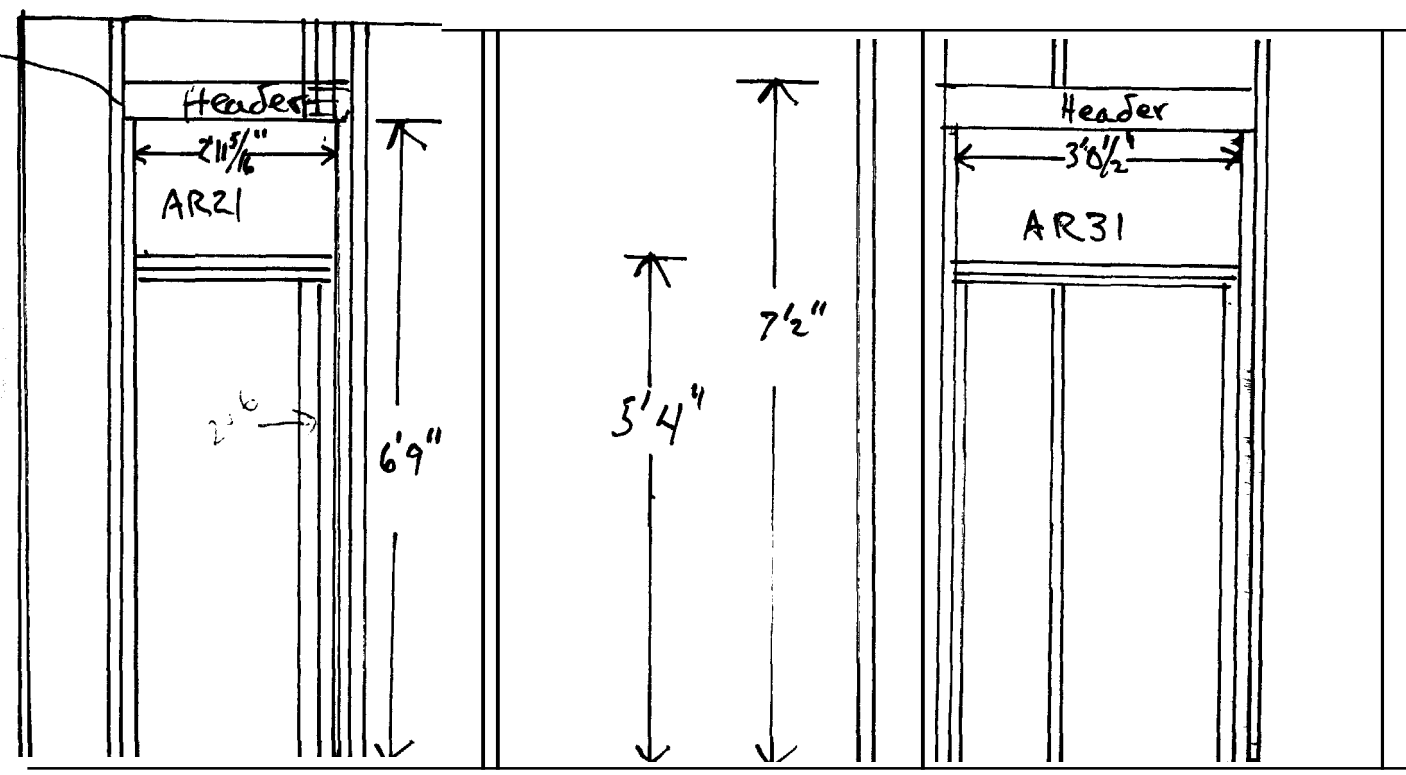
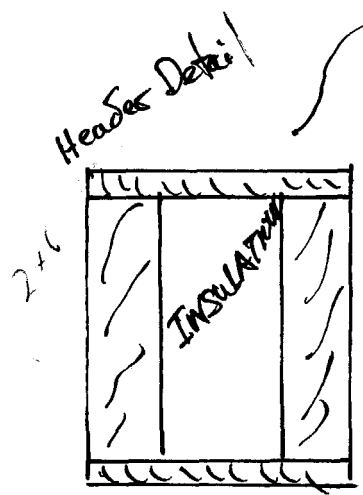

171 walton St  
 Shanagan Stepheas



# CITY OF PORTLAND, MAINE

## Department of Building Inspections

7-12 20 05

Received from 171 Walton

Location of Work James Flanagan

Cost of Construction \$ \_\_\_\_\_

Permit Fee \$ 3900.00

Building (IL)  Plumbing (I5) \_\_\_\_\_ Electrical (I2) \_\_\_\_\_ Site Plan (U2) \_\_\_\_\_

Other \_\_\_\_\_

CBL: 142 B 12

Check #: 0878

Total Collected \$ 3900.00

# THIS IS NOT A PERMIT

No work is to be started until PERMIT CARD is actually posted upon the premises. Acceptance of fee is no guarantee that permit will be granted. PRESERVE THIS RECEIPT. In case permit cannot be granted the amount of the fee will be refunded upon return of the receipt less \$10.00 or 10% whichever is greater.

WHITE - Applicant's Copy  
YELLOW - Office Copy  
PINK - Permit Copy