



General Building Permit Application

If you or the property owner owes real estate or personal property taxes or user charges on any property within the City, payment arrangements must be made before permits of any kind are accepted.

Location/Address of Construction: <u>69 WELLINGTON ST PORTLAND 04103</u>		
Total Square Footage of Proposed Structure/Area <u>85 sq ft</u>	Square Footage of Lot <u>11000</u>	Number of Stories <u>1 1/2 / 2</u>
Tax Assessor's Chart, Block & Lot Chart# Block# Lot# <u>141 - D - 16 - 17</u>	Applicant: (must be owner, lessee or buyer) Name <u>NATHAN KIMBLE</u> Address <u>69 Wellington</u> City, State & Zip <u>PLD ME 04103</u>	Telephone: <u>207-650-2487</u>
Lessee/DBA	Owner: (if different from applicant) Name Address City, State & Zip	Cost of Work: \$ <u>18,000</u> C of O Fee: \$ _____ Historic Review: \$ <u>0</u> Planning Amin.: \$ _____ Total Fee: \$ _____
Current legal use (i.e. single family) <u>Single family</u> Number of Residential Units <u>1</u> If vacant, what was the previous use? <u>n/a</u> Proposed Specific use: <u>n/a</u> Is property part of a subdivision? <u>n/a</u> <u>no</u> If yes, please name <u>n/a</u> Project description:		
Contractor's name: _____ Email: _____ Address: _____ City, State & Zip _____ Telephone: _____ Who should we contact when the permit is ready: <u>NATHAN KIMBLE</u> Telephone: <u>207 650-2487</u> Mailing address: <u>69 Wellington Portland ME 04103</u>		

Please submit all of the information outlined on the applicable checklist. Failure to do so will result in the automatic denial of your permit.

In order to be sure the City fully understands the full scope of the project, the Planning and Development Department may request additional information prior to the issuance of a permit. For further information or to download copies of this form and other applications visit the Inspections Division on-line at www.portlandmaine.gov, or stop by the Inspections Division office, room 315 City Hall or call 874-8703.

and I hereby certify that I am the Owner of record of the named property, or that the owner of record authorizes the proposed work and that I have been authorized by the owner to make this application as his/her authorized agent. I agree to conform to all applicable laws of this jurisdiction. In addition, if a permit for work described in this application is issued, I certify that the Code Official's authorized representative shall have the authority to enter all areas covered by this permit at any reasonable hour to enforce the provisions of the codes applicable to this permit.

Signature: [Signature] Date: 5-18-2012

This is not a permit; you may not commence ANY work until the permit is issued

Assessor's Office | 388 Congress Street | Portland, Maine 04101 | Room 115 | (207) 874-8486

[City](#) [Home](#) [Departments](#) [City Council](#) [E-Services](#) [Calendar](#) [Jobs](#)

This page contains a detailed description of the Parcel ID you selected. Press the **New Search** button at the bottom of the screen to submit a new query.

Current Owner Information:

Services

Applications

Doing Business

Maps

Tax Relief

Tax Roll

Q & A

CBL 141 D016001
Land Use Type SINGLE FAMILY
Property Location 69 WELLINGTON RD
Owner Information KIMBLE NATHAN W & SARAH K KIMBLE JTS
 69 WELLINGTON RD
 PORTLAND ME 04103
Book and Page 23622/120
Legal Description 141-D-16-17
 WELLINGTON RD 69
 10500 SF
Acres 0.241

Current Assessed Valuation:

[browse city services a-z](#)

TAX ACCT NO. 20934 **OWNER OF RECORD AS OF APRIL 2011**
 KIMBLE NATHAN W &
 SARAH K KIMBLE JTS
 69 WELLINGTON RD
 PORTLAND ME 04103
LAND VALUE \$71,900.00
BUILDING VALUE \$136,900.00
NET TAXABLE - REAL ESTATE \$208,800.00
TAX AMOUNT \$3,816.86

[browse facts and links a-z](#)

Any information concerning tax payments should be directed to the Treasury office at 874-8490 or e-mailed.



Best viewed at 800x600, with Internet Explorer

Building Information:

Building 1
Year Built 1923
Style/Structure Type OLD STYLE
Stories 2
Units 1
Bedrooms 3
Full Baths 1
Half Baths 1
Total Rooms 5
Attic UNFIN
Basement FULL
Square Feet 1538

[View Sketch](#) [View Map](#) [View Picture](#)



Outbuildings/Yard Improvements:

Building 1
Year Built 1923
Structure GARAGE-WD/CB
Size 12X20
Units 1
Grade C
Condition A

Sales Information:

Sale Date	Type	Price	Book/Page
1/27/2006	LAND + BUILDING	\$235,000.00	23622/120
8/1/2003	LAND + BUILDING	\$0.00	19928/241
11/1/1991	LAND + BUILDING	\$112,500.00	9780/117

[New Search](#)

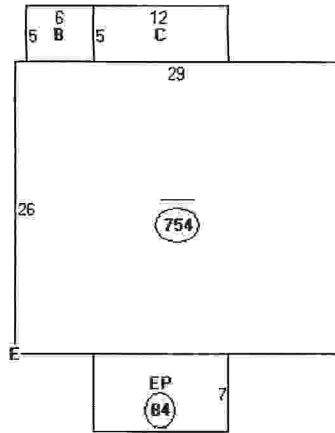

Descriptor/Area

A: ---
754 sqft
B: 1Fr/B
30 sqft
C: EP/B
60 sqft
D: EP
84 sqft
E: FG1
240 sqft