



*TIM AND CARRE GARDNER*

LOCATION <i>83 WALTON ST. PORTLAND ME.</i>	
BUILDER	PAGE <i>COVER SHEET</i>
SCALE <i>NO SCALE</i>	DRAWN BY: <i>JNA</i>



EXISTING ELEVATION

*TIM AND CARRE GARDNER*

LOCATION <i>83 WALTON ST. PORTLAND, ME.</i>	
BUILDER	PAGE <i>1</i>
SCALE <i>NO SCALE</i>	DRAWN BY: <i>JNA 5/16/2011</i>



NEW ELEVATION

TIM AND CARRE GARDNER

LOCATION	
83 WALTON ST. PORTLAND, ME.	
BUILDER	PAGE 3
SCALE	DRAWN BY:
3/16" = 1'	JNA

EXISTING FRAME ROOF:  
 #225 ASPHALT SHINGLES  
 3/4" ROOF BOARDS  
 2x8 RIDGEBOARD  
 2x6 RAFTERS @ 16" o.c.  
 2x6 CEILG JOISTS @ 16" o.c. w/  
 R38 BATT INSUL.  
 1/2" DRYWALL  
 TAPED & SANDED

EXISTING 2x4 SIDING EXTERIOR WALL:  
 ALUM. SIDING  
 3/4" SHEATHING BOARDS  
 2x4 STUDS @ 16" o.c.  
 R13 BATT INSULATION  
 1/2" DRYWALL  
 TAPED AND SANDED

NEW 2x8 FLOOR SYSTEM:  
 3/4" T&G PLYWOOD SUBFLOOR  
 2x8 FLOOR JOISTS @ 16" o.c.  
 WITH R13 INSULATION

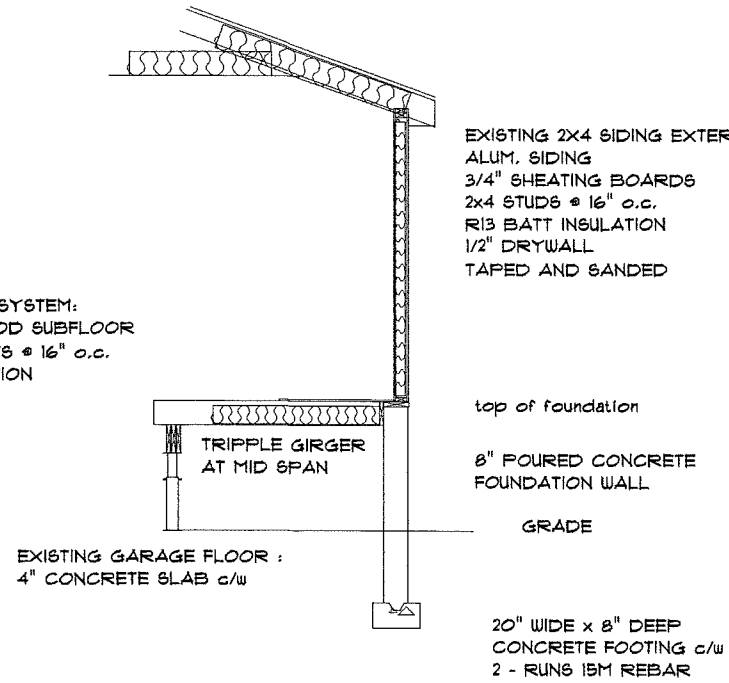

CROSS SECTION

TIM AND CARRE GARDNER

LOCATION		83 WALTON ST. PORTLAND, ME.	
BUILDER		PAGE	5
SCALE		DRAWN BY:	
NO SCALE		JNA	

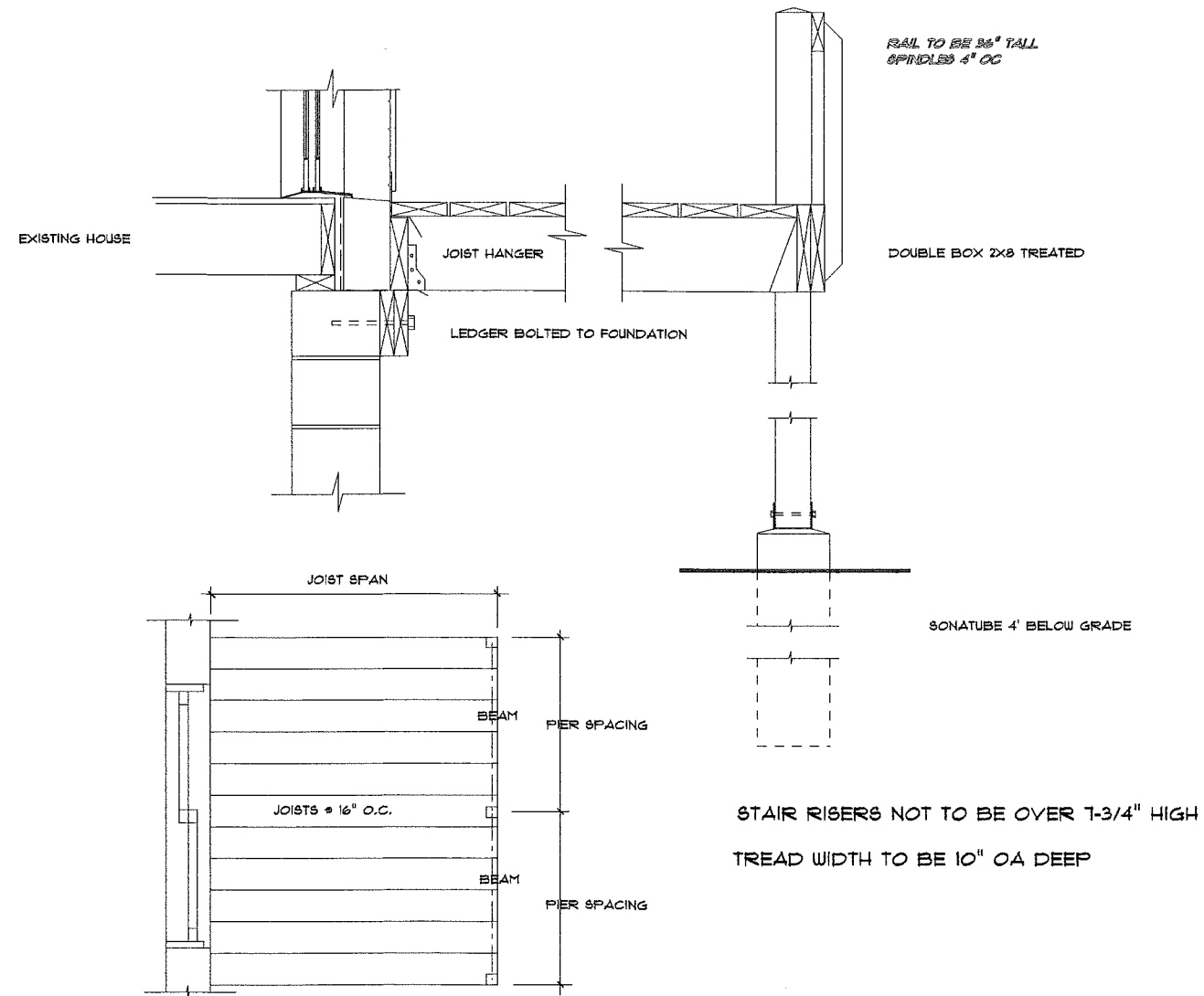

TIM AND CARRE GARDNER

LOCATION  
83 WALTON ST. PORTLAND, ME.

BUILDER

PAGE

SCALE  
NONE

DRAWN BY:  
JNA

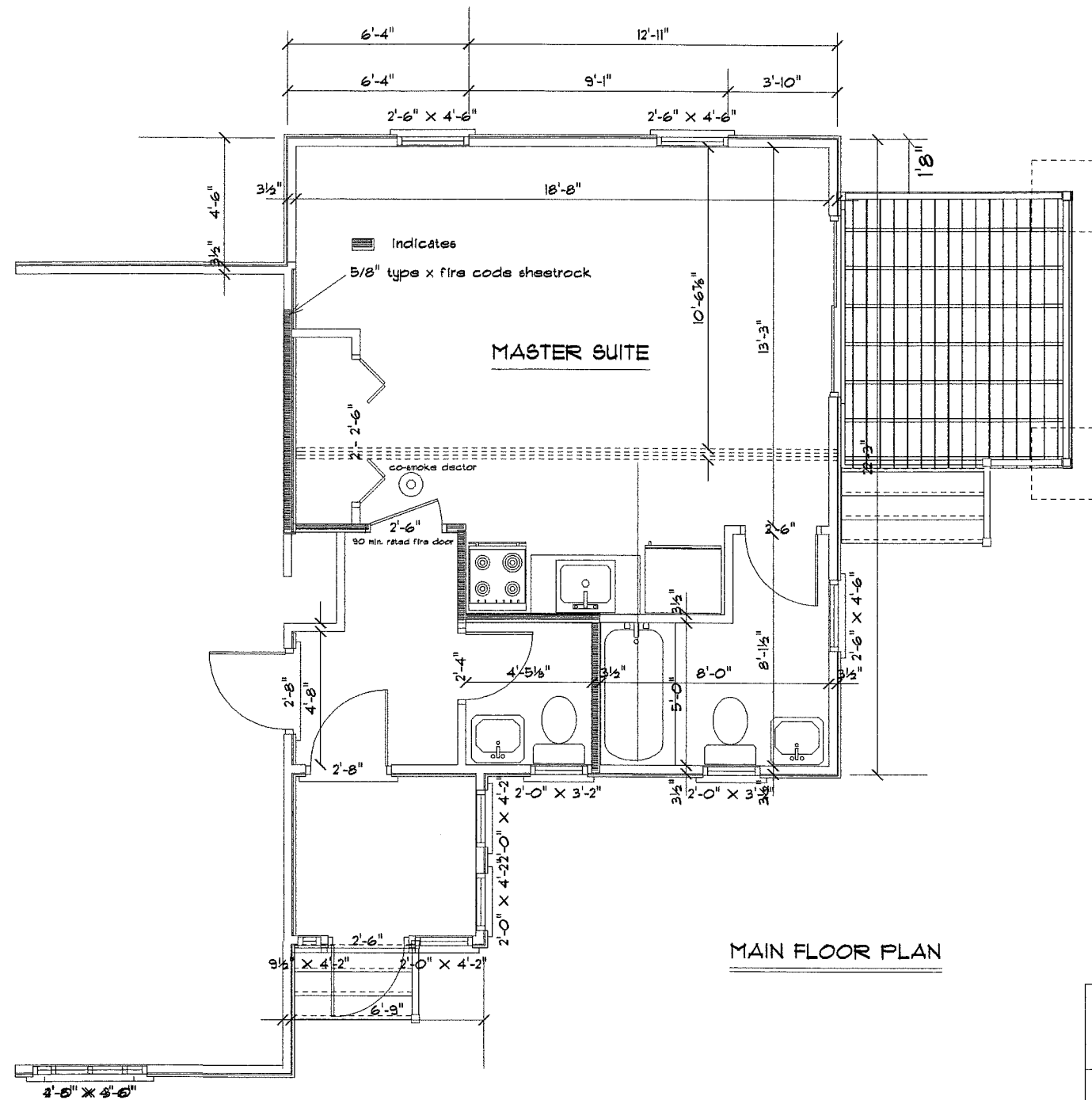

<i>TIM AND CARRE GARDNER</i>	
LOCATION <b>83 WALTON ST. PORTLAND, ME</b>	
BUILDER	PAGE <b>2</b>
SCALE <b>3/16" = 1'</b>	DRAWN BY: <b>JNA</b>

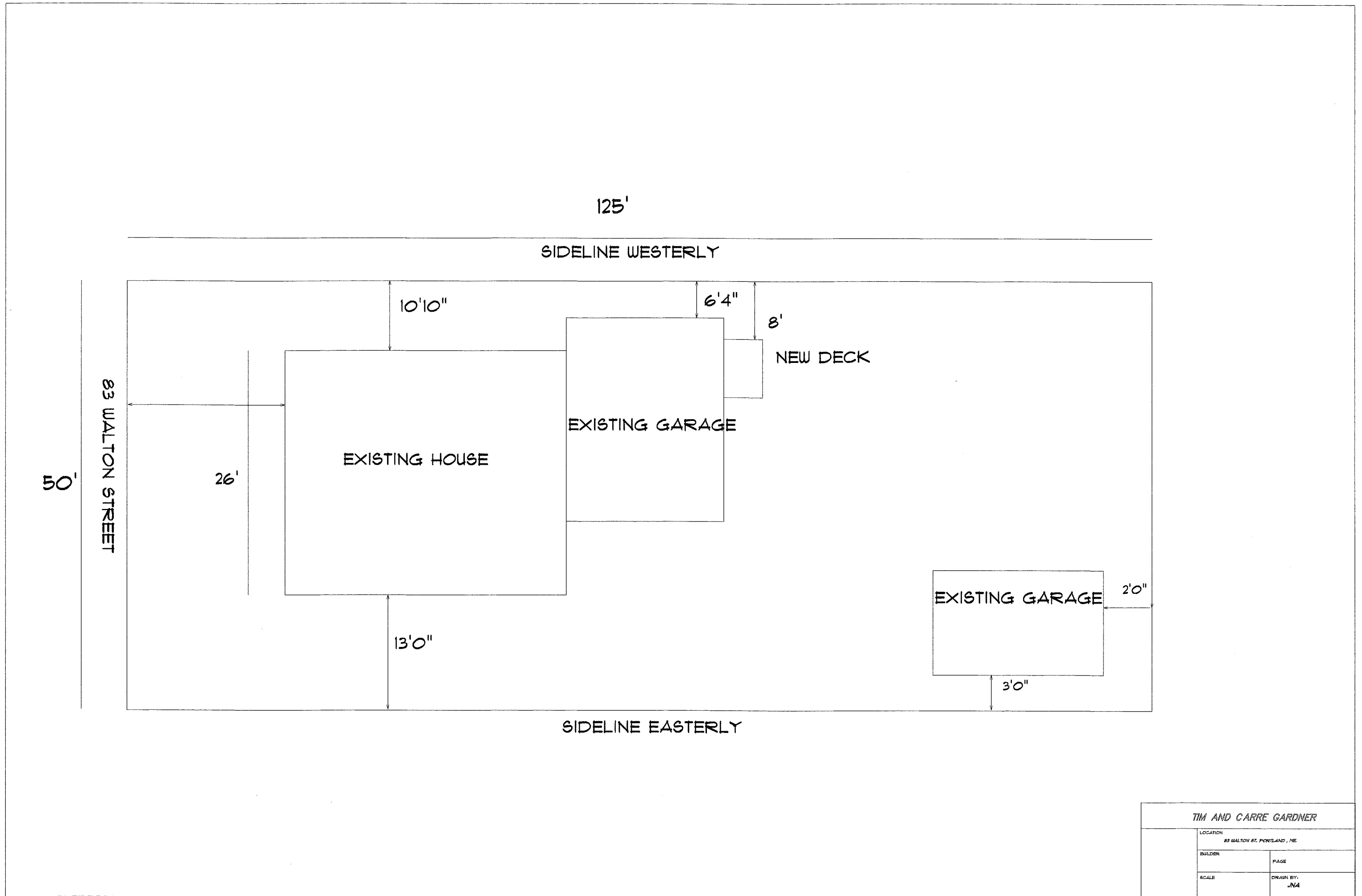

<b>TIM AND CARRE GARDNER</b>	
LOCATION 83 WALTON ST. PORTLAND, ME	
BUILDER	PAGE
SCALE	DRAWN BY: JNA