

I am Building a 10'x8' shed That will be sitting on 6, 8" sona tubes That will be 4' deep.

There will be 2 6X6 beams That will span The sona Tubes and a 2X6 Floor will be Framed resting Across The beams The Building will be constructed of 2X4 with The roof being stick Framed with 2X4's as well There will be a door Along with A window. The shed will be vinyl sided with an Asphalt Shingle roof

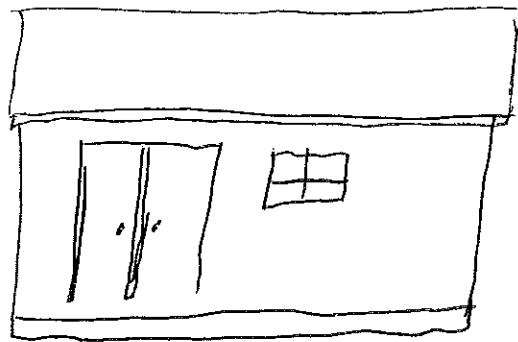

Top view

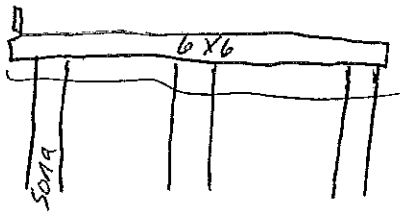