

FRAMING PLAN SYMBOLS KEY	
□	WOOD POST
○	STEEL COLUMN
⊗	NUMBER OF WOOD STUDS IN POST BELOW
⊕	COLUMN ABOVE THIS LEVEL
A	COLUMN CONTINUOUS THROUGH THIS LEVEL
C	JOIST BEARING
→	CONTINUOUS JOIST BEARING WITH INTERMEDIATE BEARING
→	FLUSH FRAMED JOIST BEARING WITH HANGER
→	WOOD STUD BEARING WALL BELOW
→	OVER FRAMING BY OTHERS -TYP
⊕	NUMBER OF TRIM STUDS UNDER HEADER
⊗	NUMBER OF KING STUDS ADJACENT TO HEADER

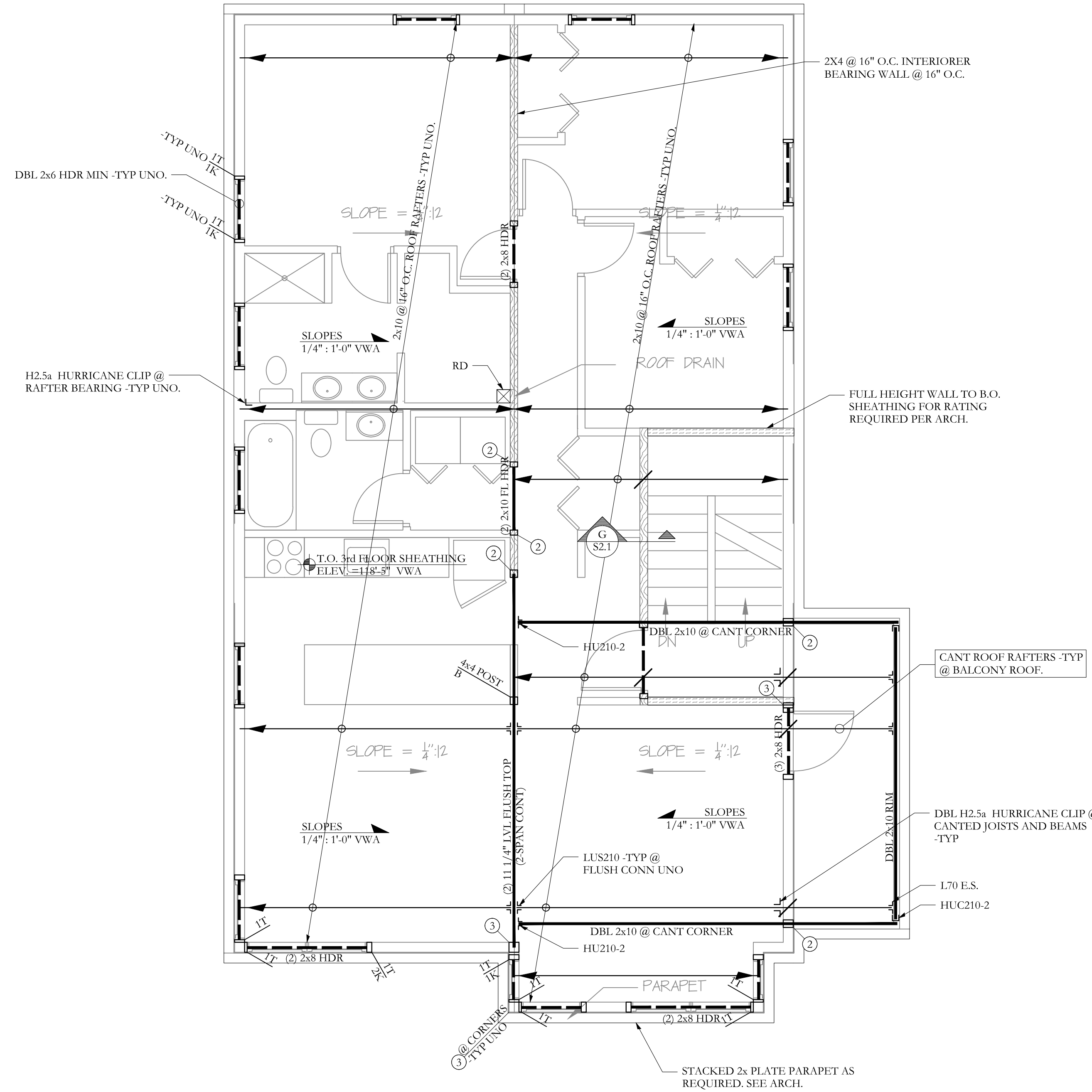

ROOF FRAMING PLAN

SCALE 1/4" = 1'-0"

NOTES:

- SEE SHEET S1.0 FOR GENERAL STRUCTURAL NOTES
- ALL WOOD COLUMNS IN 2x6 WALLS SHALL BE 3-2x6 AND IN 2x4 WALLS SHALL BE 3-2x4 UNLESS NOTED OTHERWISE ON PLANS
- ALL BEAMS ARE DROPPED, UNO
- ALL HEADERS IN 2x6 BEARING WALLS ARE (2) 2x6 NO.1 GRADE SPF MIN. UNO
- ALL HEADERS IN 2x4 BEARING WALLS ARE (2) 2x4 NO.1 GRADE SPF MIN. UNO
- ALL ROOF SHEATHING TO BE 5/8", SEE GENERAL NOTES FOR ADDITIONAL INFORMATION -TYP

Structural Integrity
 Consulting Engineers, Inc.
 77 Oak Street
 Portland, ME, 04101
 p. 207-774-4614
 f. 866-793-7835
 www.structuralinteg.com

BUILD WITH CONFIDENCE
 ©2015 Structural Integrity Consulting Engineers, Inc.
 SI # 15-0042

Bild Architecture
 PO Box 8235
 Portland, ME
 04104
 207.408.0168
 evan@bildarchitecture.com

STATE OF MAINE
 AARON C. JONES
 No. 10966
 LICENSED PROFESSIONAL ENGINEER
 Mar 11th, 2015

PROJECT NO. 15002
 PROJECT NAME 15 WALTON STREET
 PORTLAND, ME

FOR PERMIT SET

REVISIONS

1	
2	
3	
4	
5	

DRAWN BY MKL
 SHEET TITLE **Roof Framing Plan**

ISSUE DATE 3/11/15
 SHEET SCALE 1/4" = 1'-0"

S

S1.5