

© 2017 RYAN SENATORE ARCHITECTURE

TIPO - PATIO RENOVATION
182 OCEAN AVENUE
PORTLAND, MAINE



RYAN SENATORE ARCHITECTURE
565 CONGRESS STREET
PORTLAND, MAINE 04101
207-650-6414
senatorearchitecture.com

CONSULTANTS:
STRUCTURAL:
Structural Integrity
77 Oak Street
Portland, ME 04101
207-774-4614

REVISIONS:

DATE: APRIL 27, 2017

PROJECT No. 1634-A

DRAWN BY: JPF

CHECKED BY: RJS

SCALE: AS NOTED

SHEET TITLE:
DEMOLITION FLOOR PLAN

AD1-0

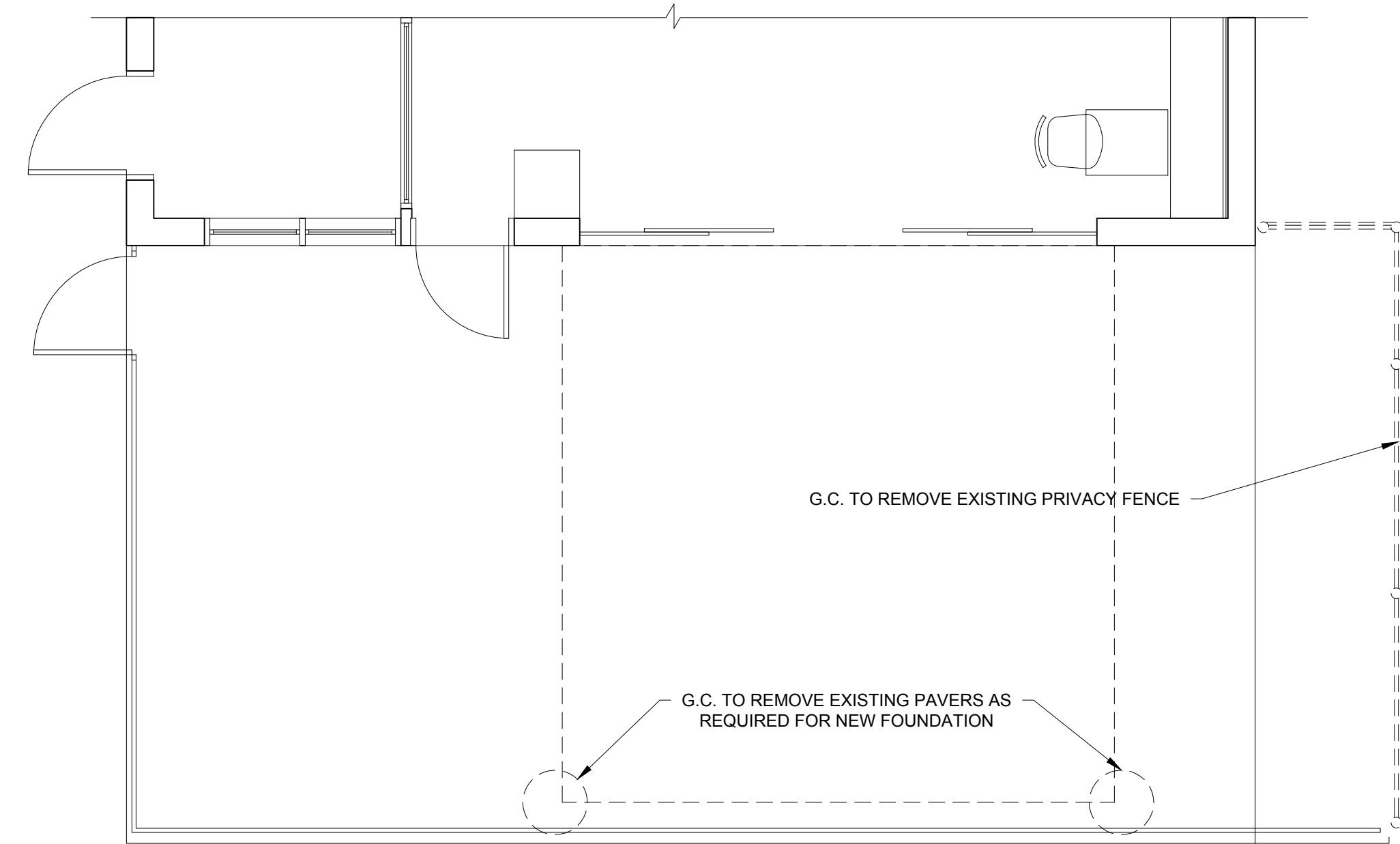

1 DEMOLITION FLOOR PLAN
1/4" = 1'-0"