



General Building Permit Application

If you or the property owner owes real estate or personal property taxes or user charges on any property within the City, payment arrangements must be made before permits of any kind are accepted.

Location/Address of Construction: <u>50 GLECKLER RD</u>		
Total Square Footage of Proposed Structure/Area <u>~ 36 #</u>	Square Footage of Lot <u>5250</u>	Number of Stories
Tax Assessor's Chart, Block & Lot Chart# Block# Lot# <u>140 A 4</u>	Applicant * must be owner, Lessee or Buyer* Name Address City, State & Zip	Telephone: <u>774-2468</u>
Lessee/DBA (If Applicable)	Owner (if different from Applicant) Name <u>PETER STEAN</u> Address <u>50 GLECKLER RD</u> City, State & Zip <u>PORTLAND</u> <u>04103</u>	Cost Of Work: \$ <u>300.00</u> C of O Fee: \$ _____ Total Fee: \$ <u>300</u>
Current legal use (i.e. single family) <u>SFR</u> Number of Residential Units <u>1</u> If vacant, what was the previous use? _____ Proposed Specific use: <u>DECK</u> Is property part of a subdivision? <u>NO</u> If yes, please name _____ Project description:		
Contractor's name: <u>DWPER</u> Address: _____ City, State & Zip _____ Telephone: _____ Who should we contact when the permit is ready: <u>DWPER</u> Telephone: _____ Mailing address: <u>JEB ABAL</u>		

Please submit all of the information outlined on the applicable Checklist. Failure to do so will result in the automatic denial of your permit.

In order to be sure the City fully understands the full scope of the project, the Planning and Development Department may request additional information prior to the issuance of a permit. For further information or to download copies of this form and other applications visit the Inspections Division on-line at www.portlandmaine.gov, or stop by the Inspections Division office, room 315 City Hall or call 874-8703.

I hereby certify that I am the Owner of record of the named property, or that the owner of record authorizes the proposed work and that I have been authorized by the owner to make this application as his/her authorized agent. I agree to conform to all applicable laws of this jurisdiction. In addition, if a permit for work described in this application is issued, I certify that the Code Official's authorized representative shall have the authority to enter all areas covered by this permit at any reasonable hour to enforce the provisions of the codes applicable to this permit.

Signature: [Signature] Date: 15 MAR 11

This is not a permit; you may not commence ANY work until the permit is issued

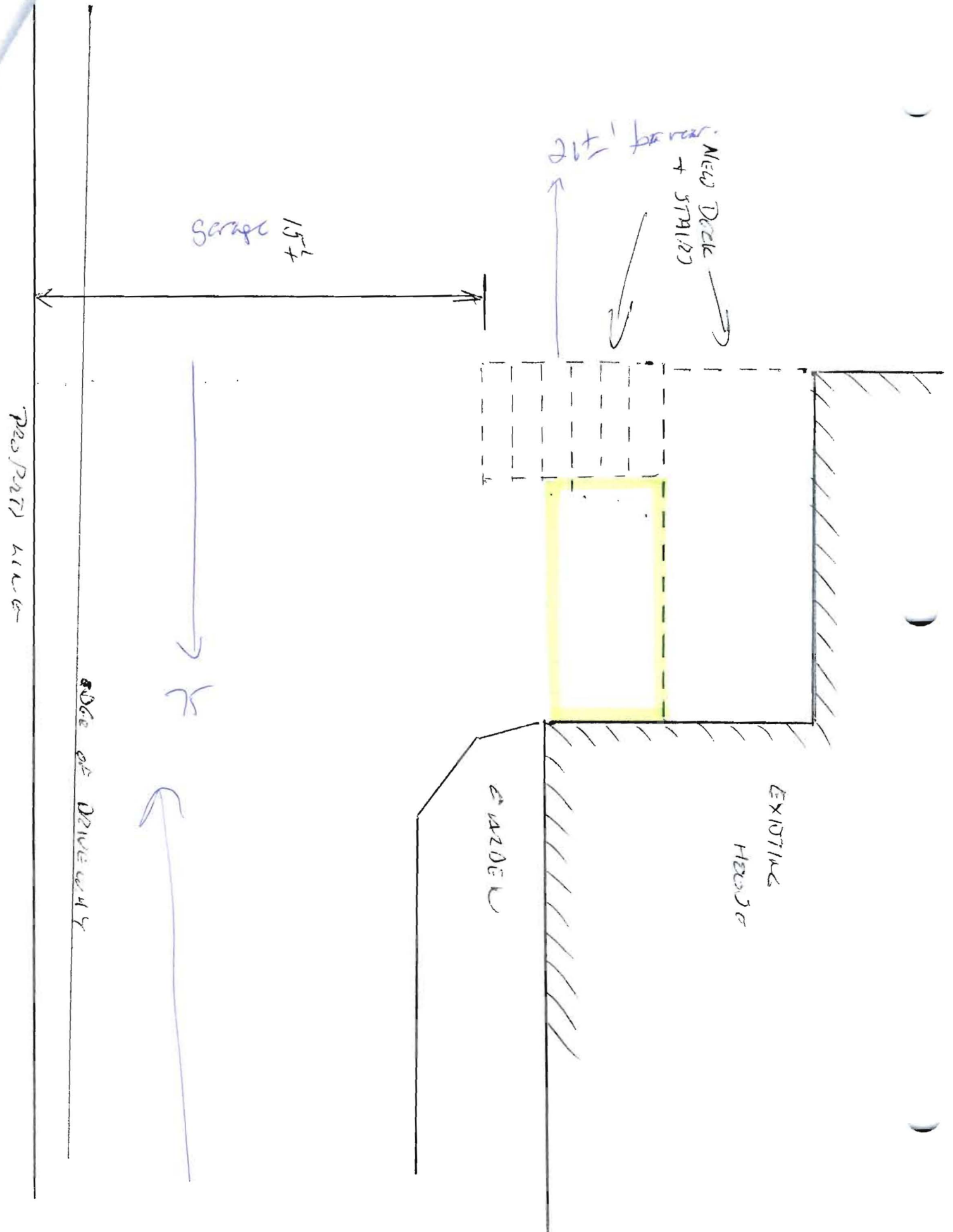

Garage 15ft

20ft to rear

New Deck + Stairs

PROPERTY LINE

EDGE OF DRIVEWAY

GARAGE

EXISTING HOUSE

Street

HOUSE

EXISTING DECK.

50 GLECKLER RD

PORTLAND 04103

ALL RAILINGS 38" HIGH
NO REVILLE CRODIER THRU 4"

EXISTING
STEEL

STUD

STUD

PROPOSED ADDITIONAL DECK
± 36" W

TO FOLLOW PREVIOUS
CONSTRUCTION OF
EXISTING DECK

JOIST 16" 16' 0"

45"

NEW 4X4 (SEE OVERLAP DETAIL) 2X8'S

HOUSE

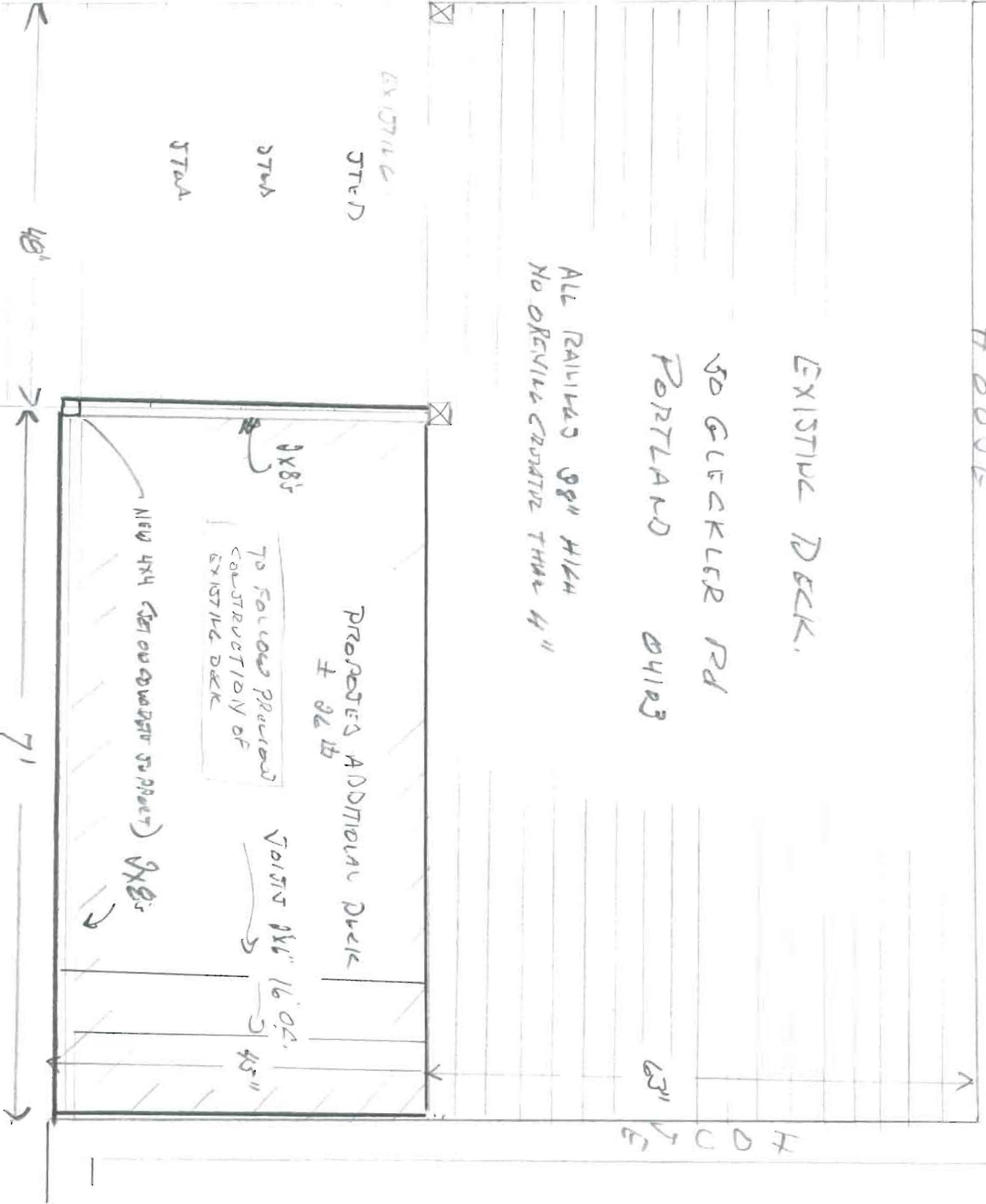

OVER HEAD
VIEW

11 1/2'

EXISTING STRUCTURE

EXISTING
DOOR

Existing Deck

5'

9'

Existing Stairs

5- 6 STEPS

Proposed Additional
Deck ± 26 ft² to
follow existing deck
construction

2x8 JOISTS

NEED 4x4 MOUNTED
ON CONCRETE BASE

2x8 LAGGED TO JOIST

2x10x8

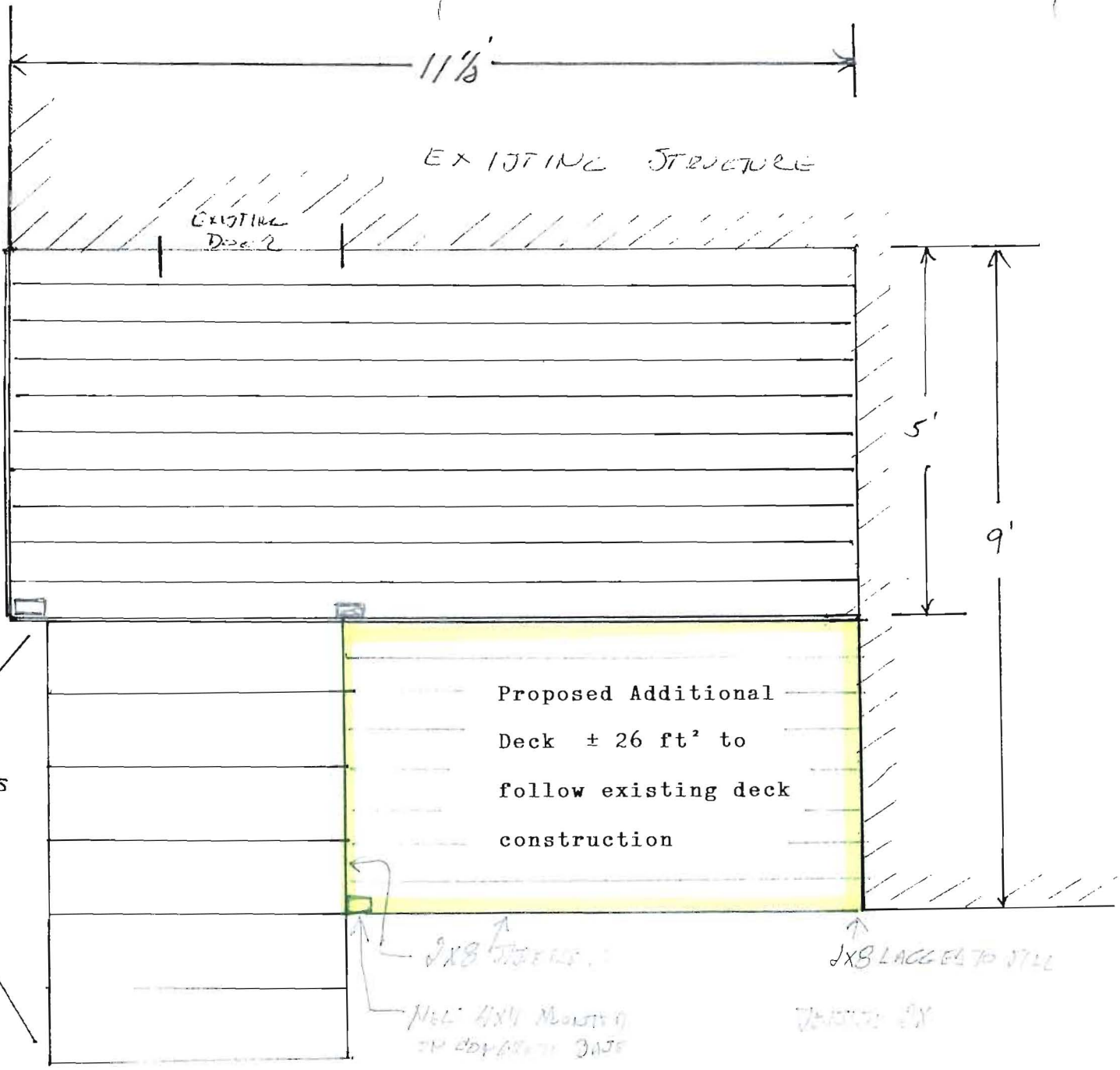



Residential Additions/Alterations Permit Application Checklist

All of the following information is required and must be submitted. Checking off each item as you prepare your application package will ensure your package is complete and will help to expedite the permitting process.

The Maine Home Construction Contracts Act requires that any home construction or repair work for more than \$3000. in materials or labor must be based on a written contract unless the parties agree to exempt themselves. A sample contract is available on the City's website at www.portlandmaine.gov, in the Inspection Office, Room 315 of Portland City Hall or call (207)874-8703 to have one mailed to you.

One (1) complete set of construction drawings must include:

- Cross sections w/framing details
- Floor plans and elevations existing & proposed
- Detail removal of all partitions & any new structural beams
- Detail any new walls or permanent partitions
- Stair details including dimensions of: rise/run, head room, guards/handrails, baluster spacing
- Window and door schedules
- Foundation plans w/required drainage and damp proofing (if applicable)
- Detail egress requirements and fire separation/sound transmission ratings (if applicable)
- Insulation R-factors of walls, ceilings & floors & U-factors of windows per the IEBC 2003
- Deck construction including: pier layout, framing, fastenings, guards, stair dimensions
- Reduced plans or electronic files in pdf format are also required if original plans are larger than 11" x 17"
- Proof of ownership is required if it is inconsistent with the assessors records

Separate permits are required for internal & external plumbing, HVAC, and electrical installations.

If there are any additions to the footprint or volume of the structure, any new or rebuilt structures or, accessory detached structures a plot plan is required. A plot must include:

- The shape and dimension of the lot, footprint of the existing and proposed structure and the distance from the actual property lines. Structures include decks, porches; bow windows, cantilever sections and roof overhangs, sheds, pools, garages and any other accessory structures must be shown with dimensions if not to scale.
- Location and dimensions of parking areas and driveways
- A change of use may require a site plan exemption application to be filed.

Please submit all of the information outlined in this application checklist. If the application is incomplete, the application may be refused.

In order to be sure the City fully understands the full scope of the project, the Planning and Development Department may request additional information prior to the issuance of a permit. For further information visit us on-line at www.portlandmaine.gov, stop by the Building Inspections office, room 315 City Hall or call 874-8703.

Permit Fee: \$30.00 for the first \$1000.00 construction cost, \$10.00 per additional \$1000.00 cost

This is not a Permit; you may not commence any work until the Permit is issued.