

DISPLAY THIS CARD ON PRINCIPAL FRONTAGE OF WORK  
**CITY OF PORTLAND**

Please Read  
 Application And  
 Notes, If Any,  
 Attached

BUILDING DEPARTMENT  
**PERMIT**

Permit Number: 080045

This is to certify that MCCAIN MELISSA D /Ben Weigel

has permission to removal of existing 7' x 15' Deck, new 5' x 10' deck, interior renovations of Kitchen, bath & bedroom

AT 31 MACKWORTH ST

139-D041001

provided that the person or persons, firm or corporation accepting this permit shall comply with all of the provisions of the Statutes of this State and of the Ordinances of the City of Portland regulating the construction, maintenance and use of buildings and structures, and of the application on file in this department.

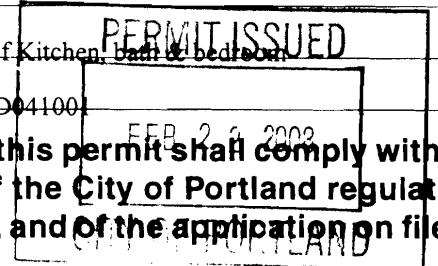

Apply to Public Works for street line and grade if nature of work requires such information.

Notification of inspection must be given and when permission procured before this building or part thereof is started or closed-in.  
 HOUR NOTICE IS REQUIRED.

A certificate of occupancy must be procured by owner before this building or part thereof is occupied.

**OTHER REQUIRED APPROVALS**

Fire Dept. \_\_\_\_\_

Health Dept. \_\_\_\_\_

Appeal Board \_\_\_\_\_

Other \_\_\_\_\_

Department Name

*Thomas M. Markley* 2/20/08  
 Director - Building & Inspection Services

**PENALTY FOR REMOVING THIS CARD**

# BUILDING PERMIT INSPECTION PROCEDURES

Please call **874-8703** or **874-8693** (ONLY)

to schedule your inspections as agreed upon

Permits expire in 6 months, if the project is not started or ceases for 6 months.

The Owner or their designee is required to notify the inspections office for the following inspections and provide adequate notice. Notice must be called in 48-72 hours in advance in order to schedule an inspection:

By initializing at each inspection time, you are agreeing that you understand the inspection procedure and additional fees from a "Stop Work Order" and "Stop Work Order Release" will be incurred if the procedure is not followed as stated below.

A Pre-construction Meeting will take place upon receipt of your building permit.

- Footing/Building Location Inspection:** Prior to pouring concrete
- Re-Bar Schedule Inspection:** Prior to pouring concrete
- Foundation Inspection:** Prior to placing ANY backfill
- Framing/Rough Plumbing/Electrical:** Prior to any insulating or drywalling
- Final/Certificate of Occupancy:** Prior to any occupancy of the structure or use. NOTE: There is a \$75.00 fee per inspection at this point.

Certificate of Occupancy is not required for certain projects. Your inspector can advise you if your project requires a Certificate of Occupancy. All projects **DO** require a final inspection

**If any of the inspections do not occur, the project cannot go on to the next phase, REGARDLESS OF THE NOTICE OR CIRCUMSTANCES.**

~~CERTIFICATE OF OCCUPANICES MUST BE ISSUED AND PAID FOR, BEFORE THE SPACE MAY BE OCCUPIED~~

Signature of Applicant/Designee

Date

Signature of Inspections Official

Date

CBL:

139D41

Building Permit #:

08 0045

**City of Portland, Maine - Building or Use Permit Application**

389 Congress Street, 04101 Tel: (207) 874-8703, Fax: (207) 874-8716

Permit No: 08-0045	Issue Date:	CBL: 139 D041001
-----------------------	-------------	---------------------

Location of Construction: 31 MACKWORTH ST	Owner Name: MCCAIN MELISSA D	Owner Address: 31 MACKWORTH ST	Phone:
Business Name:	Contractor Name: Ben Weigel	Contractor Address: 12 Madokawando Landing Falmouth	Phone: 2077764635
Lessee/Buyer's Name	Phone:	Permit Type: Alterations - Dwellings	Zone: R-3

Past Use: Single Family Home	Proposed Use: Single Family Home - removal of existing 7' x 15' Deck, new 5' x 10' deck, interior renovations of Kitchen, bath & bedroom	Permit Fee: \$1,270.00	Cost of Work: \$125,000.00	CEO District: 4
		FIRE DEPT: <input type="checkbox"/> Approved <input type="checkbox"/> Denied	INSPECTION: Use Group: R3 Type: SB IRC 2003	

Proposed Project Description: removal of existing 7' x 15' Deck, new 5' x 10' deck, interior renovations of Kitchen, bath & bedroom	Signature:	Signature: <i>ABM 2/20/08</i>
PEDESTRIAN ACTIVITIES DISTRICT (P.A.D.)		
Action: <input type="checkbox"/> Approved <input type="checkbox"/> Approved w/Conditions <input type="checkbox"/> Denied		
Signature:	Date:	

Permit Taken By: ldobson	Date Applied For: 01/16/2008	<b>Zoning Approval</b>
-----------------------------	---------------------------------	------------------------

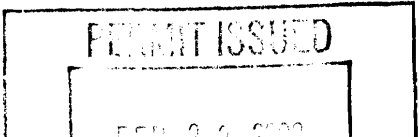
<ol style="list-style-type: none"> <li>This permit application does not preclude the Applicant(s) from meeting applicable State and Federal Rules.</li> <li>Building permits do not include plumbing, septic or electrical work.</li> <li>Building permits are void if work is not started within six (6) months of the date of issuance. False information may invalidate a building permit and stop all work..</li> </ol>	<b>Special Zone or Reviews</b> <input type="checkbox"/> Shoreland <input type="checkbox"/> Wetland <input type="checkbox"/> Flood Zone <input type="checkbox"/> Subdivision <i>OK</i> <input type="checkbox"/> Site Plan Maj <input type="checkbox"/> Minor <input type="checkbox"/> MM <input type="checkbox"/> Date: <i>ABM 2/9/08</i>	<b>Zoning Appeal</b> <input type="checkbox"/> Variance <input type="checkbox"/> Miscellaneous <input type="checkbox"/> Conditional Use <input type="checkbox"/> Interpretation <input type="checkbox"/> Approved <input type="checkbox"/> Denied Date:	<b>Historic Preservation</b> <input checked="" type="checkbox"/> Not in District or Landmark <input type="checkbox"/> Does Not Require Review <input type="checkbox"/> Requires Review <input type="checkbox"/> Approved <input type="checkbox"/> Approved w/Conditions <input type="checkbox"/> Denied <i>ABM</i> Date:
			

**CERTIFICATION**

I hereby certify that I am the owner of record of the named property, or that the proposed work is authorized by the owner of record and that I have been authorized by the owner to make this application as his authorized agent and I agree to conform to all applicable laws of this jurisdiction. In addition, if a permit for work described in the application is issued, I certify that the code official's authorized representative shall have the authority to enter all areas covered by such permit at any reasonable hour to enforce the provision of the code(s) applicable to such permit.

SIGNATURE OF APPLICANT ADDRESS DATE PHONE

RESPONSIBLE PERSON IN CHARGE OF WORK, TITLE DATE PHONE

**City of Portland, Maine - Building or Use Permit**

389 Congress Street, 04101 Tel: (207) 874-8703, Fax: (207) 874-8716

<b>Permit No:</b> 08-0045	<b>Date Applied For:</b> 01/16/2008	<b>CBL:</b> 139 D041001
------------------------------	----------------------------------------	----------------------------

<b>Location of Construction:</b> 31 MACKWORTH ST	<b>Owner Name:</b> MCCAIN MELISSA D	<b>Owner Address:</b> 31 MACKWORTH ST	<b>Phone:</b>
<b>Business Name:</b>	<b>Contractor Name:</b> Ben Weigel	<b>Contractor Address:</b> 12 Madokawando Landing Falmouth	<b>Phone</b> (207) 776-4635
<b>Lessee/Buyer's Name</b>	<b>Phone:</b>	<b>Permit Type:</b> Alterations - Dwellings	

<b>Proposed Use:</b> Single Family Home - removal of existing 7' x 15' Deck, new 5' x 10' deck, interior renovations of Kitchen, bath & bedroom	<b>Proposed Project Description:</b> removal of existing 7' x 15' Deck, new 5' x 10' deck, interior renovations of Kitchen, bath & bedroom
----------------------------------------------------------------------------------------------------------------------------------------------------	-----------------------------------------------------------------------------------------------------------------------------------------------

<b>Dept:</b> Zoning	<b>Status:</b> Approved with Conditions	<b>Reviewer:</b> Ann Machado	<b>Approval Date:</b> 02/08/2008
<b>Note:</b>			<b>Ok to Issue:</b> <input checked="" type="checkbox"/>
1) This property shall remain a single family dwelling. Any change of use shall require a separate permit application for review and approval.			
2) This permit is being approved on the basis of plans submitted. Any deviations shall require a separate approval before starting that work.			
<b>Dept:</b> Building	<b>Status:</b> Approved with Conditions	<b>Reviewer:</b> Tom Markley	<b>Approval Date:</b> 02/20/2008
<b>Note:</b>			<b>Ok to Issue:</b> <input checked="" type="checkbox"/>
1) Application approval based upon information provided by applicant. Any deviation from approved plans requires separate review and approval prior to work.			

<b>Comments:</b>
2/11/2008-tm: called Elizabeth Chapman and left a message that more info needed.
2/19/2008-tm: called contractor Ben Weigel and told him I need framing details for deck/stairs. Left a message on machine.
2/20/2008-tm: received requested info from Ben Weigel (contractor).



## Permitting By Appointment

As part of Portland's city-wide effort to improve customer service and help streamline doing business within the City, the Inspections Division has developed a new permitting system for qualified properties and for specific construction projects. Under this new program, you may be eligible to receive a building permit on the day you have a scheduled appointment with Inspection staff.

**This permitting program applies only to existing one and two family homes not located within a historic district or shore land zone.**

### Eligible Projects

Please submit a complete application with the required plans

- Interior renovations, gut rehabs including structural changes
- Attached and detached garages
- Additions, decks, sheds, pools, dormers (two family addition must be less than 500 s.f.)
- Rebuild of any exterior structure listed above

ELIZABETH CHAPMAN, Architect  
820-4228

Hi, I'm in Portland  
M,T, & W<sup>c</sup>.

Thanks so much,

Inspections are still required per City Code of Ordinance.

In order to be sure the City fully understands the full scope of the project, the Planning and Development Department may request additional information prior to the issuance of a permit. For further information visit us on-line at [www.portlandmaine.gov](http://www.portlandmaine.gov), stop by the Building Inspections office, room 315 City Hall or call 874-8703.

I hereby certify that this project meets the above criteria and that the work performed will not go beyond these parameters.

\* Signature of applicant:

*Elizabeth Chapman*

Date:

*1/16/08*

This is not a permit; you may not commence ANY work until the permit is issued.



# General Building Permit Application

If you or the property owner owes real estate or personal property taxes or user charges on any property within the City, payment arrangements must be made before permits of any kind are accepted.

Location/Address of Construction: <b>31 MACKWORTH STREET, PORTLAND</b>		
Total Square Footage of Proposed Structure/Area <b>5 X 10 STAIR</b> <b>FOOTPRINT UNCHANGED 15 X 20</b>		Square Footage of Lot
Tax Assessor's Chart, Block & Lot Chart#      Block#      Lot#	Applicant * <u>must be owner, Lessee or Buyer</u> * Name <b>MELISSA MCCAIN</b> Address <b>31 MACKWORTH ST.</b> City, State & Zip <b>PORTLAND, ME 04103</b>	Telephone: <b>541 3857</b>
Lessee/DBA (If Applicable)	Owner (if different from Applicant) Name <b>—</b> Address <b>—</b> City, State & Zip <b>—</b>	Cost Of Work: <b>\$ 125,000</b> C of O Fee: \$ _____ Total Fee: \$ _____
Current legal use (i.e. single family) <b>SINGLE FAMILY</b> If vacant, what was the previous use? _____ Proposed Specific use: <b>SAME AS EXISTING SINGLE FAMILY</b> Is property part of a subdivision? _____ If yes, please name _____ Project description: <b>REMOVAL OF EXISTING 7X15' DECK &amp; STAIR</b> <b>NEW 5X10 DECK WITH STAIR</b> <b>RENOVATION OF 14 X 20 KITCHEN - FOOTPRINT UNCHANGED</b> <b>RENOVATION OF 14 X 31 BEDROOM &amp; BATHROOMS</b>		
Contractor's name: <b>BEN WEIGEL</b>		
Address: <b>12 MADAKAWANDD LANDING</b>		
City, State & Zip <b>FALMOUTH, ME 04105</b>		Telephone: <b>781 5569</b>
Who should we contact when the permit is ready: <b>ELIZABETH CHAPMAN</b>		Telephone: <b>829 4228</b>
Mailing address: <b>P. O. BOX 177 CUMBERLAND, ME 04021</b>		

**Please submit all of the information outlined on the applicable Checklist. Failure to do so will result in the automatic denial of your permit.**

In order to be sure the City fully understands the full scope of the project, the Planning and Development Department may request additional information prior to the issuance of a permit. For further information or to download copies of this form and other applications visit the Inspections Division on-line at [www.portlandmaine.gov](http://www.portlandmaine.gov), or stop by the Inspections Division office, room 315 City Hall or call 874-8703.

I hereby certify that I am the Owner of record of the named property, or that the owner of record authorizes the proposed work and that I have been authorized by the owner to make this application as his/her authorized agent. I agree to conform to all applicable laws of this jurisdiction. In addition, if a permit for work described in this application is issued, I certify that the Code Official's authorized representative shall have the authority to enter all areas covered by this permit at any reasonable hour to enforce the provisions of the codes applicable to this permit.

Signature: *Architect*  
**Elizabeth Chapman** Date: **1/10/08**

**This is not a permit; you may not commence ANY work until the permit is issued.**

This page contains a detailed description of the Parcel ID you selected. Press the **New Search** button at the bottom of the screen to submit a new query.

### Current Owner Information

<b>Card Number</b>	1 of 1
<b>Parcel ID</b>	139 D041001
<b>Location</b>	31 MACKWORTH ST
<b>Land Use</b>	SINGLE FAMILY
<b>Owner Address</b>	MCCAIN MELISSA D 31 MACKWORTH ST PORTLAND ME 04103
<b>Book/Page</b>	22108/311
<b>Legal</b>	139-D-41 MACKWORTH ST 31  11850 SF

### Current Assessed Valuation

<b>Land</b>	<b>Building</b>	<b>Total</b>
\$133,900	\$155,300	\$289,200

### Property Information

<b>Year Built</b>	<b>Style</b>	<b>Story Height</b>	<b>Sq. Ft.</b>	<b>Total Acres</b>	
1900	Old Style	2	1967	0.272	
<b>Bedrooms</b>	<b>Full Baths</b>	<b>Half Baths</b>	<b>Total Rooms</b>	<b>Attic</b>	<b>Basement</b>
4	1	2	8	None	Full

### Outbuildings

<b>Type</b>	<b>Quantity</b>	<b>Year Built</b>	<b>Size</b>	<b>Grade</b>	<b>Condition</b>
GARAGE-WD/CB	1	1960	20X22	C	A

### Sales Information

<b>Date</b>	<b>Type</b>	<b>Price</b>	<b>Book/Page</b>
12/10/2004	LAND + BLDING	\$377,500	22108-311
10/01/1995	LAND + BLDING	\$143,300	12151-331

### Picture and Sketch

[Picture](#)      [Sketch](#)      [Tax Map](#)

[Click here](#) to view Tax Roll Information.

Any information concerning tax payments should be directed to the Treasury office at 874-8490 or [e-mailed](#).

**New Search!**

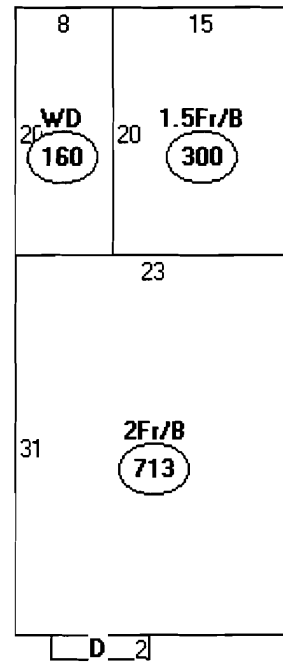
Descriptor/AreaA: 2Fr/B  
713 sqft~~B: WD~~  
180 sqftC: 1.5Fr/B  
300 sqftD: FBAY/B  
16 sqft

= 1029

20x27 garage = 440

new deck = 5x10 = 50





**WEIGEL CONSTRUCTION**

Ben Weigel • 12 Madokawando Ldg. • Falmouth, ME 04105 (207) 781-5569

ATTENTION: Tom Markkeg

Deck SECTION  
addendum to Plan  
by E. Chapman  
For 31 Mackworth St.

existing house  
Wall →

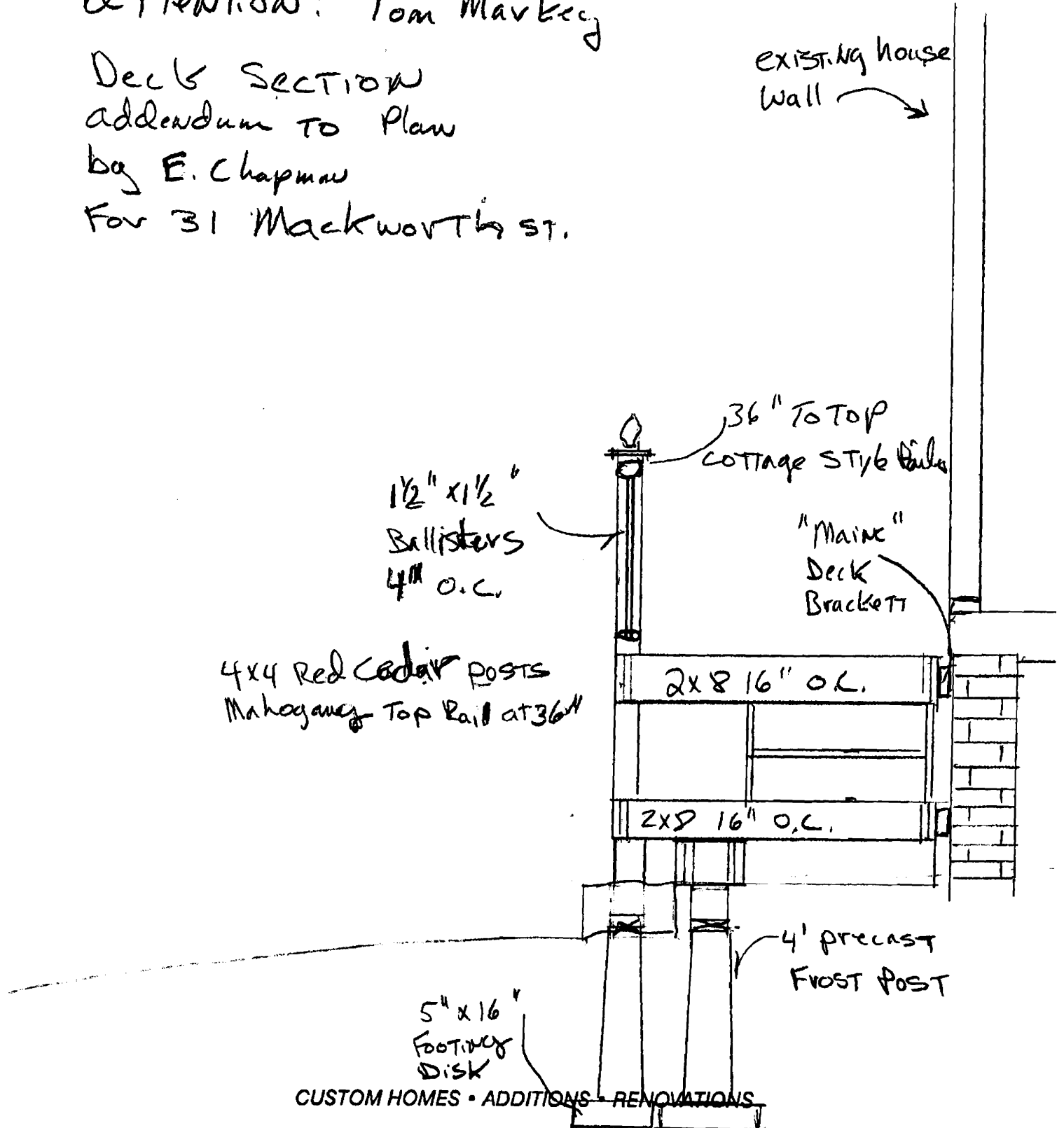



# WEIGEL CONSTRUCTION

Ben Weigel • 12 Madokawando Ldg. • Falmouth, ME 04105 (207) 781-5569

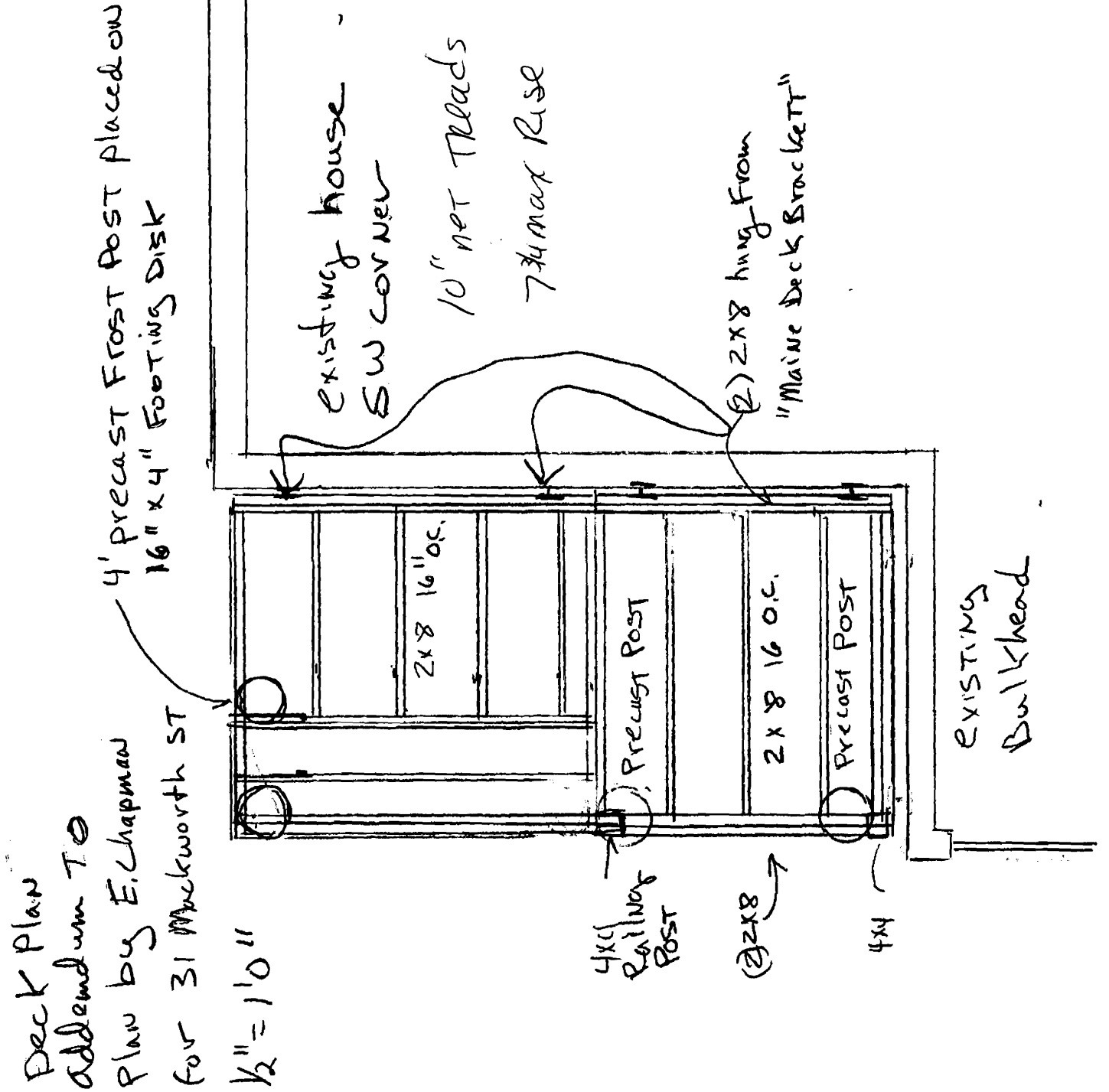

CUSTOM HOMES • ADDITIONS • RENOVATIONS