

9.0 kW_{DC} PHOTOVOLTAIC SYSTEM



142 PRESUMPCOT ST
PORTLAND, ME 04103
(207) 221-6342

CLIENT:

ERIC TOPPER

PROJECT ADDRESS:

80 PARSONS ROAD
PORTLAND, ME 04103

SYSTEM TYPE:

PHOTOVOLTAIC ARRAY

NOT FOR
CONSTRUCTION

DESIGNED BY: BA
REVISION: 0
PRINT SIZE: 8.5" x 11"
SCALE: NTS
DATE: MAY 23, 2017

SITE PLAN

SHEET A01

© COPYRIGHT REVISION ENERGY

THIS DIAGRAM IS PROVIDED AS A SERVICE AND IS BASED ON THE UNDERSTANDING OF THE INFORMATION SUPPLIED. IT IS SUBJECT TO CHANGE BASED ON ACTUAL CONDITIONS, APPLICABLE EDITION OF THE NATIONAL ELECTRIC CODE, AND LOCAL GOVERNMENTAL AUTHORITIES.

SYSTEM SUMMARY:

ITEM	DETAIL
DC SYSTEM SIZE:	9.0 kW _{DC}
AC SYSTEM SIZE:	7.6 kW _{AC}
MODULE TYPE:	(30) HANWHA Q.CELL Q.PEAK G4.1, 60-CELL, 300W
INVERTER:	(1) SOLAREEDGE 7600A-US, 240/120V, 1 PHASE
OPTIMIZER:	(30) SOLAREEDGE P300
RACKING:	ROOF MOUNT, FLUSH
ORIENTATION:	33° TILT, 202° AZIMUTH
LAYOUT:	HOUSE: 2 ROWS OF 9, PORTRAIT GARAGE: 2 ROWS OF 6, PORTRAIT

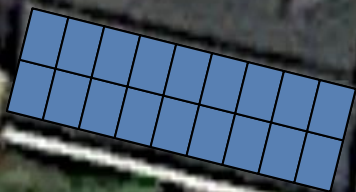

30 ft

1997

Imagery Date: 5/9/2016 43°40'29.23" N 70°16'44.10" W elev 38 ft eye alt 171 ft

Google earth