

THIS IS NOT A BOUNDARY SURVEY

INSPECTION OF PREMISES

I HEREBY CERTIFY TO Douglas Title Co.
Bank of America, N.A. and its Title Insurer

The monumentation is **not** in harmony with current deed description.
The building setbacks are **not** in conformity with town zoning requirements. "Grandfathered"
The dwelling does not **appear** to fall within the special flood hazard zone as delineated by the Federal Emergency Management Agency.
The land does not **appear** to fall within the special flood hazard zone as indicated on community-panel # 230061 0007 B

64 Mackworth Street
Portland, Maine

Job Number: 423-34
Inspection Date: 01-13-14
Scale: 1" = 20'

BUYER: Holly H. Brooks
SELLER: Kathleen A. Norris &
Clifford S. Greene

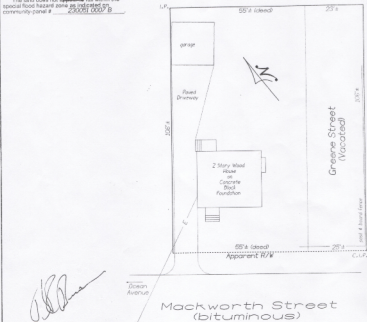

[Handwritten Signature]

THIS PROPERTY IS SUBJECT TO ALL RIGHTS AND EASEMENTS OF RECORD, THOSE THAT ARE EVIDENT ARE SHOWN. THIS PLAN MIGHT NOT REVEAL CONFLICTS WITH ADJUTING DEEDS.

Bruce R. Bowman
INCORPORATED
130 Granite Ridge Road
New Gloucester, Maine 04260
Tel./Fax (207) 924-8013



PLAN BOOK 3 PAGE 10 LOT 9+
DEED BOOK 11449 PAGE 349 COUNTY Cumberland

THIS PLAN IS NOT FOR RECORDING Drawn by: BRB