

2x4 studs 16 or 3/4 in center horizontals

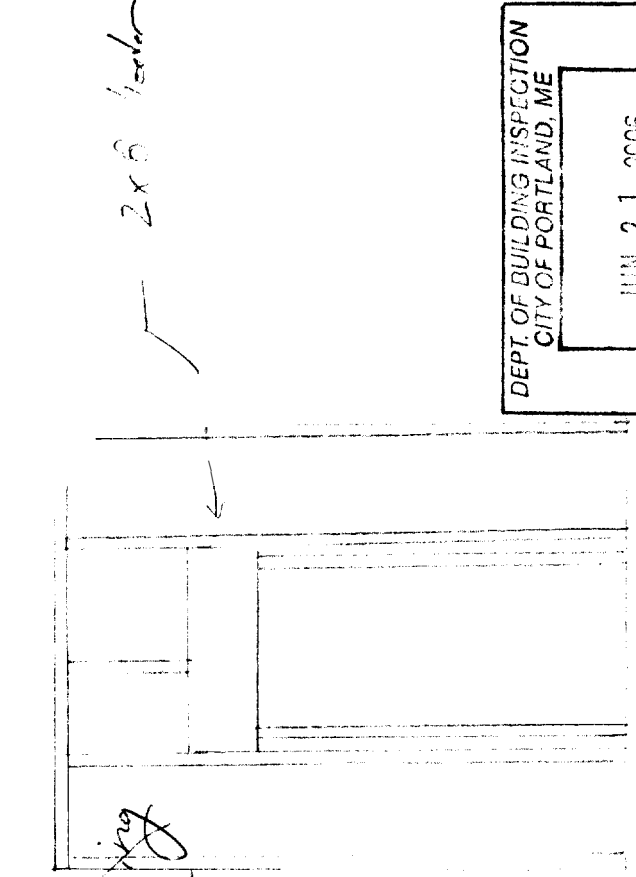

framing in existing opening of garage - OR

Existing garage door - 16' wide - reducing opening to 9' - existing header in place - add new bearing -

DEPT. OF BUILDING INSPECTION  
CITY OF PORTLAND, ME  
JUN 21 2006  
RECEIVED

Cost \$2,000

Chris Desimone 12 Bryant Street

PLAT MAP

Client Christopher & Heather DeSimone

12 Bryant Street  
Portland

County Cumberland

State ME

Zip Code 04103

Client Residential Mortgage Services

01/17/2006 02:35 FAX

RMS

SOLARI

0087009

FOR MORTGAGE LENDER USE ONLY

General note: (1) Dimensions shown are taken from provided title references shown below. (2) This inspection examines building and necessary structure compliance with regard to structural meeting seismic requirements only. (3) A Standard Boundary Survey should be performed to resolve a professional opinion as to actual property line locations. (4) This inspection depicts all visible structural improvements with respect to referenced property lines and recognizes only those elements of visible of work stated or shown in same provided title reference and does not reveal any conflicts with building code. (5) Flood hazard determination is made by zoning districts as below referenced FEMA Map. (6) This inspection is to be used only by the below listed lender, title company &/or attorney and its title insurer.

Address: 12 Bryant Street  
Portland, Maine

Inspection Date: 2-21-01

Scale: 1" = 20'

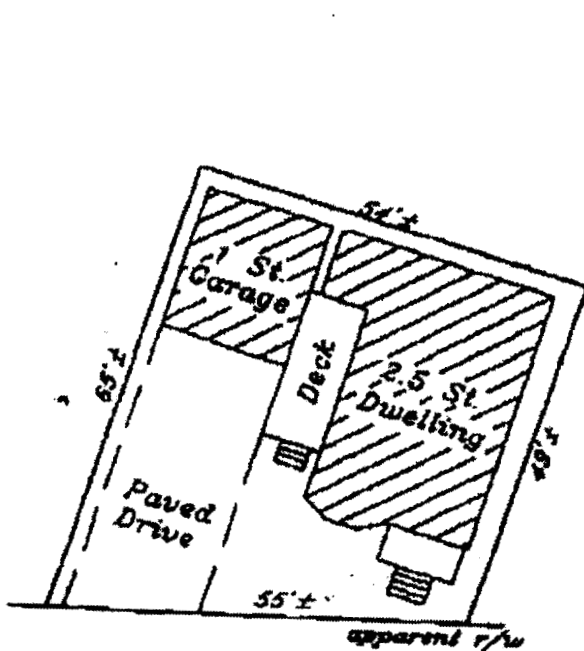

Bryant Street

See title references for appurtenances.

Applicant: Nancy Briffett

Owner: David Craig & Eric Olson

Lender: First Financial Mortgage Corp

Requesting Party: New England Title

Attorney:

File # 2019410 Field Book: 203-11

Title References:

Deed Book: 8302 Page: 81

Plan Book: Page: Lot:

County: Cumberland

Municipal References:

Map: 138 Block: A Lot: 1

The dwelling does not fall within a Special Flood Hazard Zone Per FEMA Community Map No. 830051 Parcel: Zone: C Date: 12-8-98

The dwelling was built in compliance with municipal zoning setback requirements at the time of construction.

Nadeau & Lodge, Inc.  
Professional Land Surveyors

244 Stevens Avenue  
Portland, Maine 04105  
(207) 778-7878

232 Clark Street  
Lewiston, Maine 04242  
(207) 852-4321

James J. Nadeau