

DISPLAY THIS CARD ON PRINCIPAL FRONTAGE OF WORK

CITY OF PORTLAND

BUILDING INSPECTION

PERMIT

Please Read Application And Notes, If Any, Attached

Permit Number: 061530

PERMIT ISSUED

NOV - 2 2006

CITY OF PORTLAND

This is to certify that MARDIGAN STEPHEN E. Knickel Design and Fabrication

has permission to install new 14' exhaust hood and make-up air & duct work

AT 865 FOREST AVE L 137 C011001

provided that the person or persons in firm or organization accepting this permit shall comply with all of the provisions of the Statutes of Maine and of the Ordinances of the City of Portland regulating the construction, maintenance and use of buildings and structures, and of the application on file in this department.

Apply to Public Works for street line and grade if nature of work requires such information.

Notification of inspection must be given and when permission procured before this building or part thereof is occupied or service closed-in. 4 HOUR NOTICE REQUIRED.

A certificate of occupancy must be procured by owner before this building or part thereof is occupied.

OTHER REQUIRED APPROVALS

Fire Dept. Greg Case
Health Dept.
Appeal Board
Other Department Name

William A. Collins 11/3/06
Director - Building & Inspection Services

PENALTY FOR REMOVING THIS CARD

Scanned

City of Portland, Maine - Building or Use Permit Application

389 Congress Street, 04101 Tel: (207) 874-8703, Fax: (207) 874-8716

Permit No: 06-1530	Issue Date: PERMIT ISSUED NOV - 2 2006	CBL: 137 C011001
--------------------	--	------------------

Location of Construction: 865 FOREST AVE	Owner Name: MARDIGAN STEPHEN E	Owner Address: 460 BAXTER BLVD	Phone:
Business Name:	Contractor Name: Henckel Design and Fabrication	Contractor Address: 134 Hartley Street Portland	Phone: 2073 82623
Lessee/Buyer's Name	Phone:	Permit Type: Hood Systems, Commerical	Zone: B2

Past Use: Commercial/ Restaraunt ↓ OK # 06-1058	Proposed Use: Restaraunt- install new 14' exhaust hood and make-up air & Duct work	Permit Fee: \$60.00	Cost of Work: \$3,500.00	CEO District: 4	
Proposed Project Description: install new 14' exhaust hood and make-up air & Duct work		FIRE DEPT: <input checked="" type="checkbox"/> Approved <input type="checkbox"/> Denied TO NPPA 96	INSPECTION: Use Group: A2 Type: I KITCHEN HOOD JMC 2003		

Signature: *Cerec Card* Signature: *[Signature]* 10/31/06

PEDESTRIAN ACTIVITIES DISTRICT (P.A.D.)

Action: Approved Approved w/Conditions Denied

Signature: _____ Date: _____

Permit Taken By: ldobson	Date Applied For: 10/18/2006	Zoning Approval		
-----------------------------	---------------------------------	------------------------	--	--

<ol style="list-style-type: none"> This permit application does not preclude the Applicant(s) from meeting applicable State and Federal Rules. Building permits do not include plumbing, septic or electrical work. Building permits are void if work is not started within six (6) months of the date of issuance. False information may invalidate a building permit and stop all work.. 	Special Zone or Reviews <input type="checkbox"/> Shoreland <input type="checkbox"/> Wetland <input type="checkbox"/> Flood Zone <input type="checkbox"/> Subdivision <input type="checkbox"/> Site Plan Maj <input type="checkbox"/> Minor <input type="checkbox"/> MM <input type="checkbox"/> Date: <i>10/27/06</i>	Zoning Appeal <input type="checkbox"/> Variance <input type="checkbox"/> Miscellaneous <input type="checkbox"/> Conditional Use <input type="checkbox"/> Interpretation <input type="checkbox"/> Approved <input type="checkbox"/> Denied Date: _____	Historic Preservation <input checked="" type="checkbox"/> Not in District or Landmark <input type="checkbox"/> Does Not Require Review <input type="checkbox"/> Requires Review <input type="checkbox"/> Approved <input type="checkbox"/> Approved w/Conditions <input type="checkbox"/> Denied Date: _____
	Signature: <i>ok with conditions</i>		

CERTIFICATION

I hereby certify that I am the owner of record of the named property, or that the proposed work is authorized by the owner of record and that I have been authorized by the owner to make this application as his authorized agent and I agree to conform to all applicable laws of this jurisdiction. In addition, if a permit for work described in the application is issued, I certify that the code official's authorized representative shall have the authority to enter all areas covered by such permit at any reasonable hour to enforce the provision of the code(s) applicable to such permit.

SIGNATURE OF APPLICANT	ADDRESS	DATE	PHONE
RESPONSIBLE PERSON IN CHARGE OF WORK, TITLE		DATE	PHONE



General Building Permit Application

If you or the property owner owes real estate or personal property taxes or user charges on any property within the City, payment arrangements must be made before permits of any kind are accepted.

Location/Address of Construction: <u>865 Forest Portland Me 04103</u>		
Total Square Footage of Proposed Structure		Square Footage of Lot
Tax Assessor's Chart, Block & Lot Chart# <u>137</u> Block# <u>C</u> Lot# <u>11</u>		Owner: <u>Steve Mordigan</u> Telephone: <u>772-5555</u>
Lessee/Buyer's Name (If Applicable) <u>Erik Richardson</u> <u>3 Eisenhower</u> <u>Westbrook Me 04092</u>		Applicant name, address & telephone: <u>Pete Hawckel</u> <u>134 Hattag St</u> <u>Portland Me 04103</u>
Current Specific use: <u>RESTAURANT</u>		Cost Of Work: \$ <u>3500</u>
If vacant, what was the previous use? <u>RESTAURANT</u>		Fee: \$ _____
Proposed Specific use: <u>RESTAURANT</u>		C of O Fee: \$ _____
Project description: <u>INSTALL NEW 4' exhaust Hood and make up</u> <u>Air- and DUCT WORK.</u>		
Contractor's name, address & telephone:		
Who should we contact when the permit is ready: <u>Pete Hawckel</u>		
Mailing address:		Phone: <u>207-313-2623</u>

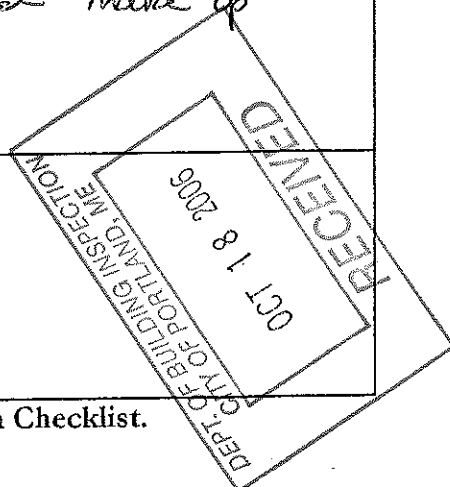

Please submit all of the information outlined in the Commercial Application Checklist. Failure to do so will result in the automatic denial of your permit.

In order to be sure the City fully understands the full scope of the project, the Planning and Development Department may request additional information prior to the issuance of a permit. For further information visit us on-line at www.portlandmaine.gov, stop by the Building Inspections office, room 315 City Hall or call 874-8703.

I hereby certify that I am the Owner of record of the named property, or that the owner of record authorizes the proposed work and that I have been authorized by the owner to make this application as his/her authorized agent. I agree to conform to all applicable laws of this jurisdiction. In addition, if a permit for work described in this application is issued, I certify that the Code Official's authorized representative shall have the authority to enter all areas covered by this permit at any reasonable hour to enforce the provisions of the codes applicable to this permit.

Signature of applicant: <u>[Signature]</u>	Date: <u>10-17-06</u>
--	-----------------------

This is not a permit; you may not commence ANY work until the permit is issued.

City of Portland, Maine - Building or Use Permit

389 Congress Street, 04101 Tel: (207) 874-8703, Fax: (207) 874-8716

Permit No: 06-1530	Date Applied For: 10/18/2006	CBL: 137 C011001
-----------------------	---------------------------------	---------------------

Location of Construction: 865 FOREST AVE	Owner Name: MARDIGAN STEPHEN E	Owner Address: 460 BAXTER BLVD	Phone:
Business Name:	Contractor Name: Henckel Design and Fabrication	Contractor Address: 134 Hartley Street Portland	Phone (207) 318-2623
Lessee/Buyer's Name	Phone:	Permit Type: Hood Systems, Commerical	

Proposed Use: Restaraunt- install new 14' exhaust hood and make-up air & Duct work	Proposed Project Description: install new 14' exhaust hood and make-up air & Duct work
---	---

Dept: Zoning **Status:** Approved with Conditions **Reviewer:** Marge Schmuckal **Approval Date:** 10/27/2006

Note: **Ok to Issue:**

- 1) This permit is being approved on the basis of plans submitted. Any deviations shall require a separate approval before starting that work.
- 2) All external effects requirements under the B-2 Zone SHALL be met including noise/sound regulations. Violations of noise requirements are aggressively enforced.

Dept: Building **Status:** Approved with Conditions **Reviewer:** Michael A. Collins **Approval Date:**

Note: **Ok to Issue:**

- 1) Equipment must be installed in compliance with the manufacturer's specifications
- 2) Separate permits are required for any electrical, plumbing, or HVAC systems. Separate plans may need to be submitted for approval as a part of this process.

Dept: Fire **Status:** Approved with Conditions **Reviewer:** Cptn Greg Cass **Approval Date:** 10/30/2006

Note: **Ok to Issue:**

- 1) Install shall comply with NFPA 96

Comments:

10/27/2006-mes: permit #06-1058 approves the restaurant use

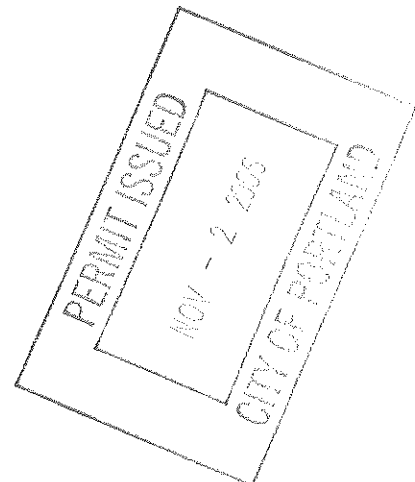



ASSOCIATED DESIGN PARTNERS INC.

Office: 207.878.1751
Fax: 207.878.1788
e-mail: adp@adpengineering.com

80 Leighton Road • Falmouth, Maine 04105

October 13, 2006

06183

Erik Richardson
3 Eisenhower Drive
Westbrook, Maine 04092

RE: New Hood at 865 Forest Ave

Dear Erik:

I was contacted by Gary Noble (mechanical contractor) to investigate the existing roof framing where a new exhaust hood is proposed to be installed at 865 Forest Ave. Based on information provided by Henkle Design (hood supplier), the hood measures 14 ft long X 4.5 ft wide, and weighs approximately 387 lbs. The existing roof joists are 16" deep manufactured I-joists, with plywood webs. Additional plywood infill has been added to the I-joists to make them appear as full 1.5" X 16" wood joists. I have accounted for this additional plywood infill in the analysis. The joists span approx. 24ft from the exterior wall, to a assumed load bearing ridge beam that is concealed by interior finishes.

I analyzed the joists with a code specified uniform snow load of 42psf, and an approximate roof dead load of 12psf. According to Henkle Design, the hood will be supported by (4) hanging rods, one in each corner. The hood is located so that no more than one rod will be installed on any one joist. Therefore, in addition to the uniform load, we applied a 100lb point load to one of the joists that will be supporting the hood. Since the actual properties of the wood used in the fabrication of the wood I-joists are unknown, we assumed that the wood species is SPF #1/#2 with a $F'b = 1157$ psi ($F_b = 875$ psi, $C_d = 1.15$, $C_r = 1.15$) for the purposes of our analysis.

Based on the above assumptions and information provided by Henkle Design, I have determined that the existing roof framing appears adequate to support the IBC 2003 code specified snow load, approximated dead loads, and hood load. My investigation and analysis was limited to the roof joists in the area of the hood only; all other framing and connections are excluded from the investigation, the analysis, and this letter.

In addition to the new hood, the contractor is proposing to remove two existing exhaust fans, and replace them with new fans. The new fans will be located in the same roof penetrations as the existing fans. Since the new fans are approximately the same size as the existing fans, and since no modifications to the penetrations are necessary, it appears that the roof has sufficient capacity to support the new fans. It should be noted that the hood will not be supported by the joists located at the roof penetrations for the exhaust fans.

Please call should you have any additional questions.

Thank you,

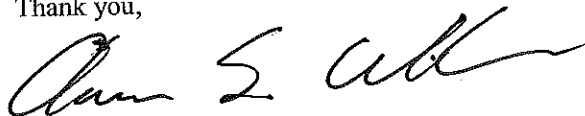

Aaron Wilson, P.E.
Structural Engineer
Associated Design Partners, Inc
207-878-1751

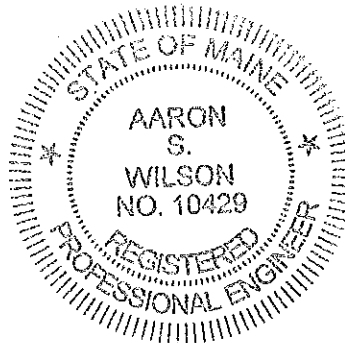



Henckel Design and Fabrication

134 Hartley Street
Portland, Maine
04103

Phone: 1-207-318-2623
Fax: 1-207-772-8952
E-mail: petehenckel@maine.rr.com

October 16, 2006

Gary, here is the information requested for the hood installation at #865 Forest Ave
In Portland Me if you should have any questions after you read this please feel free to
Call at any time.

- #1. One fourteen foot hood will be installed to local NFPA code.
- #2. sixteen gauge black iron welded duct work will be installed to local NFPA code.
- #3. One roofing curb will be installed using an existing opening for the make up air.
- #4. one exhaust fan will be installed using an existing wall mounted curb.
- #5. the new make up air system will be ducted into the building.
- #6. 22 gauge stainless steel will be installed behind the area where the hood meets
The wall.
- #7. A UL rated fire barrier insulation will be used when ever the exhaust duct comes
To close to a consumable item as well as the hood it self.

The work listed above will be code compliant, if you would like to proceed with this
quote a 50% deposit will be required with the balance to be paid when the work is
completed.

The quote for the work listed above is \$3500.00

- Restaurant Hoods • Boiler Breaching • HVAC Design • Curb Adapters and Unit Installations •
• Welded Ducting • Custom Welding Fabrication •

NSAU-1 AND NSAU-2 SERIES DOWN DISCHARGE SUPPLY FANS

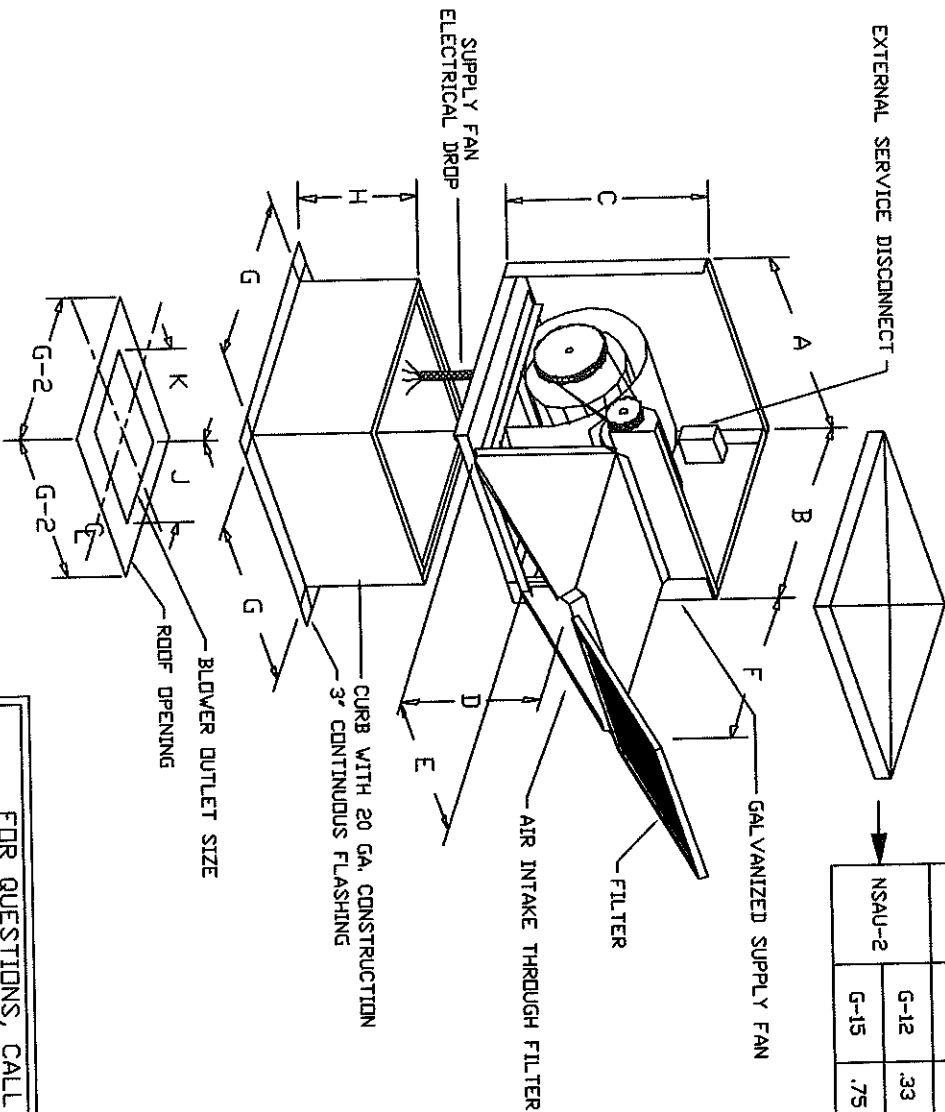

SUPPLY AIR UNIT DIMENSIONAL DATA

MODEL	BLOWER RANGE	HP RANGE	A	B	C	D	E	F	FILTER QTY.	FILTER SIZE	WEIGHT
NSAU-1	G-10	.33 - 2	26	32	28	20	20	26	2	16' X 20'	175 LBS
			36	40	35	28.5	25	29	2	20' X 25'	275 LBS
NSAU-2	G-15	.75 - 5	36	40	35	28.5	25	53.75	3	20' X 25'	315 LBS

CURB/ROOFTOP DIMENSIONAL DATA

MODEL	BLOWER	G	H	J	K
NSAU-1	G-10	23	14	11-3/4	13-1/2
NSAU-2	G-12	32.5	14	13-3/4	15-7/8
	G-15			16-1/8	18-7/8

PITCHED CURBS ARE AVAILABLE FOR PITCHED ROOFS.

SPECIFY PITCH

EXAMPLE: 7/12 PITCH = 30° SLOPE

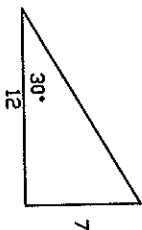

CAPTIVE SYSTEMS, INC. RESERVES THE RIGHT TO MODIFY THE DESIGN, MATERIALS AND/OR SPECIFICATIONS AS A RESULT OF CODE REQUIREMENTS OR PRODUCT ENHANCEMENTS RESULTING FROM Ongoing RESEARCH AND DEVELOPMENT.

FOR QUESTIONS, CALL THE
 MAINE & NEW HAMPSHIRE REGIONAL SALES OFFICE
 124 OHIO HILL RD., FAIRFIELD, ME 04937
 PHONE: (207) 238-9213
 FAX: (207) 238-9238

CUSTOMER APPROVAL TO MANUFACTURE:

Approved as Noted
 Approved with NO Exception Taken
 Revise and Resubmit
 SIGNATURE _____ Date _____
 Your Title _____



JOB	Flirt's	JOB #	503845
LOCATION	Portland, ME	DRAWN BY	BFC
DATE	10/4/2006	SCALE	8.5" x 11"
DWG #	Flirt's		
REV.	1.00		

FAN INFORMATION

FAN UNIT NO.	FAN UNIT MODEL #	EXHAUST FAN							SUPPLY FAN												
		MODEL	TAG	CFM	S.P.	RPM	H.P.	Ø	VOLT	FLA	BLOWER	HOUSING	TAG	CFM	S.P.	RPM	H.P.	Ø	VOLT	FLA	
1	NCA16FA	NCA16FA		3500	1.000'	1170	1.500	1	230	10.2											
2	NSAU2-G12										G12	NSAU2		3150	0.300'	646	1.000	1	230	6.8	

FAN OPTIONS

FAN NO.	OPTION (Qty. - Descr.)
1	1 - Grease Box
2	1 - Gravity Backdraft Damper for Size 2 Housing

CURB ASSEMBLIES

NO. FAN	DN FAN	ITEM	SIZE
1	# 1	Curb	26.500"W x 26.500"L x 20.000"H Vented Hinged
2	# 2	Curb	32.500"W x 32.500"L x 14.000"H

FOR QUESTIONS, CALL THE
 MAINE & NEW HAMPSHIRE REGIONAL SALES OFFICE
 124 OHIO HILL RD., FAIRFIELD, ME 04937
 PHONE: (207) 238-9213
 FAX: (207) 238-9238

CUSTOMER APPROVAL TO MANUFACTURE:

Approved as Noted

Approved with NO Exception Taken

Revise and Resubmit

SIGNATURE _____ Date _____

Your Title _____



JOB	Flirts	JOB #	503845
LOCATION	Portland, ME	DRAWN BY	BFC
DATE	10/4/2006	SCALE	8.5' x 11'
DWG #	Flirts		
REV.	1.00		

HOOD INFORMATION				EXHAUST PLENUM				SUPPLY PLENUM				HOOD CONFIG.	
HOOD NO.	MODEL	LENGTH	MAX. COOKING TEMP.	TOTAL EXH. CFM	RISERS(S)	TOTAL SUP. CFM	RISERS(S)	CONSTRUCTION	END TO END	ROW	ALONE	N/A	
1	5424 ND-2	14' 0.007Nom 14' 0.007OD	600 Deg.	3500	14' 24'	3500	0.578'	430 SS Where Exposed					



HOOD NO.	TYPE	FILTER(S)			LIGHT(S)			WIRE GUARD	LOCATION	FIRE SYSTEM		ELECTRICAL MODEL #	QUANTITY	SWITCHES LOCATION	FIRE SYSTEM PIPING	HOOD WEIGHT LBS.
		QTY	HEIGHT	LENGTH	QTY	TYPE	SIZE									
1	Alum. Baffle w/ Handle	6	16"	20"	4	Incandescent Light	ND									387

SPECIFICATIONS: ND MODEL

THE MODEL ND IS A CANOPY HOOD WITH OPTIONAL REAR DISCHARGE MAKE-UP AIR THROUGH A REAR PLENUM (NDBR). THE HOOD COMPONENTS SHALL BE FABRICATED OF TYPE 430 STAINLESS STEEL, #3 OR #4 POLISH, ON ALL EXPOSED SURFACES. CONSTRUCTION SHALL BE IN ACCORDANCE WITH NFPA 96. THE HOOD SHALL BE PROVIDED WITH HANGING ANGLES ON EACH END OF THE HOOD. AN ADDITIONAL SET OF HANGING ANGLES WILL BE PROVIDED FOR HOODS GREATER THAN 12' IN LENGTH.

THE HOOD SHALL BE FITTED WITH U.L. CLASSIFIED BAFLE TYPE FILTERS OR S/STEEL HIGH VELOCITY CARTRIDGE FILTERS. EACH FILTER SHALL BE EASILY REMOVABLE FOR CLEANING. THE FILTERS WILL DRAIN THE GREASE INTO A SLOPED GREASE DRAIN SYSTEM WITH REMOVABLE 1/2 PINT CUP FOR EASY CLEANING. HOOD LIGHTS SHALL BE U.L. LISTED SUITABLE FOR GREASE HOODS AND SHALL BE SUPPLIED WITH PLASTIC COATED GLOBES. EACH LIGHT WILL ACCOMMODATE UP TO A STANDARD 100 WATT BULB. ALL LIGHTS WILL BE PRE-WIRED TO JUNCTION BOXES ON TOP OF THE HOOD. HOOD DIMENSIONS SHALL BE AS SHOWN ON DRAWINGS.

ETL LISTING DESCRIPTION
THE CAPTIVE AIRE MODEL ND-2 HAS BEEN E.T.L. TESTED, LISTED, AND APPROVED TO EXHAUST A MINIMUM OF 200 CFM PER LINEAR FOOT OVER 600 DEGREE COOKING EQUIPMENT

CAPTIVE-AIRE HOODS ARE BUILT IN COMPLIANCE WITH

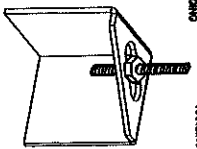

 NFPA #96
 NSF
 UL 710 & ULCT10 STANDARDS
 E.T.L. LISTED 3054804-001



ND-2 HANGING ANGLE DETAIL

1. ALL ELECTRICAL "FIELD" CONNECTIONS AND RELATED INTERCONNECTIONS BY ELECTRICAL CONTRACTORS.
2. ALL PLUMBING "FIELD" CONNECTIONS AND RELATED INTERCONNECTIONS BY PLUMBING CONTRACTORS.
3. ALL ASSOCIATED HANGER MATERIALS BY INSTALLING CONTRACTORS.
4. LONG FACTORY LOCATED AND WELDED HANGER BRACKETS AS SHOWN ON PLANS.
5. ALL CONNECTIONS FROM CAPTIVE-AIRE DUCT PER THE PLANS BY MECHANICAL CONTRACTORS.
6. ALL LIGHTS SHOWN INSTALLED BY CAPTIVE-AIRE ARE FACTORY PREWIRED PER THE PLANS. INTERCONNECTIONS BETWEEN HOODS AND TO SWITCHES BY ELECTRICAL CONTRACTOR.
7. LAMPS FOR LIGHT FIXTURES BY INSTALLING CONTRACTORS.
8. SERVIC RESTRAINTS ARE RESPONSIBILITY OF INSTALLING CONTRACTOR.
9. INSTALLING CONTRACTORS ASSUME ALL RELATED RESPONSIBILITY FOR VERIFICATION OF DIMENSIONAL DATA CONTAINED ON THESE DOCUMENTS FOR ACCURACY, INTEGRATION, AND ADMINISTRATION OF CODE REQUIREMENTS IN EVERY FRANK TO SHOW. RELEASE FOR PRODUCTION OF EQUIPMENT SHALL BE SIGNED AND "APPROVED" COPIES OF THIS DOCUMENT MUST BE RECEIVED BY THE MANUFACTURER. COMMENCEMENT OF FABRICATION.
10. NOMINAL HOOD DIMENSIONS AS SHOWN ON DRAWINGS.

GENERAL NOTES

EXHAUST GRAB LENGTH OF HOOD X CFM/LINFT. (LOAD)
 SUPPLY GRAB=EXHAUST CFM X PERCENTAGE REQUIRED
 TOTAL DUCT AREA=144 X _____ CFM
 DUCT LENGTH= _____ TOTAL DUCT AREA
 DUCT DEPTH _____

*CAPTIVE-AIRE VENTILATOR DUCT SIZES ARE CALCULATED USING AN EXHAUST CAPACITY OF 400-1800 FPM AND A SUPPLY VELOCITY OF 1000 FPM. PLEASE CONSULT FACTORY FOR MAXIMUM ALLOWABLE DUCT SIZES

CALCULATIONS UTILIZED

FOR QUESTIONS, CALL THE
 MAINE & NEW HAMPSHIRE REGIONAL SALES OFFICE
 124 OHIO HILL RD., FAIRFIELD, ME 04937
 PHONE: (207) 238-9213
 FAX: (207) 238-9238

CUSTOMER APPROVAL TO MANUFACTURE:

Approved as Noted

Approved with ND Exception Taken

Revise and Resubmit

SIGNATURE _____ Date _____

Your Title _____

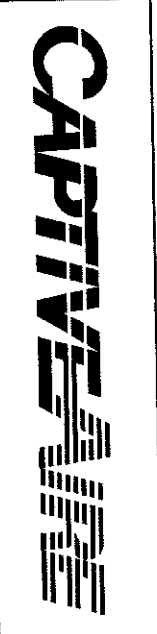

JOB	Flirt's	JOB #	503845
LOCATION	Portland, ME	DRAWN BY	BFC
DATE	10/4/2006	SCALE	8.5' x 11'
DWG #	Flirt's		
REV	1.00		

NCAFA SERIES UPBLAST EXHAUST FANS (UL762)

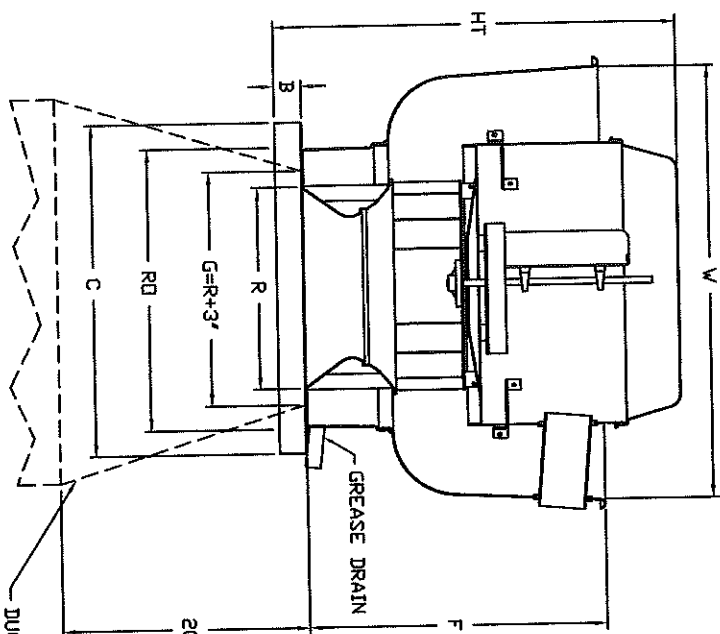

FEATURES:

- ROOF MOUNTED FANS
- RESTAURANT MODEL
- UL762
- AMCA SOUND AND AIR CERTIFIED
- WIRING FROM MOTOR TO DISCONNECT SWITCH
- WEATHERPROOF DISCONNECT
- HIGH HEAT OPERATION 300°F (149°C)
- GREASE CLASSIFICATION TESTING

NORMAL TEMPERATURE TEST:
 NORMAL TEMPERATURE TEST EXHAUST FAN MUST OPERATE CONTINUOUSLY WHILE EXHAUSTING AIR AT 300°F (149°C) UNTIL ALL FAN PARTS HAVE REACHED THERMAL EQUILIBRIUM, AND WITHOUT ANY DETERIORATING EFFECTS TO THE FAN WHICH WOULD CAUSE UNSAFE OPERATION.

ABNORMAL FLARE-UP TEST:
 ABNORMAL FLARE-UP TEST EXHAUST FAN MUST OPERATE CONTINUOUSLY WHILE EXHAUSTING BURNING GREASE VAPORS AT 600°F (316°C) FOR A PERIOD OF 15 MINUTES WITHOUT THE FAN BECOMING DAMAGED TO ANY EXTENT THAT COULD CAUSE AN UNSAFE CONDITION.

OPTIONS:

- GREASE BOX
- HINGED FAN

DUCTWORK BETWEEN EXHAUST RISER ON HOOD AND FAN (BY OTHERS)

NCAFA BELT DRIVE CENTRIFUGAL UP-BLAST EXHAUST FANS DIMENSIONAL DATA

FAN MODEL	HT	W	B	C	F	R	RD	WEIGHT LB
NCA16FA	33 3/4	38	2	28	23 1/2	16 1/2	24 1/2	190

FOR QUESTIONS, CALL THE
 MAINE & NEW HAMPSHIRE REGIONAL SALES OFFICE
 124 OHIO HILL RD., FAIRFIELD, ME 04937
 PHONE: (207) 238-9213
 FAX: (207) 238-9238

CUSTOMER APPROVAL TO MANUFACTURE:

Approved as Noted

Approved with ND Exception Taken

Revise and Resubmit

SIGNATURE _____ Date _____

Your Title _____

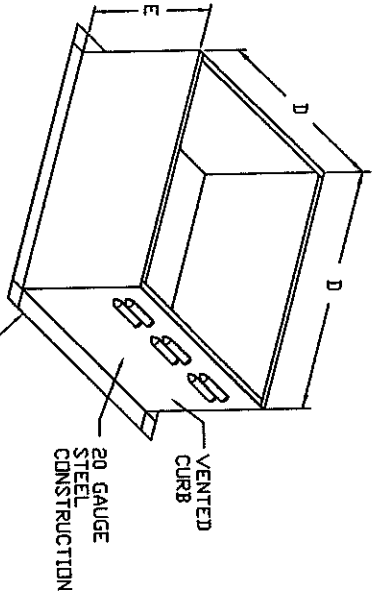

PITCHED CURBS ARE AVAILABLE FOR PITCHED ROOFS.

SPECIFY PITCH:
 EXAMPLE: 7/12 PITCH = 30° SLOPE

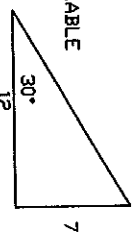

CURB DIMENSIONAL DATA

FAN MODEL	D	E
NCA16FA	26 1/2	20



JOB	Flirts	JOB #	SCALE
LOCATION	Portland, ME	503845	8.5' x 11'
DATE	10/4/2006	DRAWN BY	BFC
DWG #	Flirts	REV	1.00

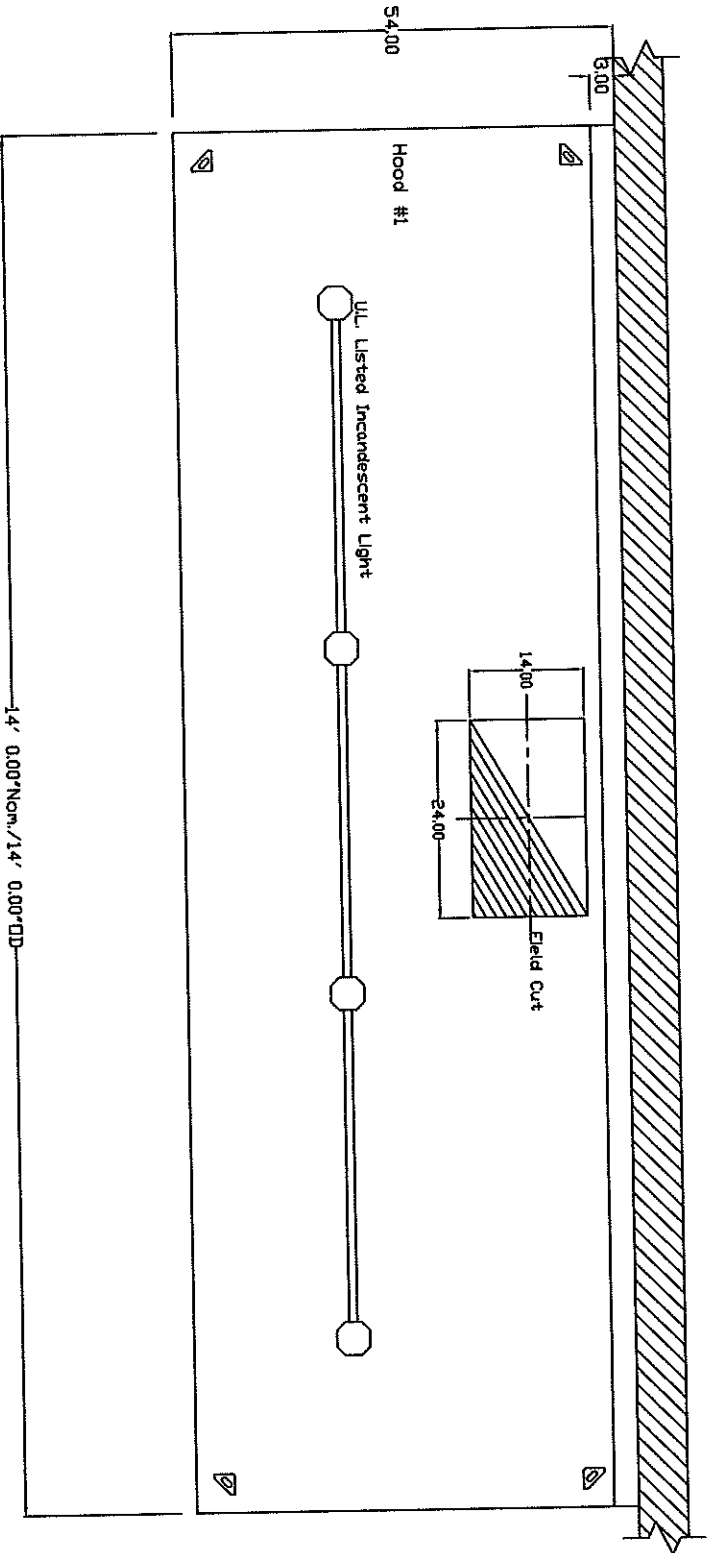

NOTE: Additional hanging angles provided for hoods longer than 12 ft.

FOR QUESTIONS, CALL THE
 MAINE & NEW HAMPSHIRE REGIONAL SALES OFFICE
 124 OHIO HILL RD., FAIRFIELD, ME 04937
 PHONE: (207) 238-9213
 FAX: (207) 238-9238

CUSTOMER APPROVAL TO MANUFACTURE:

Approved as Noted

Approved with ND Exception Taken

Revise and Resubmit

SIGNATURE _____ Date _____

Your Title _____



JOB	Flirts	JOB #	503845
LOCATION	Portland, ME	DRAWN BY	BFC
DATE	10/4/2006	SCALE	8.5' x 11'
DWG #	Flirts		
REV	1.00		

THE HOOD MAY BE INSTALLED WITH A 0 INCH CLEARANCE TO COMBUSTIBLE MATERIALS, IF CONSTRUCTED IN ONE OF THE FOLLOWING METHODS:

- 3" UNINSULATED STANDOFF
- 1" INSULATED STANDOFF
- 1" INSULATED BACKSPASH
- BACK RETURN SUPPLY PLenum

TABLE 1

FOR QUESTIONS, CALL THE
 MAINE & NEW HAMPSHIRE REGIONAL SALES OFFICE
 124 OHIO HILL RD., FAIRFIELD, ME 04937
 PHONE: (207) 238-9213
 FAX: (207) 238-9238

CUSTOMER APPROVAL TO MANUFACTURE:

Approved as Noted

Approved with NO Exception Taken

Revise and Resubmit

SIGNATURE _____ Date _____

Your Title _____

IT IS THE RESPONSIBILITY OF THE ARCHITECT/DOWNER TO ENSURE THAT THE HOOD CLEARANCE FROM LIMITED-COMBUSTIBLE AND COMBUSTIBLE MATERIALS IS IN COMPLIANCE WITH LOCAL CODE REQUIREMENTS

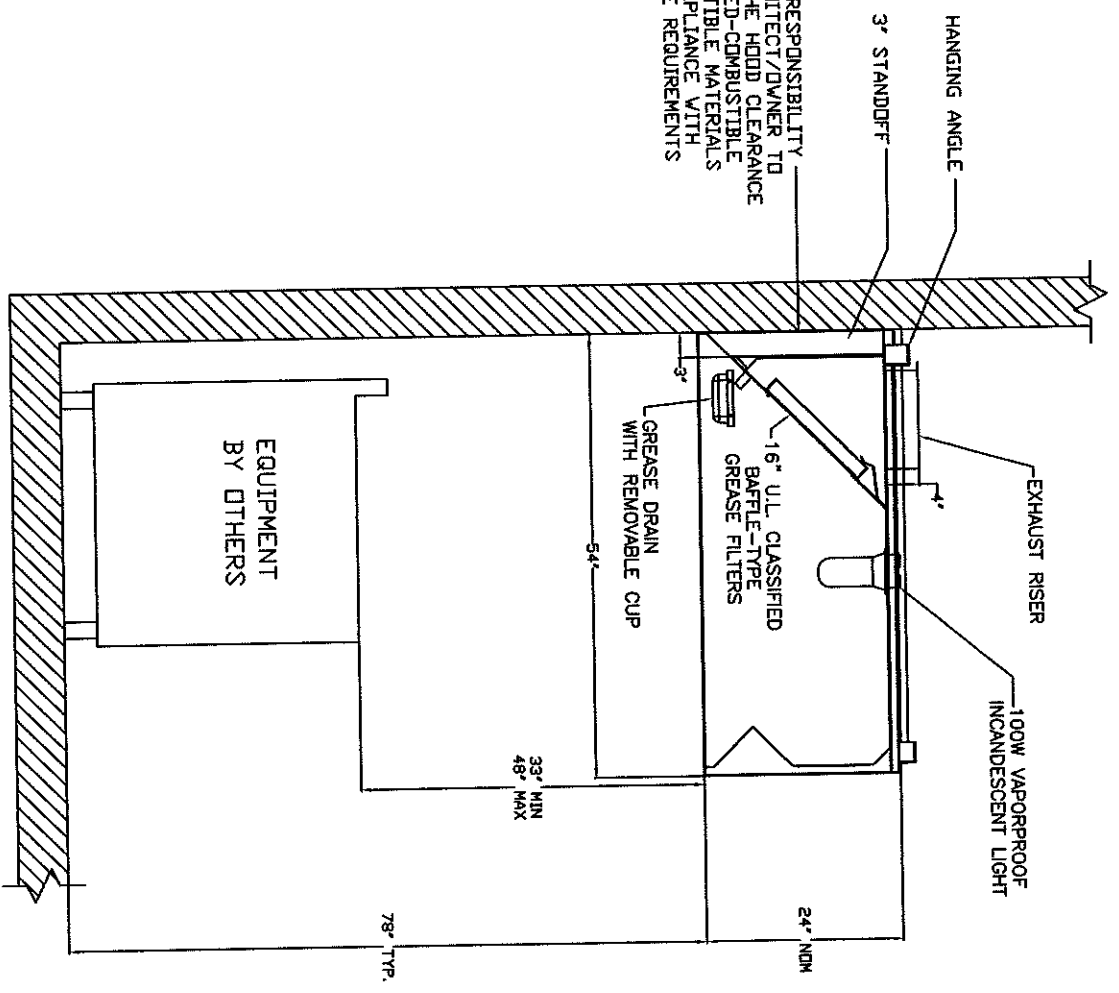

SECTION VIEW - MODEL 5424-ND-2



JOB	Flirts	JOB #	503845
LOCATION	Portland, ME	DRAWN BY	BFC
DATE	10/4/2006	SCALE	8.5' x 11'
DWG #	Flirts		
REV.	1.00		



PORTLAND MAINE

Strengthening a Remarkable City, Building a Community for Life • www.portlandmaine.gov

Lee Urban- Director of Planning and Development
Michael J. Nugent- Inspections Division Director

Kitchen Exhaust System Checklist and Code Provisions

Dear Applicant,

The following is a checklist to assist you in filing for a permit for a Kitchen Exhaust system. The applicable Mechanical Code provisions have also been attached. Please complete this and submit job specific construction documents that demonstrate compliance with the attached information.

Type of System:

Type I Type II

(Type I systems are systems that vent fryers, grills, broilers, ovens or woks. Type II systems are systems that vent steamers and other non grease producing appliances)

Type of Materials:

Is the hood Stainless steel or other type of steel? Stainless If Other, what Type? _____

Is the duct work Stainless steel or other type of steel? Black iron If Other, what type? 16 Ga Black iron ducting

Thickness of the steel for the hood 430 SS

Thickness of the duct for the hood 16 Ga

Type of Hood and Duct supports 3/8 threaded Rod 1 5/8"
UNI-STRUT

Type of seams and Joints welded

Grease Gutters provided? yes

Hood Clearance from Combustibles materials Code Compliant

Duct Clearance from Combustibles materials Code Compliant

Vibration Isolation System:

yes per code

Air Velocity within the duct system No less than 1.500 Ft per Min

Grease accumulation prevention system

2 percent slope

Cleanouts

Grease Duct enclosure Per Code

Exhaust Termination per code

Fire Suppression

system yes

Exhaust fan mounting and clearance from the roof or wall per code

Exhaust fan distance from other vents or openings 10'

Exhaust fan height above adjoining grade 10'

Hood Specs

Style of hood Type I

Type of Filter: Aluminum baffle

Height of filter above nearest cooking surface: per code

Capacity of hood in CFM 3500 CFM

Make up Air system description and capacity

3150 CFM .035 SP

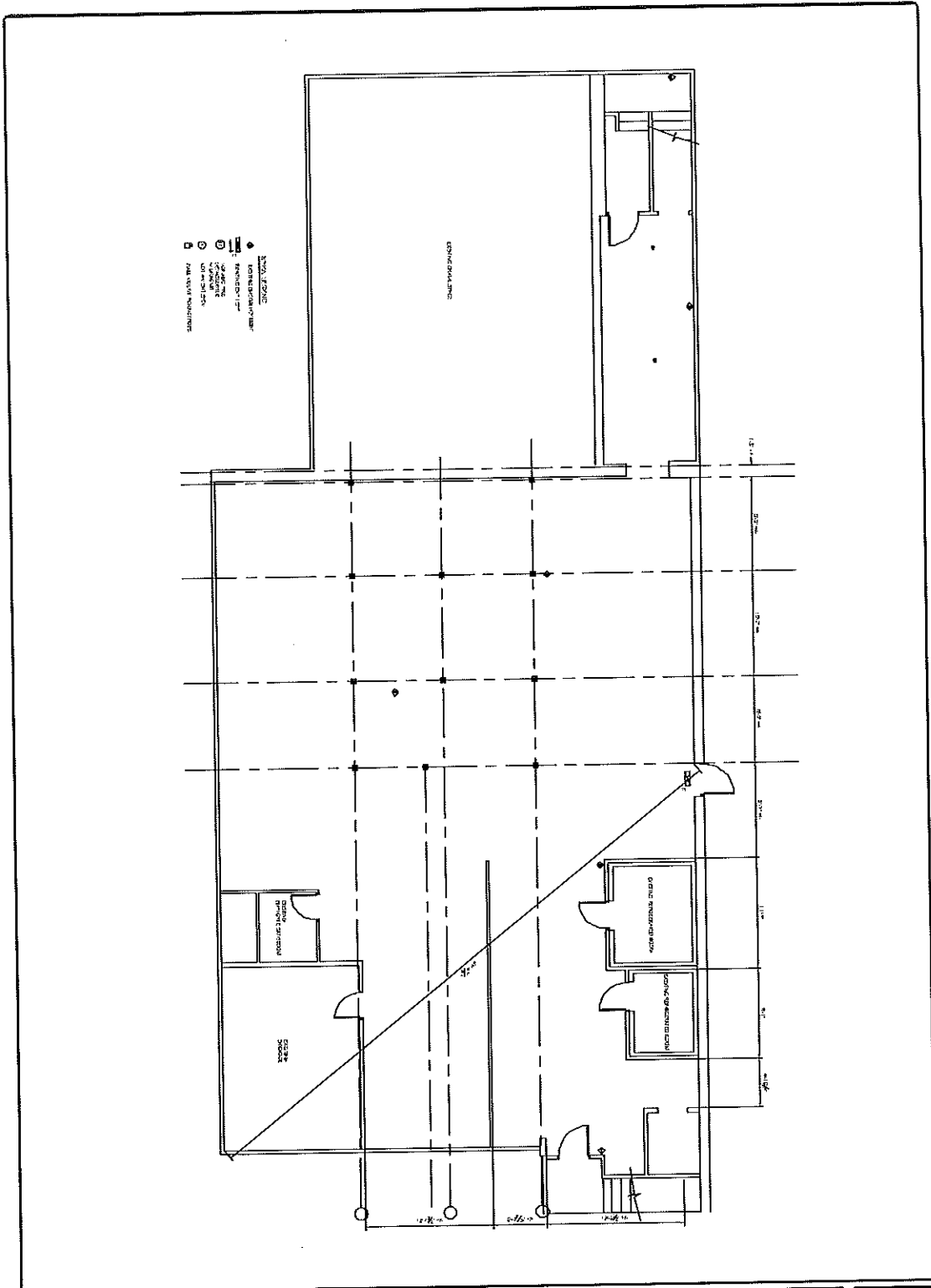

0010
0010
0010

NO.	BY	REVISION	DATE

PROJECT: 665 FOREST AVE.
PORTLAND, MAINE
THEREK RICHARDSON

SHEET TITLE:
**BASEMENT PLAN
ISSUED FOR PERMITTING**

DATE: 06/18/10
SCALE: AS SHOWN

**ASSOCIATED DESIGN
PARTNERS INC.**

35 Brighton Road
Portland, Maine 04102
Phone: (207) 878-1731
Fax: (207) 878-1148
E-Mail: info@adpartners.com

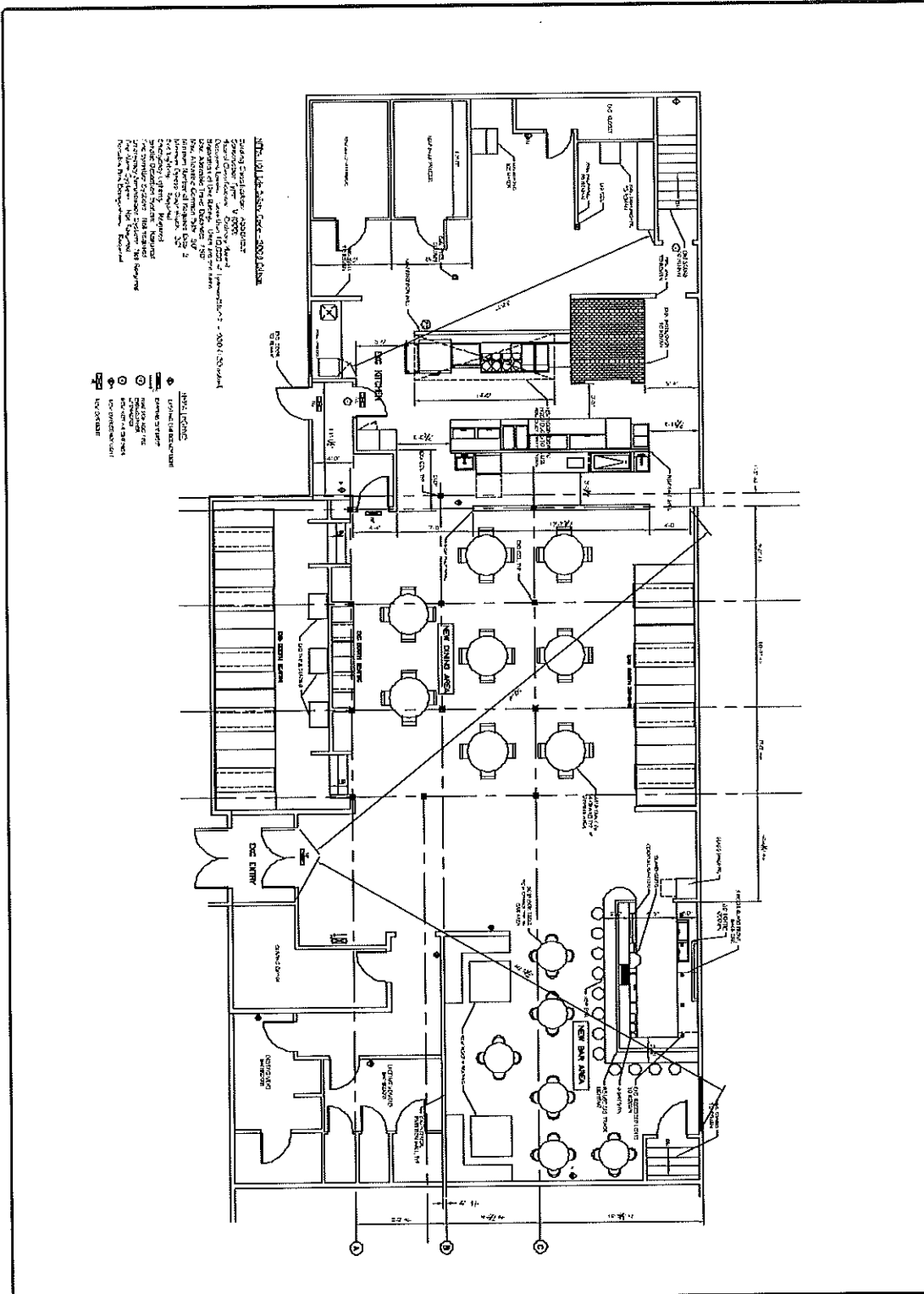

SHEET 101-LA-8530-002-A101
 DRAWING TITLE: **RESTAURANT**
 PROJECT: **865 FOREST AVE. PORTLAND, MAINE**
 DRAWING NO.: **06183-A101**
 DATE: **10/20/07**
 SCALE: **AS SHOWN**
 DRAWN BY: **LA**
 CHECKED BY: **LD**
 APPROVED BY: **LD**
 PROJECT MANAGER: **LD**
 ARCHITECT: **ASSOCIATED DESIGN PARTNERS INC.**
 85 LEIGHTON ROAD
 PORTLAND, MAINE 04103
 TEL: (207) 878-1111
 FAX: (207) 878-1114
 WWW: www.adpinc.com

- NOTES:**
- 1. SEE SHEET 101-LA-8530-001 FOR GENERAL NOTES.
 - 2. ALL DIMENSIONS ARE UNLESS OTHERWISE NOTED.
 - 3. FINISHES TO BE AS SHOWN ON SHEET 101-LA-8530-001.
 - 4. SEE SHEET 101-LA-8530-001 FOR MATERIAL SCHEDULE.
 - 5. SEE SHEET 101-LA-8530-001 FOR ELECTRICAL SCHEDULE.
 - 6. SEE SHEET 101-LA-8530-001 FOR MECHANICAL SCHEDULE.
 - 7. SEE SHEET 101-LA-8530-001 FOR PLUMBING SCHEDULE.
 - 8. SEE SHEET 101-LA-8530-001 FOR STRUCTURAL SCHEDULE.
 - 9. SEE SHEET 101-LA-8530-001 FOR FINISH SCHEDULE.
 - 10. SEE SHEET 101-LA-8530-001 FOR FURNITURE SCHEDULE.
 - 11. SEE SHEET 101-LA-8530-001 FOR LIGHTING SCHEDULE.
 - 12. SEE SHEET 101-LA-8530-001 FOR SOUNDING SCHEDULE.
 - 13. SEE SHEET 101-LA-8530-001 FOR SECURITY SCHEDULE.
 - 14. SEE SHEET 101-LA-8530-001 FOR SIGNAGE SCHEDULE.
 - 15. SEE SHEET 101-LA-8530-001 FOR SPECIALTY SCHEDULE.
 - 16. SEE SHEET 101-LA-8530-001 FOR ACCESSIBILITY SCHEDULE.
 - 17. SEE SHEET 101-LA-8530-001 FOR ENERGY EFFICIENCY SCHEDULE.
 - 18. SEE SHEET 101-LA-8530-001 FOR SUSTAINABILITY SCHEDULE.
 - 19. SEE SHEET 101-LA-8530-001 FOR HISTORIC PRESERVATION SCHEDULE.
 - 20. SEE SHEET 101-LA-8530-001 FOR OTHER SCHEDULES.

<p>REVISIONS</p> <table border="1" style="width: 100%; border-collapse: collapse;"> <thead> <tr> <th>NO.</th> <th>BY</th> <th>REVISION</th> <th>DATE</th> </tr> </thead> <tbody> <tr> <td> </td> <td> </td> <td> </td> <td> </td> </tr> <tr> <td> </td> <td> </td> <td> </td> <td> </td> </tr> <tr> <td> </td> <td> </td> <td> </td> <td> </td> </tr> </tbody> </table>	NO.	BY	REVISION	DATE													<p>PROJECT: 865 FOREST AVE. PORTLAND, MAINE FOR GRANT WILSON</p> <p>SHEET TITLE: PROPOSED FLOOR PLAN ISSUED FOR PERMITTING</p>	<p>ASSOCIATED DESIGN PARTNERS INC.</p> <p>85 Leighton Road Portland, Maine 04103 Phone: (207) 878-1111 Fax: (207) 878-1114 E-Mail: info@adpinc.com</p>	<p>SCALE: AS SHOWN</p> <p>DATE: 10/20/07</p> <p>DRAWN BY: LA</p> <p>CHECKED BY: LD</p> <p>APPROVED BY: LD</p> <p>PROJECT MANAGER: LD</p> <p>ARCHITECT: ASSOCIATED DESIGN PARTNERS INC.</p> <p>865 FOREST AVE.</p>	
NO.	BY	REVISION	DATE																	

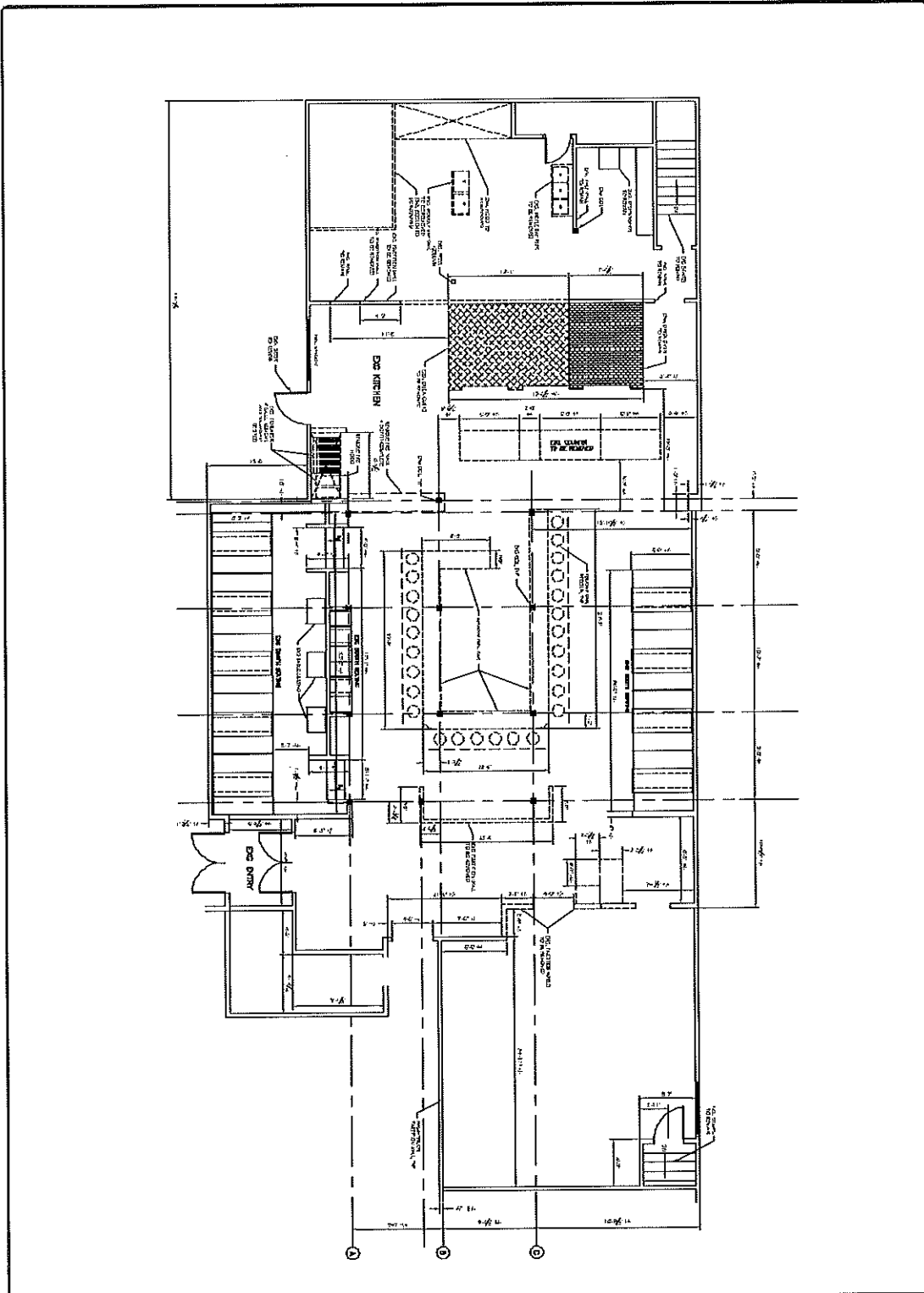

SHEET NO. D101	PROJECT NO. 06183	DATE 08/11/11
		BY [Signature]
REVISIONS NO. BY DESCRIPTION DATE		
1		
2		
3		
4		
5		
6		

PROJECT: **865 FOREST AVE.**
PORTLAND, MAINE
 FOR CRANT WILSON
 SHEET TITLE:
DEMO PLAN
ISSUED FOR PERMITTING

SCALE: AS SHOWN
 DRAWN BY: [Signature]
 CHECKED BY: [Signature]

ASSOCIATED DESIGN PARTNERS INC.
 80 Litchon Road
 Portland, Maine 04108
 Phone: (207) 878-1111
 Fax: (207) 878-1118
 E-Mail: info@adpartners.com

PROJECT NO.
06183