

REV.	DESCRIPTION	DATE
0	COG/COO	

PERMIT APPLICATION
SUBMISSION 3-18-09
 CURRENT ISSUE STATUS:

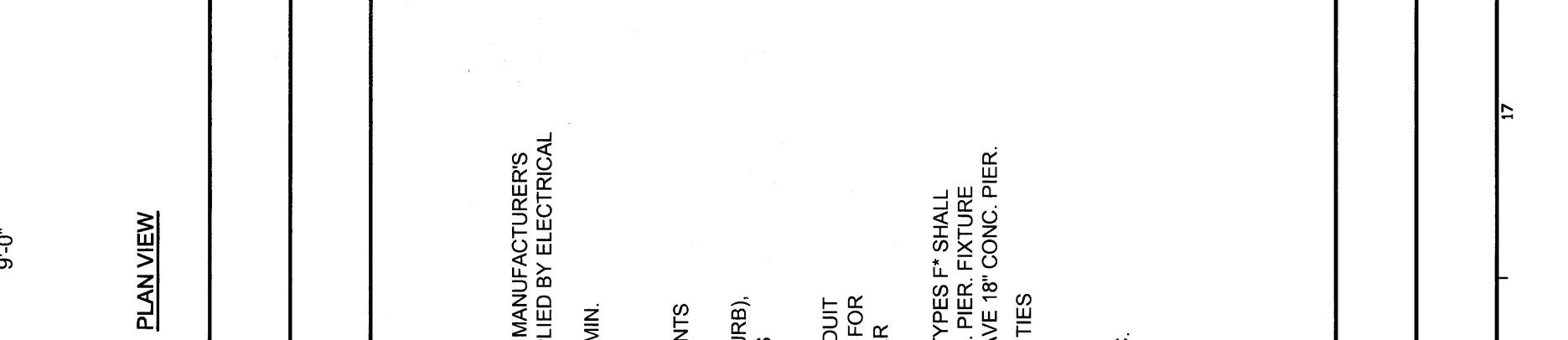

WBRC
 ARCHITECTS • ENGINEERS
 100 WASHINGTON ST.
 PORTLAND, ME 04101
 TEL: 603.761.1111
 WWW.WBRC.COM

**OCEAN AVENUE
 ELEMENTARY SCHOOL**
 PORTLAND, ME

SITE ELECTRICAL DETAILS

SHEET TITLE	331610-ESS01
PROJECT NO.	331610
SCALE	AS NOTED
PROJECT MANAGER	MEJ
DRAWN BY	AE
CHECKED BY	AE OF RECORD

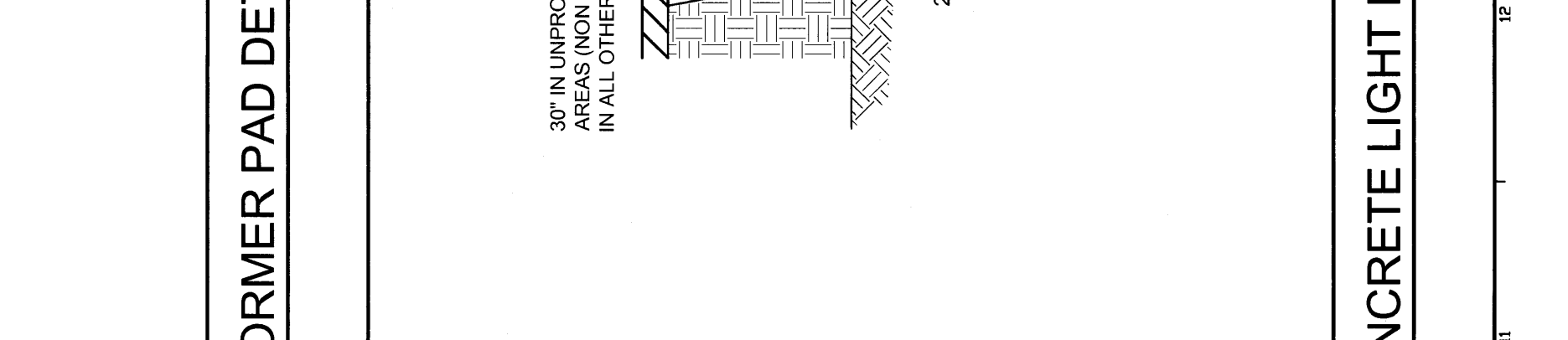
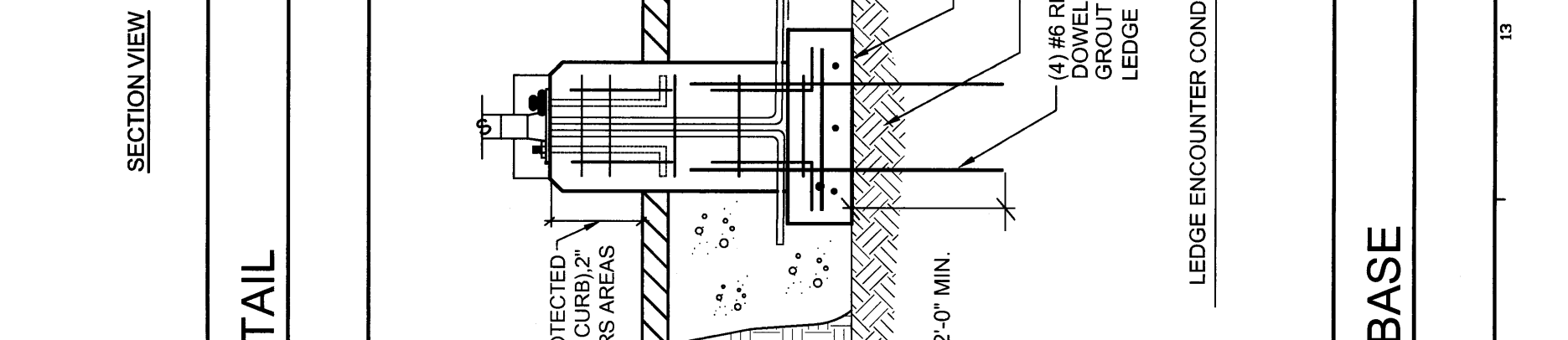

J10	PRIMARY ELECTRICAL MANHOLE DETAIL	NTS
E10	TRANSFORMER PAD DETAIL	NTS
A10	NEW CONCRETE LIGHT BASE	NTS

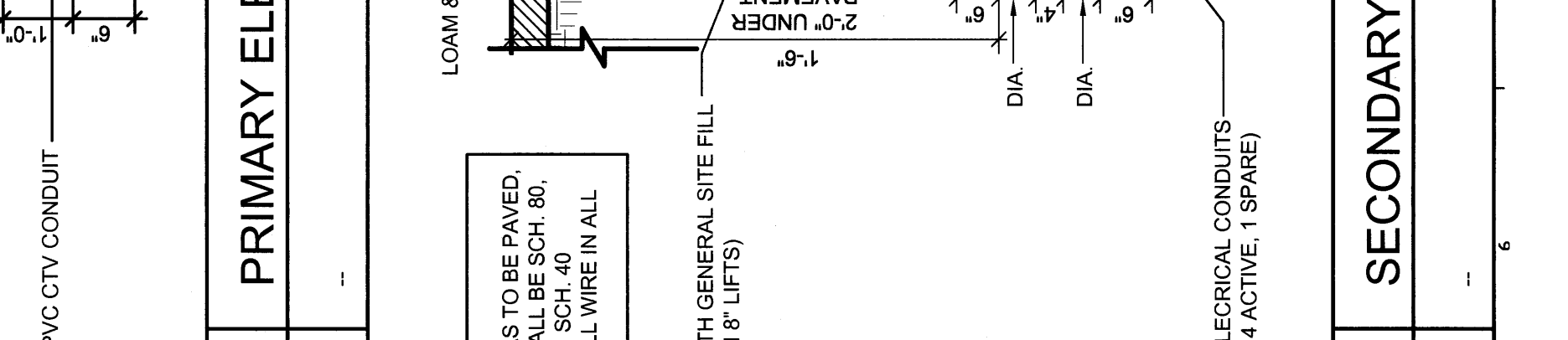
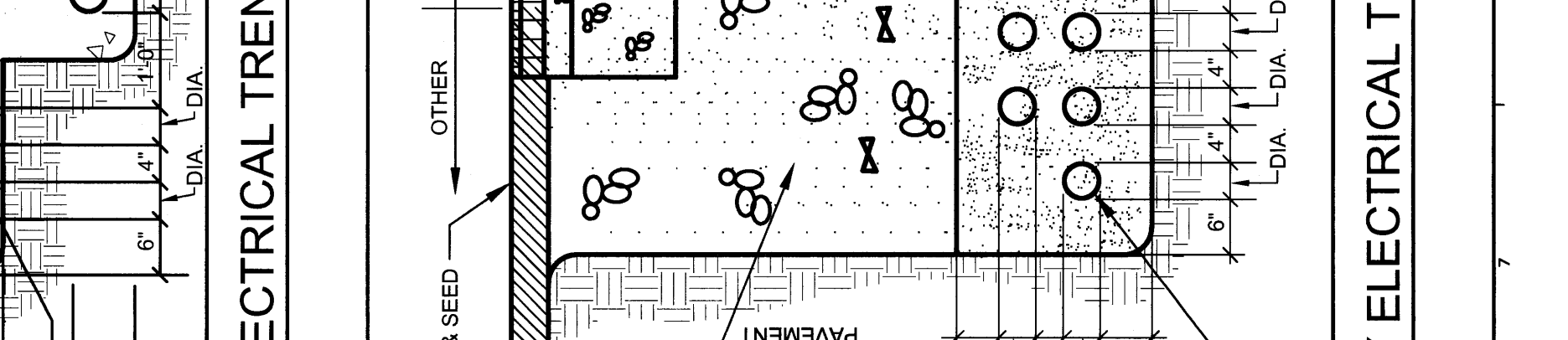
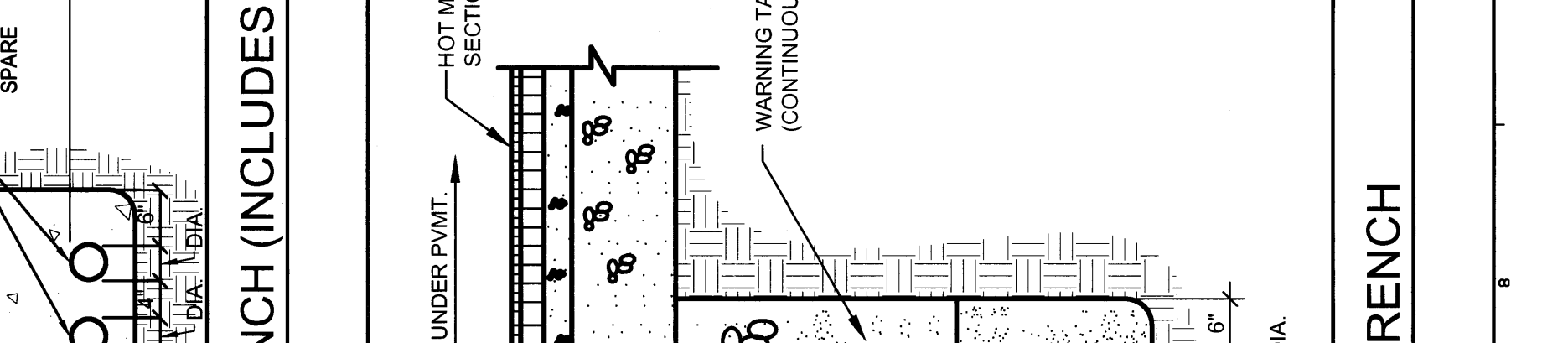
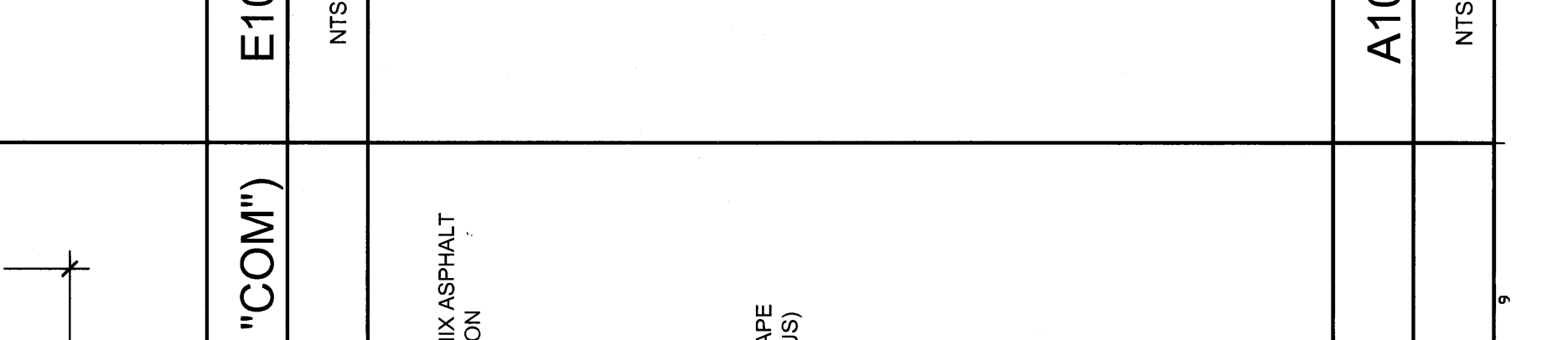

J5	NEW COMMUNICATIONS PULL BOX	NTS
E5	PRIMARY ELECTRICAL TRENCH (INCLUDES "COM")	NTS
A5	SECONDARY ELECTRICAL TRENCH	NTS

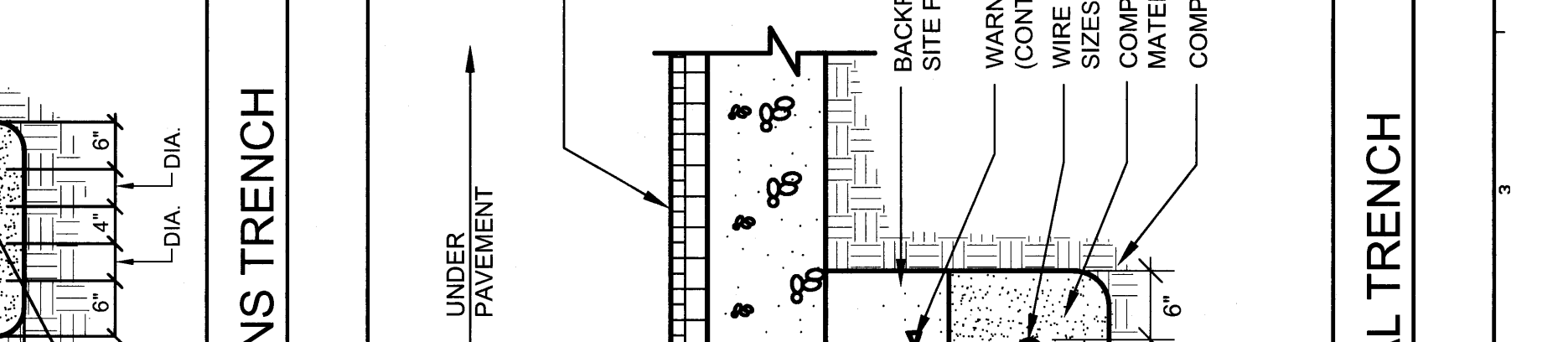
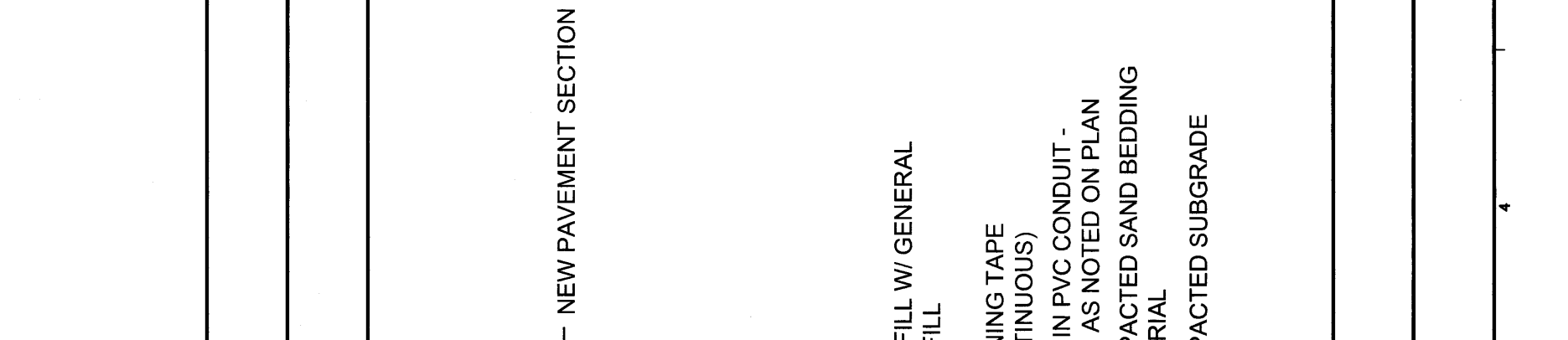

E1	COMMUNICATIONS TRENCH	NTS
A1	NEW ELECTRICAL TRENCH	NTS