

TECHNICAL NOTES:

- 1 POWER CONTROL CENTER - MOUNT ABOVE SUSPENDED CEILING
- 2 PLUG & PLAY CONNECTIONS NOT SHOWN FOR SUSPENDED CEILING - REFER TO DETAIL ATE-501 FOR WIRING INFORMATION
- 3 REFER TO DETAIL AISE-501 FOR ADDITIONAL WIRING INFORMATION
- 4 REFER TO DETAIL DISSE-501 FOR ADDITIONAL WIRING INFORMATION

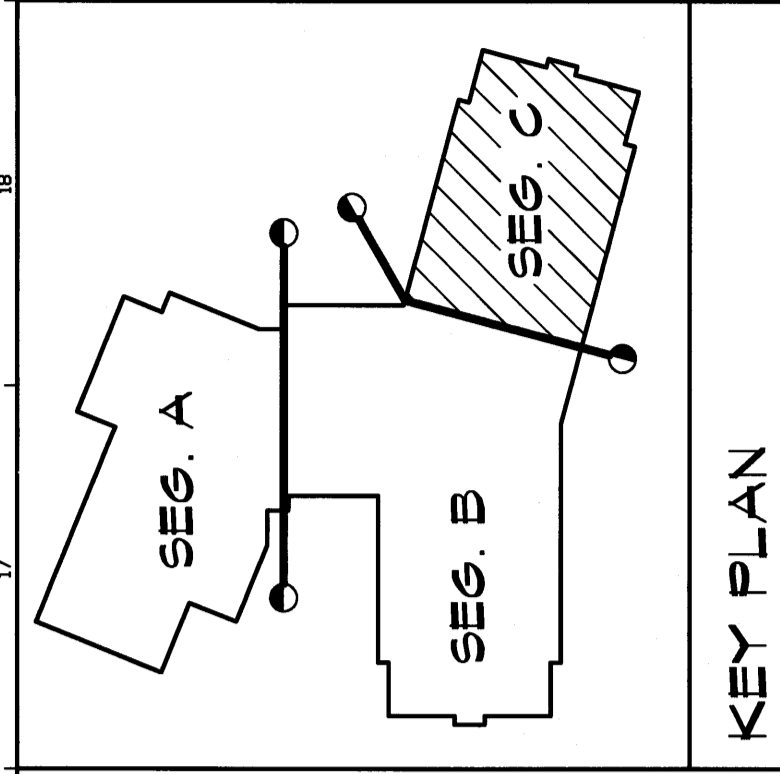

REV.	DESCRIPTION	DATE
0		10.03.09

PERMIT APPLICATION
SUBMISSION 3-18-09
 CURRENT ISSUE STATUS:



WBRC
ARCHITECTS • ENGINEERS
 100 WASHINGTON STREET
 PORTLAND, MAINE 04101
 TEL: 603.761.1111
 FAX: 603.761.1112

PROJECT
 NORTH

PROJECT
 OCEAN AVENUE ELEMENTARY
 SCHOOL
 PORTLAND, ME

PROJECT TITLE
 FIRST FLOOR ELECTRICAL
 LIGHTING PLAN - SEG. C

SHEET TITLE
 331610-EL101-C

SCALE
 1/8" = 1'-0"

PROJECT MANAGER
 MEJ

DATE
 3/16/09

SHEET NO.
 EL101-C

A1

FIRST FLOOR ELECTRICAL LIGHTING PLAN - SEG. C

1/8" = 1'-0"