

GENERAL NOTES:

- REFER TO PLUMBING FIXTURE CONNECTION SCHEDULE FOR PIPING SIZES TO INDIVIDUAL FIXTURES.
- PROVIDE SHOCK ABSORBERS AT ALL CW BRANCHES TO FLUSH VALVES.
- PROVIDE SHOCK ABSORBERS AT ALL HW BRANCHES TO TOILET ROOMS W/ SENSOR FAUCETS.

TECHNICAL NOTES:

- EXPOSED STRUCTURE, NO CEILING IN THIS AREA. COORDINATE EXTENT WITH REFLECTED CEILING PLANS. INTENT IS TO PAINT EXPOSED STRUCTURE. REFER TO DWG. PAINTING BY OTHERS, REFER TO DWG. 2.
- 1/2" PEEX TUBING DROPS IN WALL DRAINAGE PIPING PLAN. ROUTE INDIVIDUAL 1/2" PEEX TUBING UNDERSLAB TO EACH FLOOR DRAIN & FLOOR SINK.
- CURB. SEE STRUCTURAL.

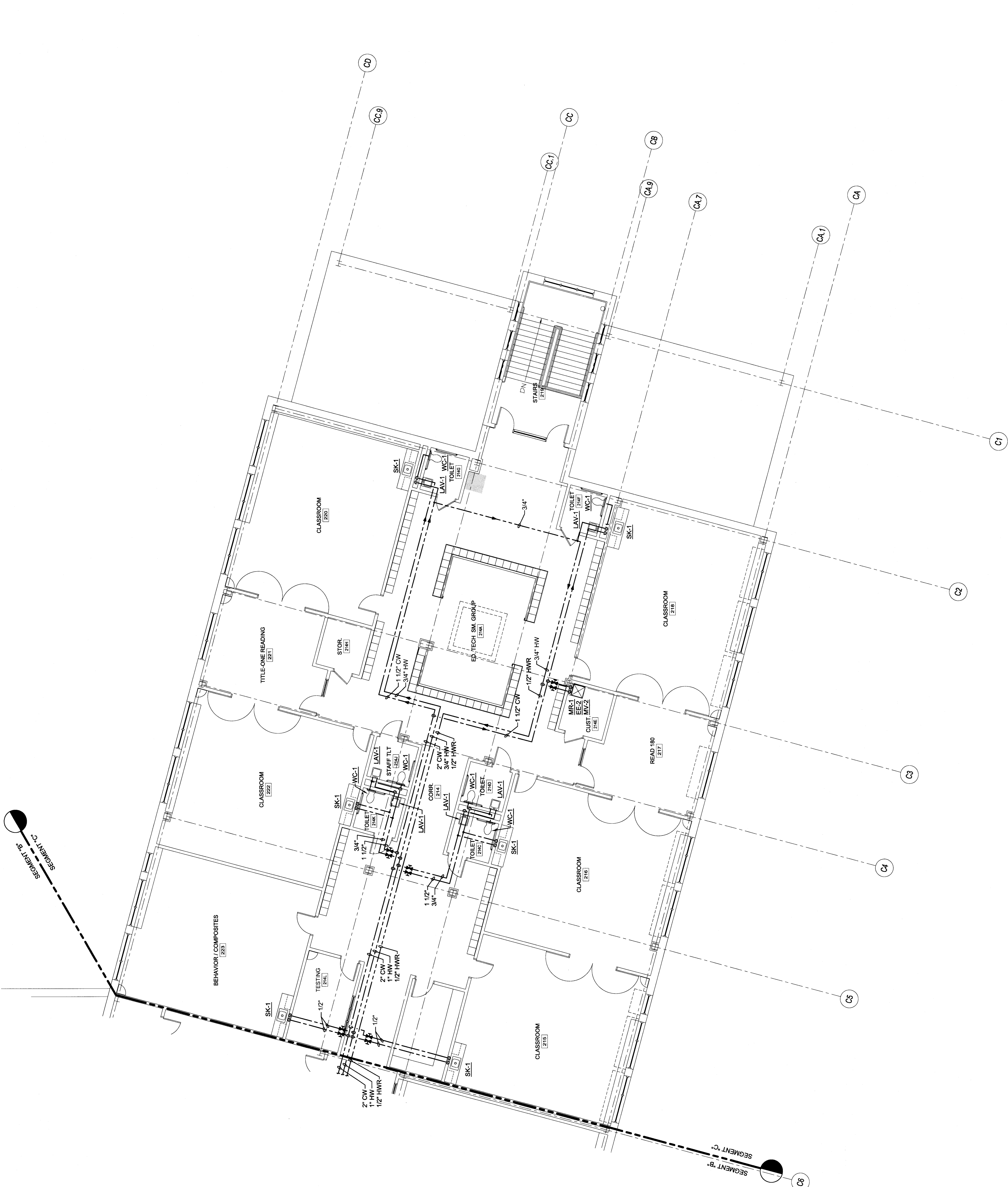

REV.	DESCRIPTION	DATE
0		03.03.09

PERMIT APPLICATION
SUBMISSION 3-18-09
 CURRENT ISSUE STATUS:

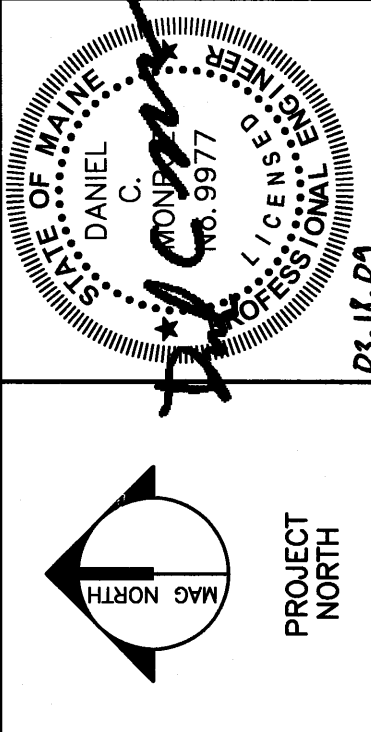

OCEAN AVENUE ELEMENTARY SCHOOL
 PORTLAND, ME

SECOND FLOOR DOMESTIC WATER PLAN - SEG. C

SHEET TITLE: 331610-PL122-C
 PROJECT No.: 331610
 SCALE: 1/8" = 1'-0"

PROJECT NUMBER: MEJ
 DRAWN BY: LAC
 CHECKED BY: DMON
PL122-C

A1 SECOND FLOOR DOMESTIC WATER PLAN - SEG. C

1/8" = 1'-0"