

AI FIRST FLOOR FINISH PLAN SEG. A

1/8"=1'-0"

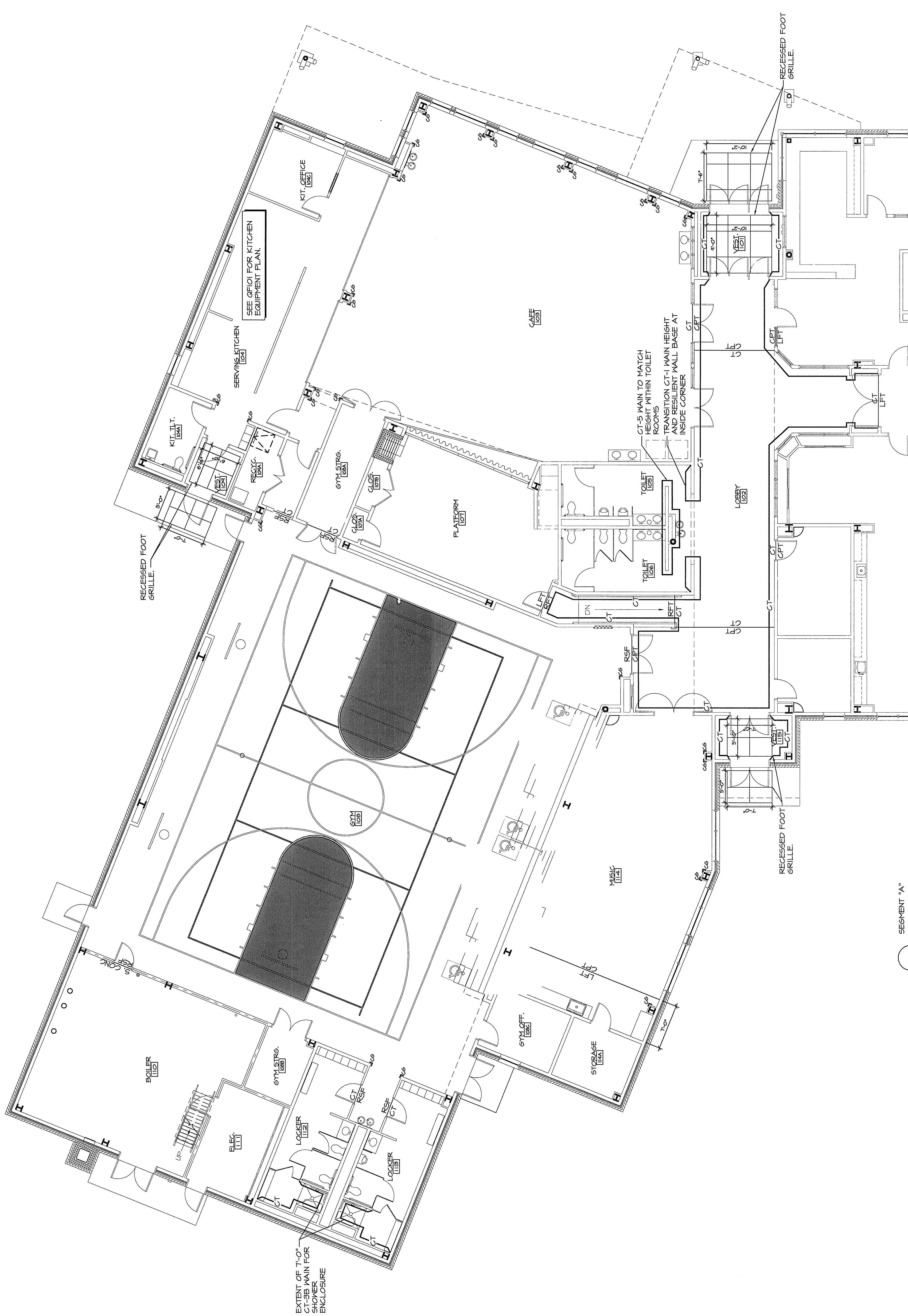

WBRC ARCHITECTS ENGINEERS 3100 NE 130th Avenue, Suite 200 Boca Raton, Florida 33431-5700 Phone: 561-993-9900 Fax: 561-993-9901 Email: info@wbrc.com		
OCEAN AVENUE ELEMENTARY SCHOOL PORTLAND, ME		
PERMIT APPLICATION SUBMISSION 3-18-09 CURRENT ISSUE STATUS:		
REV.	DESCRIPTION	DATE
0		00.00.00

FINISH PLAN NOTES:

- REFER TO ARCHITECTURAL ABBREVIATIONS ON SHEET G1002 FOR ALL ABBREVIATIONS SHOWN.
- ABBREVIATIONS IN ADDITION TO THOSE ON G1002 INCLUDE:
 - USNIC - SEALED CONCRETE
- REFER TO FINISH SCHEDULES ON SHEET AF01 FOR MORE INFORMATION.
- REFER TO SPECIFICATION FOR PRODUCT INFORMATION.
- REFER TO REFLECTED CEILING PLANS ON SHEETS AE10A-AE10C FOR MORE INFORMATION.
- REFER TO INTERIOR ELEVATIONS ON SHEETS AE205 TO AE219.
- WALL, FLOOR, AND BASE FINISH TRANSITIONS ARE TO OCCUR ON INSIDE CORNERS U.N.O. VERIFY QUESTIONABLE FIELD CONDITIONS WITH ARCHITECT.
- REFER TO AF01 FOR TRANSITION DETAILS. INSTALL MATERIAL ABOUTS DISSIMILAR FLOORING MATERIAL. FLOORING CONTRACTOR TO VERIFY LOCATION AND STYLE OF FLOORING TRANSITION STRIPS BEFORE INSTALLATION.
- CENTERLINE OF FLOORING TRANSITIONS BETWEEN ROOMS TO OCCUR AT CENTERLINE OF DOOR FRAMES, U.N.O.
- ELEVATOR FLOOR TO RECEIVE SCHEDULED FINISH. ALL OTHER FINISHES TO BE SELECTED BY ARCHITECT FOR FINISH SCHEDULE'S FULL RANGE OF STANDARD FINISH OPTIONS, U.N.O.
- PANT EXPOSED METAL CT-1S SURFACES PER 2, INCLUDING UNDERSIDES OF METAL PANS, CARRIAGES, RAILINGS, PICKETS, HANDRAILS AND HANDRAIL MOUNTING BRACKETS, U.N.O.

FINISH PLAN LEGEND:

- SHADES GRAYING APPLIES TO ROOMS WITH PATTERN ONLY. SEE FINISH SCHEDULE FOR FINISH IN ROOMS WITHOUT SHADING.
- SHEET OR ROLL PATTERN DESIGNATION. SEE NOTE 1.
- FILE PATTERN DESIGNATION. SEE NOTE 1.
- CORNER GUARD LOCATIONS.
- CERAMIC TILE MANSOFT EXTENTS. LINE ILLUSTRATES INTENT OF CT WAIN LOCATIONS. CT WAIN TO EXTEND TO FOLLOW METAL FRAMES.

KEY PLAN

FINISH PLAN NOTES:

- REFER TO ARCHITECTURAL ABBREVIATIONS ON SHEET G1002 FOR ALL ABBREVIATIONS SHOWN.
- ABBREVIATIONS IN ADDITION TO THOSE ON G1002 INCLUDE:
 - USNIC - SEALED CONCRETE
- REFER TO FINISH SCHEDULES ON SHEET AF01 FOR MORE INFORMATION.
- REFER TO SPECIFICATION FOR PRODUCT INFORMATION.
- REFER TO REFLECTED CEILING PLANS ON SHEETS AE10A-AE10C FOR MORE INFORMATION.
- REFER TO INTERIOR ELEVATIONS ON SHEETS AE205 TO AE219.
- WALL, FLOOR, AND BASE FINISH TRANSITIONS ARE TO OCCUR ON INSIDE CORNERS U.N.O. VERIFY QUESTIONABLE FIELD CONDITIONS WITH ARCHITECT.
- REFER TO AF01 FOR TRANSITION DETAILS. INSTALL MATERIAL ABOUTS DISSIMILAR FLOORING MATERIAL. FLOORING CONTRACTOR TO VERIFY LOCATION AND STYLE OF FLOORING TRANSITION STRIPS BEFORE INSTALLATION.
- CENTERLINE OF FLOORING TRANSITIONS BETWEEN ROOMS TO OCCUR AT CENTERLINE OF DOOR FRAMES, U.N.O.
- ELEVATOR FLOOR TO RECEIVE SCHEDULED FINISH. ALL OTHER FINISHES TO BE SELECTED BY ARCHITECT FOR FINISH SCHEDULE'S FULL RANGE OF STANDARD FINISH OPTIONS, U.N.O.
- PANT EXPOSED METAL CT-1S SURFACES PER 2, INCLUDING UNDERSIDES OF METAL PANS, CARRIAGES, RAILINGS, PICKETS, HANDRAILS AND HANDRAIL MOUNTING BRACKETS, U.N.O.

FINISH PLAN LEGEND:

- SHADES GRAYING APPLIES TO ROOMS WITH PATTERN ONLY. SEE FINISH SCHEDULE FOR FINISH IN ROOMS WITHOUT SHADING.
- SHEET OR ROLL PATTERN DESIGNATION. SEE NOTE 1.
- FILE PATTERN DESIGNATION. SEE NOTE 1.
- CORNER GUARD LOCATIONS.
- CERAMIC TILE MANSOFT EXTENTS. LINE ILLUSTRATES INTENT OF CT WAIN LOCATIONS. CT WAIN TO EXTEND TO FOLLOW METAL FRAMES.

KEY PLAN