

## **EXHIBIT 3**

### **ASSESSORS MAP**

A draft copy of the new assessors CBL's for the new 4 lot subdivision approved in 2015 is attached as *Exhibit 3*. Lot 4 is listed as CBL 136-E006-001 (rear portion of Lot 4) and CBL 143-F012-001 (front portion of Lot 4 within the TIF District containing Building -1). This map was provided by the City Assessor Chris Huff as an interim Assessors CBL Map until the formal maps are updated. The current maps available through the City Assessors website reflect the several map CBL's in effect for the last century which have been superseded by the new 4 lot subdivision.

**KEY**

- MOTHERHOUSE PROPERTY (UNIT 1)
- SEA COAST PROPERTY & LAND, (UNITS 2&3)
- THE DISTRICT BOUNDARY

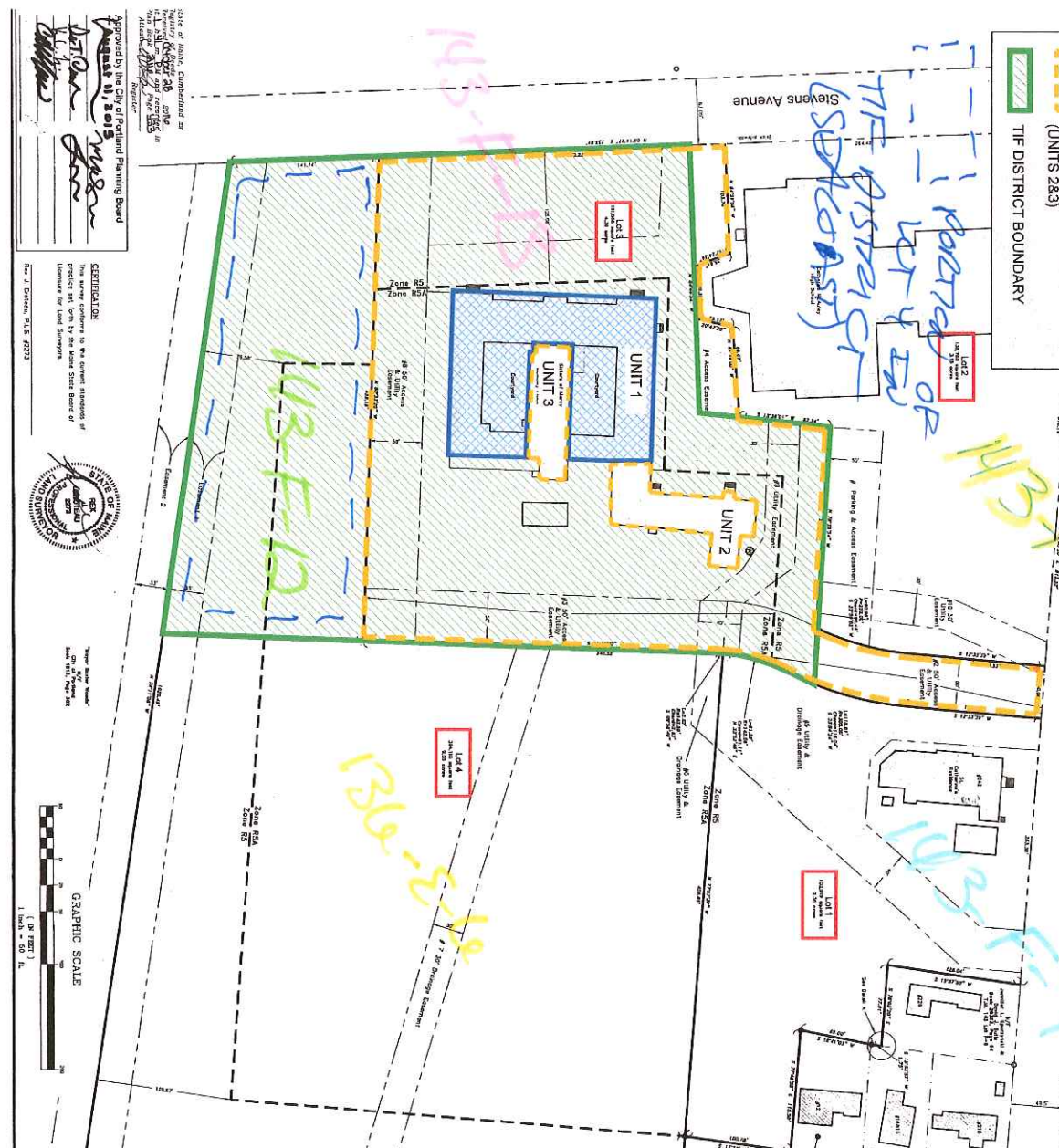

**605 Stevens Avenue, Portland - Residential Density Computation, Lots 3, 4 & 5**

Parcel ID: 06-24-00000 (Acres: 1.1247) or Parcel ID: 06-24-00000 (Acres: 1.1247)

Lot	Area (sq. ft.)	Area (Acres)	Units Allowed	Units Allowed (per 10,000 sq. ft.)
Lot 1	12,144	0.278	0	0
Lot 2	12,144	0.278	0	0
Lot 3	12,144	0.278	0	0
Lot 4	12,144	0.278	0	0
Lot 5	12,144	0.278	0	0
<b>Total</b>	<b>60,720</b>	<b>1.402</b>	<b>0</b>	<b>0</b>

APPROVED FOR THE CITY OF PORTLAND  
DATE: 07/19/11 BY: [Signature]

**LEGEND**

- Site lot bound
- Appurtenant Easement
- Easement Easement
- Right of Way
- City Building

**MINIMUM STANDARDS FOR THE DISTRICT BOUNDARY:**

- The proposed lot and block and corresponding lot and block numbers shall be consistent with the City of Portland's Official Code of Ordinances, Chapter 21.020, Section 21.020.010.
- The lot and block numbers shall be consistent with the City of Portland's Official Code of Ordinances, Chapter 21.020, Section 21.020.010.
- The lot and block numbers shall be consistent with the City of Portland's Official Code of Ordinances, Chapter 21.020, Section 21.020.010.

**COMMENTS OF RECORD:**

1. The lot and block numbers shall be consistent with the City of Portland's Official Code of Ordinances, Chapter 21.020, Section 21.020.010.
2. The lot and block numbers shall be consistent with the City of Portland's Official Code of Ordinances, Chapter 21.020, Section 21.020.010.
3. The lot and block numbers shall be consistent with the City of Portland's Official Code of Ordinances, Chapter 21.020, Section 21.020.010.

**APPROVED FOR THE CITY OF PORTLAND**

DATE: 07/19/11 BY: [Signature]

**GRAPHIC SCALE**

1 inch = 50 feet

**SEA COAST AT BEAVER WOODS ASSOCIATES, L.P.**

605 Stevens Avenue

APPROVED FOR THE CITY OF PORTLAND

DATE: 07/19/11 BY: [Signature]

**APPROVED FOR THE CITY OF PORTLAND**

DATE: 07/19/11 BY: [Signature]

**APPROVED FOR THE CITY OF PORTLAND**

DATE: 07/19/11 BY: [Signature]

**APPROVED FOR THE CITY OF PORTLAND**

DATE: 07/19/11 BY: [Signature]

**APPROVED FOR THE CITY OF PORTLAND**

DATE: 07/19/11 BY: [Signature]

**APPROVED FOR THE CITY OF PORTLAND**

DATE: 07/19/11 BY: [Signature]

**APPROVED FOR THE CITY OF PORTLAND**

DATE: 07/19/11 BY: [Signature]

**APPROVED FOR THE CITY OF PORTLAND**

DATE: 07/19/11 BY: [Signature]

**APPROVED FOR THE CITY OF PORTLAND**

DATE: 07/19/11 BY: [Signature]

**APPROVED FOR THE CITY OF PORTLAND**

DATE: 07/19/11 BY: [Signature]