



PHASE I

MOTHERHOUSE RENOVATION
ALL FIELDS REMAIN INTACT



PHASE III

BUILDINGS #2 & 3 CONSTRUCTED (70 DU)
LOWER FIELDS LOST, UPPER FIELDS REMAIN,
(SOCCER RECONFIGURED)

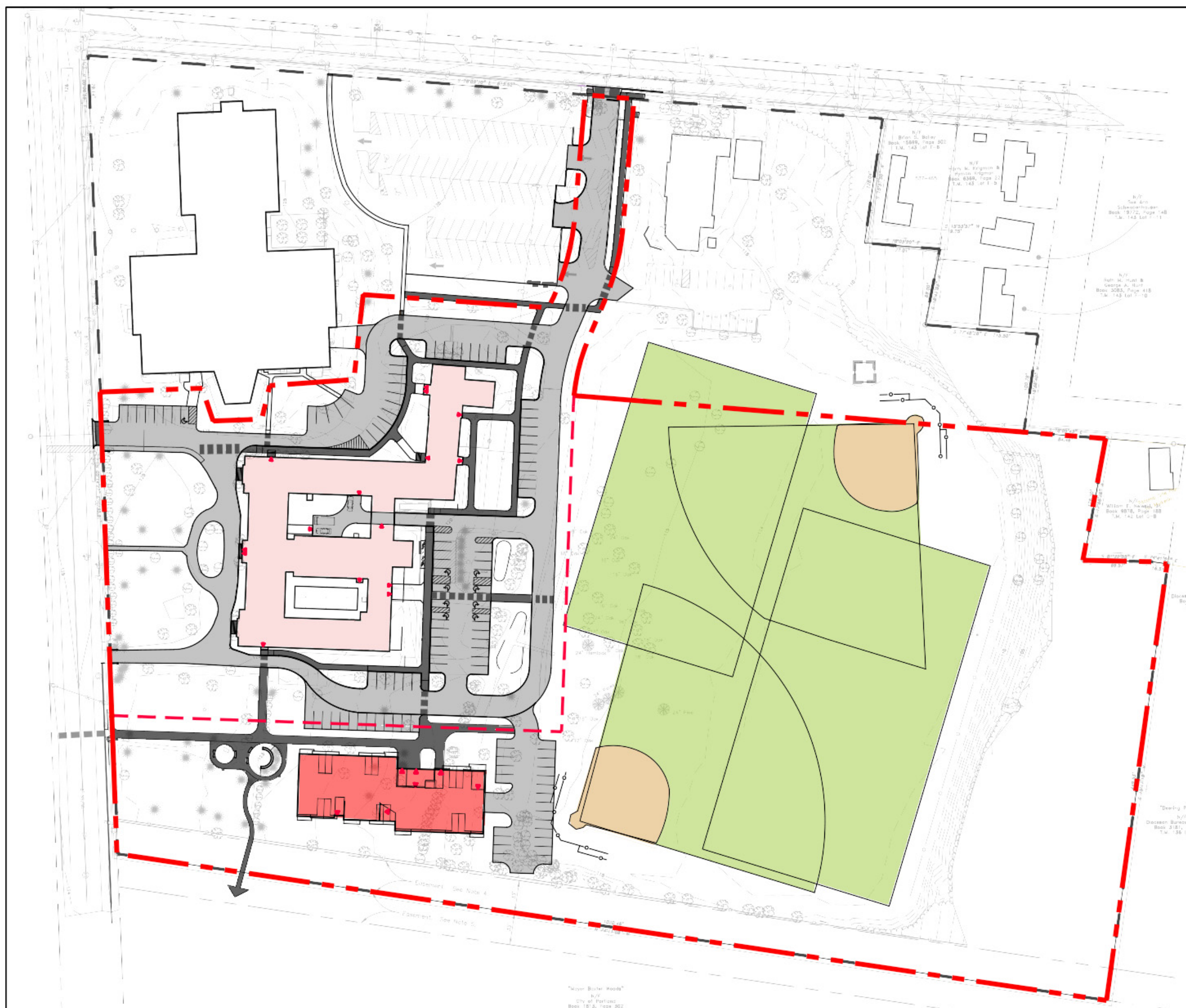

PHASE II

FIRST NEW BUILDING CONSTRUCTED (21 DU)
ALL FIELDS REMAIN INTACT



PHASE IV

BUILDINGS #4 & 5 CONSTRUCTED (70 DU)
NEW FIELDS CONSTRUCTED

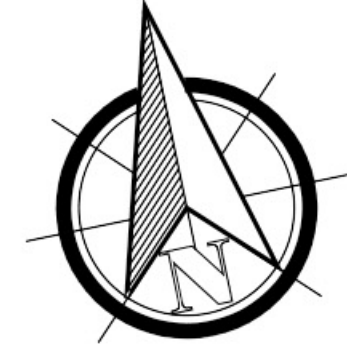

APPLICANT:

SEA COAST AT
BAXTER WOODS
ASSOCIATES, LLC

MOTHERHOUSE
ASSOCIATES LP
100 COMMERCIAL STREET
SUITE 414
PORTLAND, ME 04101
207.772.7673

Project:
605 Stevens Ave.
CONCEPTUAL PHASING PLAN

Revisions	Date	Description

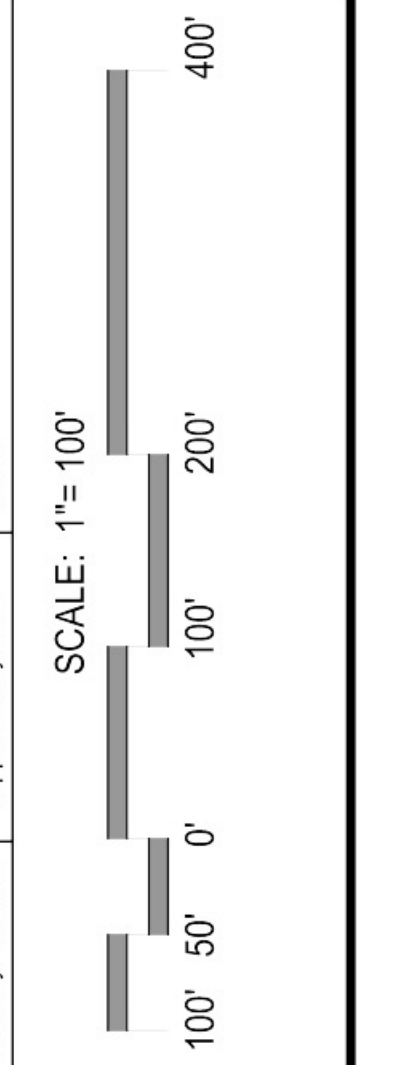

Phase:
PERMITTING

C
CARROLL ASSOCIATES
LANDSCAPE ARCHITECTS
217 COMMERCIAL STREET, STE 200
PORTLAND, MAINE, 04101
207.772.1552 V. F. 207.772.0712

Date:
FEBRUARY 16, 2016

Sheet No:

L-4