

- GENERAL NOTES:**
1. PLASTER CEILINGS (ABOVE DROP CEILING) AT ALL ROOMS AND CORRIDORS U.N.O
 2. REMOVE ALL EXISTING LIGHT FIXTURES AND INTERCOM DEVICES IN NUNCNELLS. TYP.
 3. REMOVE ALL EXISTING RADIATORS, U.N.O
 4. REMOVE ALL VCT, TYP.
 5. REMOVE ALL TERRAZZO, TYP.

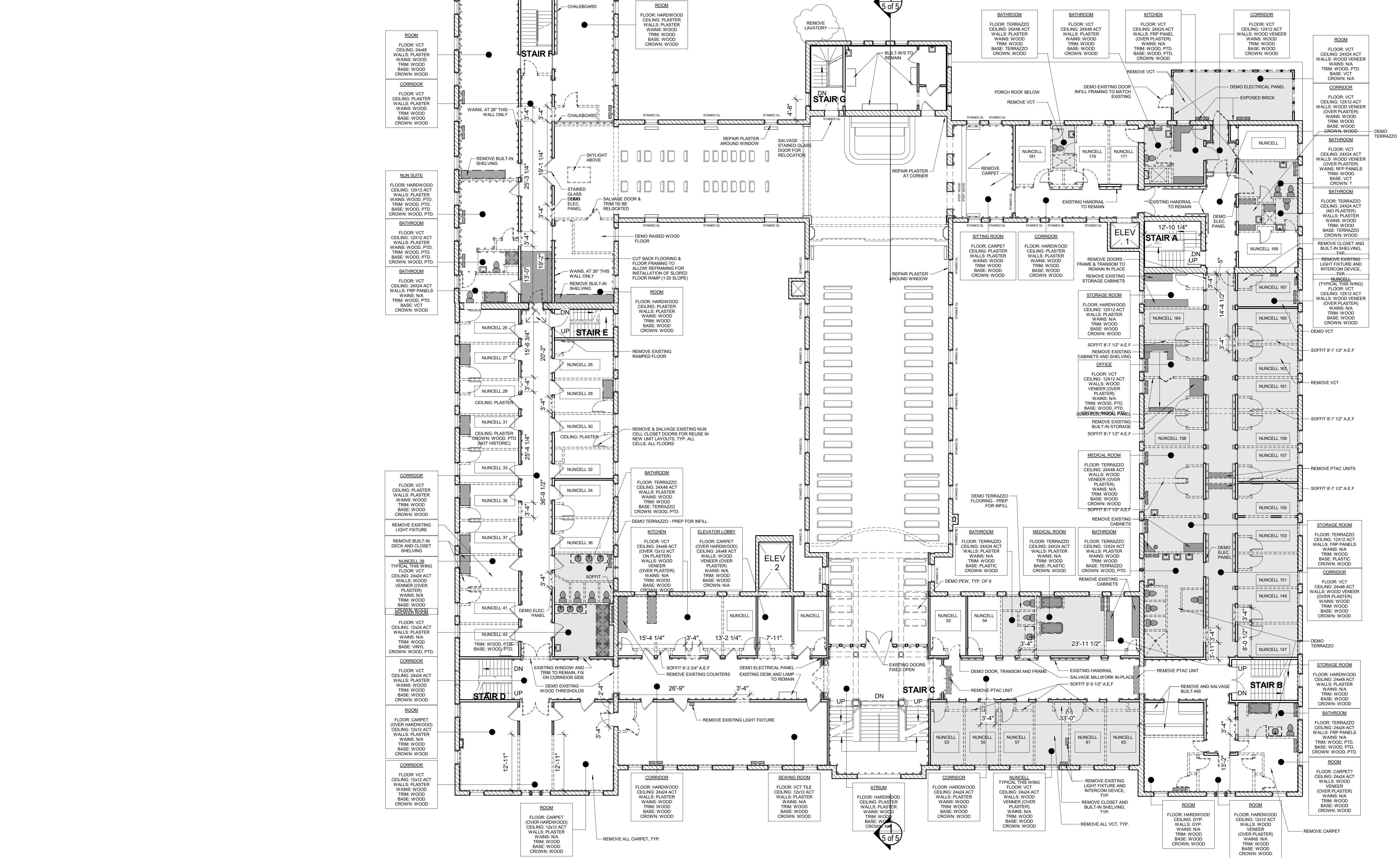

Prepared For:
MOTHERHOUSE LLC

Consultant:
ARCHETYPE architects
48 Union Wharf Portland, Maine 04101
(207) 772-0022 ARCHETYPE@ARCHETYPEPA.COM

Project:
MOTHERHOUSE SENIOR HOUSING
605 STEVENS AVENUE
PORTLAND, MAINE 04103

Revisions:
3 11/21/16 Clarif. to Bid Documents

Date:
1 MAR 2017

Scale:
3/32" = 1'-0"

EXISTING THIRD FLOOR PLAN & DEMO

A0.03

1 | EXISTING THIRD FLOOR PLAN & DEMO
3/32" = 1'-0"