

NOTES:

1. ALL WORK SHALL CONFORM TO THE APPLICABLE CODES AND ORDINANCES.
2. EXISTING CONDITIONS BASED ON EXISTING CONDITIONS SURVEY COMPLETED BY TITCOMB ASSOCIATES DATED JUNE 24, 2015. FIELD CONDITIONS MAY VARY SLIGHTLY FROM WHAT IS DEPICTED ON THE PLANS.
3. CONTRACTOR SHALL VERIFY ALL DIMENSIONS AND CONDITIONS IN THE FIELD PRIOR TO CONSTRUCTION. ANY UNUSUAL CONDITIONS SHALL BE IMMEDIATELY REPORTED TO THE ATTENTION OF THE OWNER.
4. CONTRACTOR SHALL CLEAN AND REMOVE DEBRIS AND SEDIMENT DEPOSITED ON PUBLIC STREETS, SIDEWALKS, ADJACENT AREAS, OR OTHER PUBLIC WAYS DUE TO CONSTRUCTION.
5. CONTRACTOR SHALL PROTECT EXISTING STRUCTURES, PHYSICAL FEATURES, AND MAINTAIN SITE STABILITY DURING CONSTRUCTION. CONTRACTOR SHALL RESTORE ALL AREAS TO ORIGINAL CONDITION AND AS DIRECTED.
6. THE CONTRACTOR SHALL CONTACT DIG SAFE (1-888-DIGSAFE) AT LEAST THREE (3) BUT NOT MORE THAN THIRTY (30) DAYS PRIOR TO COMMENCEMENT OF EXCAVATION OR DEMOLITION TO VERIFY HORIZONTAL AND VERTICAL LOCATION OF ALL UTILITIES.
7. ALL PAVEMENT JOINTS SHALL BE SAWCUT PRIOR TO PAVING TO PROVIDE A DURABLE AND UNIFORM JOINT.
8. NO HOLES, TRENCHES OR STRUCTURES SHALL BE LEFT OPEN OVERNIGHT IN ANY EXCAVATION ACCESSIBLE TO THE PUBLIC OR IN PUBLIC RIGHTS-OF-WAY.
9. ALL WORK WITHIN THE PUBLIC RIGHT-OF-WAY SHALL REQUIRE A STREET - OPENING PERMIT FROM THE CITY OF PORTLAND AND COORDINATION WITH THE DEPARTMENT OF PUBLIC SERVICES.



APPLICANT:

MOTHERHOUSE ASSOCIATES LP
100 COMMERCIAL STREET
SUITE 414
PORTLAND, ME 04101
207.772.7673

MOTHERHOUSE SENIOR HOUSING

Revisions	Date	Description
1	07/28/2015	SUBMISSION TO CITY
2	11/20/2015	50% SUBMISSION
3	02/15/2016	90% MSHA SUBMISSION

MATERIALS PLAN

Phase: CONSTRUCTION

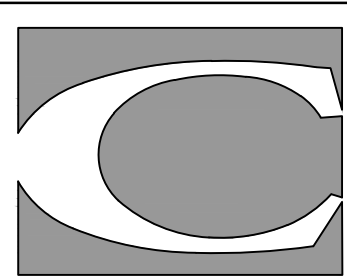

CARROLL ASSOCIATES LANDSCAPE ARCHITECTS
217 COMMERCIAL STREET, STE 200
PORTLAND, MAINE 04101
207.772.1952 V. F. 207.772.0712

Date: JUNE 24, 2015

Sheet No:

C4.1

PRELIMINARY - NOT FOR CONSTRUCTION

Walton Street

Stevens Avenue

30' 15' 0" 30' 60' 120'

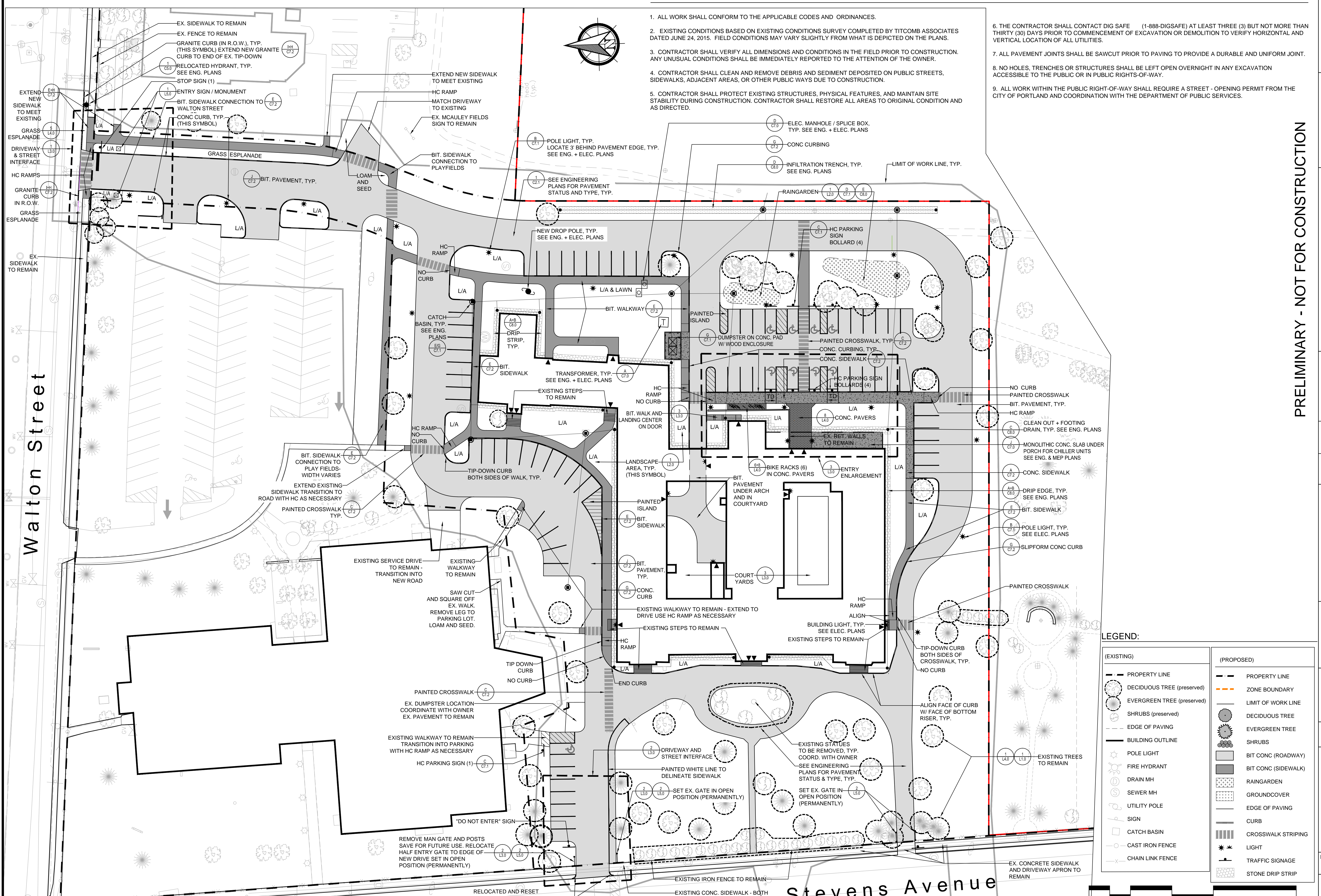

LEGEND:

(EXISTING)	(PROPOSED)
PROPERTY LINE	PROPERTY LINE
DECIDUOUS TREE (preserved)	ZONE BOUNDARY
EVERGREEN TREE (preserved)	LIMIT OF WORK LINE
SHRUBS (preserved)	DECIDUOUS TREE
EDGE OF PAVING	EVERGREEN TREE
BUILDING OUTLINE	SHRUBS
POLE LIGHT	BIT CONC (ROADWAY)
FIRE HYDRANT	BIT CONC (SIDEWALK)
DRAIN MH	RAINGARDEN
SEWER MH	GROUNDCOVER
UTILITY POLE	EDGE OF PAVING
SIGN	CURB
CATCH BASIN	CROSSWALK STRIPING
CHAIN LINK FENCE	LIGHT
	TRAFFIC SIGNAGE
	STONE DRIP STRIP