

- △
- △
- △
- △
- △
- △

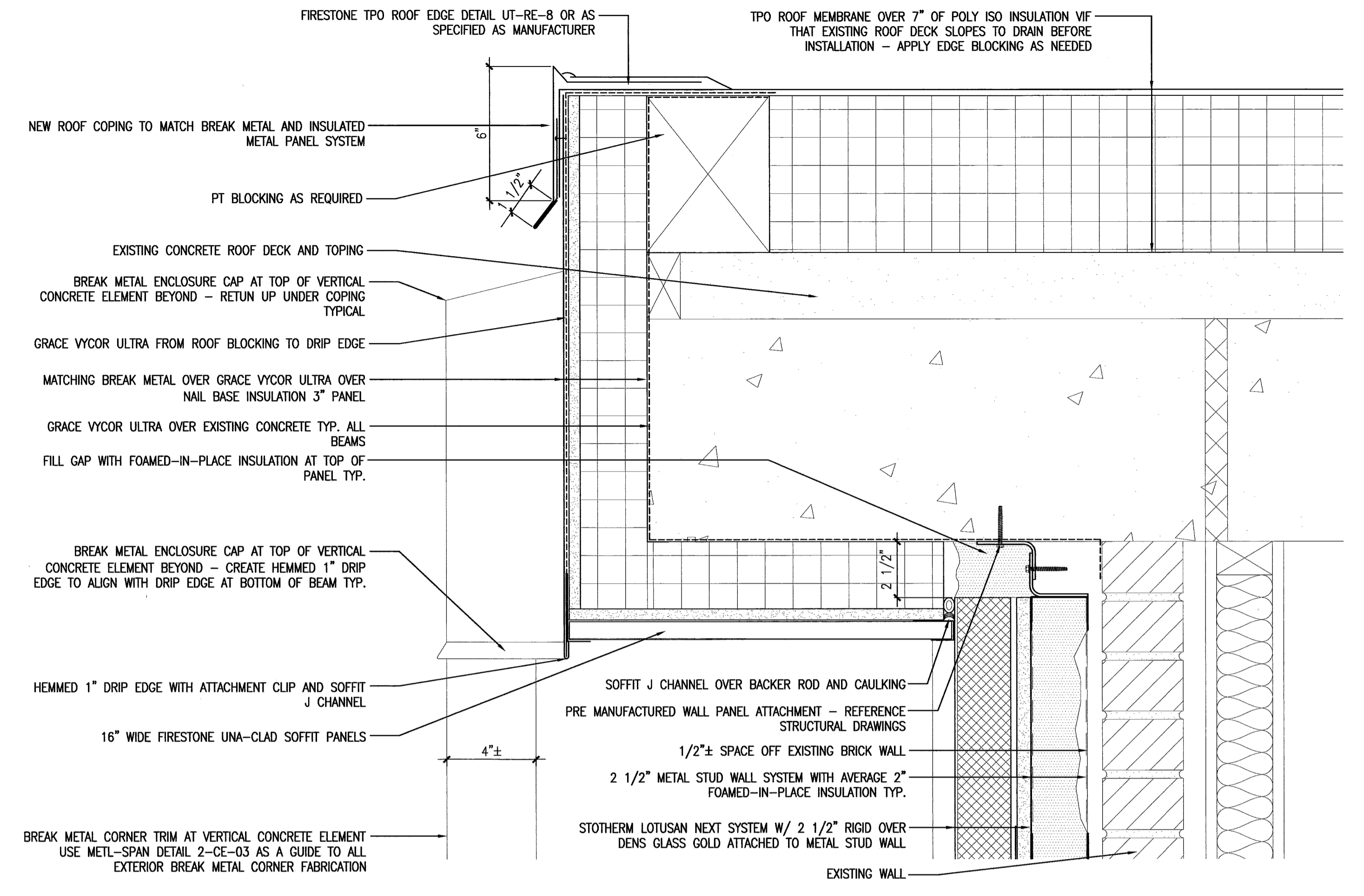

1 ROOF EDGE DETAIL

SCALE: 3"=1'-0"

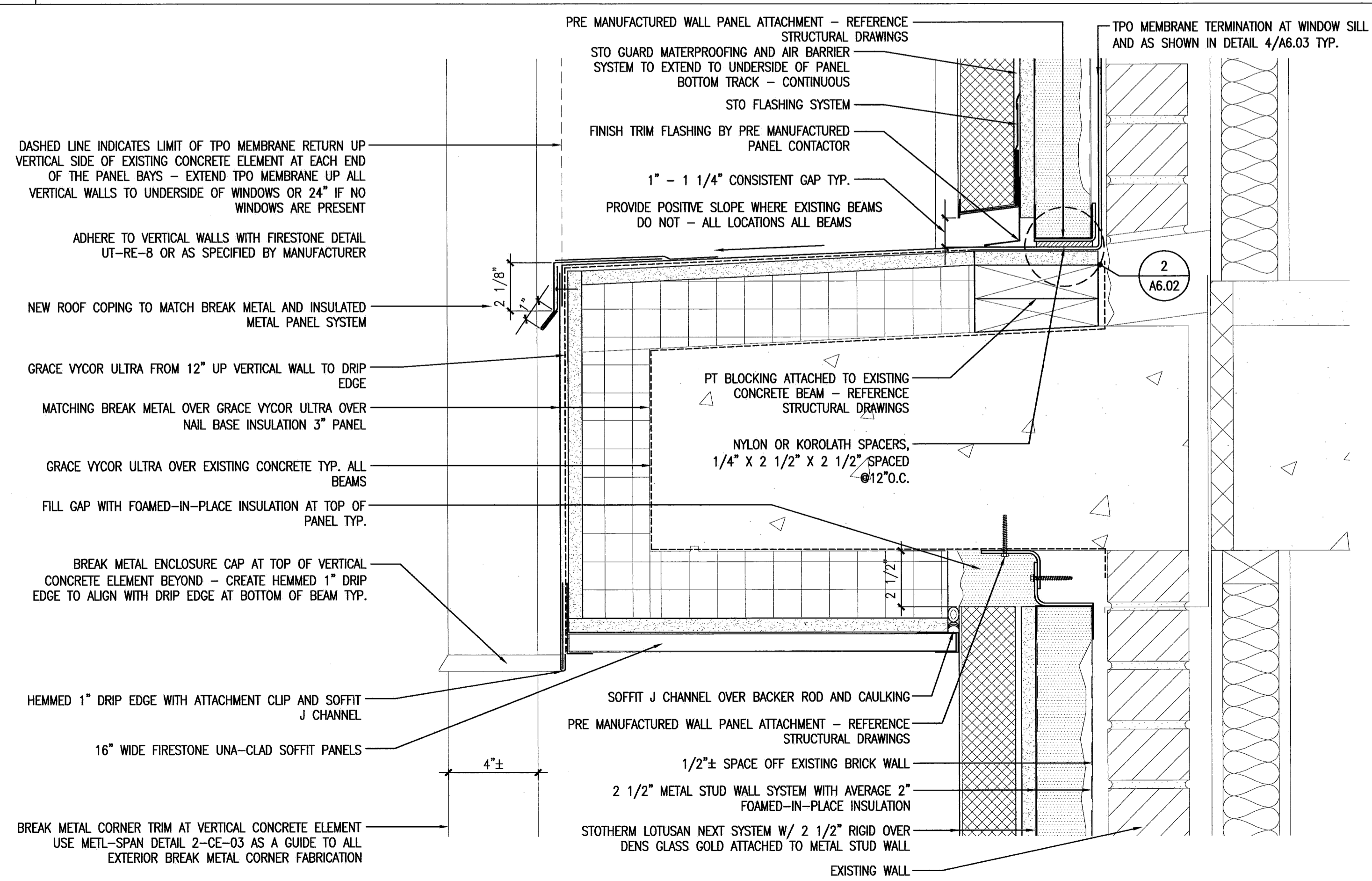

2 SECOND TO ELEVENTH FLOOR BEAM DETAIL

SCALE: 3"=1'-0"

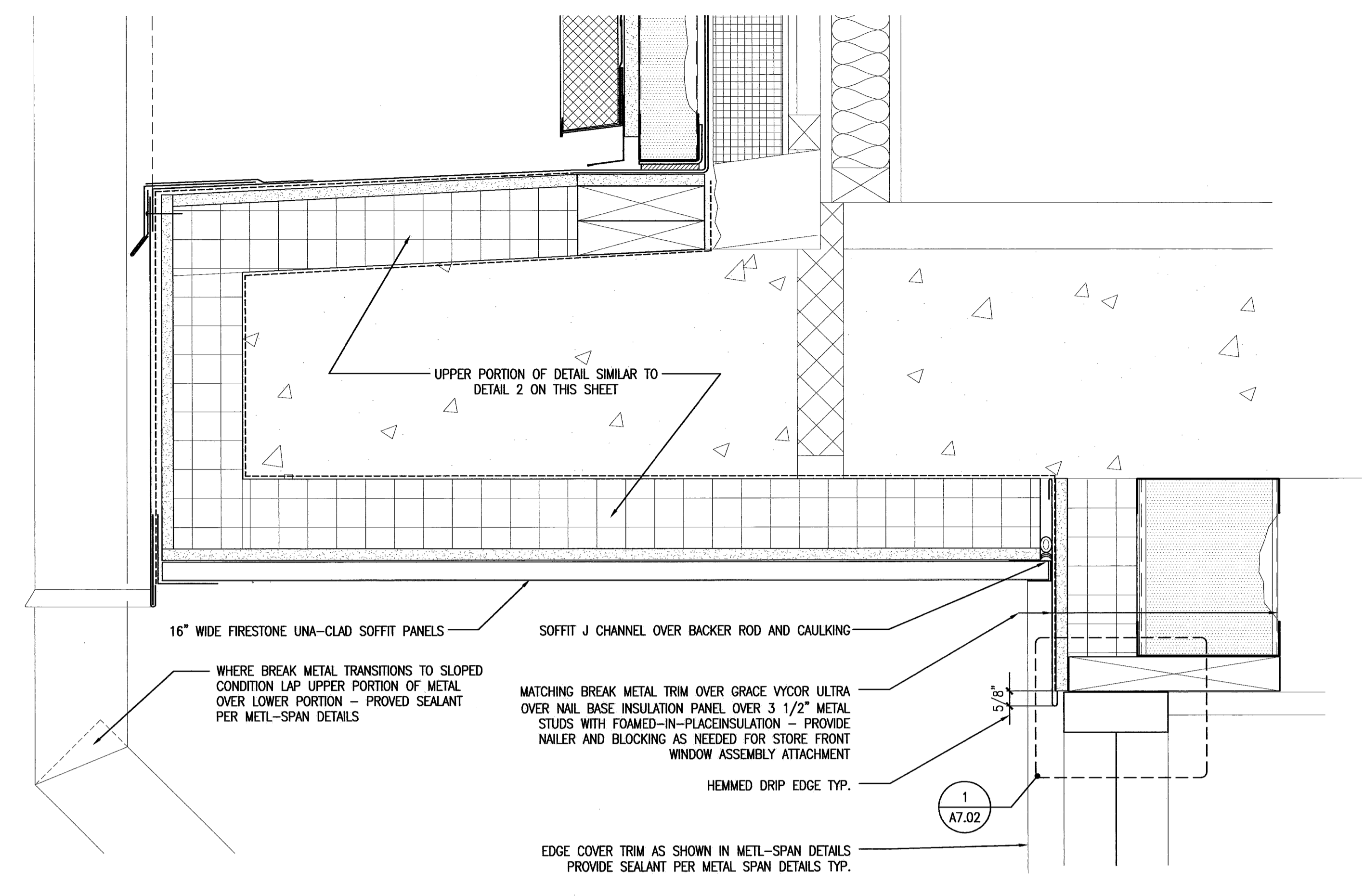

3 FIRST TO SECOND FLOOR BEAM DETAIL

SCALE: 3"=1'-0"

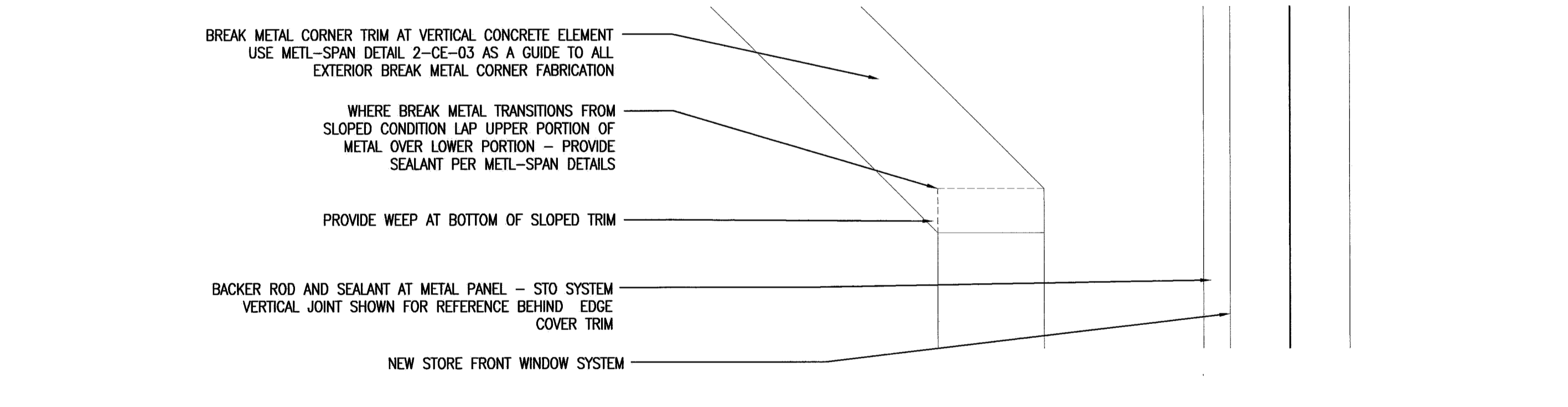

4 FLASHING DETAIL @ SLOPED SURFACE TO VERTICAL TRANSITION

SCALE: 3"=1'-0"

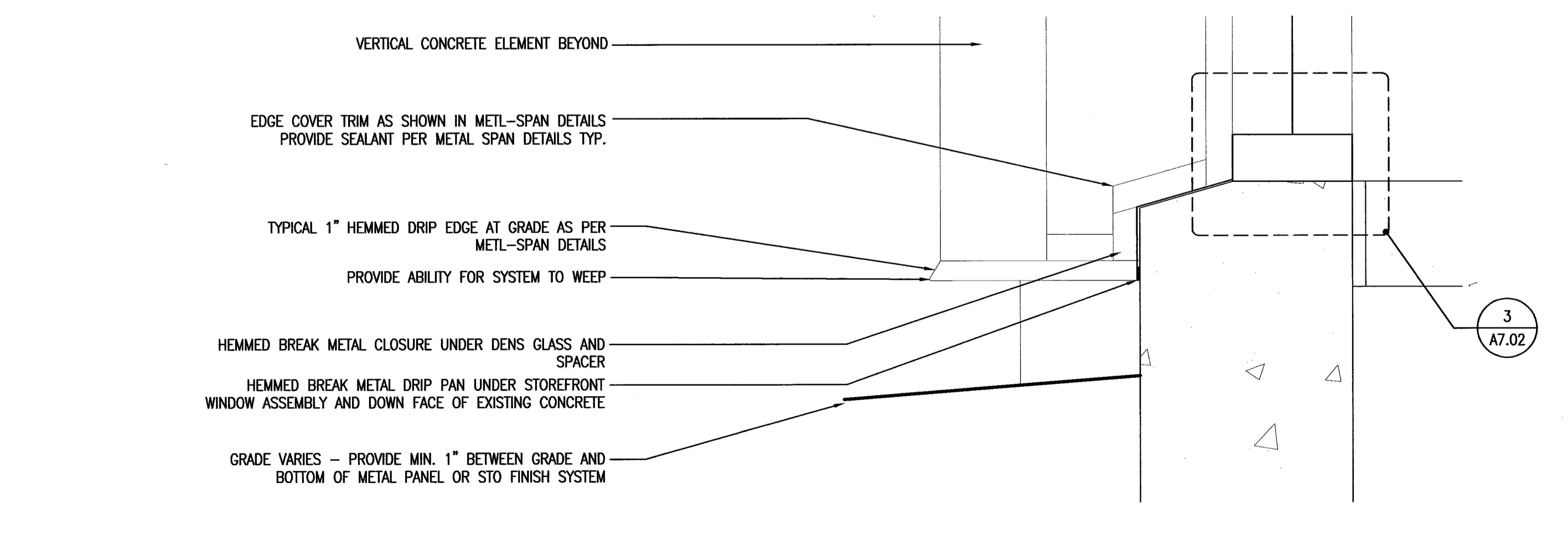

5 GROUND LEVEL DETAIL

SCALE: 3"=1'-0"