

NOTES:

- 1 42" WIDE METL-SPAN 3" THICK INSULATED METAL PANELS WITH VERTICAL JOINTS AND STACKED AS NOTED IN THE DETAILS
- 2 STOTHERM LOTUSAN NEXT SYSTEM W/ 2 1/2" RIGID OVER DENS GLASS GOLD ATTACHED TO METAL STUD WALL
- 3 STOTHERM LOTUSAN NEXT SYSTEM W/ 2 1/2" RIGID OVER DENS GLASS GOLD DIRECT APPLIED TO EXISTING BRICK FACADE
- 4 EXISTING DOORS TO REMAIN - STEEL DOORS TO BE PAINTED
- 5 REPLACE ALL VENTS, LOUVERS, FANS AND HOODS WITH NEW - REFERENCE MECHANICAL DRAWINGS FOR MORE INFORMATION
- 6 REMOVE FAN AND HOOD - PATCH WALL OPENING FINISH AND PAINT INTERIOR
- 7 REFERENCE ELECTRICAL DRAWINGS FOR LIGHTING INFORMATION
- 8 EXISTING GAS LINE AND MANIFOLD TO REMAIN - PREP AND APINT TO MATCH NEW EXTERIOR SKIN AS REQUIRED.
- 9 COORDINATE INSTALLATION OF STO SYSTEM WITH EXISTING ELEMENTS ON BUILDING FACADE TO REMAIN



CWS Architects

Architecture
Space Planning
Value Design

434 Cumberland Avenue
Portland, ME 04101
Phone: (207)774-4441
Fax: (207)774-4016
www.CWSarch.com

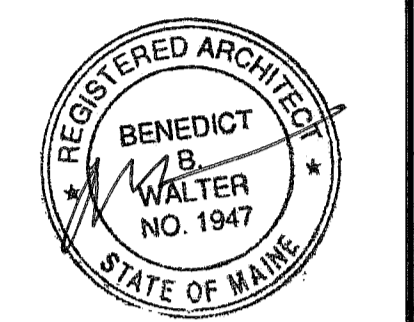

Owner:
Diocesan Bureau of Housing LLC
PO BOX 11559
Portland, Maine 04104-7559
TEL. 207-773-6471

Client:

Deering Pavilion Renovations

Portland, Maine

Project No: 08441

Drawing Title:
NORTH ELEVATION SECTION

Scale: AS NOTED
Date: May 20, 2010

- Revisions:
- △
 - △
 - △
 - △
 - △
 - △

Drawing Number:

A3.05

2 NOTES
SCALE: NTS

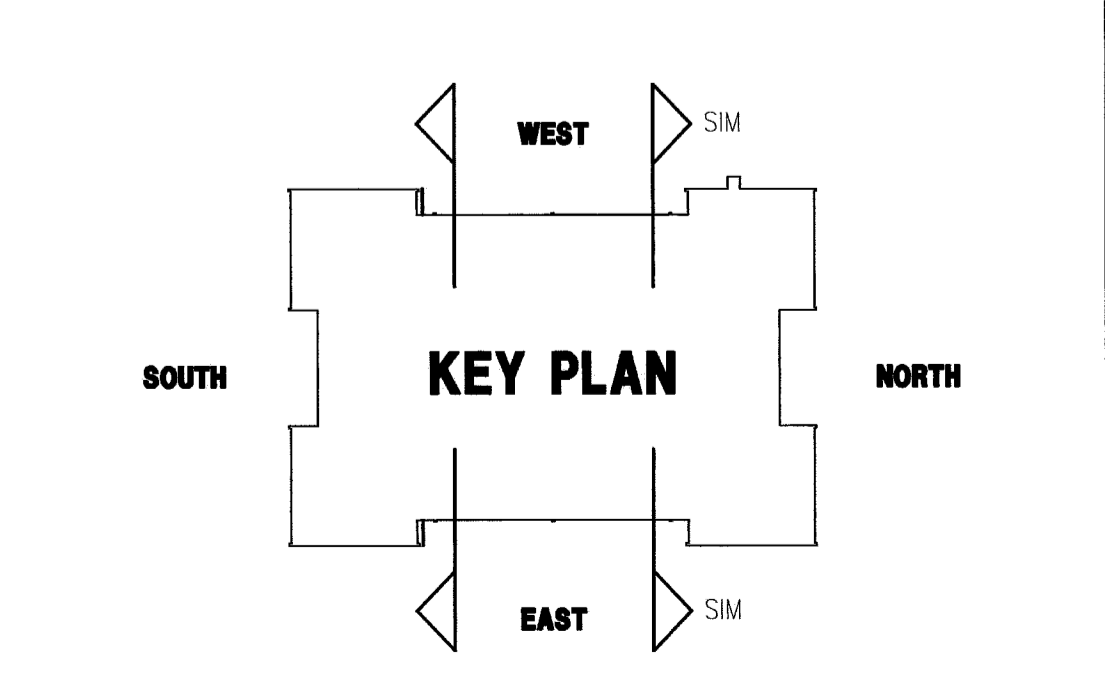

1 KEY PLAN
SCALE: NTS

3 NEW NORTH ELEVATION - SECTION
SOUTH ELEVATION SIM AT BUILDING SECTION

SCALE: 1/8" = 1'-0"