



**NOTES:**

- 1 42" WIDE METL-SPAN 3" THICK INSULATED METAL PANELS WITH VERTICAL JOINTS AND STACKED AS NOTED IN THE DETAILS
- 2 STOTHERM LOTUSAN NEXT SYSTEM W/ 2 1/2" RIGID OVER DENIS GLASS GOLD ATTACHED TO METAL STUD WALL
- 3 STOTHERM LOTUSAN NEXT SYSTEM W/ 2 1/2" RIGID OVER DENIS GLASS GOLD DIRECT APPLIED TO EXISTING BRICK FACADE
- 4 EXISTING DOORS TO REMAIN - STEEL DOORS TO BE PAINTED
- 5 REPLACE ALL VENTS, LOUVERS, FANS AND HOODS WITH NEW - REFERENCE MECHANICAL DRAWINGS FOR MORE INFORMATION
- 6 REMOVE FAN AND HOOD - PATCH WALL OPENING FINISH AND PAINT INTERIOR
- 7 REFERENCE ELECTRICAL DRAWINGS FOR LIGHTING INFORMATION
- 8 EXISTING GAS LINE AND MANIFOLD TO REMAIN - PREP AND APINT TO MATCH NEW EXTERIOR SKIN AS REQUIRED.
- 9 COORDINATE INSTALLATION OF STO SYSTEM WITH EXISTING ELEMENTS ON BUILDING FACADE TO REMAIN



**CWS Architects**

Architecture  
Space Planning  
Value Design

434 Cumberland Avenue  
Portland, ME 04101  
Phone: (207)774-4441  
Fax: (207)774-4016  
www.CWSarch.com

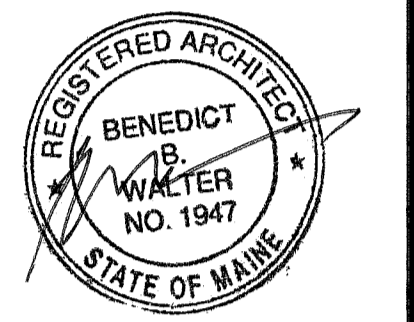

Owner:  
**Diocesan Bureau of Housing LLC**  
PO BOX 11559  
Portland, Maine 04104-7559  
TEL. 207-773-6471

Client:

**Deering Pavilion Renovations**

Portland, Maine

Project No: 08441

Drawing Title:  
**NORTH ELEVATION**

Scale: AS NOTED  
Date: May 20, 2010

- Revisions:
- ▲
  - ▲
  - ▲
  - ▲
  - ▲

Drawing Number:

**A3.03**

**2** NOTES  
SCALE: NTS

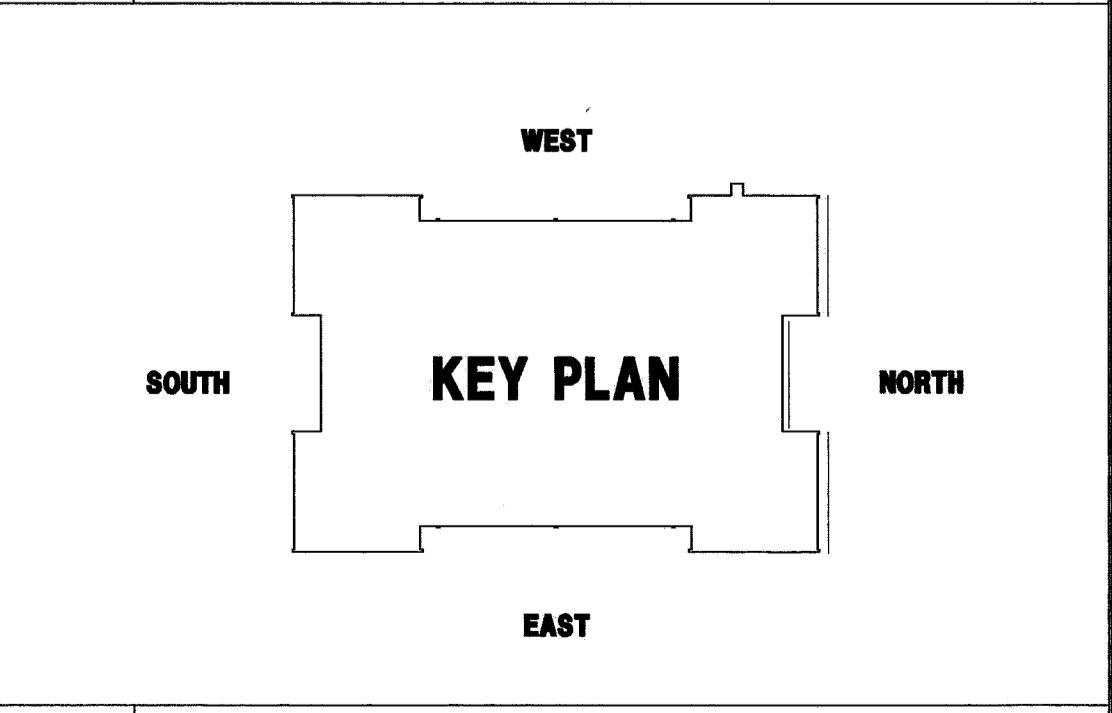

**1** KEY PLAN  
SCALE: NTS

**3** NEW NORTH ELEVATION

SCALE: 1/8" = 1'-0"