

TOP OF SLAB
 8'-10"
 11TH FLOOR
 9'-0"
 10TH FLOOR
 9'-0"
 9TH FLOOR
 9'-0"
 8TH FLOOR
 9'-0"
 7TH FLOOR
 9'-0"
 6TH FLOOR
 9'-0"
 5TH FLOOR
 9'-0"
 4TH FLOOR
 9'-0"
 3RD FLOOR
 9'-0"
 2ND FLOOR
 9'-0"
 GROUND FLOOR
 ARCH ELEVATION = 10'-0"

NOTES:

- 1 42" WIDE METL-SPAN 3" THICK INSULATED METAL PANELS WITH VERTICAL JOINTS AND STACKED AS NOTED IN THE DETAILS
- 2 STOTHERM LOTUSAN NEXT SYSTEM W/ 2 1/2" RIGID OVER DENS GLASS GOLD ATTACHED TO METAL STUD WALL
- 3 STOTHERM LOTUSAN NEXT SYSTEM W/ 2 1/2" RIGID OVER DENS GLASS GOLD DIRECT APPLIED TO EXISTING BRICK FACADE
- 4 EXISTING DOORS TO REMAIN - STEEL DOORS TO BE PAINTED
- 5 REPLACE ALL VENTS, LOUVERS, FANS AND HOODS WITH NEW - REFERENCE MECHANICAL DRAWINGS FOR MORE INFORMATION
- 6 REMOVE FAN AND HOOD - PATCH WALL OPENING FINISH AND PAINT INTERIOR
- 7 REFERENCE ELECTRICAL DRAWINGS FOR LIGHTING INFORMATION
- 8 EXISTING GAS LINE AND MANIFOLD TO REMAIN - PREP AND APINT TO MATCH NEW EXTERIOR SKIN AS REQUIRED.
- 9 COORDINATE INSTALLATION OF STO SYSTEM WITH EXISTING ELEMENTS ON BUILDING FACADE TO REMAIN



CWS Architects

Architecture
 Space Planning
 Value Design

434 Cumberland Avenue
 Portland, ME 04101
 Phone: (207)774-4441
 Fax: (207)774-4016
 www.CWSarch.com

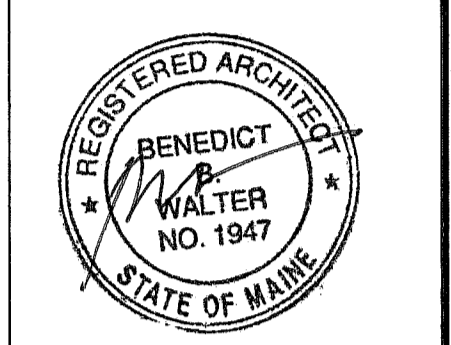

Owner:
Diocesan Bureau of Housing LLC
 PO BOX 11559
 Portland, Maine 04104-7559
 TEL. 207-773-6471

Client:

Deering Pavilion Renovations

Portland, Maine

Project No: 08441

Drawing Title:
EAST ELEVATION

Scale: AS NOTED
 Date: May 20, 2010

- Revisions:
- ▲
 - ▲
 - ▲
 - ▲
 - ▲
 - ▲

Drawing Number:

A3.01

2 NOTES SCALE: NTS

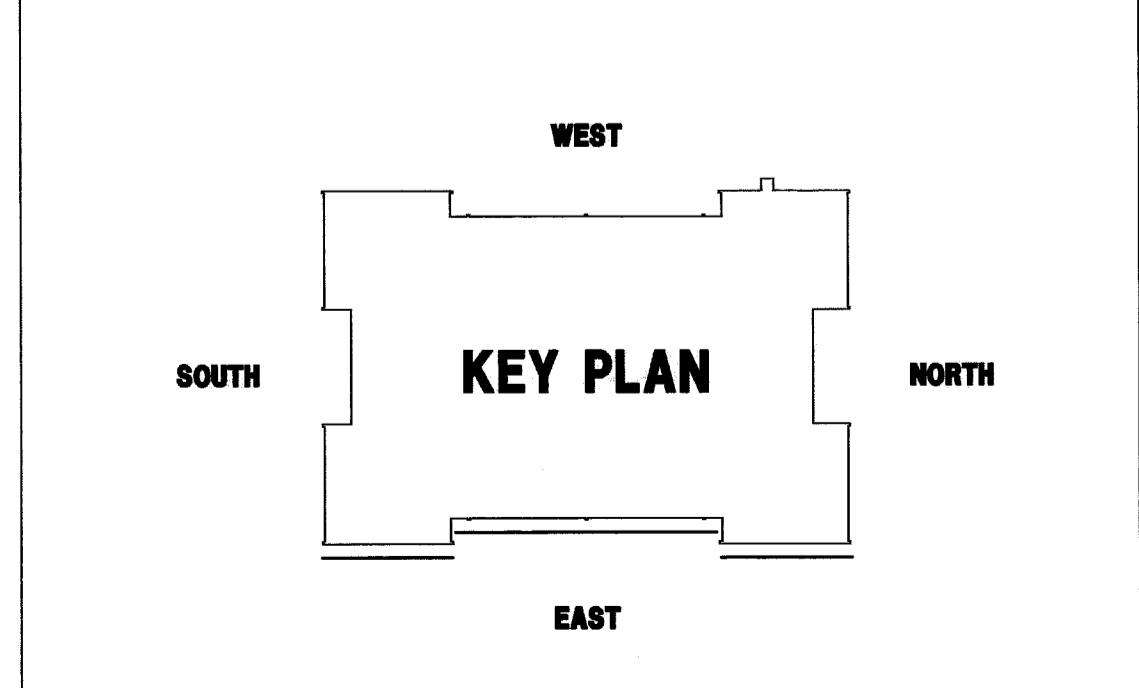

1 KEY PLAN SCALE: NTS

3 NEW EAST ELEVATION

SCALE: 1/8" = 1'-0"