

REMOVALS NOTES:

- 1 REMOVE WINDOW AND WINDOW ASSEMBLIES COMPLETE - REMOVE ANY PREVIOUSLY INSTALLED WINDOW TRACK SO THAT THE WOOD FRAMING OF EACH WINDOW IS EXPOSED, HEAD JAMBS AND SILL
- 2 REMOVE ANY WINDOW TRIM FASTENERS OR FLASHING AT EXISTING OPENING FLOORS 2-11
- 3 REMOVE WINDOW ASSEMBLIES COMPLETE TO CONCRETE SURFACE WHERE APPLICABLE FLOORS 2-11
- 4 REMOVE ALL COPING, FLASHING AND ATTACHMENT HARDWARE AT ROOF PERIMETER - PROVIDE TEMPORARY WEATHER PROTECTION AS NEEDED
- 5 REMOVE AND STORE LIGHT FIXTURES FOR REINSTALLATION TYPICAL
- 6 REMOVE AND STORE FIRE ALARM HARDWARE FOR REINSTALLATION - COORDINATE TEMPORARY SYSTEMS AND FIXTURES WITH AUTHORITY HAVING JURISDICTION BEFORE REMOVAL
- 7 REMOVE EXISTING CANVAS ENTRY CANOPY
- 8 REMOVE EXISTING METAL SIDING ON 12TH FLOOR - COORDINATE WORK WITH OWNERS OF LEASED EQUIPMENT ATTACHED TO THIS PORTION OF THE BUILDING BEFORE PROCEEDING WITH WORK.
- 9 REFERENCE MECHANICAL DRAWINGS FOR VENTS, LOUVERS, FAN AND HOOD REMOVAL AND REPLACEMENT
- 10 REMOVE FAN AND HOOD
- 11 REMOVE STOREFRONT COMPLETE
- 12 REMOVE EDGE OF BRICK BELOW EACH WINDOW FLUSH WITH PANEL TYP.



CWS Architects

Architecture
Space Planning
Value Design

434 Cumberland Avenue
Portland, ME 04101
Phone: (207)774-4441
Fax: (207)774-4016
www.CWSarch.com

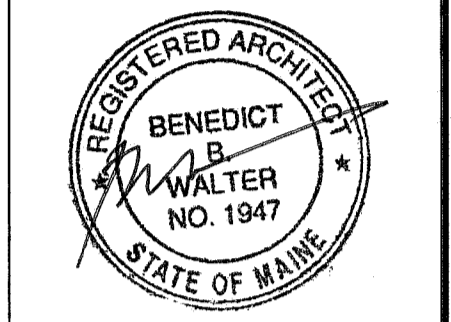

Owners:
Diocesan Bureau of Housing LLC
PO BOX 11559
Portland, Maine 04104-7559
TEL. 207-773-6471

Client:

Deering Pavilion Renovations

Portland, Maine

Project No: 08441

Drawing Title:
REMOVALS EAST ELEVATION

Scale: AS NOTED
Date: May 20, 2010

- Revisions:
- ▲
 - ▲
 - ▲
 - ▲
 - ▲
 - ▲

Drawing Number:

D3.01

2 REMOVALS NOTES SCALE: NTS

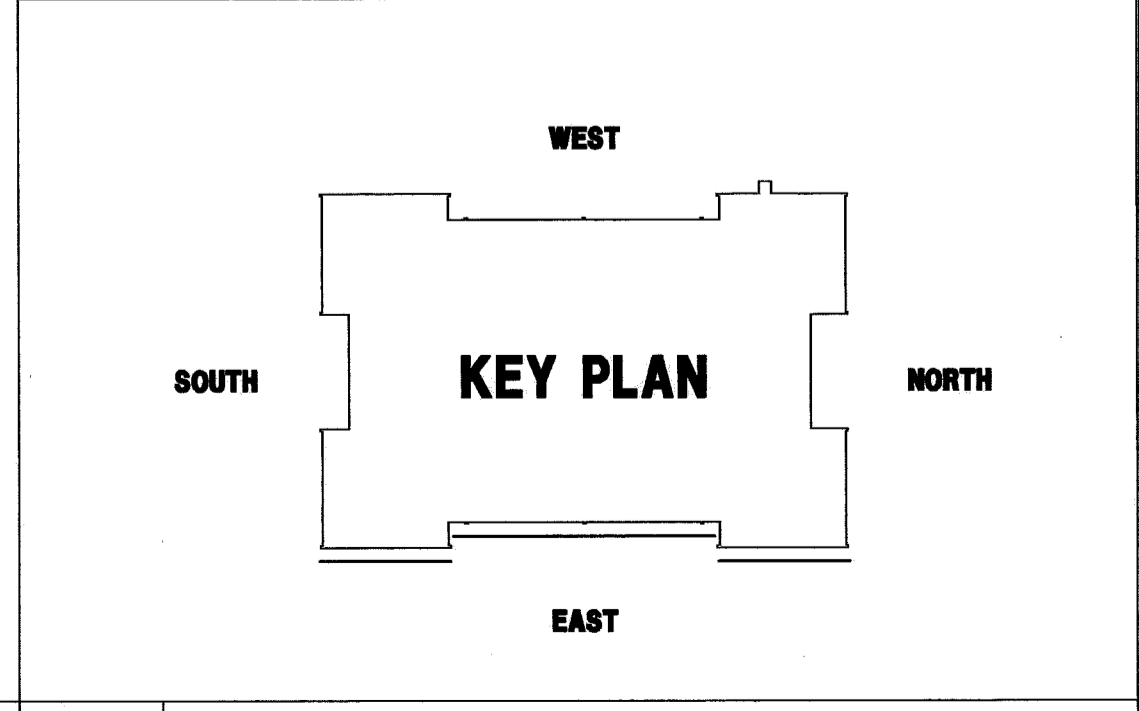

3 EAST ELEVATION REMOVALS

SCALE: 1/8" = 1'-0"

1 KEY PLAN SCALE: NTS