



Core Hood view

18ga stainless steel grease duct solid welded from hood to curb.

Grease duct wrap 615' 3m.

24ga makeup air duct 24ga galv.

2" min wool insulation non combustible face with  
24ga stainless steel

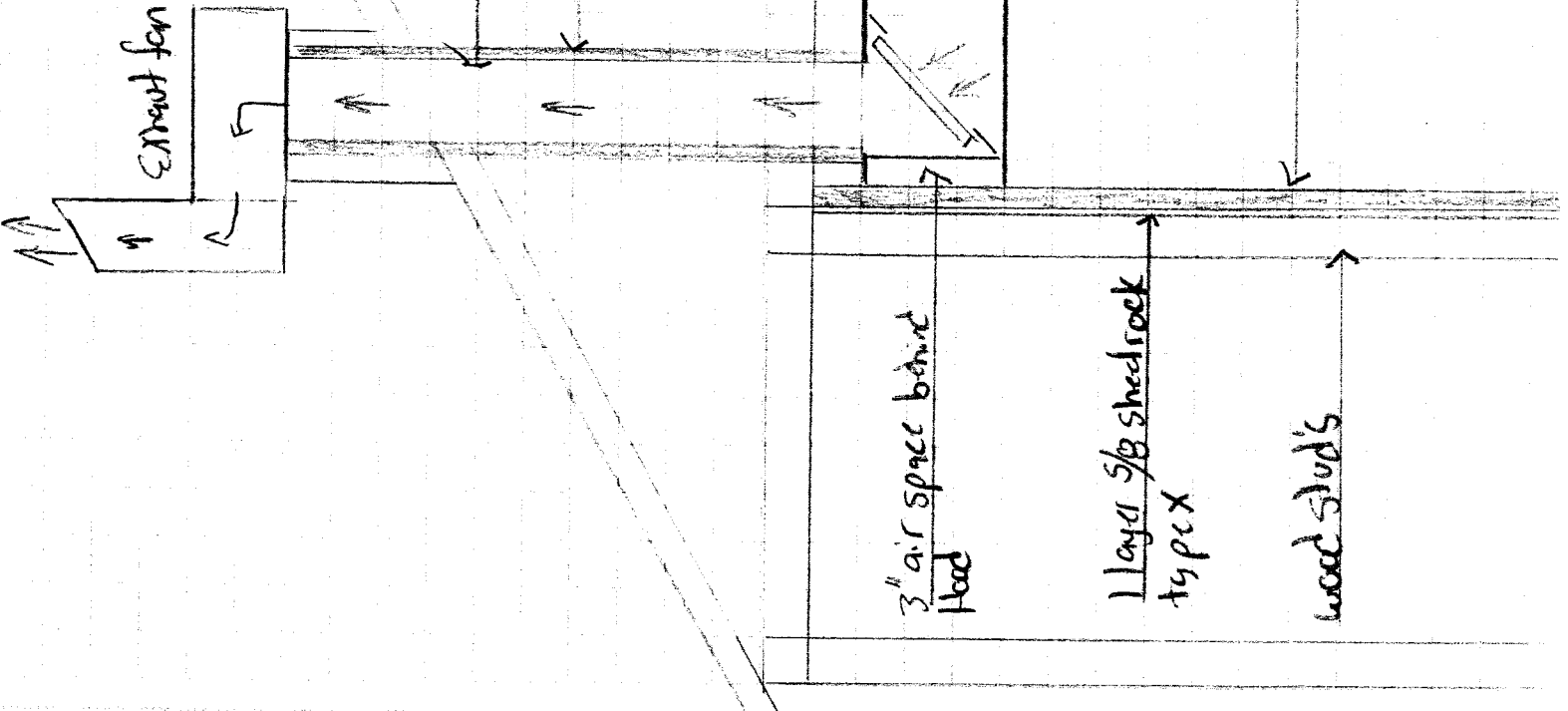

3" air space behind hood

1 layer 5/8 sheetrock  
type X

wood studs

80"

9' core hood

Exhaust fan



Reviewed for Code Compliance  
Permitting and Inspections Department  
Approved with Conditions

04/26/2018

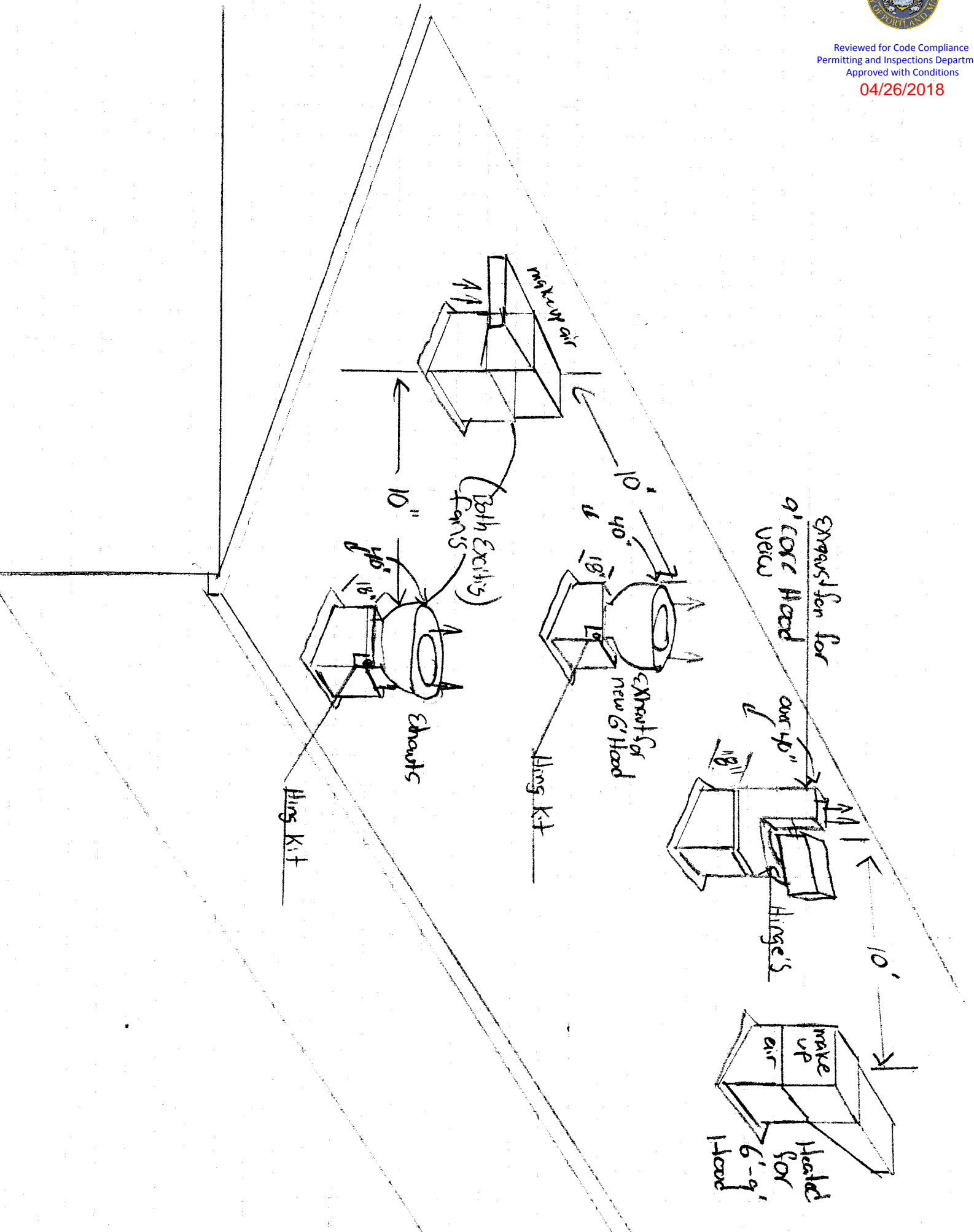

6' Hood view

