

# 502 DEERING CENTER

## Consultants:

### OWNER / APPLICANT:

502 DEERING CENTER, LLC  
55 Hamblet Avenue  
Portland, ME 04103

### ARCHITECT:

LACHMAN ARCHITECTS & PLANNERS  
58 Fore Street, Bldg 30  
Portland, ME 04101  
(207) 831-8585

### LANDSCAPE ARCHITECT:

CARROLL ASSOCIATES  
217 Commercial Street, Suite 200  
Portland, ME 04101  
(207) 772-1552

### ENGINEER:

PINKHAM & GREER CIVIL ENGINEERS  
28 Vannah Avenue  
Portland, ME 04103  
(207) 781-5242

### SURVEYOR:

FOUR POINTS ASSOCIATES, INC.  
9 Ralph Avenue  
Lewiston, ME 04240  
(207) 577-5840

## 502 STEVENS AVENUE PORTLAND, ME

### TAX MAP 16NE, LOT 135-E009

## Plan Index :

- C 0.0 EXISTING CONDITIONS SURVEY
- C 1.0 DEMOLITION AND SITE PREP PLAN
- C 2.0 SITE PLAN
- C 3.0 SUBDIVISION PLAN
- C 4.0 GRADING AND STORMWATER MANAGEMENT
- C 5.0 UTILITIES PLAN
- C 6.0 CIVIL DETAILS
- C 7.0 CIVIL DETAILS
- C 8.0 SITE DETAILS
- C 9.0 EROSION CONTROL PLAN AND NOTES
- C 10.0 DRAINAGE ANALYSIS DEVELOPED CONDITIONS
- L 1.0 LANDSCAPE AND LIGHTING PLAN
- L 2.0 LANDSCAPE DETAILS
- PHOTOMETRIC PLAN
- A1.0 LOWER LEVEL PLAN WITH SITE
- A1.1 1ST FLOOR PLAN WITH SITE
- A1.2 2ND & 3RD FLOOR PLAN
- A2.0 FRONT (EAST) ELEVATION & BUILDING SECTIONS
- A2.1 FRONT (EAST) ELEVATION
- A2.2 SIDE (SOUTH) ELEVATION
- A2.3 SIDE (NORTH) ELEVATION
- A2.4 REAR (WEST) ELEVATIONS
- A2.5 CARPORT (PH 2) AND BIKE SHELTER (PH 2)
- A3 KEYED NOTES, FEATURES & DESCRIPTIONS

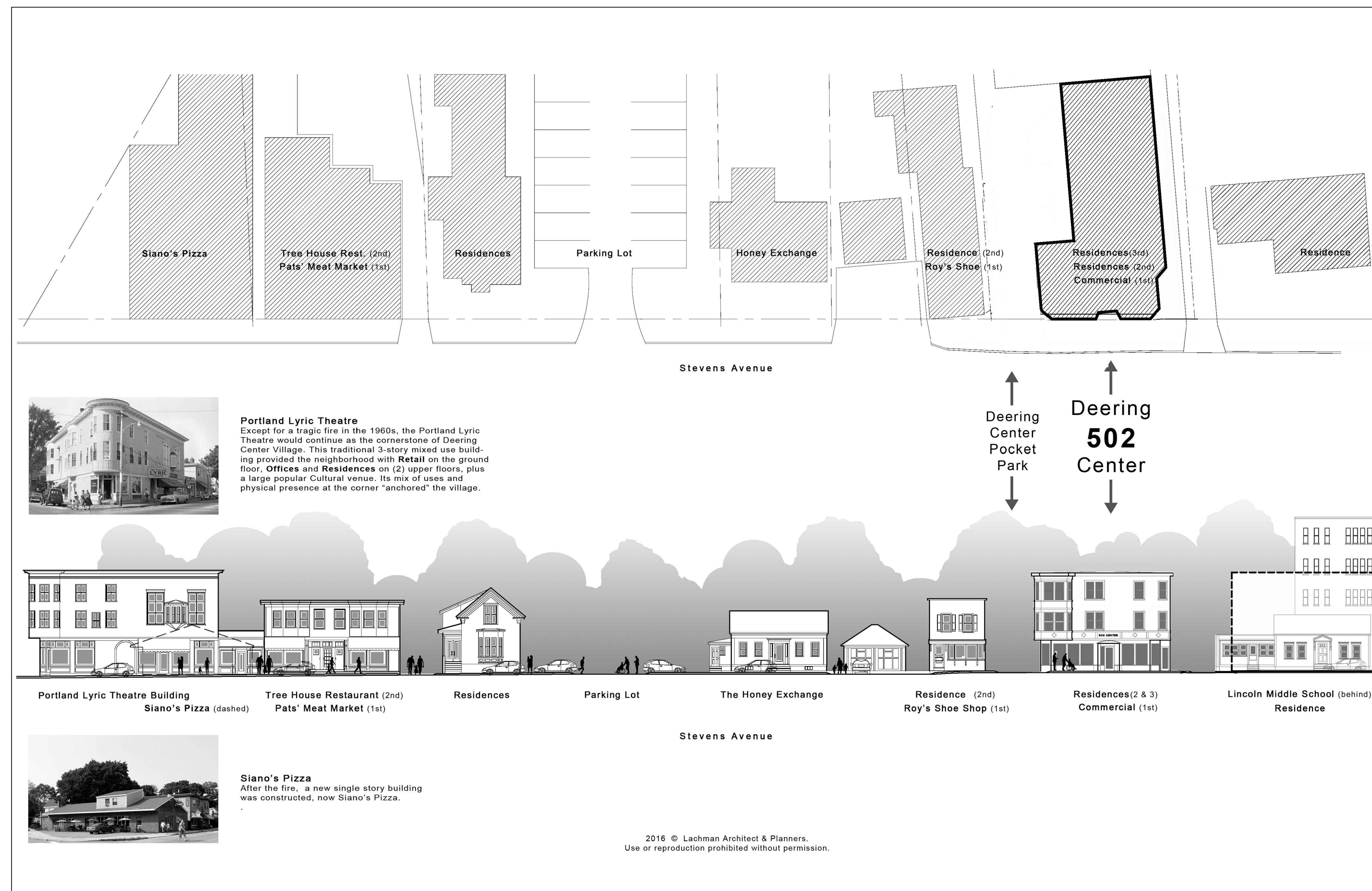

ISSUED FOR: SITE PLAN REVIEW - FINAL

ISSUE DATE: DECEMBER 22, 2016