

PROJECT DESCRIPTION

A new 3-story mixed-use building replaces existing single family residence. 1st floor is commercial, 2nd and 3rd floors each have 3 dwelling units (total 6).

PROJECT TEAM

Owner / Applicant:
502 DEERING CENTER, LLC
55 Hamblet Avenue
Portland, ME 04103

Architect:
LACHMAN ARCHITECTS & PLANNERS
58 Fore Street, Bldg 30
Portland, ME 04101
(207) 831-8585

Landscape Architect:
CARROLL ASSOCIATES
217 Commercial Street, Suite 200
Portland, ME 04101
(207) 772-1552

Civil Engineer:
PINKHAM & GREER CIVIL ENGINEERS
28 Vannah Avenue
Portland, ME 04103
(207) 781-5242

Surveyor:
FOUR POINTS ASSOCIATES, INC.
9 Ralph Avenue
Lewiston, ME 04240
(207) 577-5840

Structural:
L&L STRUCTURAL ENGINEERING
6 Q St. South Portland, ME 04106
(207) 767-4830

Mechanical/Electrical:
BENNETT ENGINEERING
7 Bennett Rd. Freeport, ME 04032
(207) 865-9475

Geotech
S. W. COLE ENGINEERING, INC.
286 Portland Road, Gray, Maine 04039
T: 207-657-2866

502 DEERING CENTER at 502 STEVENS AVENUE PORTLAND, MAINE

**TAX MAP
16NE, LOT 135-E009**

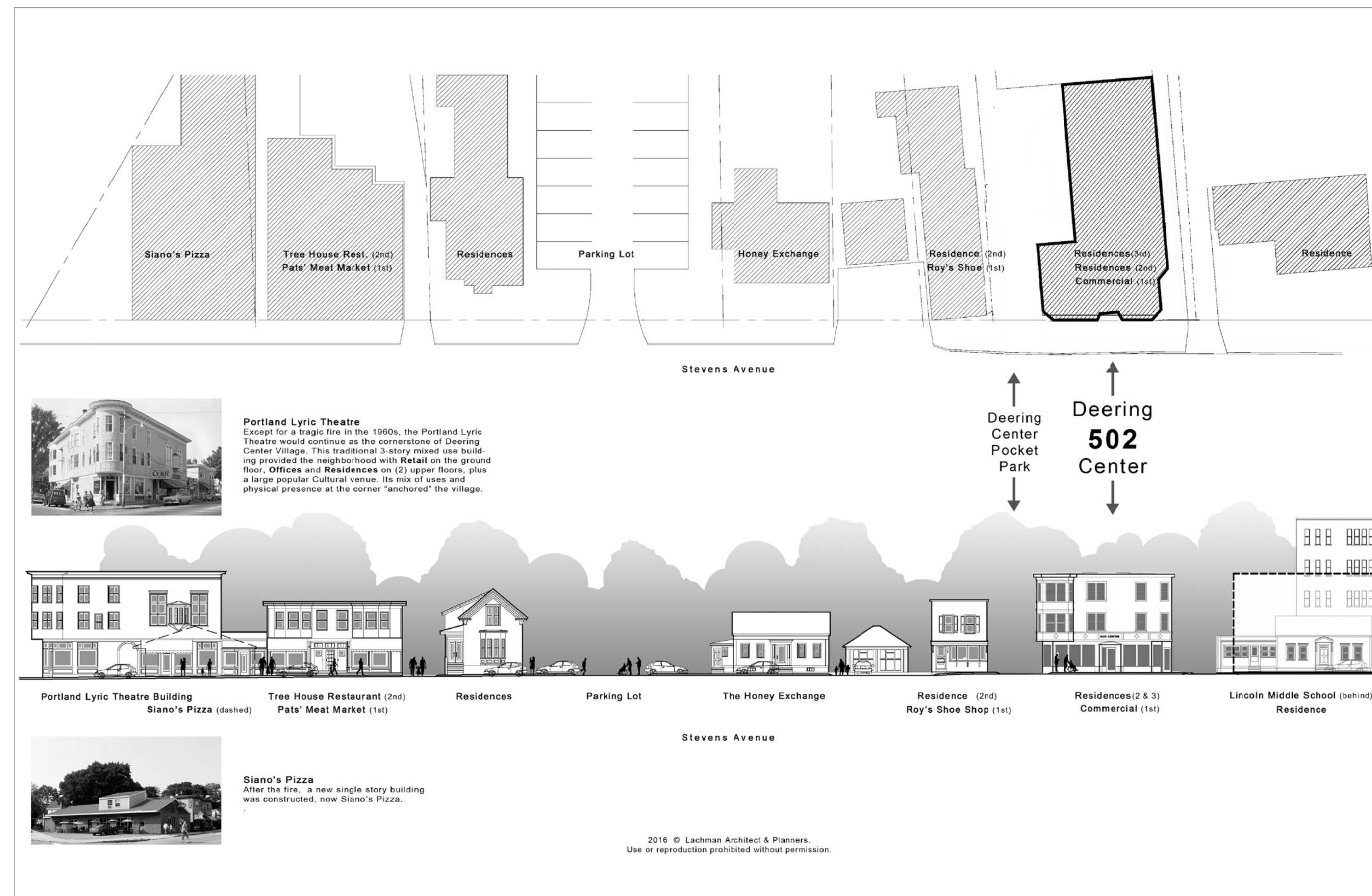

DOCUMENT INDEX

PROJECT MANUAL

COVER, PROJECT TEAM, DESCRIPTION, DRAWING INDEX

- C-0.0 EXISTING CONDITIONS SURVEY
- C-1.0 DEMOLITION & SITE PREP PLAN
- C-2.0 SITE PLAN
- C-4.0 GRADING & STORMWATER MANAGEMENT
- C-5.0 UTILITIES PLAN
- C-6.0 CIVIL DETAILS
- C-7.0 CIVIL DETAILS
- C-8.0 SITE DETAILS
- C-8.1 SITE DETAILS
- C-9.0 EROSION CONTROL PLAN & NOTES

- L-1.0 LANDSCAPE AND LIGHTING PLAN
- L-2.0 LANDSCAPE DETAILS

- A 0 CODE & LIFE SAFETY
- A 1.1 1ST FLOOR PLAN & ADA BATHROOMS
- A 1.2 2ND & 3RD FLOOR PLAN & WALL TYPES
- A 2.1 FRONT (EAST) & SIDE (NORTH) ELEVATIONS & ROOF PLAN
- A 2.2 SIDE (SOUTH) & REAR (WEST) ELEVATIONS
- A 3.1 BUILDING SECTIONS
- A 3.2 WALL SECTIONS
- A 3.3 WALL SECTIONS & EXTERIOR DETAILS
- A 3.4 EXTERIOR DETAILS
- A 3.5 BAYS & ENLARGED PLAN DETAILS
- A 4.1 ENLARGED BATHROOMS
- A 4.2 ENLARGED KITCHENS
- A 5.1 STAIRS
- A 6.1 WINDOW TYPES & SCHEDULE
- A 6.2 DOOR TYPES & SCHEDULE
- A 6.3 FINISH SCHEDULE

- S 0.1 GENERAL NOTES
- S 1.0 FOUNDATION PLAN
- S 1.1 FOUNDATION SECTIONS & DETAILS
- S 2.0 SECOND FLOOR FRAMING
- S 2.1 THIRD FLOOR FRAMING
- S 2.2 ROOF FRAMING PLAN
- S 3.0 FRAMING SECTIONS & DETAILS

- M 1.1 MECHANICAL PLANS
- M 2.1 SANITARY PLUMBING PLANS
- M 2.2 DOMESTIC PLUMBING PLANS
- M 3.1 MECHANICAL DETAILS & LEGEND
- M 3.2 MECHANICAL SCHEDULES & DETAILS

- E 0.1 ELECTRICAL SITE PLAN
- E 1.1 LIGHTING PLANS
- E 2.1 POWER PLANS - 1ST, 2ND & 3RD FLOORS
- E 2.2 ROOF POWER PLAN
- E 3.1 NOTES, LEGEND, ONE-LINE DIAGRAM
- E 3.2 LIGHTING FIXTURE SCHEDULE & PANEL SCHEDULES

Lachman
Architects & Planners

Architecture
Community Design
Preservation

58 Fore St. Bldg 30
Portland, Maine 04101
207-831-8585

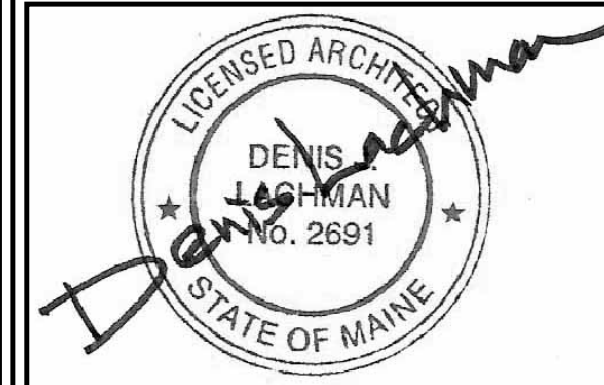

502 DEERING CENTER
NEW MIXED USE
502 STEVENS AVE, PORTLAND ME

FOR PERMIT
NOT FOR
CONSTRUCTION

TITLE:
COVER

REV	DATE	ISSUE
D		
C		
B		
A	05/15/2017	PERMIT

DRAWING NO:
0