

CONCRETE SPECIFICATION:  
 • 4000 psi  
 • 3/4" AGGREGATE  
 • 6-7% AIR ENTRAINMENT  
 • SLUMP - 4" ± 1"

FINISH SPECIFICATION:  
 • BROOM SWEEP FINISH  
 • CURE WITH CURE-TO-SPEC MS  
 • AFTER CONSTRUCTION JOINTS HAVE BEEN FILLED AND SEALED, APPLY "CONSOLIDACK SALT GUARD"

JOINT SPECIFICATIONS:  
 • SPACING OF CONTROL JOINTS:  
 •• 10 FEET ON CENTER ALONG LENGTH  
 •• 6 FEET ON CENTER ALONG WIDTH  
 • SAW CUT JOINTS AT 1 1/2" MAX. DEPTH  
 • EXPANSION JOINTS SHALL BE PROVIDED ALONG FOUNDATION AND ALL OTHER HARD, NON-FLEXIBLE STRUCTURES

NOTE:  
 ALL CONCRETE SHALL BE PLACED BY AN A.C.I. FLATWORK CERTIFIED FINISHER

1 CONCRETE PAVEMENT (INTERNAL WALKWAYS)  
 NOT TO SCALE

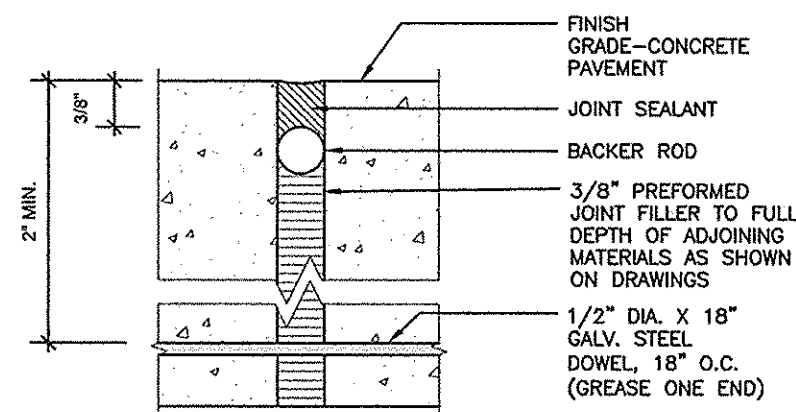

2 EXPANSION JOINT  
 NOT TO SCALE

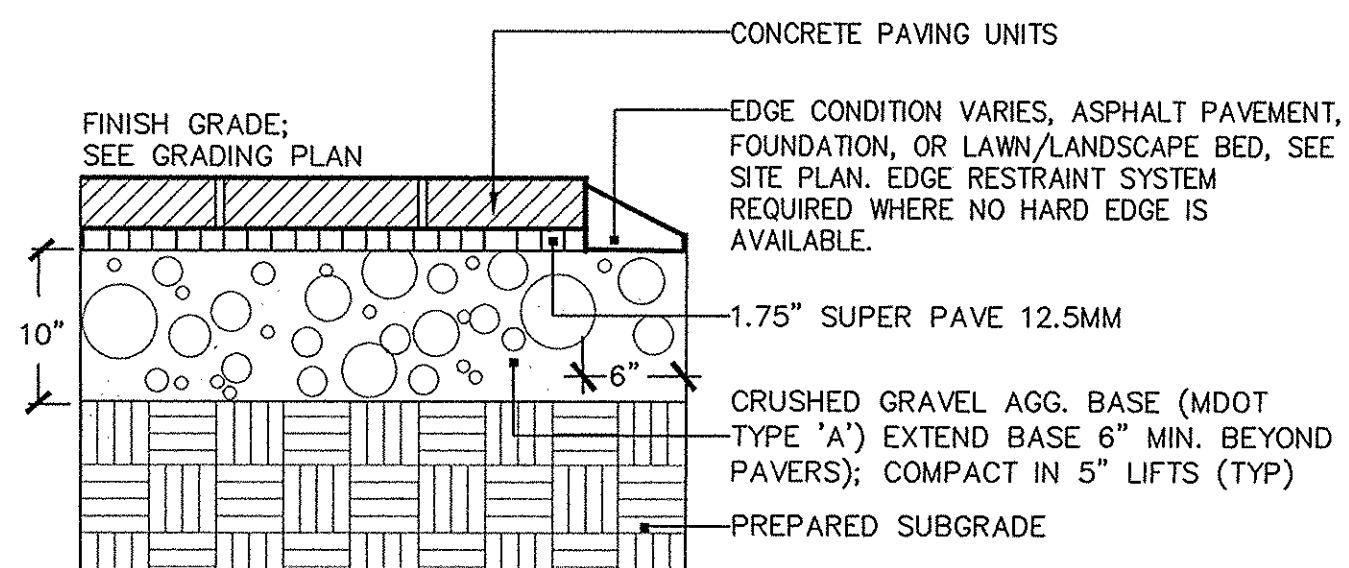

3 CONCRETE PAVERS (INTERNAL WALKWAYS)  
 NOT TO SCALE

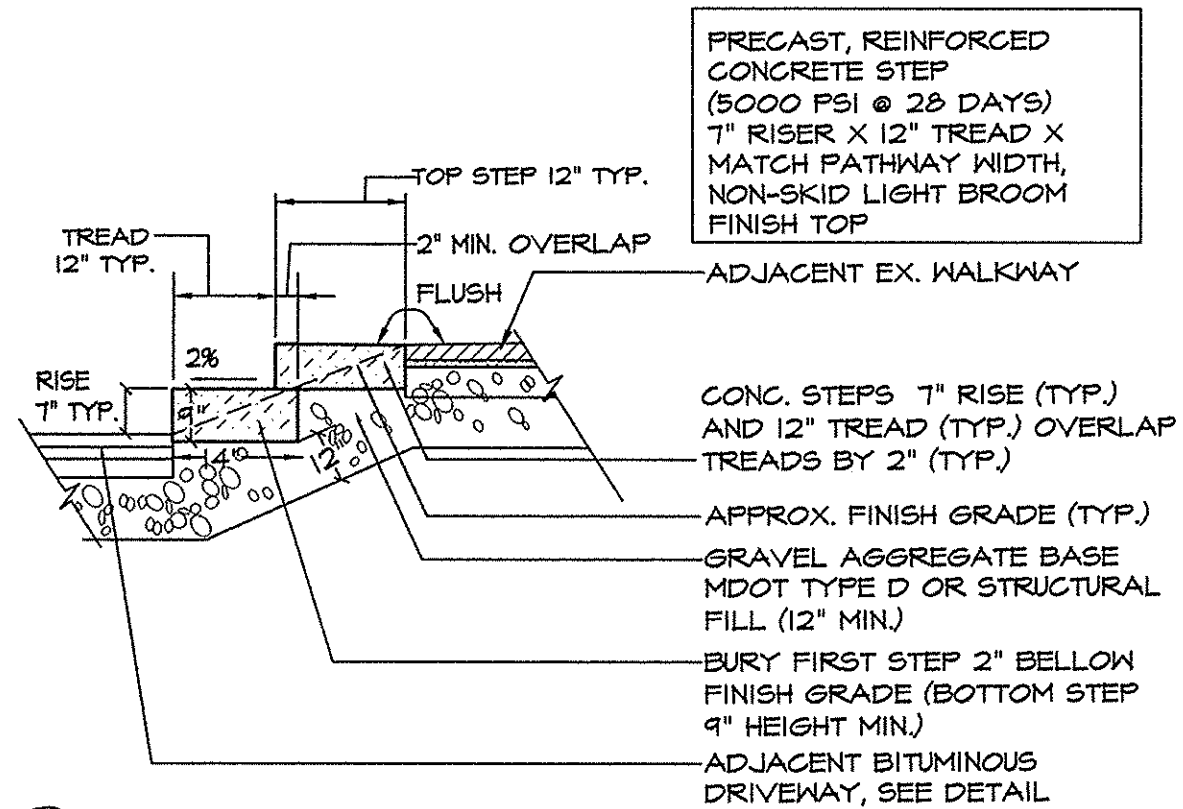

5 PRECAST CONCRETE STEPS  
 NOT TO SCALE

Project Name:

**502  
 Deering  
 Center**  
 Portland, Maine

Owner / Applicant:

502 Deering Center, LLC  
 55 Hamblet Avenue  
 Portland, Maine 04103

Consultants:

**Architect**  
 Lachman Architects & Planners  
 58 Fore Street, Bldg 30  
 Portland, Maine 04101  
 207.831.8585  
 Contact: Denis Lachman

**Landscape Architects**  
 Carroll Associates  
 217 Commercial St.  
 Portland, Maine 04101  
 207.772.1552  
 Contact: Patrick Carroll

**Civil Engineer**  
 Pinkham & Greer Civil Engineers  
 28 Vannah Ave.  
 Portland, ME 04103  
 207.781.5242  
 Contact: Thomas Greer

**Surveyor**  
 Four Points Associates, Inc.  
 9 Ralph Avenue  
 Lewiston, Maine 04240  
 207.577.5840  
 Contact: Donald Dostie

Drawing Set:

No.	Date	Revision
1	12-22-16	SITE PLAN REVIEW-FINAL
2	2-7-17	REVS PER CITY COMMENTS
3	3-14-17	REVS PER CITY COMMENTS
4	4-12-17	FINAL CITY PLANS

Drawing Set:

PERMITTING

Drawn:

MAP

Checked:

MAP

Approved:

PC

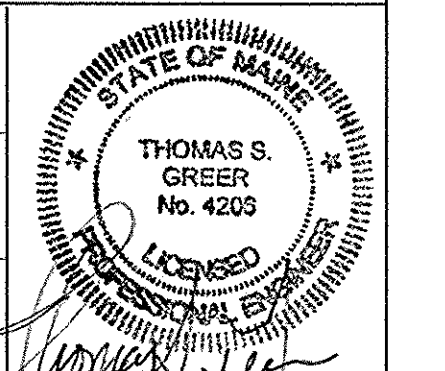

Drawing Title:

SITE DETAILS

Job Number:

File:

Date: 12-22-2016

Scale: AS SHOWN

Drawing Number:

**C-8.1**

© 2017 CARROLL ASSOCIATES