

DISPLAY THIS CARD ON PRINCIPAL FRONTAGE OF WORK

CITY OF PORTLAND

BUILDING INSPECTION

PERMIT

Please Read
Application And
Notes, If Any,
Attached

PERMIT ISSUED

Permit Number 080330 2008
APR 9 2008

CITY OF PORTLAND

This is to certify that CITY OF PORTLAND / Home Depot

has permission to Install a 6' x 6' storage shed

AT 512 STEVENS AVE

135 E007001

provided that the person or persons who apply for and accept this permit shall comply with all of the provisions of the Statutes of the State of Oregon and of the Ordinances of the City of Portland regulating the construction, maintenance and use of buildings and structures, and of the application on file in this department.

Apply to Public Works for street line and grade if nature of work requires such information.

Notification of inspection must be given and when permission is procured before this building or part thereof is leased or otherwise closed-in. 24 HOUR NOTICE IS REQUIRED.

A certificate of occupancy must be procured by owner before this building or part thereof is occupied.

OTHER REQUIRED APPROVALS

Fire Dept. _____

Health Dept. _____

Appeal Board _____

Other _____

Department Name

Anne Bonke 4/23/08
Director - Building & Inspection Services
perc.H.

PENALTY FOR REMOVING THIS CARD

City of Portland, Maine - Building or Use Permit Application

389 Congress Street, 04101 Tel: (207) 874-8703, Fax: (207) 874-8716

Permit No: 08-0331	Issue Date:	CBL: 135 E007001
-----------------------	-------------	---------------------

Location of Construction: 512 STEVENS AVE	Owner Name: CITY OF PORTLAND	Owner Address: 389 CONGRESS ST	Phone:
Business Name:	Contractor Name: Home Depot	Contractor Address: 245 Riverside St. Portland	Phone: 2077610600
Lessee/Buyer's Name	Phone:	Permit Type: Sheds	Zone: R-5

Past Use: Lincoln Middle School	Proposed Use: Lincoln Middle School - Install a 8'x8' storage shed	Permit Fee: \$30.00	Cost of Work: \$799.00	CEO District: 5
		FIRE DEPT: <input type="checkbox"/> Approved <input type="checkbox"/> Denied	INSPECTION: Use Group: U Type: SB	

Proposed Project Description: Install a 8'x 8' storage shed	Signature:	Signature: <i>JMB 4/23/08</i>
PEDESTRIAN ACTIVITIES DISTRICT (P.A.D.)		
Action: <input type="checkbox"/> Approved <input type="checkbox"/> Approved w/Conditions <input type="checkbox"/> Denied <i>per C.H.</i>		
Signature:	Date:	

Permit Taken By: Idobson	Date Applied For: 04/09/2008	Zoning Approval		
-----------------------------	---------------------------------	------------------------	--	--

- This permit application does not preclude the Applicant(s) from meeting applicable State and Federal Rules.
- Building permits do not include plumbing, septic or electrical work.
- Building permits are void if work is not started within six (6) months of the date of issuance. False information may invalidate a building permit and stop all work..

Special Zone or Reviews	Zoning Appeal	Historic Preservation
<input type="checkbox"/> Shoreland	<input type="checkbox"/> Variance	<input checked="" type="checkbox"/> Not in District or Landmark
<input type="checkbox"/> Wetland	<input type="checkbox"/> Miscellaneous	<input type="checkbox"/> Does Not Require Review
<input type="checkbox"/> Flood Zone	<input type="checkbox"/> Conditional Use	<input type="checkbox"/> Requires Review
<input type="checkbox"/> Subdivision	<input type="checkbox"/> Interpretation	<input type="checkbox"/> Approved
<input checked="" type="checkbox"/> Site Plan <i>Exemption</i>	<input type="checkbox"/> Approved	<input type="checkbox"/> Approved w/Conditions
<i>Site Plan Exemption</i>	<input type="checkbox"/> Denied	<input type="checkbox"/> Denied
Maj <input type="checkbox"/> Minor <input type="checkbox"/> MM <input type="checkbox"/>	Date: <i>4/15/08</i>	Date:

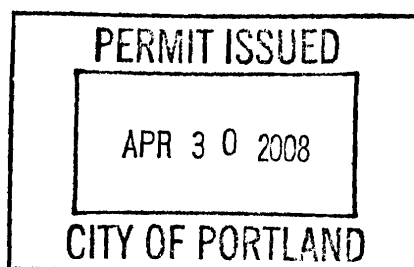

CERTIFICATION

I hereby certify that I am the owner of record of the named property, or that the proposed work is authorized by the owner of record and that I have been authorized by the owner to make this application as his authorized agent and I agree to conform to all applicable laws of this jurisdiction. In addition, if a permit for work described in the application is issued, I certify that the code official's authorized representative shall have the authority to enter all areas covered by such permit at any reasonable hour to enforce the provision of the code(s) applicable to such permit.

SIGNATURE OF APPLICANT ADDRESS DATE PHONE

RESPONSIBLE PERSON IN CHARGE OF WORK, TITLE DATE PHONE

BUILDING PERMIT INSPECTION PROCEDURES

Please call 874-8703 or 874-8693 (ONLY)

to schedule your inspections as agreed upon

Permits expire in 6 months, if the project is not started or ceases for 6 months.

The Owner or their designee is required to notify the inspections office for the following inspections and provide adequate notice. Notice must be called in 48-72 hours in advance in order to schedule an inspection:

By initializing at each inspection time, you are agreeing that you understand the inspection procedure and additional fees from a "Stop Work Order" and "Stop Work Order Release" will be incurred if the procedure is not followed as stated below.

A Pre-construction Meeting will take place upon receipt of your building permit.

 X Final inspection required at completion of work.

Certificate of Occupancy is not required for certain projects. Your inspector can advise you if your project requires a Certificate of Occupancy. All projects DO require a final inspection.

If any of the inspections do not occur, the project cannot go on to the next phase, REGARDLESS OF THE NOTICE OR CIRCUMSTANCES.

CERIFICATE OF OCCUPANICES MUST BE ISSUED AND PAID FOR, BEFORE THE SPACE MAY BE OCCUPIED.



Signature of Applicant/Designee

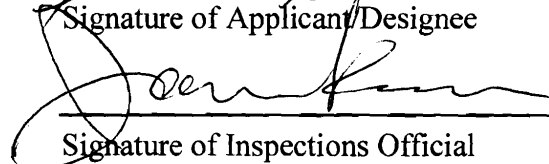

Signature of Inspections Official

4/30/08
Date

4/30/08
Date

City of Portland, Maine - Building or Use Permit

389 Congress Street, 04101 Tel: (207) 874-8703, Fax: (207) 874-8716

Permit No: 08-0331	Date Applied For: 04/09/2008	CBL: 135 E007001
------------------------------	--	----------------------------

Location of Construction: 512 STEVENS AVE	Owner Name: CITY OF PORTLAND	Owner Address: 389 CONGRESS ST	Phone:
Business Name:	Contractor Name: Home Depot	Contractor Address: 245 Riverside St. Portland	Phone: (207) 761-0600
Lessee/Buyer's Name	Phone:	Permit Type: Sheds	

Proposed Use: Lincoln Middle School - Install a 8'x8' storage shed	Proposed Project Description: Install a 8'x 8' storage shed
--	---

Dept: Zoning	Status: Approved with Conditions	Reviewer: Marge Schmuckal	Approval Date: 04/15/2008
Note:			Ok to Issue: <input checked="" type="checkbox"/>
1) This permit is being approved on the basis of revised plans submitted on 4/15/08. Any deviations shall require a separate approval before starting that work. It is understood that the 8'x8' shed will be placed 5' from the rear and side property lines. The shed is now well beyond the minimum 20' front setback.			
Dept: Building	Status: Approved with Conditions	Reviewer: Chris Hanson	Approval Date: 04/16/2008
Note:			Ok to Issue: <input checked="" type="checkbox"/>
1) Application approval based upon information provided by applicant. Any deviation from approved plans requires separate review and approval prior to work.			

Comments:
4/9/2008-mes: the shed is shown within the required front and side setbacks - I called Tom Fournier and left him a message that I need revised plans. I gave the site plan exemption to planning.
4/15/2008-mes: Tom Fournier came in with revised plans - Now a 8'x8' shed not near the front - 5' from the side and 5' from the rear yards - I passed on the information to planning for their site plan exemption.



General Building Permit Application

If you or the property owner owes real estate or personal property taxes or user charges on any property within the City, payment arrangements must be made before permits of any kind are accepted.

Location/Address of Construction: <u>LINCOLN Middle School 522 STEVENS AVE</u>		
Total Square Footage of Proposed Structure/Area <u>100 sqft</u>		Square Footage of Lot
Tax Assessor's Chart, Block & Lot Chart# <u>135</u> Block# <u>2</u> Lot# <u>7</u>	Applicant * must be owner, Lessee or Buyer * Name <u>THOMAS FOURNIER</u> Address <u>522 Stevens Ave</u> City, State & Zip <u>Portland ME 04106</u>	Telephone: <u>874 8145</u>
Lessee/DBA (If Applicable)	Owner (if different from Applicant) Name <u>Portland Public School</u> Address <u>196 Allen Ave</u> City, State & Zip <u>Portland ME 04103</u>	Cost Of Work: \$ <u>799⁰⁰</u> C of O Fee: \$ _____ Total Fee: \$ <u>30⁰⁰</u>
Current legal use (i.e. single family) <u>public school</u>		
If vacant, what was the previous use? _____		
Proposed Specific use: <u>storage of gardening supplies</u> must have 4/2-1/08		
Is property part of a subdivision? <u>NO</u> If yes, please name _____		
Project description: <u>construction of a 10'x10' storage shed in the educational garden near the geodesic dome, built by Home Depot</u>		
Contractor's name: <u>Home Depot</u>		
Address: <u>245 Riverside St</u>		
City, State & Zip: <u>Portland ME 04103</u>		Telephone: <u>761-0600</u>
Who should we contact when the permit is ready: <u>THOMAS FOURNIER</u>		Telephone: <u>874 8145</u>
Mailing address: <u>245 Riverside St Portland ME 04103</u>		

Please submit all of the information outlined on the applicable Checklist. Failure to do so will result in the automatic denial of your permit.

In order to be sure the City fully understands the full scope of the project, the Planning and Development Department may request additional information prior to the issuance of a permit. For further information or to download copies of this form and other applications visit the Inspections Division on-line at www.portlandmaine.gov, or stop by the Inspections Division office, room 315 City Hall or call 874-8703.

I hereby certify that I am the Owner of record of the named property, or that the owner of record authorizes the proposed work and that I have been authorized by the owner to make this application as his/her authorized agent. I agree to conform to all applicable laws of this jurisdiction. In addition, if a permit for work described in this application is issued, I certify that the Code Official's authorized representative shall have the authority to enter all areas covered by this permit at any reasonable hour to enforce the provisions of the codes applicable to this permit.

Signature: Thom Fournier Date: 4/9/08

This is not a permit; you may not commence ANY work until the permit is issued.

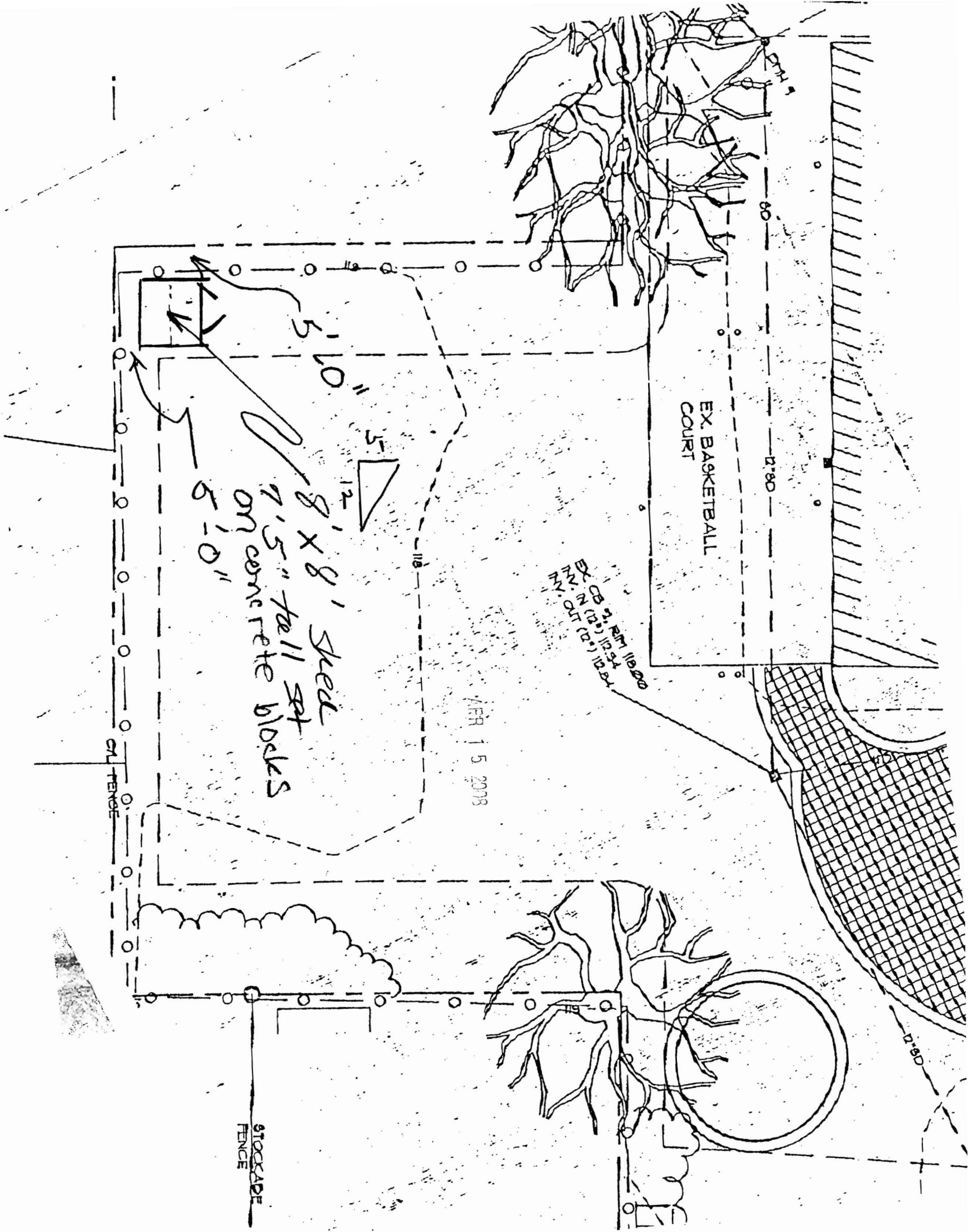

EX. BASKETBALL COURT

8' x 8' steel
 7.5" tall set
 on concrete blocks
 5'-0"

APR 15 2008

EM 11800
 11834
 11834
 11834
 11834

CH FENCE

STOCKADE FENCE

60'

27'80"

17'80"



Geodesic dome / educational garden storage shed

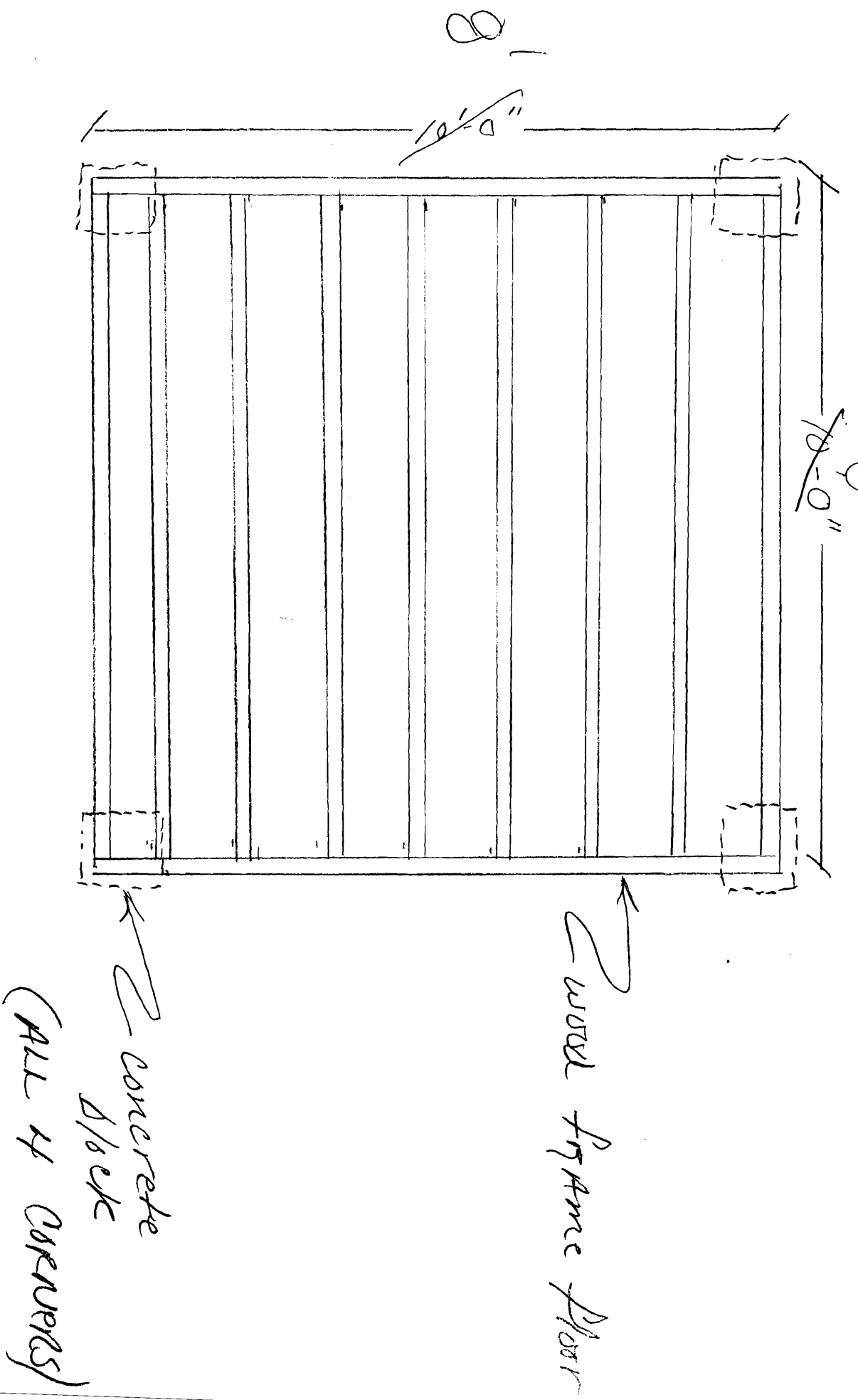

Linncoln Middle School
5222 Stevens Ave Portland, OR 97219

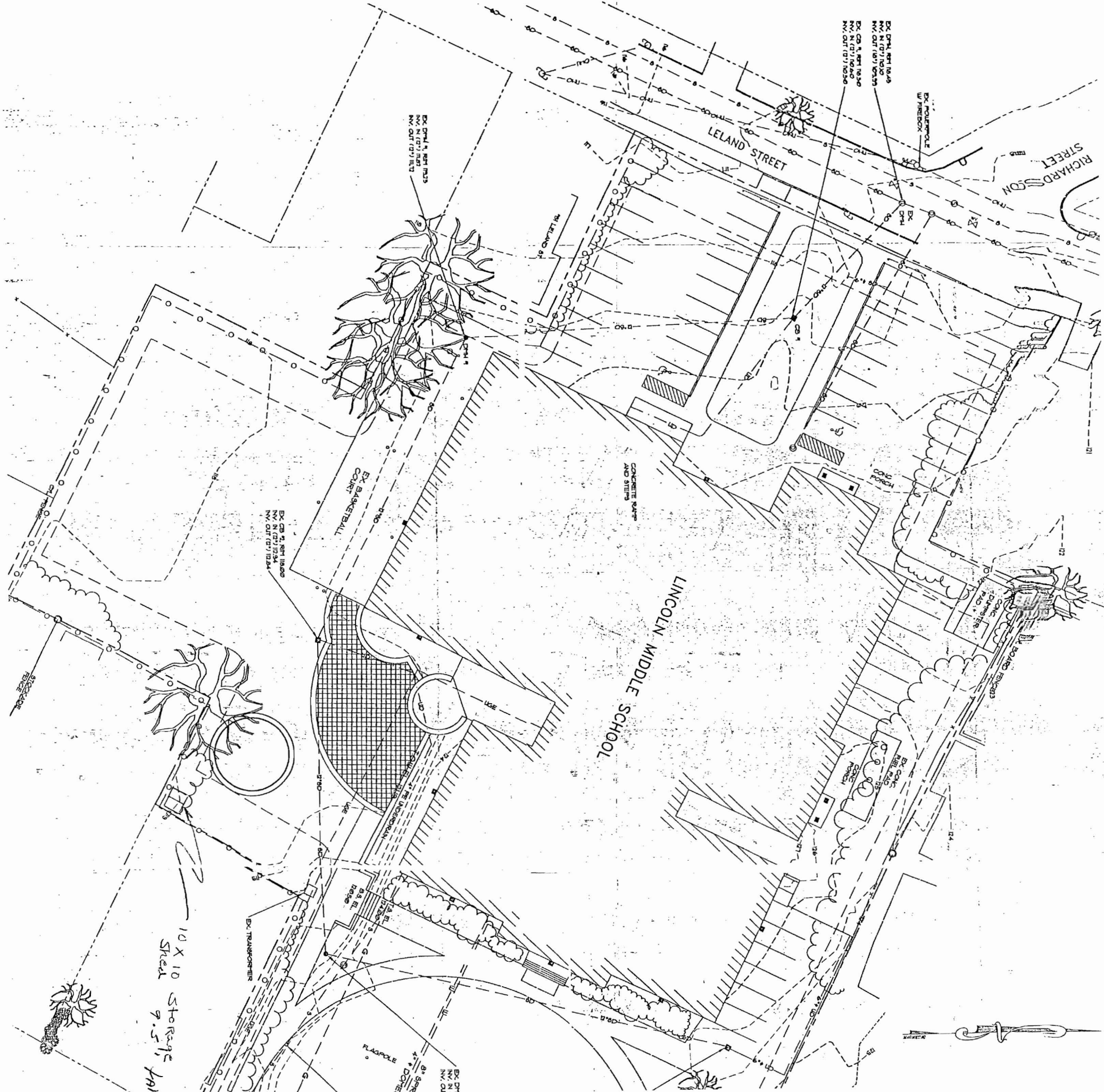

10 X 10 Storage Shed
9.5' x 11'

