

THIS IS NOT A BOUNDARY SURVEY

MORTGAGE INSPECTION OF: DEED BOOK 12903 PAGE 48 COUNTY Cumberland
PLAN BOOK 6 PAGE 18 LOT 19 1/2 28

ADDRESS: 147 Clinton Street, Portland, Maine

Job Number: 447-53
Inspection Date: 11-21-03
Scale: 1"=20'
File No: n/a

Owner: Francis Watson

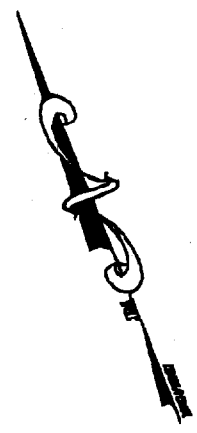
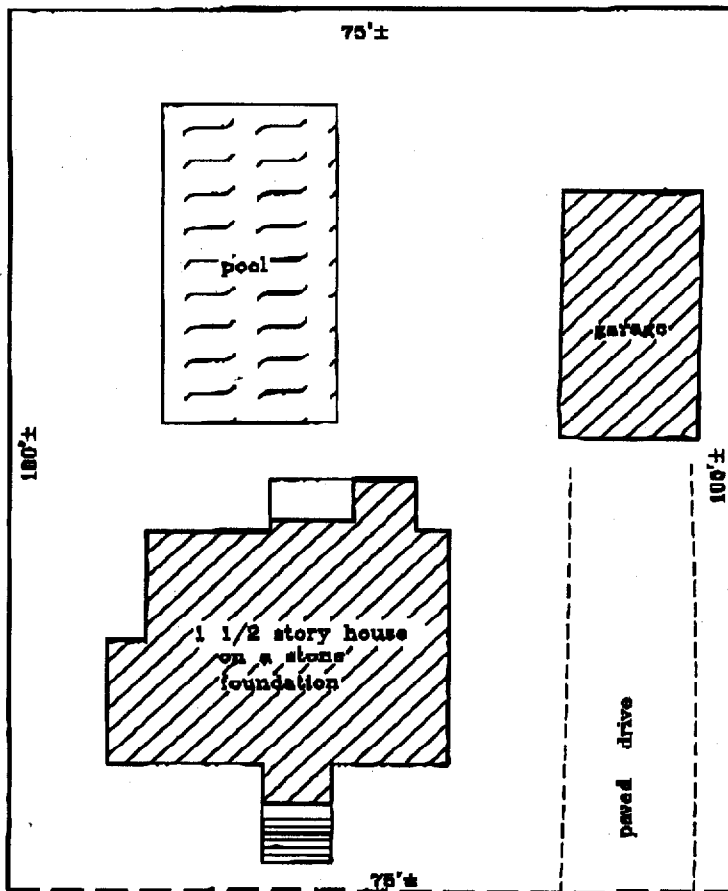

Clinton Street

[Handwritten signature]

I HEREBY CERTIFY TO: Stewart Title of Northern New England, Inc.

and its title insurer.

Monuments found did not conflict with the deed description.

The dwelling setbacks do not violate town zoning requirements.

As delineated on the Federal Emergency Management Agency Community Panel: 230051 0007 B

The structure does not fall within the special flood hazard zone.

The land does not fall within the special flood hazard zone.

A wetlands study has not been performed.

APPARENT EASEMENTS AND RIGHTS OF WAY ARE SHOWN. OTHER ENCUMBRANCES, RECORDED OR NOT, MAY EXIST. THIS SKETCH WILL NOT REVEAL ABUTTING DEED CONFLICTS, IF ANY.

copyright 1994

Livingston - Hughes
Professional Land Surveyors & Foresters
88 Guinea Road
Kennebunkport - Maine 04046
207-987-9761 phone 207-987-4831 fax

THIS SKETCH IS FOR MORTGAGE PURPOSES ONLY

