

$$\begin{array}{r}
 12 \times 20'5'' = 246 \\
 5 \times 4 = 20 \\
 \hline
 266
 \end{array}$$

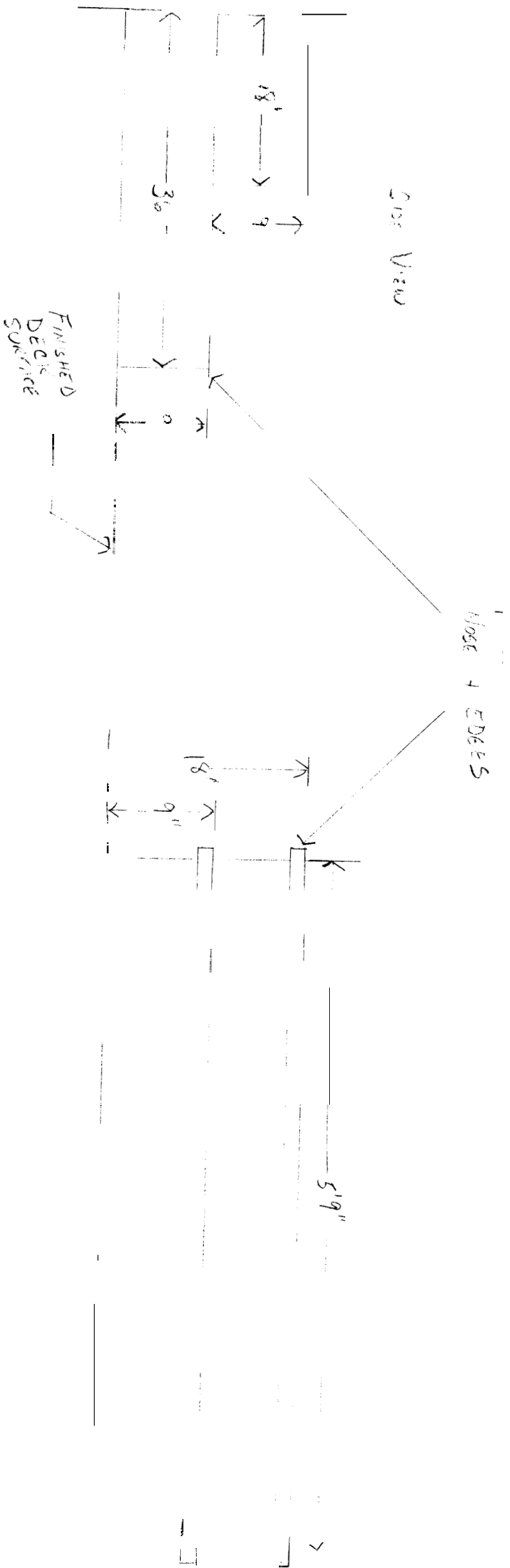

FOUNDATION SYSTEM

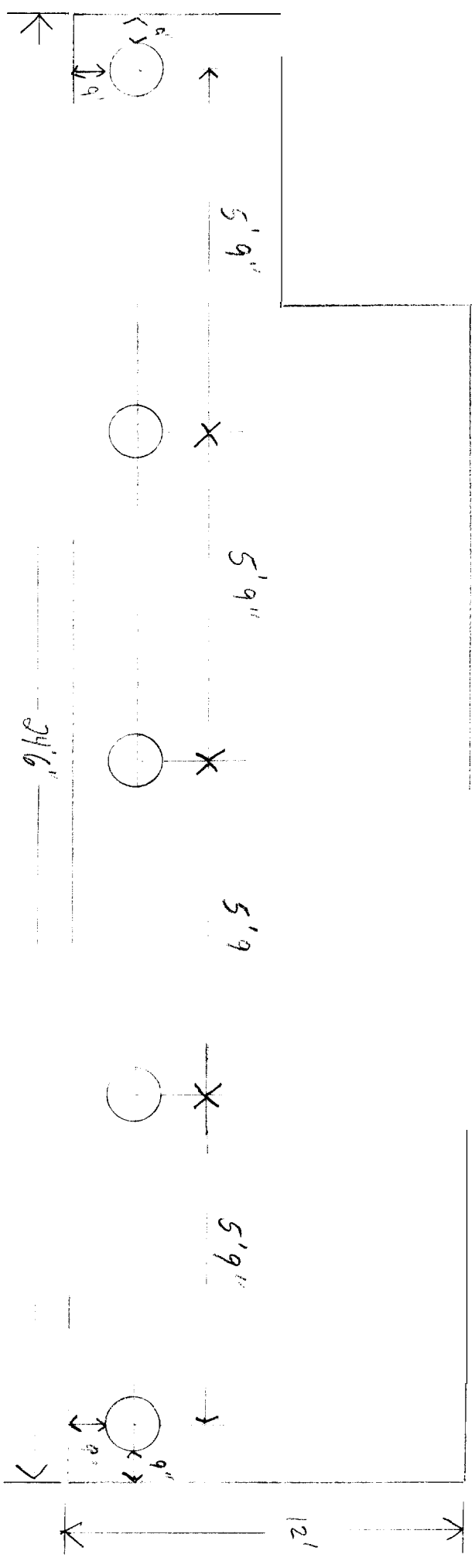

House

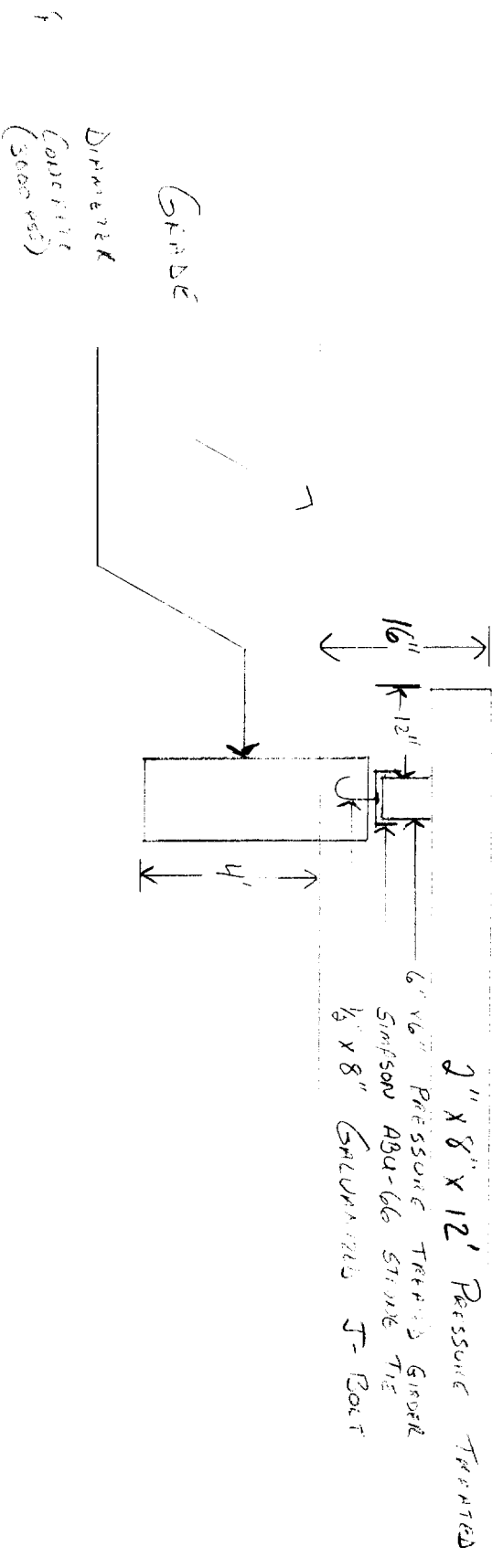

2" X 8" X 12' PRESSURE TREATED GIRDER
6" X 6" PRESSURE TREATED GIRDER
SIMPSON ABU-66 STRIKE TIE
5/8" X 8" GALVANIZED J-BOAT

① FRAMING - 2" X 8" PRESSURE TREATED

FRAMING

- ② LEDGER - 2X8' PRESSURE TREATED
DOUBLE LEDGER WITH
3/4" T X 3"W X 7 1/2" H
PRESSURE TREATED SPACERS
33" O.C.
JOIST NAILS: EACH END
- ③ FLOOR JOIST 16" O.C.
2" X 8" PRESSURE TREATED

