

DISPLAY THIS CARD ON PRINCIPAL FRONTAGE OF WORK CITY OF PORTLAND

Please Read Application And Notes, If Any, Attached

PERMIT ISSUED
Permit Number: 060433
MAY - 1 2006
CITY OF PORTLAND

This is to certify that RICE GEOFFREY I
has permission to retail - sign install a 32" x 37" 1.5"
AT 197 PLEASANT AVE (463 Stevens) L 132 J001001

provided that the person or persons responsible for the erection and maintenance of this permit shall comply with all of the provisions of the Statutes of the State and of the Ordinances of the City of Portland regulating the construction, maintenance and use of buildings and structures, and of the application on file in this department.

Apply to Public Works for street line and grade if nature of work requires such information.

Notification of inspection must be given and when permission procured before this building or part thereof is altered or proposed-in-4
FOUR NOTICE IS REQUIRED.

A certificate of occupancy must be procured by owner before this building or part thereof is occupied.

OTHER REQUIRED APPROVALS

Fire Dept. _____
Health Dept. _____
Appeal Board _____
Other _____

DepartmentName

[Signature] 4/27/06
Director - Building & Inspection Services

PENALTY FOR REMOVING THIS CARD

City of Portland, Maine - Building or Use Permit Application

389 Congress Street, 04101 Tel: (207) 874-8703, Fax: (207) 874-8716

Permit No: 06-0438	Issued Date: PERMIT ISSUED	CU: 132 J001001
-----------------------	--------------------------------------	--------------------

Location of Construction: 197 PLEASANT AVE	Owner Name: RICE GEOFFREY I	Owner Address: 658 CONGRESS ST 1ST FLOOR	Phone:
Business Name:	Contractor Name:	Contractor Address:	Phone:
Lessee/Buyer's Name	Phone:	Permit Type: Signs - Permanent	Zone: B1

Past Use: Commercial/ retail	Proposed Use: Commercial/ retail - sign install a 32" x 37" x 1.5"	Permit Fee: \$62.00	Cost of Work: \$62.00	CEO District: 5
Proposed Project Description: retail - sign install a 32" x 37" x 1.5" (423 Stevens)		FIRE DEPT: <input type="checkbox"/> Approved <input checked="" type="checkbox"/> Denied Signature: <i>N/A</i>		INSPECTION: Use Group <i>U</i> Type <i>Sig</i> <i>C 2003</i> Signature: _____
PEDESTRIAN ACTIVITIES DISTRICT (P.A.D.) Action <input type="checkbox"/> Approved <input type="checkbox"/> Approved w/Conditions <input type="checkbox"/> Denied Signature: _____ Date: _____				

Permit Taken By: Idobson	Date Applied For: 03/31/2006	Zoning Approval		
------------------------------------	--	------------------------	--	--

1. This permit application does not preclude the Applicant(s) from meeting applicable State and Federal Rules. 2. Building permits do not include plumbing, septic or electrical work. 3. Building permits are void if work is not started within six (6) months of the date of issuance. False information may invalidate a building permit and stop all work..	Special Zone or Reviews <input type="checkbox"/> Shoreland <input type="checkbox"/> Wetland <input type="checkbox"/> Flood Zone <input type="checkbox"/> Subdivision <input type="checkbox"/> Site Plan Maj <input type="checkbox"/> Minor <input type="checkbox"/> MM <input type="checkbox"/> <i>UK</i> Date: <i>4/27/06</i> <i>ABM</i>	Zoning Appeal <input type="checkbox"/> Variance <input type="checkbox"/> Miscellaneous <input type="checkbox"/> Conditional Use <input type="checkbox"/> Interpretation <input type="checkbox"/> Approved <input type="checkbox"/> Denied late: _____	Historic Preservation <input checked="" type="checkbox"/> Not in District or Landmar <input type="checkbox"/> Does Not Require Review <input type="checkbox"/> Requires Review <input type="checkbox"/> Approved <input type="checkbox"/> Approved w/Conditions <input type="checkbox"/> Denied <i>ABM</i> late: _____
--	--	---	---

CERTIFICATION

I hereby certify that I am the owner of record of the named property, or that the proposed work is authorized by the owner of record and that I have been authorized by the owner to make this application as his authorized agent and I agree to conform to all applicable laws of this jurisdiction. In addition, if a permit for work described in the application is issued, I certify that the code official's authorized representative shall have the authority to enter all areas covered by such permit at any reasonable hour to enforce the provision of the code(s) applicable to such permit.

SIGNATURE OF APPLICANT	ADDRESS	DATE	PHONE
RESPONSIBLE PERSON IN CHARGE OF WORK, TITLE		DATE	PHONE

City of Portland, Maine - Building or Use Permit

389 Congress Street, 04101 Tel: (207) 874-8703, Fax: (207) 874-8716

Permit No: 06-0433	Date Applied For: 03/31/2006	CBL: 132 J001001
------------------------------	--	----------------------------

Location of Construction: 197 PLEASANT AVE	Owner Name: RICE GEOFFREY I	Owner Address: 658 CONGRESS ST 1ST FLOOR	Phone:
Business Name:	Contractor Name:	Contractor Address:	Phone:
Lessee/Buyer's Name	Phone:	Permit Type: Signs - Permanent	

Commercial/ retail - sign install a 32" x 37" x 1.5"	retail - sign install a 32" x 37" x 1.5"
--	--

Dept: Zoning **Status:** Approved **Reviewer:** Ann Machado **Approval Date:**
Note: **Ok to Issue:**

Dept: Building **Status:** Approved with Conditions **Reviewer:** Tammy Munson **Approval Date:** 04/27/2006
Note: **Ok to Issue:**

1) Signage Installation to comply with Chapter 31 of the IBC 2003 building code.



Signage/Awning Permit Application

If you or the property owner owes real estate or personal property taxes or user charges on any property within the City, payment arrangements must be made before permits of any kind are accepted.

Location/Address of Construction: <u>463 Stevens Ave Pktd 04103</u>	
Total Square Footage of Proposed Structure	Square Footage of Lot
Tax Assessor's Chart, Block & Lot Chart# <u>132</u> Block# <u>J</u> Lot# <u>1</u>	Owner: <u>Geoffrey I. Rice</u> Telephone: <u>773-1814</u>
Lessee/Buyer's Name (If Applicable) <u>Jodi Thomas</u>	Applicant name, address & telephone: <u>DOOR 463</u> <u>Jodi Thomas</u> <u>463 Stevens Ave</u> <u>318.1760</u> Total s.f. of signage x \$2.00 Per s.f. plus \$30.00/\$65.00 For H.D. signage= Total Fee: \$ _____ Awning Fee= cost of work _____ Total Fee: _____

Who should we contact when the permit is ready: Jodi Thomas phone: 318.1760 cell 32
 Tenant/allocated building space frontage (feet): Length: 15' Height: +30' height
 Lot Frontage (feet): _____ Single Tenant or Multi Tenant Lot: multi
 Current Specific use: Art Gallery + Frame Shop
 If vacant, what was prior use: _____
 Proposed Use: _____

Information on proposed sign(s):
 Freestanding (e.g., pole) sign? Yes ___ No Dimensions proposed 40" x 18" sidewalk sign
 Bldg. wall sign? (attached to bldg) Yes No ___ Dimensions proposed 32" x 37"
 Awning? Yes ___ No Is awning backlit? Yes ___ No ___
 Height of awning: _____ Length of awning _____ Depth: _____
 Is there any communication, message, trademark or symbol on it? Yes ___ No ___
 If yes, total s.f. of panels w/communications, message, trademark or symbol _____ s.f.

Information on existing and previously permitted sign(s):
 Freestanding (e.g., pole) sign? Yes ___ No Dimensions proposed _____
 Bldg. wall sign? (attached to bldg) Yes No ___ Dimensions proposed _____
 Awning? Yes ___ No Dimensions: _____

A site sketch and building sketch showing exactly where existing and new signage is located must be provided. Sketches and/or pictures of proposed signage are also required.

Please submit all of the information outlined in the Sign/Awning Application Checklist. Failure to do so may result in the automatic denial of your permit.

In order to be sure the City fully understands the full scope of the project, the Planning and Development Department may request additional information prior to the issuance of a permit. For further information visit us on-line at www.portlandmaine.gov, stop by the Building Inspections office, room 315 City Hall or call 874-8703.

I hereby certify that I am the Owner of record of the named property, or that the owner of record authorizes the proposed work and that I have been authorized by the owner to make this application as his/her authorized agent. I agree to conform to all applicable laws of this jurisdiction. In addition, if a permit for work described in this application is issued, I certify that the Code Official's authorized representative shall have the authority to enter all areas covered by this permit at any reasonable hour to enforce the provisions of the codes applicable to this permit.

Signature of applicant: <u>Jodi Thomas</u>	Date: <u>03/29/12</u>
--	-----------------------

This is not a permit; you may not commence ANY work until the permit is issued.

$1.5 \times 15 = 22.5$ $4 \times 32 \times 37 = 1184$



Signage/Awning Pre-Application Questionnaire

Please complete all of the following information.

Address: _____ Zone: _____
CBL _____

Single Tenant Lot? Yes _____ No Multi Tenant Lot? Yes No _____

Tenant/allocated building space frontage (feet): Length: 15' Height _____

Sidewalk

Information on proposed sign(s):

Freestanding (e.g., pole) sign? Yes _____ No Dimensions proposed _____
Bldg. wall sign? (attached to bldg) Yes No _____ Dimensions proposed 32" x 37" x 1/2"
w h d

Information on already existing and permitted sign(s):

Freestanding (e.g., pole) sign? Yes _____ No Dimensions proposed: _____
Bldg. wall sign? (attached to bldg) Yes No _____ Dimensions proposed 24" x 36" remaining
Awning? Yes _____ No Dimensions: _____
Lot frontage (feet): _____

Awning? Yes _____ No Is awning backlit? Yes _____ No _____
Height of awning: _____ Length of awning: _____ Depth: _____
Is there any communication, message, trademark or symbol on it? Yes _____ No _____
If yes, total s.f. of panels w/communications, message, trademark or symbol: _____ s.f.

A site sketch and building sketch showing exactly where existing and new signage is located must be provided. Sketches and/or pictures of proposed signage are also required.

Signature of applicant: J. L. Thomas Date: 3/22/06

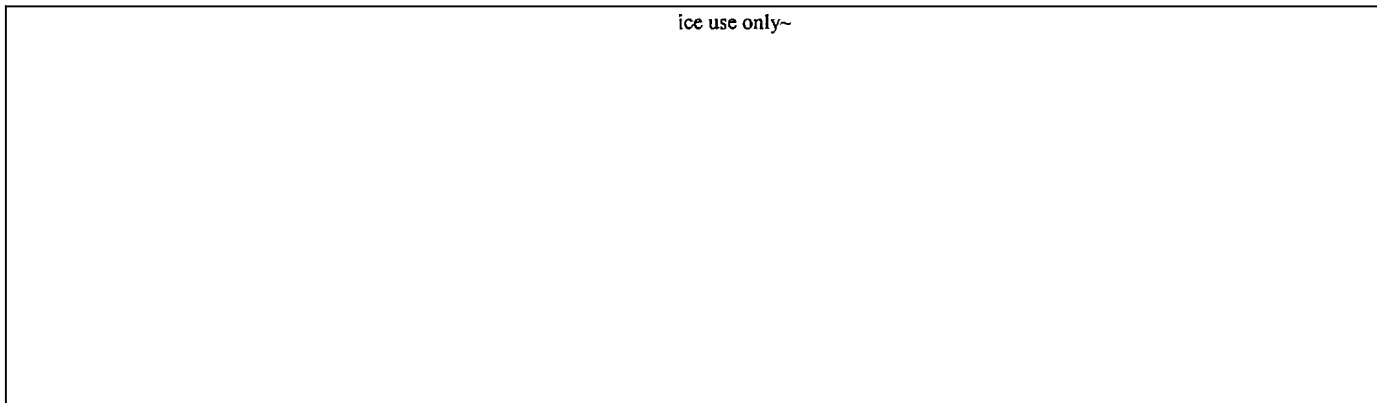

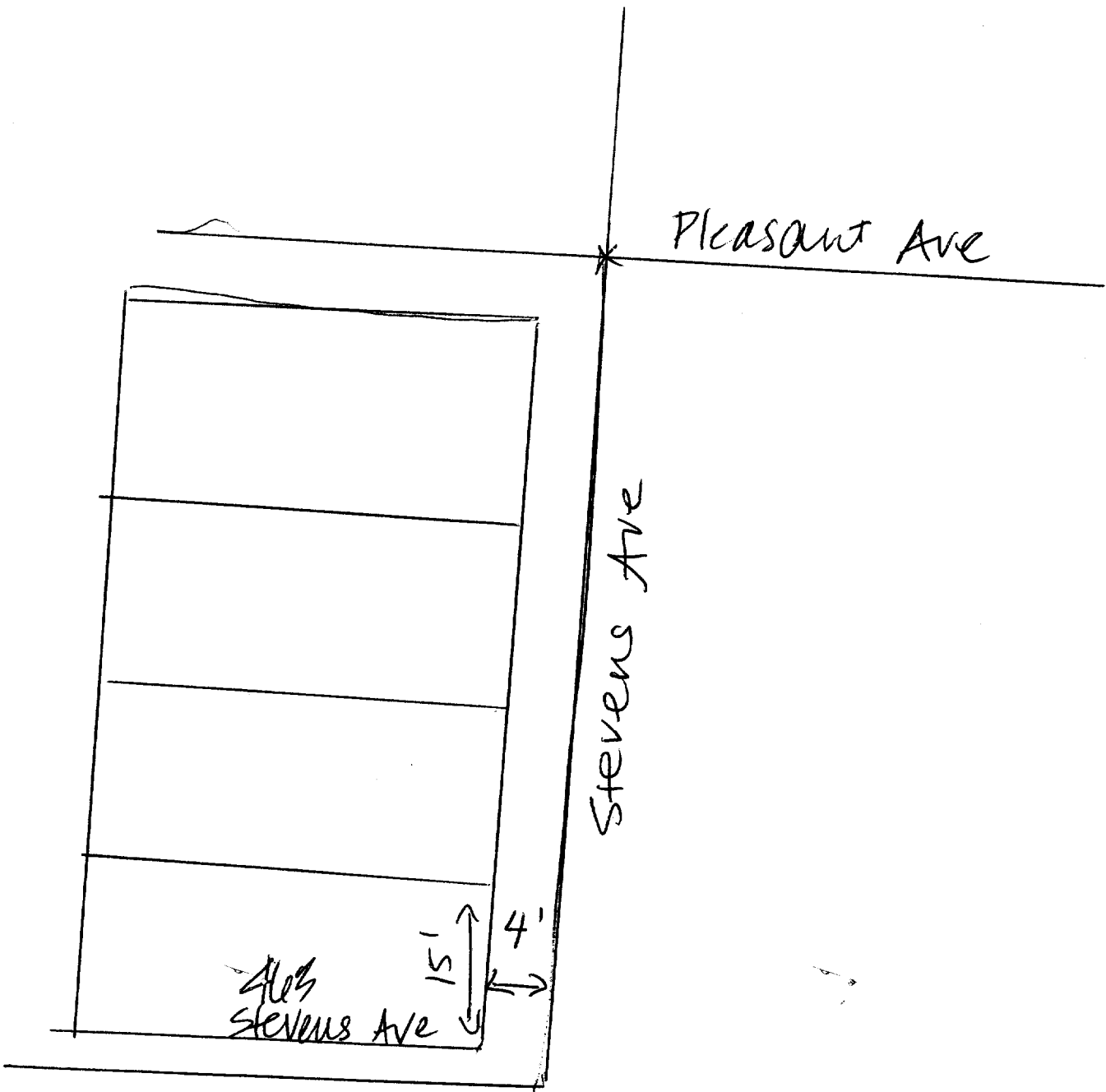

replacement
sign

32" w x 37" h x 1 1/2" d

oak half-door



DOOR
463

existing sign

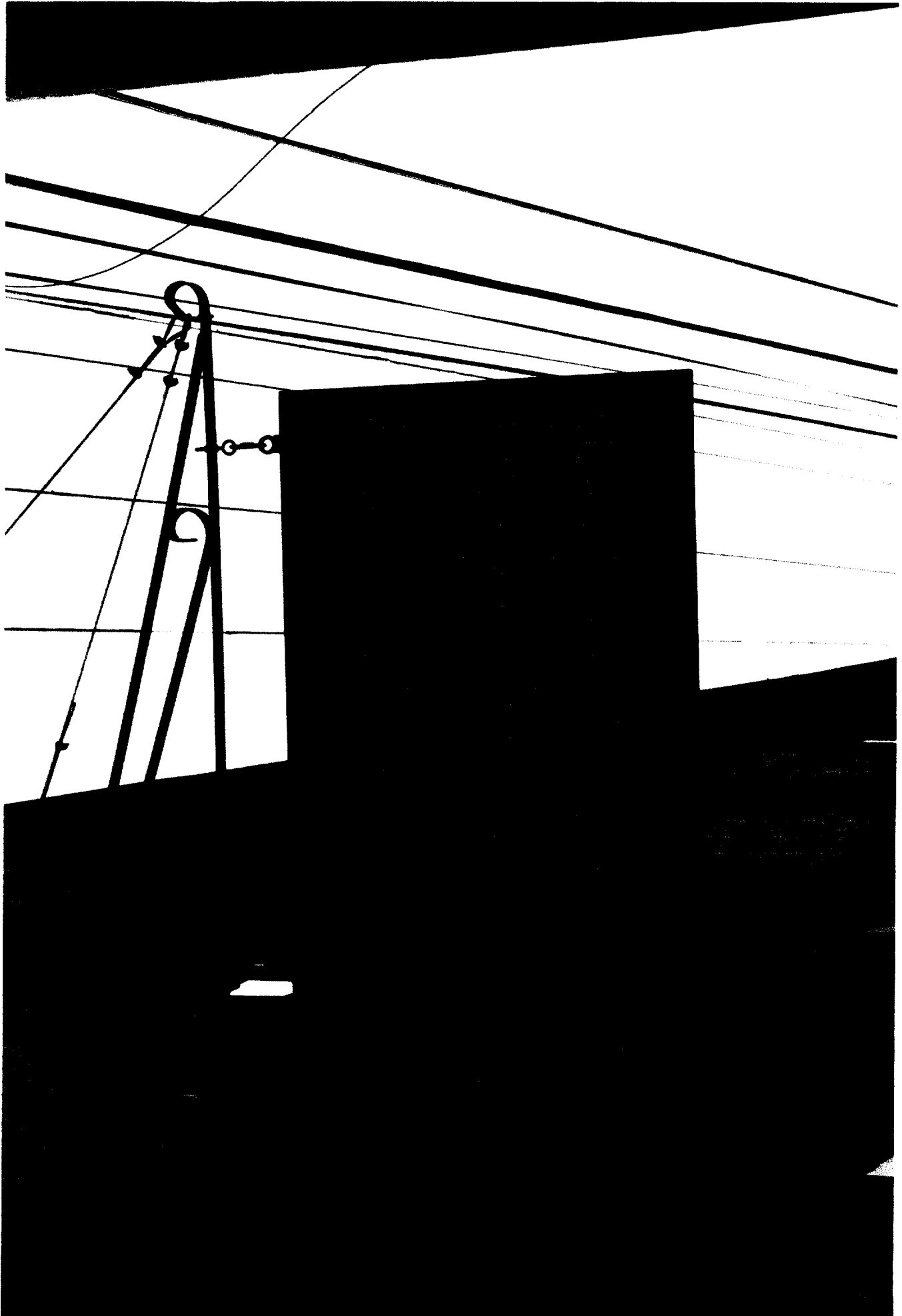

NIVE

CITY HALL NEEDS TO KNOW METHOD WE'RE
USING TO HANG THIS SIGN.

PLEASE FAX
SPECS
TO
874-8716
Attn: Ann

2078791570
207.879.1570

The Signery

APR 26, 2006 04:38P
Apr 13 06 05:20P

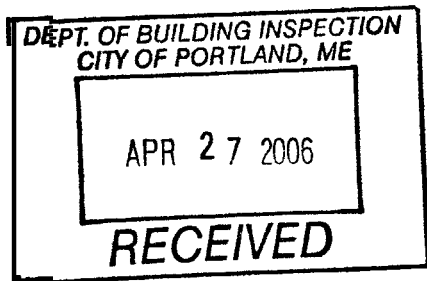

JOB INFO	210-463-000 24" X 36" PAINTED BLACK DOUBLED-DEEP SIGN CLIPS - 30" APART ON CENTER CUT CONTOUR 1/8" X 1/4" ALU.
DESIGNER	DH

BY SIGNING OFF ON THIS PROOF YOU ARE GIVING THE SIGNERY THE GO TO PRODUCE THIS WORK TO THE SPECIFICATIONS LISTED

Approved By:
Date:

PLEASE REVIEW THIS PROOF CAREFULLY!
AND SEND COPY BACK TO THE SIGNERY THANK YOU!

INSTALL
=
V
B

Once approved job and deposit is made, this proof is property of The Signery

DEPT. OF BUILDING INSPECTION
 CITY OF PORTLAND, ME

APR 27 2006

RECEIVED

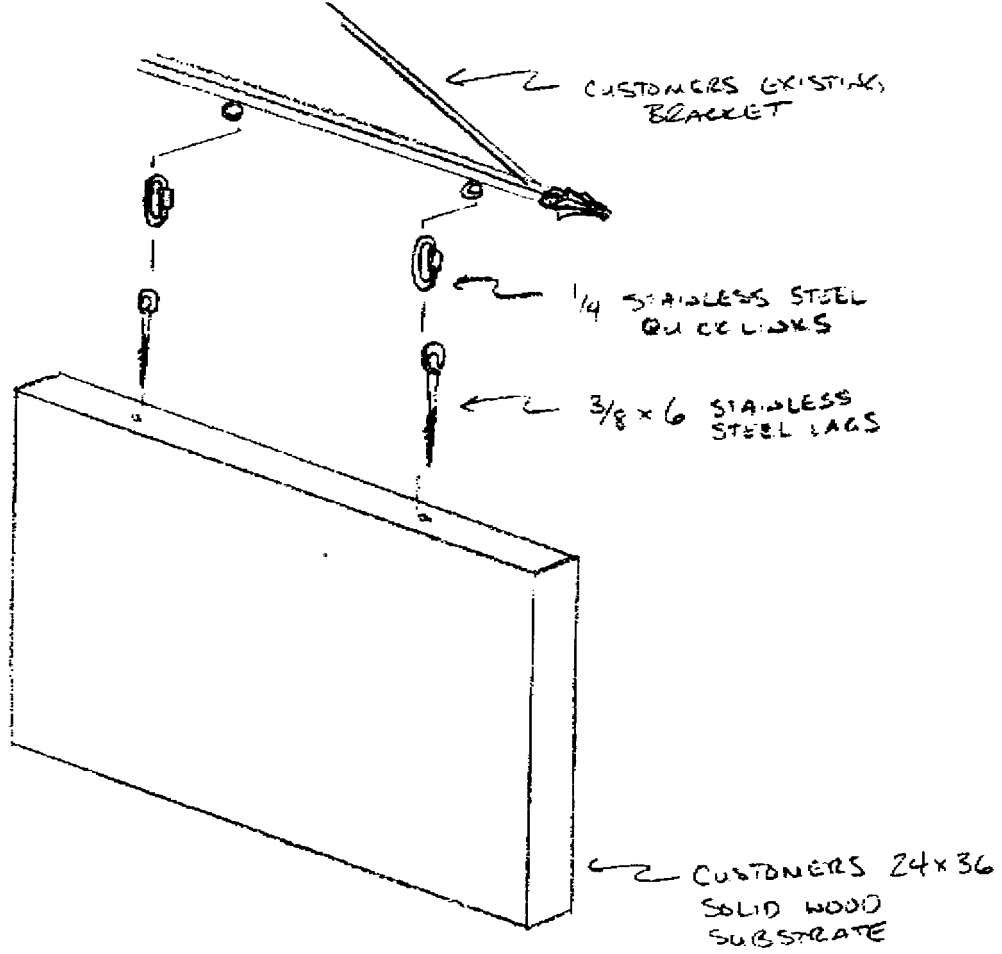

DOOR 463
 RE: [Signature]
 APR 26 2006

DOOR
463

Now On
Exhibit..

IN ROOM 11
ADVANCED ART PRESENTS
WORKS ON PAPER
DOOR 463

MARCH
18-22

720
54

40"

Sidewalk sign



existing sign

GEOFFREY I. RICE
First Floor
658 Congress Street
Portland, Maine 04101
(207) 773-1814

March 17,2006

Jodi Thomas
Door 463
463 Stevens Avenue
Portland, Maine 04103

Re: 463 Stevens Avenue
Portland, Maine 04103

Dear Jodi:

Thank you for your letter of February 21,2006 **and** its enclosure.

Your proposed change in sign is agreeable with me.

The exterior forest green paint was purchased at ICI Paints, 973 Congress Street, Portland, telephone number (207) 772-6236. Take a paint chip and they can match the color for you. In their computer they may be able to access the color from a past purchase. If not, they can analyze the color to come up with the correct shade.

Yours truly,



Geoffrey I. Rice

GIR/pjd
463.doc

half-door
natural
finish

black

32" x 36"

Bodini text

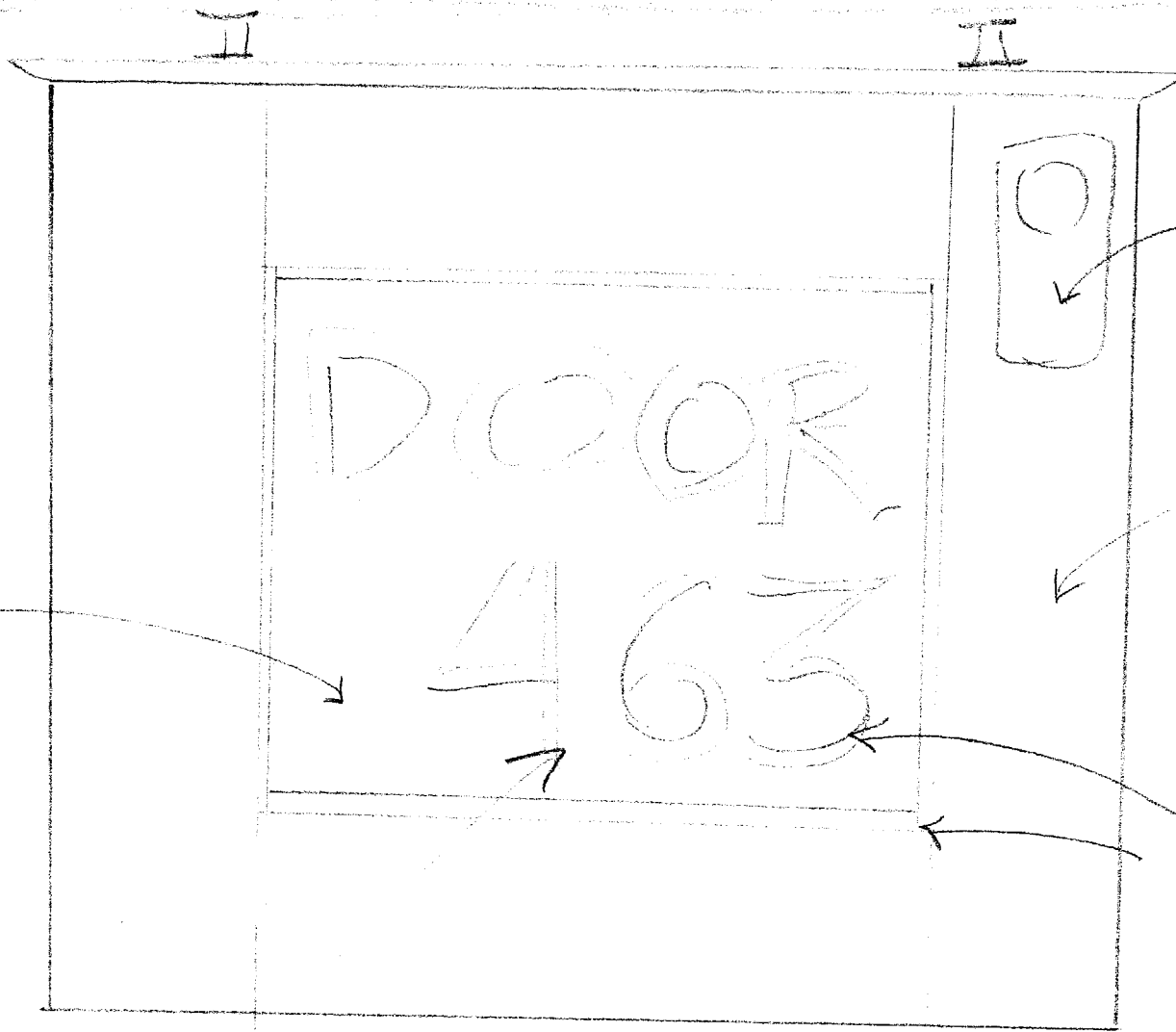

brass
door
knob

brown/wood
door

gold
letters
& border
line

DOOR 463

•Gallery. Framing. Studio Classes.
403 Stevens Avenue
Portland, Maine 04103

Date: February 21, 2006

To: Geoffrey I. Rice
658 Congress Street, First Floor
Portland, Maine 04101

RE: exterior paint and signage

Dear Geoffrey:

As spring nears the corner and a year of business is under my belt, I am thinking about ways to improve the curb appeal of the retail space at 463 Stevens Avenue.

Dan added what looks like a piece of vinyl over a portion of the wooden molding on the outside front, which seems to have solved the problem of the leaking front windows. If you remember, with your permission, I painted the side molding black last year. I'm wondering if you have the forest green paint available that matches existing color of wooden molding on the building. With your permission, I would like to repaint the front vinyl piece and the side wooden molding to match the existing color scheme. I think it would unify the aesthetics of your building.

In addition, I am in the process of building a new exterior sign. I request your permission to replace existing signage. Enclosed you will find a sketch.

I look forward to hearing from you.

Sincerely,



Jodi Thomas

Phone and Fax 207.879.5940

Email door463.maine.rr.com

ACORD CERTIFICATE OF LIABILITY INSURANCE

OPID LL
SYLVJON

DATE (MM/DD/YYYY)
03/29/06

PRODUCER
Harold W. Bishop Agency
P.O. Box 87
3 Bridge Street
Boothbay Harbor ME 04538
Phone: 207-633-3910

THIS CERTIFICATE IS ISSUED AS A MATTER OF INFORMATION ONLY AND CONFERS NO RIGHTS UPON THE CERTIFICATE HOLDER. THIS CERTIFICATE DOES NOT AMEND, EXTEND OR ALTER THE COVERAGE AFFORDED BY THE POLICIES BELOW.

INSURED

Jonathan Sylvester &
Jodi Thomas DBA Door 463
463 Stevens Ave
Portland ME 04103

INSURERS AFFORDING COVERAGE		NAIC #
INSURER A	MMG Insurance Company	15997
INSURER B		
INSURER C		
INSURER D		
INSURER E		

COVERAGES

THE POLICIES OF INSURANCE LISTED BELOW HAVE BEEN ISSUED TO THE INSURED NAMED ABOVE FOR THE POLICY PERIOD INDICATED NOTWITHSTANDING ANY REQUIREMENT TERM OR CONDITION OF ANY CONTRACT OR OTHER DOCUMENT WITH RESPECT TO WHICH THIS CERTIFICATE MAY BE ISSUED OR MAY PERTAIN THE INSURANCE AFFORDED BY THE POLICIES DESCRIBED HEREIN IS SUBJECT TO ALL THE TERMS EXCLUSIONS AND CONDITIONS OF SUCH POLICIES AGGREGATE LIMITS SHOWN MAY HAVE BEEN REDUCED BY PAID CLAIMS

INSURANCE	TYPE OF INSURANCE	POLICY NUMBER	POLICY EFFECTIVE DATE (MM/DD/YY)	POLICY EXPIRATION DATE (MM/DD/YY)	LIMITS
A X X	GENERAL LIABILITY				EACH OCCURRENCE \$ 1000000
	COMMERCIAL GENERAL LIABILITY	BP 0426246	04/01/05	04/01/06	DAMAGE TO RENTED PREMISES (Ea occurrence) \$ 250000
	CLAIMS MADE X OCCUR	"	04/01/06	04/01/07	MED. EXP (Any one person) \$ 5000
					PERSONAL & ADV INJURY \$ 11000000
	GEN'L AGGREGATE LIMIT APPLIES PER				GENERAL AGGREGATE \$ 2000000
	POLICY PROJECT LOC				PRODUCTS, COMP/OP AGG \$ 1000000
	AUTOMOBILE LIABILITY				COMBINED SINGLE LIMIT (Ea accident) \$
	ANY AUTO				BODILY INJURY (Per person) \$
	ALL OWNED AUTOS				BODILY INJURY (Per accident) \$
	SCHEDULED AUTOS				PROPERTY DAMAGE (Per accident) \$
	HIRED AUTOS				
	NON-OWNED AUTOS				
	DEDUCTIBLE				
	RETENTION \$				
	WORKERS COMPENSATION AND EMPLOYERS LIABILITY				WC STATUTORY LIMITS OTHER
	ANY PROPRIETOR/PARTNER/EXECUTIVE OFFICER MEMBER EXCLUDED				E L EACH ACCIDENT \$
	If yes describe under SPECIAL PROVISIONS below				E L DISEASE - EA EMPLOYEE \$
	OTHER				E L DISEASE - POLICY LIMIT \$

DESCRIPTION OF OPERATIONS / LOCATIONS / VEHICLES / EXCLUSIONS ADDED BY ENDORSEMENT / SPECIAL PROVISIONS
Changing out a sign.

CERTIFICATE HOLDER & Additional Insured:

✓ City of Portland
Code Enforcement &
Building Inspector
389 Congress Street
Portland ME 04101

PORTLND

CANCELLATION

SHOULD ANY OF THE ABOVE DESCRIBED POLICIES BE CANCELLED BEFORE THE EXPIRATION DATE THEREOF, THE ISSUING INSURER WILL ENDEAVOR TO MAIL 10 DAYS WRITTEN NOTICE TO THE CERTIFICATE HOLDER NAMED TO THE LEFT, BUT FAILURE TO DO SO SHALL IMPOSE NO OBLIGATION OR LIABILITY OF ANY KIND UPON THE INSURER, ITS AGENTS OR REPRESENTATIVES.

AUTHORIZED REPRESENTATIVE

Stacy L. Dickinson

Stacy L. Dickinson