

DISPLAY THIS CARD ON PRINCIPAL FRONTAGE OF WORK CITY OF PORTLAND

BUILDING DEPARTMENT

PERMIT

Permit Number: 081190

Please Read Application And Notes, If Any, Attached

This is to certify that HERR SALLY BLANCHE
has permission to Install Hanging 21"x13" (New) Therapist Sign
AT 205 CONCORD ST CB# 132 H007001

provided that the person or persons, firm or corporation accepting this permit shall comply with all of the provisions of the Statutes of Maine and of the Ordinances of the City of Portland regulating the construction, maintenance and use of buildings and structures, and of the application on file in this department.

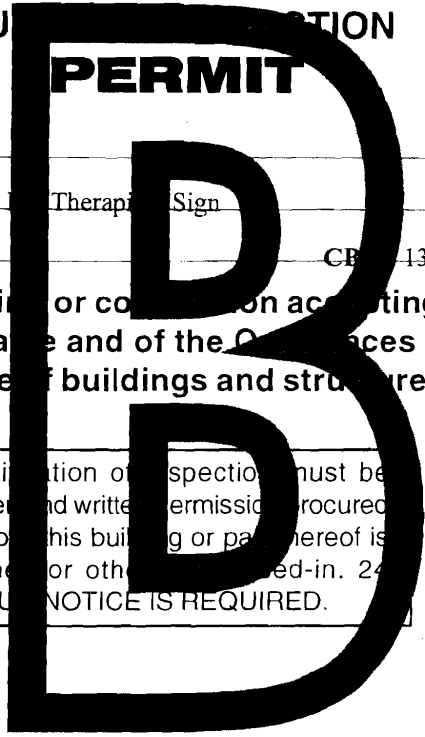

Apply to Public Works for street line and grade if nature of work requires such information.

Notification of inspection must be given and written permission procured before this building or part thereof is lathed or otherwise altered-in. 24 HOURS NOTICE IS REQUIRED.

A certificate of occupancy must be procured by owner before this building or part thereof is occupied.

OTHER REQUIRED APPROVALS

Fire Dept. _____

Health Dept. _____

Appeal Board _____

Other _____

Department Name

PERMIT ISSUED

SEP 30 2008

CITY OF PORTLAND

9/29/08 *City*
Director - Building & Inspection Services

PENALTY FOR REMOVING THIS CARD

City of Portland, Maine - Building or Use Permit Application

389 Congress Street, 04101 Tel: (207) 874-8703, Fax: (207) 874-8716

Permit No: 08-1190	Issue Date: 9/29/08	CBL: 132 H007001
-----------------------	------------------------	---------------------

Location of Construction: 205 CONCORD ST	Owner Name: HERR SALLY BLANCHE	Owner Address: 205 CONCORD ST	Phone: 207-415-4613
Business Name:	Contractor Name:	Contractor Address:	Phone:
Lessee/Buyer's Name	Phone:	Permit Type: Signs - Permanent	Zone: R-5

Past Use: Single Family Home w/ home occupation (therapist)	Proposed Use: Single Family Home w/home occupation (therapist) - Install Hanging 21"x13" (New Era Therapies) Sign	Permit Fee: \$36.00	Cost of Work: \$0.00	CEO District: 5
Proposed Project Description: Install Hanging 21"x13" (New Era Therapies) Sign		FIRE DEPT: <input type="checkbox"/> Approved <input type="checkbox"/> Denied	INSPECTION: Use Group: R-3 Type: SB S:8 IRC-2003	
		Signature: 9/29/08 C		Signature: 9/29/08 C
		PEDESTRIAN ACTIVITIES DISTRICT (P.A.D.)		
		Action: <input type="checkbox"/> Approved <input type="checkbox"/> Approved w/Conditions <input type="checkbox"/> Denied		
		Signature: _____ Date: _____		

Permit Taken By: lmd	Date Applied For: 09/19/2008	Zoning Approval		
-------------------------	---------------------------------	------------------------	--	--

<ol style="list-style-type: none"> This permit application does not preclude the Applicant(s) from meeting applicable State and Federal Rules. Building permits do not include plumbing, septic or electrical work. Building permits are void if work is not started within six (6) months of the date of issuance. False information may invalidate a building permit and stop all work.. 	Special Zone or Reviews <input type="checkbox"/> Shoreland <input type="checkbox"/> Wetland <input type="checkbox"/> Flood Zone <input type="checkbox"/> Subdivision <input type="checkbox"/> Site Plan Maj <input type="checkbox"/> Minor <input type="checkbox"/> MM <input type="checkbox"/> OK Date: 9/29/08 ABM	Zoning Appeal <input type="checkbox"/> Variance <input type="checkbox"/> Miscellaneous <input type="checkbox"/> Conditional Use <input type="checkbox"/> Interpretation <input type="checkbox"/> Approved <input type="checkbox"/> Denied Date: _____	Historic Preservation <input checked="" type="checkbox"/> Not in District or Landmark <input type="checkbox"/> Does Not Require Review <input type="checkbox"/> Requires Review <input type="checkbox"/> Approved <input type="checkbox"/> Approved w/Conditions <input type="checkbox"/> Denied Date: ABM
---	---	---	--

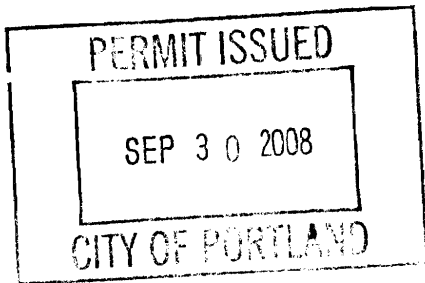

CERTIFICATION

I hereby certify that I am the owner of record of the named property, or that the proposed work is authorized by the owner of record and that I have been authorized by the owner to make this application as his authorized agent and I agree to conform to all applicable laws of this jurisdiction. In addition, if a permit for work described in the application is issued, I certify that the code official's authorized representative shall have the authority to enter all areas covered by such permit at any reasonable hour to enforce the provision of the code(s) applicable to such permit.

SIGNATURE OF APPLICANT	ADDRESS	DATE	PHONE
RESPONSIBLE PERSON IN CHARGE OF WORK, TITLE		DATE	PHONE

City of Portland, Maine - Building or Use Permit

389 Congress Street, 04101 Tel: (207) 874-8703, Fax: (207) 874-8716

Permit No: 08-1190	Date Applied For: 09/19/2008	CBL: 132 H007001
-----------------------	---------------------------------	---------------------

Location of Construction: 205 CONCORD ST	Owner Name: HERR SALLY BLANCHE	Owner Address: 205 CONCORD ST	Phone: 207-415-4613
Business Name:	Contractor Name:	Contractor Address:	Phone:
Lessee/Buyer's Name	Phone:	Permit Type: Signs - Permanent	

Proposed Use: Single Family Home w/home occupation (therapist) - Install Hanging 21"x13" (New Era Therapies) Sign	Proposed Project Description: Install Hanging 21"x13" (New Era Therapies) Sign
--	---

Dept: Zoning	Status: Approved	Reviewer: Ann Machado	Approval Date: 09/29/2008
Note: connected to permit #960909. Original application was for a 24" x 16" sign. This did not meet the max. allowable square footage so the new proposal is 21" x 13".			Ok to Issue: <input checked="" type="checkbox"/>
Dept: Building	Status: Approved with Conditions	Reviewer: Chris Hanson	Approval Date: 09/29/2008
Note:			Ok to Issue: <input checked="" type="checkbox"/>
1) Signage Installation to comply with Chapter 31 of the IBC 2003 building code.			

Comments:
9/23/2008-amachado: Left vcm for Sally Herr. Sign can only be 2 sf. Her proposed sign is 2.67 sf.
9/29/2008-amachado: Received revised sign dimensions that meet the ordinance,



Signage/Awning Permit Application

If you or the property owner owes real estate or personal property taxes or user charges on any property within the City, payment arrangements must be made before permits of any kind are accepted.

Location/Address of Construction: <u>205 Concord St Portland ME 04103</u>		
Tax Assessor's Chart, Block & Lot Chart# Block# Lot# <u>132 H 007</u>	Owner:	Telephone: <u>207 879-6007</u> cell: <u>207 415-4613</u>
Lessee/Buyer's Name (If Applicable) <u>SEP 19 2003</u>	Contractor name, address & telephone:	Total s.f. of signage x \$2.00 Per s.f. plus \$30.00/\$65.00 For H.D. signage= Total Fee: \$ _____ Awning Fee= cost of work _____ Total Fee: \$ _____
Who should we contact when the permit is ready: <u>Sally Horn</u> phone: <u>207-879-6007</u>		
Tenant/allocated building space frontage (feet): Length: _____ Height: _____ Lot Frontage (feet) _____ Single Tenant or Multi Tenant Lot _____		
Current Specific use: <u>Single Family home / with Home Occupation</u> If vacant, what was prior use: _____ Proposed Use: _____		
Information on proposed sign(s): Freestanding (e.g., pole) sign? Yes ___ No ___ Dimensions proposed: _____ Height from grade: _____ Bldg. wall sign? (attached to bldg) Yes <input checked="" type="checkbox"/> No ___ Dimensions proposed: _____ <u>24 x 16</u>		
Proposed awning? Yes ___ No ___ Is awning backlit? Yes ___ No ___ Height of awning: _____ Length of awning: _____ Depth: _____ Is there any communication, message, trademark or symbol on it? Yes ___ No ___ If yes, total s.f. of panels w/communications, message, trademark or symbol: _____ s.f. <u>21" x 13"</u> <i>* see revised dimensions on email - 9/29/08</i>		
Information on existing and previously permitted sign(s): Freestanding (e.g., pole) sign? Yes ___ No ___ Dimensions: _____ Bldg. wall sign? (attached to bldg) Yes ___ No ___ Dimensions: _____ Awning? Yes ___ No ___ Sq. ft. area of awning w/communication: _____		
A site sketch and building sketch showing exactly where existing and new signage is located must be provided. Sketches and/or pictures of proposed signage and existing building are also required.		

Please submit all of the information outlined in the Sign/Awning Application Checklist. Failure to do so may result in the automatic denial of your permit.

In order to be sure the City fully understands the full scope of the project, the Planning and Development Department may request additional information prior to the issuance of a permit. For further information visit us on-line at www.portlandmaine.gov, stop by the Building Inspections office, room 315 City Hall or call 874-8703.

I hereby certify that I am the Owner of record of the named property, or that the owner of record authorizes the proposed work and that I have been authorized by the owner to make this application as his/her authorized agent. I agree to conform to all applicable laws of this jurisdiction. In addition, if a permit for work described in this application is issued, I certify that the Code Official's authorized representative shall have the authority to enter all areas covered by this permit at any reasonable hour to enforce the provisions of the codes applicable to this permit.

Signature of applicant: <u>Sally Horn</u>	Date: <u>9/19/2008</u>
---	------------------------

home occupation sign affixed to building - can't project more than 1' max area 24"
 This is not a permit; you may not commence ANY work until the permit is issued.
 proposed 24" x 16" = 384 sq ft = 2.67 sq ft
 21" x 13" = 273 sq ft = 1.9 sq ft ok.

From: Sally Herr <sally@maine.rr.com>
To: <Amachado@PortlandMaine.gov>
Date: 9/26/2008 1:16:03 PM
Subject: Dimensions of a Sign

Dear Ann;

You had kindly informed me that my measurements for a sign were too large. The revised measurements for the sign are 21" wide by 13" tall. Thank you for your help.

Sincerely,

Sally Herr

$21" \times 13" = 273\# = 1.9\phi$

--

Sally Herr
New Era Therapies
205 Concord Street
Portland, ME 04103
207 879 6007

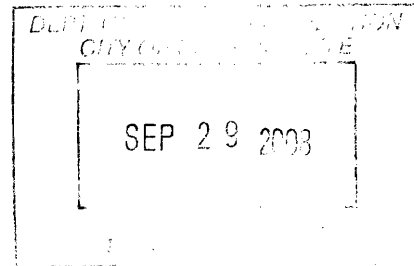

Actual **24x16** - revised size is 21" x 13"
per email received 9/29/08.

Hung from eye hooks



New Era
Therapies
(207) 879-6007

CranioSacral Therapy Speech Therapy
Resonance Repatterning



CITY OF PORTLAND, MAINE
Department of Building Inspection

Certificate of Occupancy

LOCATION 205 Commercial St. 151-2-107

Issued to Sally Kerr

Date of Issue 21 October 1991

This is to certify that the building, premises, or part thereof, at the above location, built — altered — changed as to use under Building Permit No. 98890, has had final inspection, has been found to conform substantially to requirements of Zoning Ordinance and Building Code of the City, and is hereby approved for occupancy or use, limited or otherwise, as indicated below.

PORTION OF BUILDING OR PREMISES

APPROVED OCCUPANCY

Entire

Single Family w/home Occupations

Speech & Polarity Therapy

Limiting Conditions:

This certificate supersedes certificate issued

Approved:

10/3/91 *M. L. Seary*

(Date) Inspector

[Signature]

Inspector of Buildings

Notice: This certificate identifies lawful use of building or premises, and ought to be transferred from owner to owner when property changes hands. Copy will be furnished to owner or lessee for one dollar.

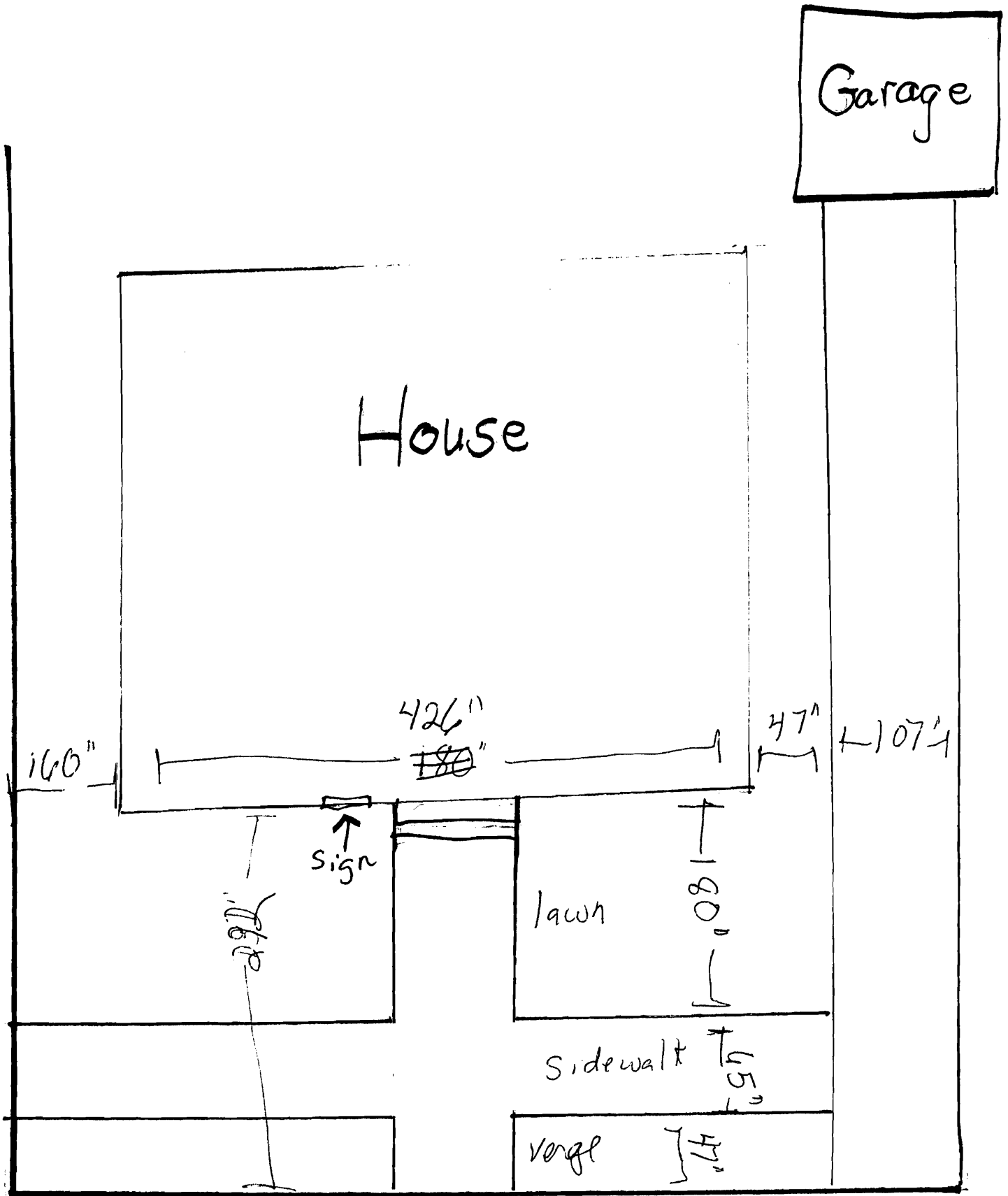

205 Concord St
 Portland 04103

street



Hanging from a beam 131" from ground.
292" from curb of street.



Signage/Awning Permit Application Checklist

All of the following information is required and must be submitted. Checking off each item as you prepare your application package will ensure your package is complete and will help to expedite the permitting process.

- Certificate of Liability listing the City as additional insured if any portion of the sign abuts or encroaches on any public right of way, or can fall into any public right of way.
- N/A* Letter of permission from the owner indicating the permissions granted and the tenant/space building frontage.
- A sketch plan of lot indicating location of buildings, driveways and any abutting streets or rights of way, lengths of building frontages, street frontages and all existing setbacks. Please indicate on the plan all existing and proposed signs with their dimensions and specific locations. Be sure to include distance from the ground and building facade dimensions for any signage attached to the building.
How far from the property line 131" from ground How far from a beam
- A sketch or photo of any proposed sign(s) indicating content, dimensions, materials, source of illumination, construction method as well as specifics of installation/attachment.
- Certificate of flammability required for awning or canopy.
- A UL# is required for lighted signs at the time of final inspection.
- Pre-application questionnaire completed and attached.
- Photos of existing signage
- Details for sign fastening, attachment or mounting in the ground.

Permit fee for signage or awning-with-signage: \$30.00 plus \$2.00 per square foot of sign.

Permit fee for awning-without-signage is based on cost of work:
\$30.00 for the first \$1,000.00, \$9.00 per additional \$1,000.00 of cost.

Base application fee for any Historic District signage is \$65.00.