

2 - 70" cabinet
2 - 42" cabinet
2 - 36" cabinet
2 - 30" cabinet
2 - 24" cabinet
2 - 18" cabinet
2 - 12" cabinet
2 - 6" cabinet

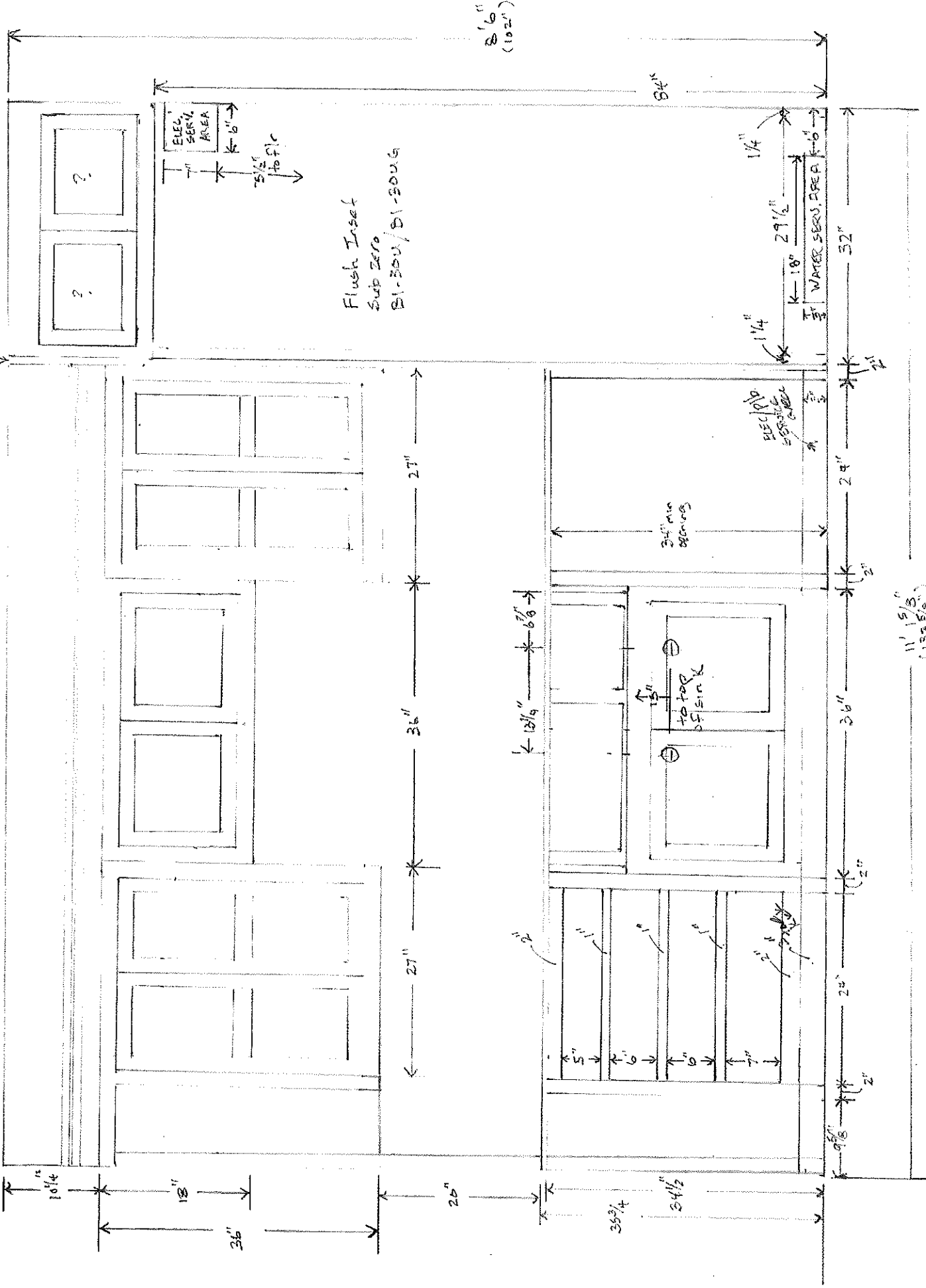

102"
(102")

Flush Inset
Sub Zero
B1-30U/B1-30UG

ELEC. SERV. AREA
6"

1/4"
29 1/2"
K-18"
WATER SERV. AREA
K-10"

ELEC. SERV. AREA
6"

24" min beams

TO TOP OF ISLAND

11' 5/8"
(133 5/8")