

Proposed rear Deck enlargement
Scale $\frac{1}{4}''=1'$
Drawn by Peter Raszmann
Cell Phone 329 8117
22 May 16

For Lisa and Tin Hangoc
101 Concord Street
Portland, Maine 04101

Steps not to exceed $7\frac{3}{4}''$ Rise and not to be less than 10" run
 $5/4''$ Decking

Railings to be minimum of 36" high with
spacing between balusters less than 4"

Ledger,joist, 2"x8" Pressure Treated 16" OC

$1\frac{1}{2}''$ "x8" pressure treated , doubled at the rim and
Supported by 8" sono tubes to 48" below grade.

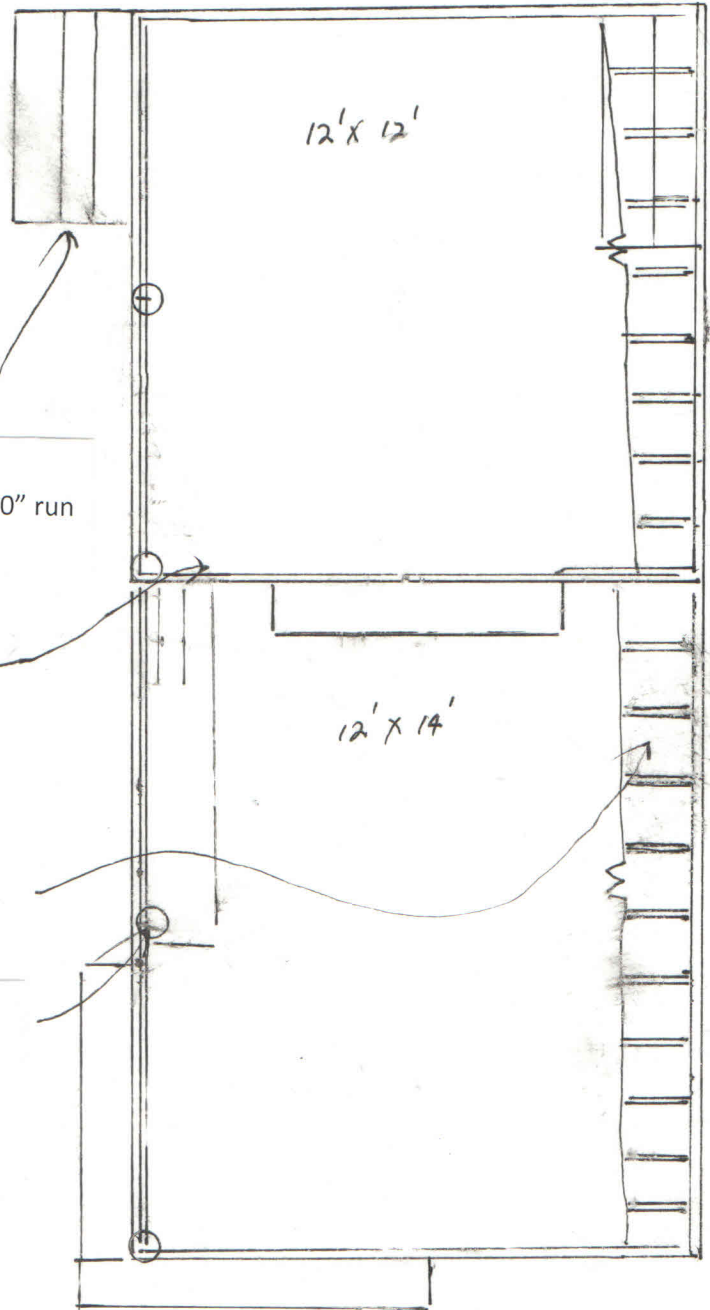

Plan drawing