

©2015 MJM+A ARCHITECTS, PLLC
 THIS SHALL NOT BE CONSIDERED AN AUTHORIZED COPY ISSUED FROM THE ARCHITECT UNLESS HIS ORIGINAL SEAL AND ORIGINAL SIGNATURE ARE AFFIXED. ANY REPRODUCTIONS MAY NOT BE USED FOR ANY REASON WITHOUT THE PRIOR, WRITTEN PERMISSION FROM THE ARCHITECT.

THESE DOCUMENTS HAVE BEEN PREPARED ELECTRONICALLY AND AS SUCH ARE NOT PROTECTED AGAINST UNAUTHORIZED CHANGES. ALL PARTIES ARE HEREBY NOTIFIED THAT ONLY THOSE PAPER COPIES BEARING THE ORIGINAL SEAL AND SIGNATURE OF THE ARCHITECT OF RECORD SHALL BE CONSIDERED AUTHORIZED BY THE ARCHITECT FOR USE. ANY UNAUTHORIZED USE SHALL BE UNDERTAKEN AT THE RISK OF THE USER.

ISSUE LOG:

NO.	DATE:	BY:	ISSUE:
01	07/24/15	RPS	OWNER REVIEW
02	07/28/15	RPS	FOR PRICING
03	07/28/15	RPS	FOR BUILDING PERMIT

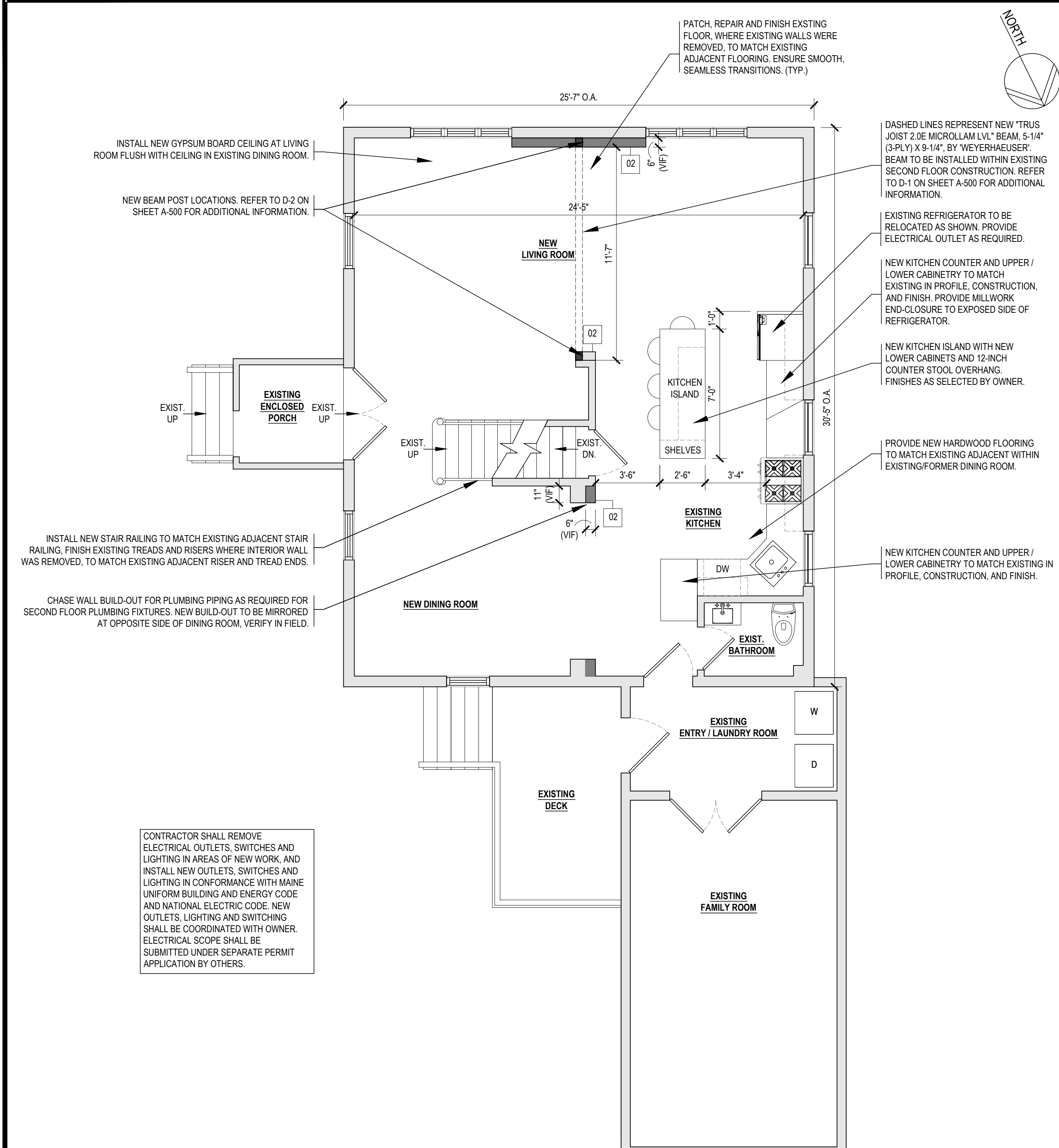

1 FIRST FLOOR CONSTRUCTION PLAN
 SCALE: 1/4" = 1'-0" (24"x36" SHEET ONLY)
 2ft 0 2ft 4ft 6ft 10ft 14ft
 S C A L E

GENERAL CONSTRUCTION NOTES

- REFER TO GENERAL NOTES ON SHEET T-100 AND G-100 FOR ADDITIONAL INFORMATION.
- CONTRACTOR SHALL VERIFY ALL DIMENSIONS. CONTRACTOR SHALL NOTIFY ARCHITECT OF ANY DISCREPANCIES BETWEEN THE CONTRACT DOCUMENTS AND THE EXISTING CONDITIONS.
- CONTRACTOR TO INSTALL "DUROCK" "CEMENT BOARD" WALL SHEATHING SUBSTRATE BY "USG" AT ALL TILE SURFACES AND SURFACES THAT ARE TO BE SUBJECT TO DIRECT CONTACT WITH WATER.
- FLOORS: CONTRACTOR TO INSTALL NEW FLOOR FINISHES AND FINISH FLOOR PATCHES AS INDICATED. FINISHES INCLUDE BUT NOT LIMITED TO NEW WOOD FLOORING, STONE FINISHES, TILE FINISHES ETC. CONTRACTOR SHALL ENSURE SMOOTH SEAMLESS TRANSITIONS WITHIN FLOORS OF SAME FINISH MATERIALS, AND ADA COMPLIANT / NON-TRIP HAZARD FLOOR TRANSITIONS BETWEEN DISSIMILAR MATERIALS. (TYPICAL THROUGHOUT)
- CEILINGS: CONTRACTOR SHALL FURNISH AND INSTALL NEW HARD GYPSUM BOARD CEILINGS AND CEILING PATCHES AS INDICATED. CONTRACTOR SHALL ENSURE ALL CEILING SURFACES ARE COMPLETELY LEVEL AS MEASURED FROM THE FINISHED FLOOR PRIOR TO ANY CROWN MOLDING INSTALLATION AND FINISH WORK.
- BLOCKING: CONTRACTOR TO PROVIDE WOOD BLOCKING / STRAPPING AS NECESSARY AT ALL LOCATIONS OF WALL MOUNTED TELEVISIONS, WALL HUNG CABINETRY, GRAB BARS, HANDRAILS AND ANY OTHER INSTALLATIONS REQUIRING ADDITIONAL SUPPORT WITHIN THE WALL CONSTRUCTION.

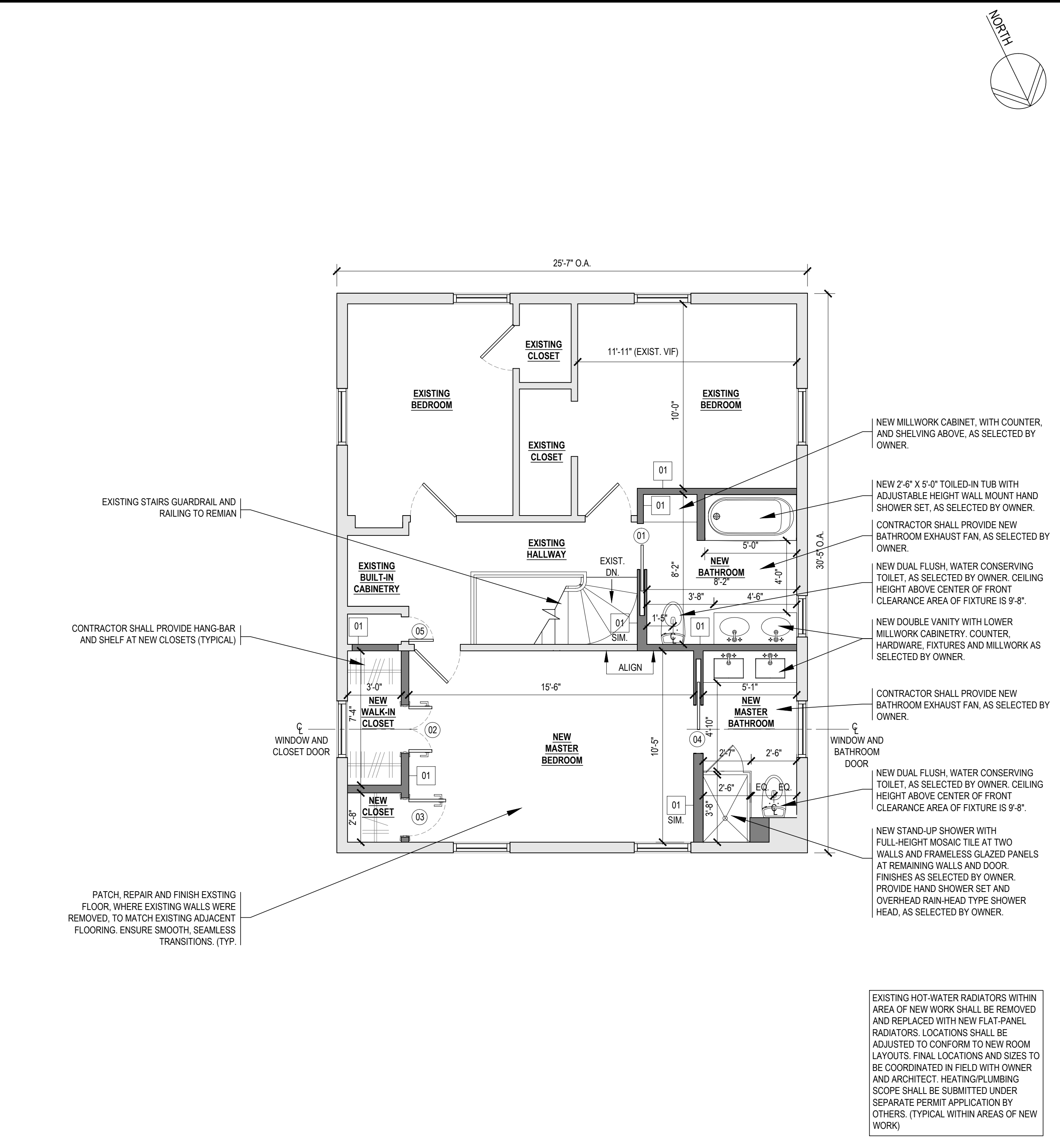

2 SECOND FLOOR CONSTRUCTION PLAN
 SCALE: 1/4" = 1'-0" (24"x36" SHEET ONLY)
 2ft 0 2ft 4ft 6ft 10ft 14ft
 S C A L E

DOOR SCHEDULE

MARK	DOOR SIZE W x H	DOOR TYPE	GLAZING	WEATHER STRIPPING	LOCK SET	PASSAGE SET	REMARKS
01	2'-6" x 7'-0"	POCKET DOOR			●		PANELING AND HEIGHT TO MATCH EXISTING ADJACENT DOORS, V.I.F.
02	(2) 1'-3" x 7'-0"	DOUBLE DOOR	FROSTED		●		PROVIDE 9" X 5'-10" FROSTED SINGLE LITE PER PANEL
03	2'-0" x 7'-0"	SINGLE DOOR			●		CUSTOM DOOR SHAPE TO BE PROVIDED.
04	2'-6" x 7'-0"	POCKET DOOR	FROSTED		●		PROVIDE 2'-0" X 5'-10" FROSTED SINGLE LITE.
05	1'-4" x 7'-0"	SINGLE DOOR			●		

DOOR NOTES:
 1) ALL DOORS TO BE SOLID WOOD CORE, STAIN-GRADE VENEER, MANUFACTURER, MODEL AND FINISH AS SELECTED BY OWNER. ALL DOORS TO BE SHOP FINISHED PRIOR TO INSTALLATION.
 2) ALL DOORS TO BE PROVIDED WITH SOLID HARDWOOD CASINGS AND TRIM, FINISH AS SELECTED BY OWNER.
 3) DOOR HARDWARE MANUFACTURER, MODEL AND FINISH, AS SELECTED BY OWNER.
 4) LOCK SETS AT BATHROOM DOORS TO BE PRIVACY TYPE.

LEGEND OF SYMBOLS (THIS SHEET ONLY)

SYMBOL	DESCRIPTION
---	EXISTING PROPERTY LINE.
---	EXISTING WALL CONSTRUCTION TO REMAIN.
---	EXISTING DOOR TO REMAIN.
---	EXISTING CONSTRUCTION TO BE REMOVED. PATCH AND REPAIR EXISTING ADJ. WALLS, FLOOR AND CEILING AS REQUIRED.
---	EXISTING DOOR TO BE REMOVED.
X	NEW WALL CONSTRUCTION. REFER TO WALL TYPE DETAILS ON SHEET A-200 FOR ADDITIONAL INFORMATION.
X	NEW DOOR. REFER TO DOOR SCHEDULE; THIS SHEET FOR ADDITIONAL INFORMATION.

PROJECT:
RESIDENTIAL INTERIOR ALTERATION
101 CONCORD STREET
PORTLAND, ME 04103

SHEET TITLE:
FIRST AND SECOND FLOOR CONSTRUCTION PLANS

SEAL & SIGNATURE:

ISSUE DATE: 07/28/15
PRINTED DATE: 07/28/15
PROJECT No: 1571-00
DRAWING BY: VRC
DWG. No:

A-100.00
CADD FILE No: A-100.00.DWG 4 OF 5