

# Typical wall section

2x4x10' wall <sup>wood</sup> const with the exception of  
1 wet wall which will be min. 2x6

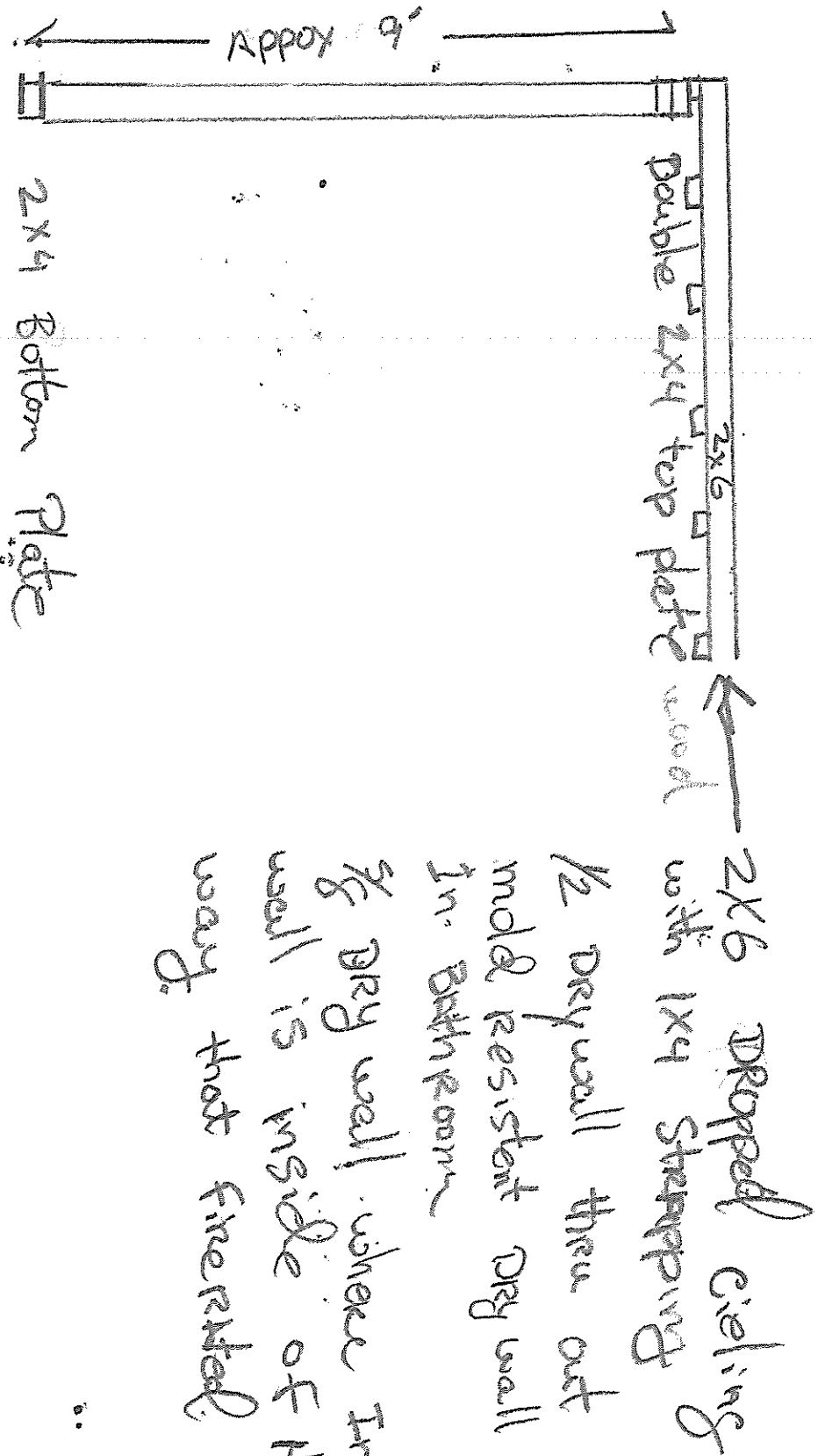

2x6 dropped ceiling  
1/2 Drywall thru out  
mold resistant Dry wall  
in Bathroom

3/8 Dry wall where Interior  
wall is inside of Hall.  
wavy hot fire rated