

EXISTING STARWELL OPENING
3'-0"

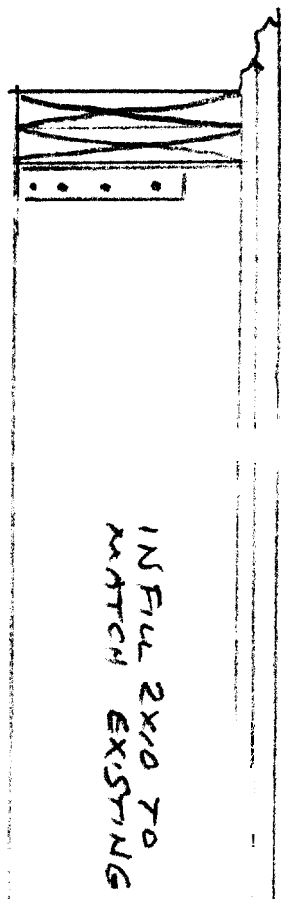

IN FILE 2X10 TO
MATCH EXISTING

$1\frac{1}{2}'' \approx 1'$

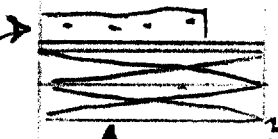

FINISH FLOOR $\frac{3}{4}''$
SUBFLOOR $\frac{7}{8}''$
2X10 DOUBLE

2X10
JOIST
HANGERS
ON IN FILE
FRAMING

4'-6"

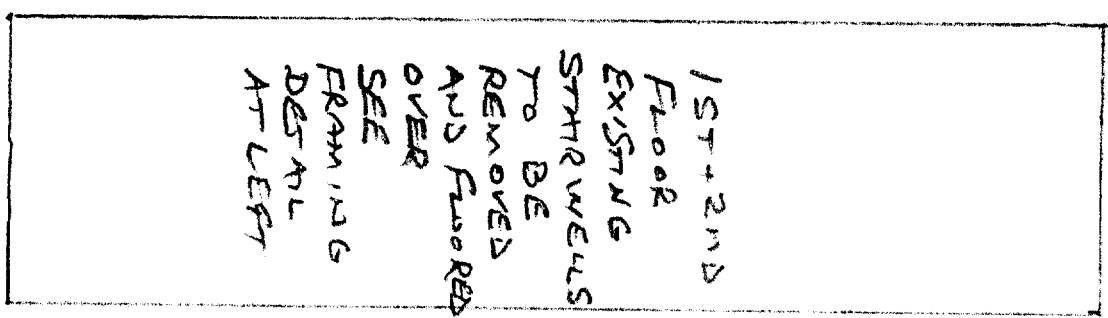

1ST+2ND
FLOOR
EXISTING
STARWELLS
TO BE
REMOVED
AND FLOORED
OVER
SEE
FRAMING
DETAIL
AT LEFT

3'-0"